

1:10 DUAL SPORT

Associated's RC10DS Dual Sport kits are based on the most durable and proven car on the market, the original off road RC10. The feature that makes our car different from our competitors is the dual sport aspect. This means we are offering two different styles of bodies, for touring or Trans Am racing. The Associated on road RC10L series racing cars were built for racing on smooth tracks designed specifically for on road racing. The RC10DS, however, was created for parking lot tracks, which have a rougher surface than are found on those dedicated to on road.

The kits come with our race proven Stealth transmission (not included in the conversion kit), Associated's proven racing shocks, special Proline semi-pneumatic rubber tires on new scale chrome wheels (with BBS style hub caps), our special dual sport front and rear suspension parts, front and rear anti-roll bars, front and rear shock struts, new body mounts, aluminum tub chassis, and a new chassis nose plate.

All of this combines to make one of the most versatile and enjoyable cars we have ever produced.

RC10^{DS} SPORT KIT

This economical version of our racer kit is complete with bronze bushings, stock motor, new easier-to-install mechanical speed control, and all wiring. One kit includes the Mustang Trans Am body and the other a German Mercedes DTM touring body.

Features it shares with the racer kit includes the Stealth transmission, special ProLine semi-pneumatic tires with scale chrome wheels (with BBS style hubcaps and foam inserts for all four tires), and our special dual sport suspension parts. It includes new front and rear suspension arms, front and rear anti-roll bar, front and rear shock struts, chassis nose plate, and our proven aluminum tub chassis.

As with the racer version, this car is fully tunable for many track conditions. Later, you may purchase ball bearings, hard anodized Teflon sealed shocks, and universal dogbone rear axles to move up to full racing benefits.

#8080, \$285.00

#8081, \$285.00

RC10^{DS} RACER KIT

This racing version differs from the sport versions with its ball bearings, hard anodized Teflon sealed shocks, and universal dogbone rear axles. It does not have a body, motor, speed control, or wiring.

Features it shares with the sport kits includes the race-proven Stealth transmission with ATC, special ProLine semi-pneumatic rubber on road tires with new scale chrome wheels (with BBS style hubcaps and foam inserts for all four tires), and our special dual sport suspension parts. It includes new front and rear suspension arms, front and rear anti-roll bars, front and rear shock struts, new chassis nose plate, and our proven aluminum tub chassis.

You can fine-tune almost anything on this car. It has adjustable toe-in/toe-out, adjustable servo saver bellcrank, adjustable anti-roll bar, adjustable-height body mounts, adjustable caster and camber, and more—this car is built for racing! Requires body designed for the RC10DS.

#8085, \$325.00

RC10^{DS} CONVERSION KIT

Many racers have older RC10's or RC10T's that are used less often because they have switched to our RC10B2 or RC10T2. Some may also just be looking for something different to run. The RC10DS conversion kit allows you to convert to on road racing by using your existing off road RC10 or RC10T chassis, your Stealth tranny (or even your original RC10 tranny) and a few other parts from your old car. (You cannot convert from an RC10B2 or RC10T2 or graphite chassis.)

The kit contains front and rear suspension arms, front and rear shocks, front and rear shock brackets, front pickup plate, front bulkhead, racing front and rear wheels, pneumatic ProLine racing tires, anti-roll bars, and all necessary hardware. Does not include motor, body or electrical.

Requires body designed for the RC10DS.

#8089, \$115.00

	aluminum tub	bearing kit	bushing kit	motor	mech. speed control	Teflon sealed, hard anodized shocks	gold anodized shocks	price
8080*	●	●	●	●		●		285.00
8081*	●	●	●	●		●		285.00
8085**	●	●			●			325.00
8089**		●				●		115.00

* does not include battery and radio. ** does not include body, motor, battery, radio and all electrical. Due to ongoing R&D to improve our kits, some photos may not accurately reflect the latest edition. PRICES SUBJECT TO CHANGE WITHOUT NOTICE.



part #	description	qty	price
--------	-------------	-----	-------

part #	description	qty	price
--------	-------------	-----	-------

1:10 ON ROAD DUAL SPORT CATALOG

CATALOG #10DS February 1997

This free catalog is updated yearly; is yours current?

Prices subject to change without notice.

If you cannot obtain parts from your distributor or dealer, you may order them directly from us.

(We're sorry, you cannot order car kits from us.)

Numbers in **boldface** are unique to this catalog.

ORDERING INSTRUCTIONS

1. Write out order on separate sheet of paper if Order Form is missing. Include part no., quantity, and price of each item. **Include your phone no., full name and return address. DO NOT SEND CASH. NO CREDIT CARD ORDERS ACCEPTED.**
2. **California residents only** add sales tax: 7.75% in Orange County, 6.25% elsewhere.
3. **Add shipping fee of \$4.25** to all orders, except for faster Red, Orange & Blue Label services and international orders, which require extra charges.
4. **C.O.D. fee is \$4.75** (C.O.D. = "Cash On Delivery")
5. All international orders must be prepaid by International Money Order in US funds.
6. Mail order to: **Associated Electrics, Inc.**
3585 Cadillac Ave.
Costa Mesa, CA 92626 USA
7. Or call (714) 850-9342. **Please have your order ready before calling.** Or FAX: 714-850-1744. **Include your phone no., full name and return address.**

RC10DS COMPETITION KITS

8080	RC10DS SPORT KIT Complete bushing kit, including stock motor, mechanical speed control, and all wiring.	1	285.00
8081	RC10DS SPORT KIT Complete bushing kit, including stock motor, mechanical speed control, and all wiring.	1	285.00
8085	RC10DS RACER KIT, ball bearing kit without body, motor, resistor, or wiring. Requires body specifically designed for RC10DS chassis.	1	325.00
8089	RC10DS CONVERSION KIT. Contains front and rear suspension arms, front and rear shocks, front and rear shock brackets, front kickup plate, front bulkhead, racing front and rear wheels, pneumatic ProLine racing tires, anti-roll bars and all necessary hardware. Does not include body. For all RC10's and RC10T's with aluminum chassis. Not for RC10B2 or RC10T2.	1	135.00

ELECTRONIC SPEED CONTROL

Associated is the exclusive importer for North and South America of the LRP digital electronic speed control. This speed control uses an actual, digital, miniature computer that results in a state-of-the-art speed control that surpasses every other type available.

LRP 8066	LRP DIGITAL ELECTRONIC SPEED CONTROL, winning speed control for both 2WD & 4WD at the 1995 IFMAR 1/10 Off Road World Championships	1	225.00
LRP 8304	NEW! LRP RUNNER electronic speed control, forward, reverse, EMK brake, w/ thermal protection. Recommended motor: 20 turn or higher wind motor	1	79.95
LRP 8317	NEW! F1 DIGITAL electronic speed control, forward, reverse, EMK brake, w/ thermal protection. Recommended motor: 16 turn or higher wind motor.	1	99.50

LRP 8322	NEW! F1 POWER DIGITAL electronic speed control, forward, reverse, EMK brake, with thermal protection and adj. current limiter. Motor recommendation: 12 turn or higher wind motor.	1	132.00
LRP 8335	NEW! F1 BULLET DIGITAL electronic speed control, forward reverse, EMK brake, with thermal protection and adj. current limiter. Recommended motor: No Limit.	1	175.00
LRP 8346	NEW! INDY 200 DIGITAL electronic speed control, forward, EMK brake, with adjustable current limiter & thermal protection. Recommended motor: 13 turn or higher wind motor.	1	99.50
LRP 8357	NEW! INDY 400 DIGITAL electronic speed control, forward, EMK brake, with adjustable current limiter & thermal protection. Recommended motor: 11 turn or higher wind motor.	1	132.00
LRP 8361	NEW! INDY 600 DIGITAL electronic speed control, forward, EMK brake, with adjustable current limiter & thermal protection.	1	164.00

CLEAR BODIES & ACCESSORIES

See Associated's Pictorial Catalog for full-color pictures of the following bodies

6120	THUNDERBIRD 1991 narrow Super Speedway	1	18.00
6135	fits RC10DS chassis only. (Included in #8080 kit.)	1	18.00
6136	fits RC10DS chassis only	1	18.00
6137	fits RC10DS chassis only. (Included in #8081 kit.)	1	18.00
6138	fits RC10DS chassis only	1	18.00
6163	oval full-fendered	1	18.00
6179	narrow oval stock car	1	18.00
711	REEDY CAR WASH. Great for cleaning gas and electric cars and bodies. Lexan safe and biodegradable. Not for electrical components. 4 oz. bottles sold in cases of 12 only. Price reflects \$6.00 per bottle. (Purchase individual bottles at your hobby shop or race track.)	12	72.00
6180	DRIVER, clear	1	2.00
6190	WING MOUNT, adjustable (Wing-Things)	pr	1.75
6193	ALUMINUM WING MOUNT. Fits .065" and .078" wire	pr	2.50

DECALS

See Associated's Pictorial Catalog for full-color pictures of the following decals

717	REEDY MODIFIED DECALS, 1995 style Reedy Logo, 3 sizes in both black and white (5.5" x 8.5" sheet)	1	2.50
718	REEDY MODIFIED DECALS, 1995 style Reedy Logo, 3 sizes in both fluorescent red and green (5.5" x 8.5" sheet)	1	3.50
2812	LARGE TEAM ASSOCIATED DECAL, black	5	2.50
2813	LARGE TEAM ASSOCIATED DECAL, white	5	2.50
3807	"RC10" DECALS, 3 sizes, fluorescent red & yellow	1	2.00
3817	ASSOCIATED BUMPER STICKERS, 1 large, 1 small. Red, white, blue.	1	4.00
3818	TEAM ASSOCIATED LOGO DECALS, Mylar peel and stick, black	6	1.00

part #	description	qty	price
3819	TEAM ASSOCIATED LOGO DECALS, Mylar peel and stick, white	6	1.00
6196	TEAM ASSOCIATED & MISC. SPONSORS decals, 5 colors	1	2.00
8801	"RC10DS" LOGO DECAL SHEET. Several sizes included. Fluorescent red and yellow with black outlines.	1	2.00
8802	DECAL SHEET FOR #6135 MUSTANG TRANS AM BODY	1	4.00
8803	DECAL SHEET FOR #6136 CAMARO TRANS AM BODY	1	4.00
8804	DECAL SHEET FOR #6137 MERCEDES DTM BODY	1	4.00
8805	DECAL SHEET FOR #6138 BMW DTM BODY	1	4.00

FRONT SUSPENSION & LINKAGE

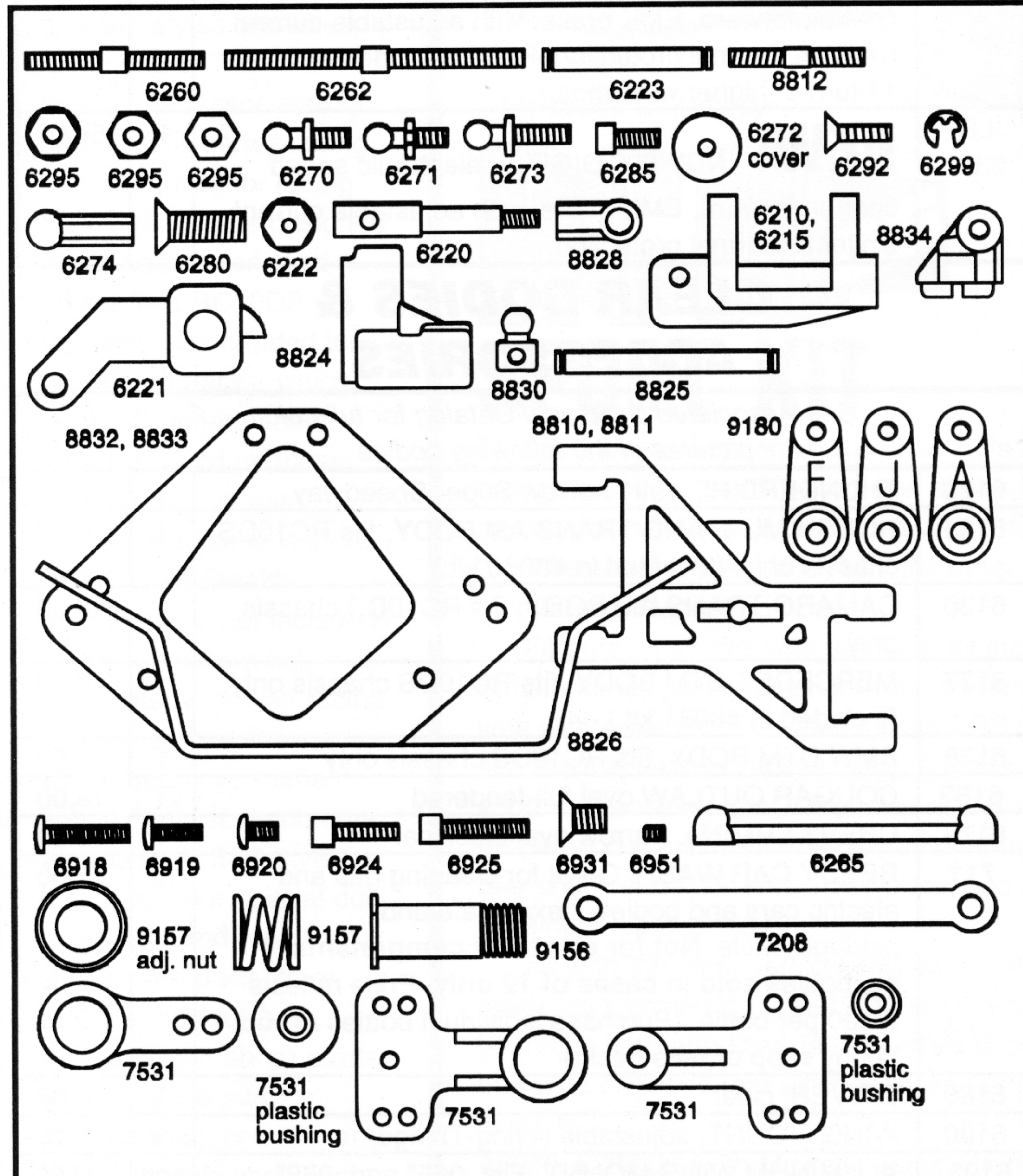

6210	FRONT BLOCK CARRIER, 30° caster	pr	3.00
6215	FRONT BLOCK CARRIER, 25° caster	pr	4.50
6220	ALUMINUM FRONT INLINE AXLES. 5-40 axle thread. Uses #6222 black nylon locknut	pr	6.00
6221	INLINE STEERING BLOCK, for alum. axles	pr	2.00
6222	SELF-THREADING NYLON LOCKNUT, for #6220 axles	8	2.00
6223	KINGPIN, with clips	pr	2.50
8810	DS FRONT A-ARM, molded composite	pr	5.00
8811	DS FRONT A-ARMS, graphite composite. Optional	pr	8.00
8812	DS FRONT/REAR UPPER TURNBUCKLE, 0.75"	pr	3.00
6260	TURNBUCKLE, 1"	2	3.00
6262	TURNBUCKLE, 1.65"	2	3.00
6270	SHORT BALL END, steel (4-40 threaded ball studs), with plastic end caps	2	2.50
6271	SHORT BALL END, steel (4-40 threaded ball studs), with plastic end caps (6-14)	12	10.00

part #	description	qty	price
6273	LONG BALL END, steel (4-40 long threaded ball studs), with plastic end caps. 1/10" longer thread than #6270	2	2.50
6272	BALL CUP DUST COVER	28	2.00
6274	BALL CUP, spares for 6270, 6271, nylon	14	5.00
7208	FRONT BULKHEAD ALUMINUM SUPPORT	1	1.50
8826	DS FRONT ANTI-ROLL BAR KIT	1	8.00
8828	DS ROLL BAR CUP	2pr	2.00
8830	DS ROLL BAR PIVOT, aluminum, with set screw	2	4.00
8832	DS FRONT SHOCK STRUT, fiberglass	1	7.00
8833	DS FRONT SHOCK STRUT, graphite	1	12.00
8834	DS FRONT ARM/SHOCK MOUNT	pr	1.50
9156	SERVO SAVER HUB, threaded	1	2.50
7531	SERVO SAVER, plastic parts	set	2.50
9157	SERVO SAVER SPRING & ADJUSTING NUT	1	2.00
9180	SERVO HORNS, molded (1 ea. fits Airtronics, Futaba, or JRpropo)	1	2.50
6265	DRAG LINK. One-piece replacement of the standard ball cups-and-turnbuckle linkage.	1	2.00
8833	DS FRONT SHOCK STRUT, graphite. Optional	1	12.00
8824	DS FRONT BULKHEAD	1	4.00
8825	DS FRONT INNER HINGE PIN	pr	3.00
6280	8-32 X 1/2 ALUM. FLAT HEAD screw	16	2.00
6285	4-40 X 1/4" SOCKET HEAD Cap Screw	12	2.00
6292	4-40 X 3/8" FLAT HEAD SOCKET screw	6	2.00
6295	4-40 NUT, 6 each plain nut, nylon and steel locknut	18	2.00
6299	E-CLIP, for 1/8 shaft	12	1.00
6918	BUTTON HEAD Socket screw, 4-40 X 1/2"	6	2.00
6919	4-40 X 5/16 BUTTON HEAD Socket Screw	6	2.00
6924	4-40 X 3/8" SOCKET HEAD Cap Screw	6	2.00
6925	SOCKET HEAD Cap screw, 4-40 X 1/2"	6	2.00
6920	BUTTON HEAD Socket screw, 4-40 X 3/16"	6	2.00
6931	FLAT HEAD Machine screw, 8-32 X 1/4"	6	1.00
6951	4-40 X 1/8" SET SCREW, with wrench	6	2.50

CHASSIS PARTS

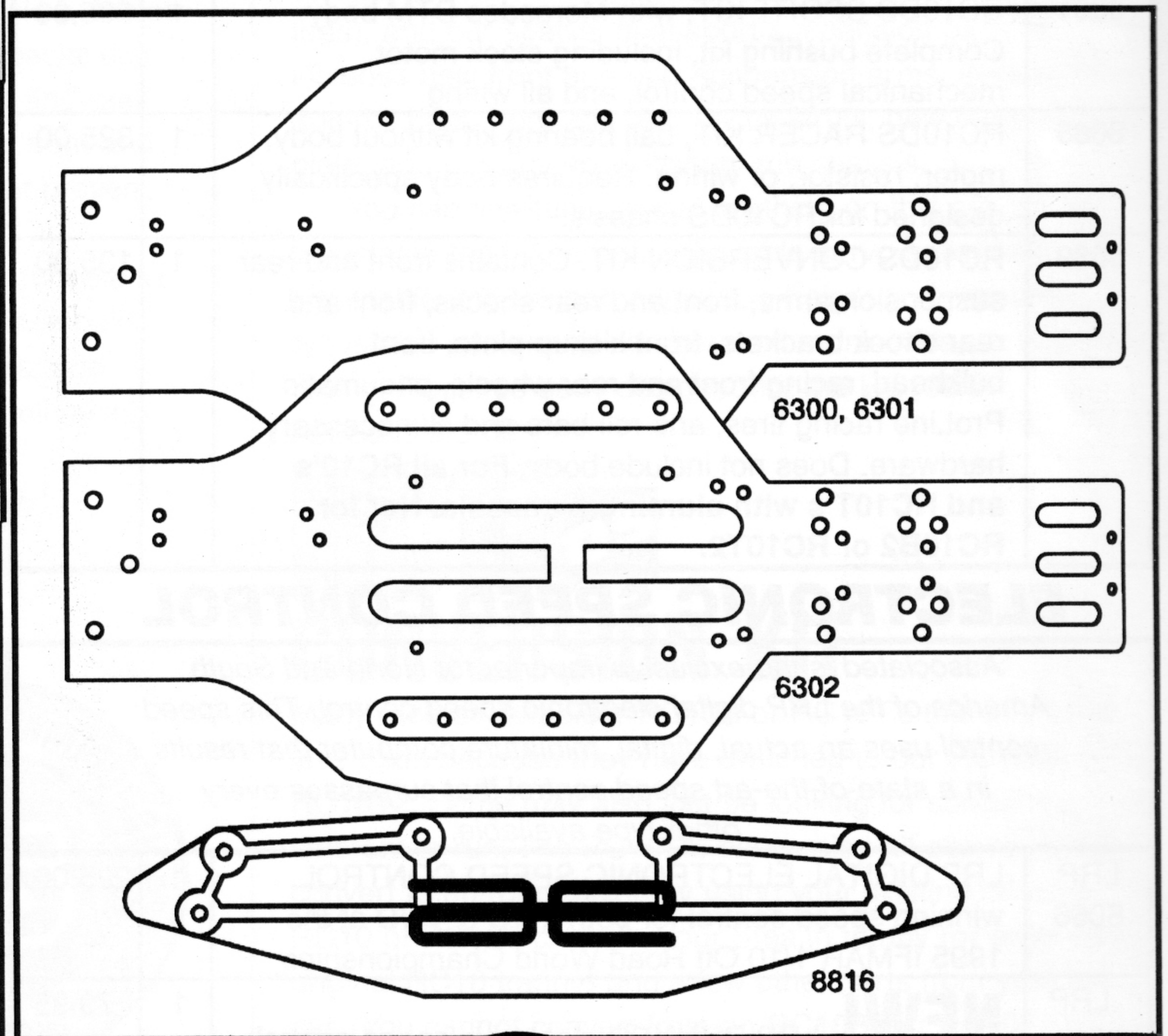

part #	description	qty	price
--------	-------------	-----	-------

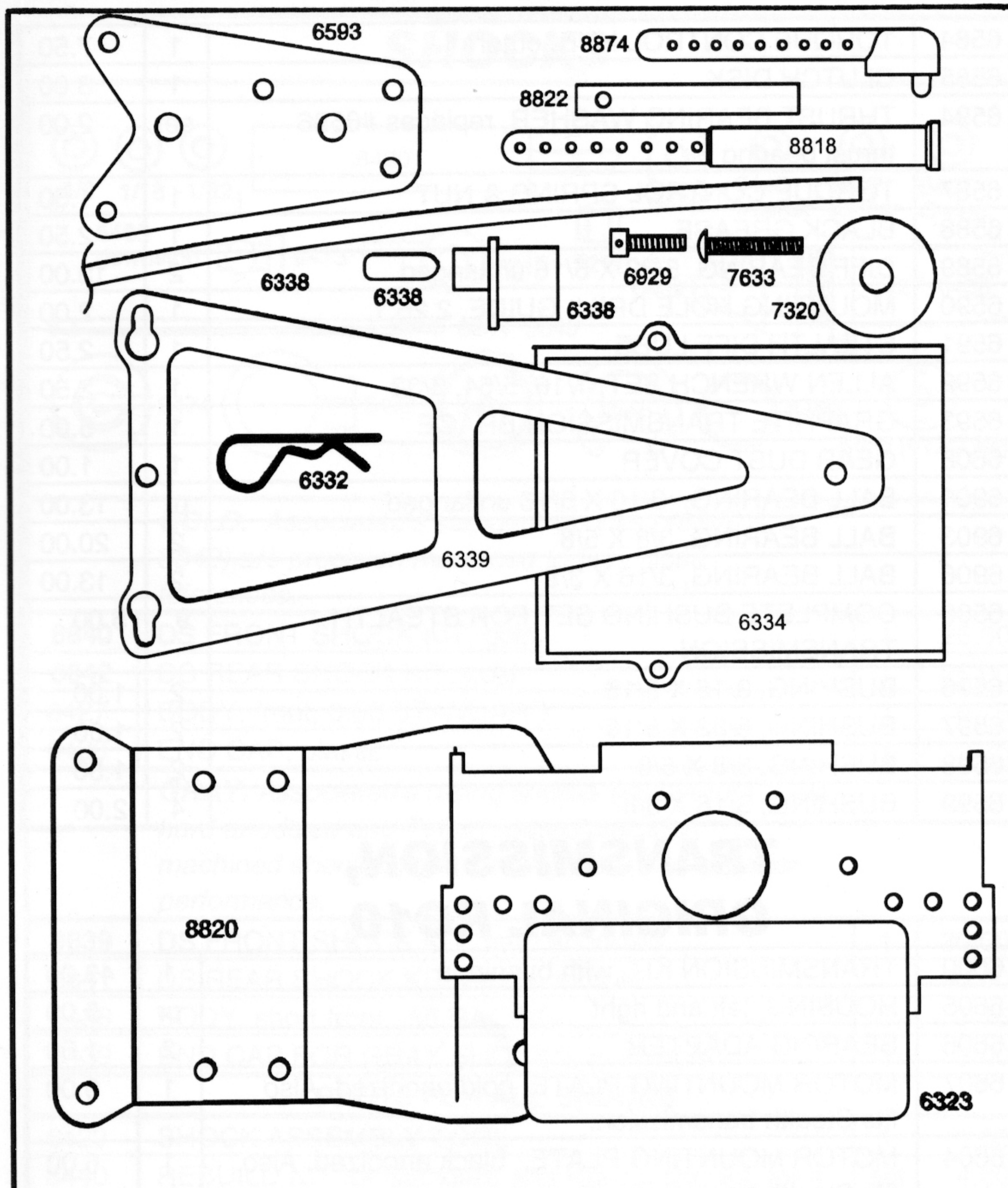

6300	CHASSIS TUB, gold anodized	1	35.00
6301	CHASSIS TUB, black anodized	1	37.00
6302	CHASSIS TUB, hard anodized black and milled, new stronger aluminum material	1	39.00
6312	CLEAR CHASSIS PROTECTIVE SHEET to protect the chassis finish, 6 1/2" X 18"	1	6.50
6323	REAR BULKHEAD, new updated design	1	4.00
6325	TRANSMISSION BRACE	1	2.00
6593	GRAPHITE TRANSMISSION BRACE for Stealth tranny only	1	5.00
6332	HOOD PIN	6	.75
6334	BATTERY CUP, w/straps, hardware (6-7)	2	6.00
6335	BATTERY HOLD-DOWN STRAP	pr	2.50
6336	SERVO MOUNT, w/ hardware (bag 6-6)	4	2.00
6338	ANTENNA KIT, with hardware	1	2.00
6339	FIBERGLASS BATTERY HOLD DOWN STRAP for 6-cell battery pack mounted front to rear in chassis	1	7.00
8816	DS FRONT BUMPER	1	4.00
8818	DS FRONT BODY POST	pr	3.50
8820	DS FRONT KICKUP, aluminum, black anodized	1	8.00
8822	DS FRONT NOSE BRACE TUBE	pr	4.00
7306	NOSE PLATE Screw Set	1	2.00
8874	DS REAR BODY MOUNT	pr	3.50
6929	SOCKET HEAD Cap Screw, 4-40 X 3/8" with hole	4	2.00
7320	BODY MOUNT LARGE NYLON WASHER	4	.75
7633	4-40 X 5/8" BUTTON HEAD Socket Screw	6	2.00

part #	description	qty	price
--------	-------------	-----	-------

REAR SUSPENSION

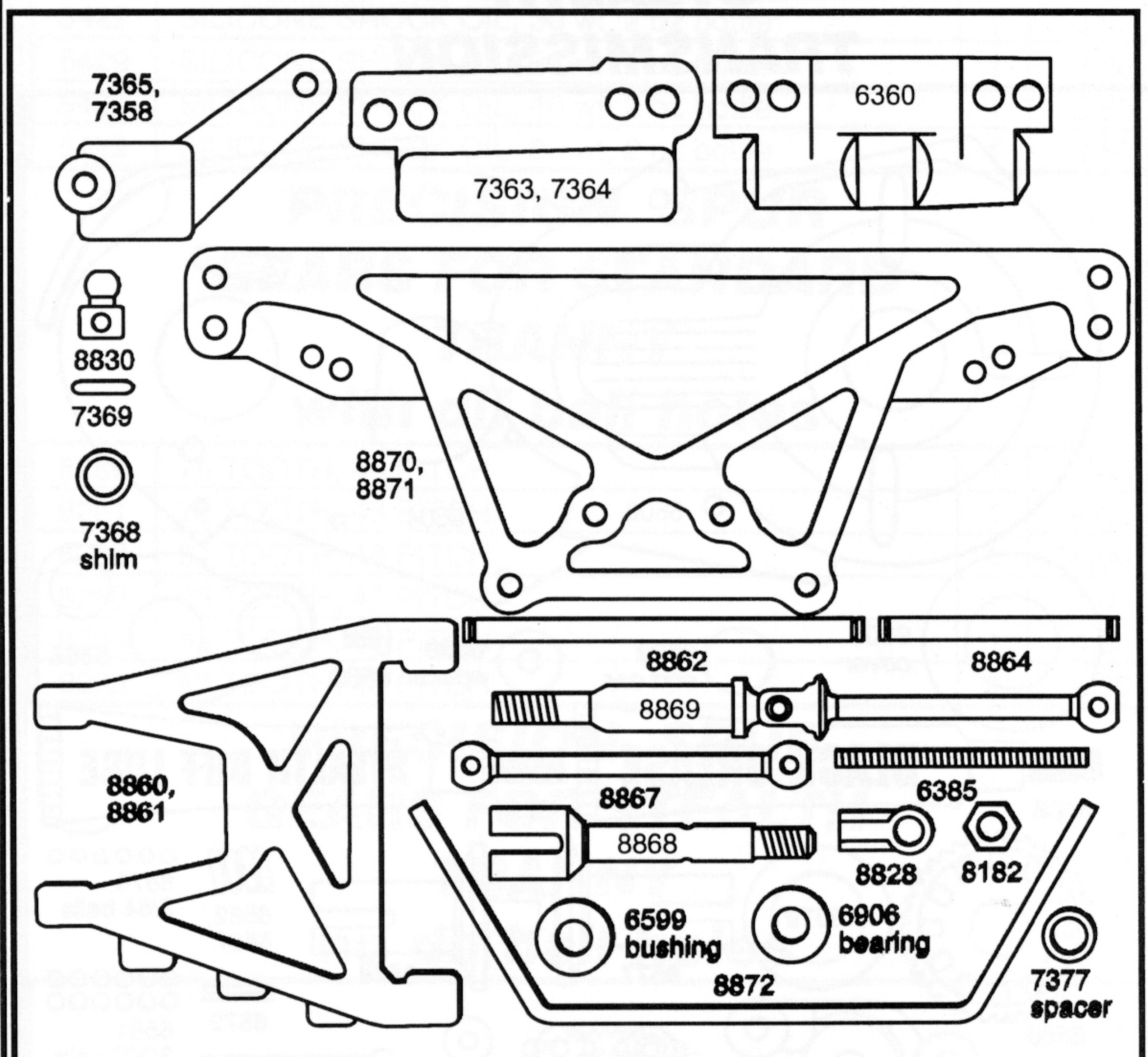

8860	DS REAR A-ARM, molded composite	pr	6.00
8861	DS REAR A-ARM, graphite. Optional	pr	9.00
8862	DS REAR INNER HINGE PIN	pr	3.00
8864	DS REAR OUTER HINGE PIN	pr	3.00
8867	DS DOGBONE	ea	5.00
8868	DS REAR STUB AXLE	ea	5.00
8869	DS UNIVERSALS	pr	35.00
8870	DS REAR SHOCK STRUT, molded composite	1	5.00
8871	DS REAR SHOCK STRUT, graphite	1	7.50
7377	REAR AXLE BEARING SPACER, aluminum. For 3/16" rear axles	2	1.50
8828	DS ROLL BAR CUP	2pr	2.00
8830	DS ROLL BAR PIVOT, aluminum, with set screw	2	4.00
8872	DS REAR ANTI-ROLL BAR KIT	1	7.50
6360	REAR SUSPENSION MOUNT, 1.5° toe-in per side	pr	2.00
7364	REAR SUSPENSION MOUNT, 0° toe-in	pr	2.00
7363	REAR SUSPENSION MOUNT, 3° toe-in	pr	2.00
7365	REAR HUB CARRIER, 0° toe-in per side (uses 1/4 X 3/8 unflanged bearing #7359)	pr	3.50
7358	REAR HUB CARRIER, 3° toe-in per side (uses 1/4 X 3/8 unflanged bearing #7359)	pr	3.50
6385	4-40 X 1 1/4 threaded rod (upper link)	2	1.00
7368	UNIVERSAL SHIMS	14	1.50
7369	AXLE SPRING PINS	4	1.00
6599	BUSHING, 3/16 X 3/8	4	2.00
6906	3/16" X 3/8" BALL BEARING, unflanged	pr	13.00
8182	SPECIAL NUT, 8-32	6	2.00

part #	description	qty	price
--------	-------------	-----	-------

STEALTH TRANSMISSION

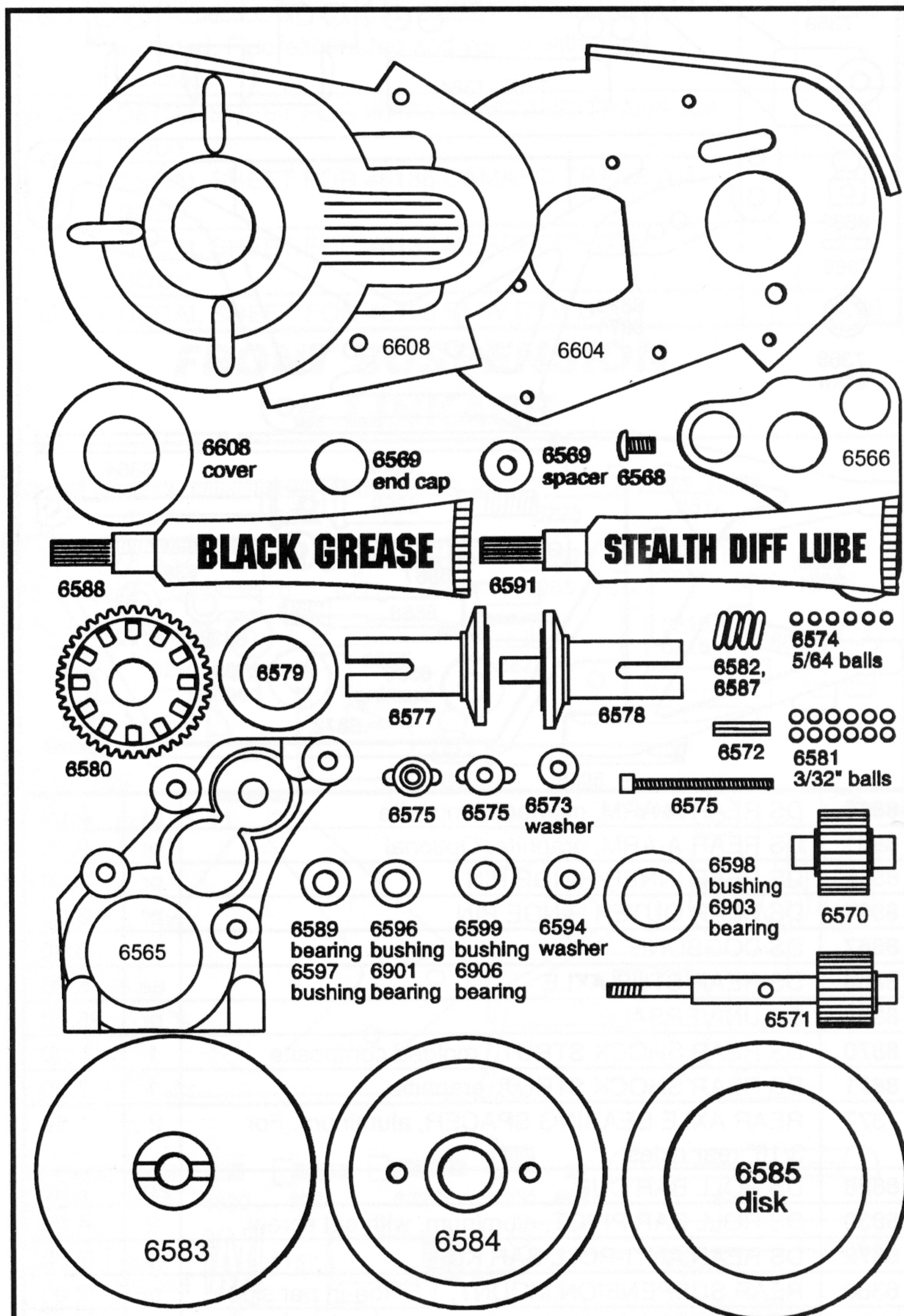

6560	STEALTH 2.25:1 TRANSMISSION KIT, with bearings and Associated Torque Control	1	120.00
6563	COMPLETE TRANNY BALL BEARING SET	9	52.00
6565	TRANSMISSION CASE, left & right sides, for 2.25:1 transmission	set	6.00
6566	FELT GASKET	1	1.50
6567	COMPLETE SCREW SET	10	2.50
6568	SPUR GEAR SCREW	4	1.50
6569	MOTOR PLATE SPACER & END CAP	set	1.50
6570	IDLER SHAFT AND GEAR	set	3.50
6571	DRIVE GEAR/SHAFT Assembly, w/roll pin	set	9.00
6572	DRIVE SHAFT ROLL PIN	6	1.00
6573	DIFF THRUST WASHER	2	3.00
6574	PRECISION THRUST BALL, 5/64" (Replaces #6576)	6	2.00
6575	DIFF THRUST BOLT, THRUST BEARING COVER, dogbone spacers & Locking T-nut	1	2.00
6577	DIFF OUTDRIVE HUB, right, 2.25:1	1	7.50
6578	DIFF OUTDRIVE HUB, left, 2.25:1	1	7.50
6579	DIFF DRIVE RING, 2.25:1	2	1.50
6580	DIFF GEAR, 2.25:1	1	2.50
6581	CARBIDE DIFF BALL, large, 3/32"	12	12.00
6582	DIFF THRUST SPRING	1	1.50
6583	TORQUE CONTROL HUB, inner	1	7.50

part #	description	qty	price
--------	-------------	-----	-------

6584	TORQUE CONTROL HUB, outer	1	7.50
6585	CLUTCH DISK	1	3.00
6594	THRUST BEARING WASHER, replaces #6586 thrust bearing	set	2.00
6587	TORQUE CONTROL SPRING & NUT	1	1.50
6588	BLACK GREASE	1	2.50
6589	DIFF BEARING, 5/32 X 5/16 unflanged	2	13.00
6590	MOUNTING HOLE DRILL GUIDE, 2.25:1	1	2.00
6591	STEALTH DIFF LUBE	1	2.50
6592	ALLEN WRENCH SET, 1/16, 5/64, 3/32	1	2.50
6593	GRAPHITE TRANSMISSION BRACE	1	5.00
6608	GEAR DUST COVER	1	1.00
6901	BALL BEARING, 3/16 X 5/16 unflanged	pr	13.00
6903	BALL BEARING, 3/8 X 5/8	2	20.00
6906	BALL BEARING, 3/16 X 3/8	2	13.00
6595	COMPLETE BUSHING SET FOR STEALTH TRANSMISSION	9	5.00
6596	BUSHING, 3/16 X 5/16	2	1.00
6597	BUSHING, 5/32 X 5/16	2	1.00
6598	BUSHING, 3/8 X 5/8	2	1.50
6599	BUSHING, 3/16 X 3/8	4	2.00

TRANSMISSION, ORIGINAL RC10

6600	TRANSMISSION KIT, with bushings	1	49.00
6605	HOUSING, left and right	pr	5.00
6606	BEARING ADAPTER	2	1.50
6607	MOTOR MOUNTING PLATE, gold anodized. Also fits Stealth transmission.	1	6.00
6604	MOTOR MOUNTING PLATE, black anodized. Also fits Stealth transmission.	1	6.00
6608	GEAR DUST COVER	1	1.00
6609	DRIVE GEAR PIVOT	1	4.00
6610	IDLE GEAR PIVOT	1	3.00
6611	SPINE (CENTER) PLATE	1	2.00
6612	AXLE DRIVE GEAR	1	6.00
6614	IDLE GEAR, black, precision, reinforced	pr	5.00
6617	DIFF TUBE, w/inner hub & Teflon bushings	1	7.00
6618	DIFF SHAFT, with left dif pinion	1	9.00
6619	DIFF BALL, 1/8" Carbide	8	8.00
6620	DIFF PINION, left (small hole)	1	4.00
6621	DIFF PINION, right, (large hole)	1	4.00
6623	DIFF TEFLON BUSHING	2	1.50
6624	DIFF OUTER HUB	1	2.50
6625	DIFF DRIVE RING	2	1.50
6626	DIFF BALL	16	1.50
6627	DIFF THRUST BEARING SET	1	2.50
6587	TORQUE CONTROL SPRING & NUT	1	1.50
6629	DIFF LOCKNUT, 5-40	6	1.00
6630	TRANSMISSION OILITE BUSHING SET	1	3.00
6633	FELT SEAL	2	1.00
6634	TRANSMISSION E-CLIP and screw set	1	3.00
6635	E-CLIPS AND WASHER for #6610	3	1.00
6636	SILICON DIFF GREASE, 1/4 oz tub (Not for Stealth tranny)	1	2.50

(*) denotes non-standard discount item. (**) denotes short discount or net item.

part #	description	qty	price
--------	-------------	-----	-------

SHOCKS

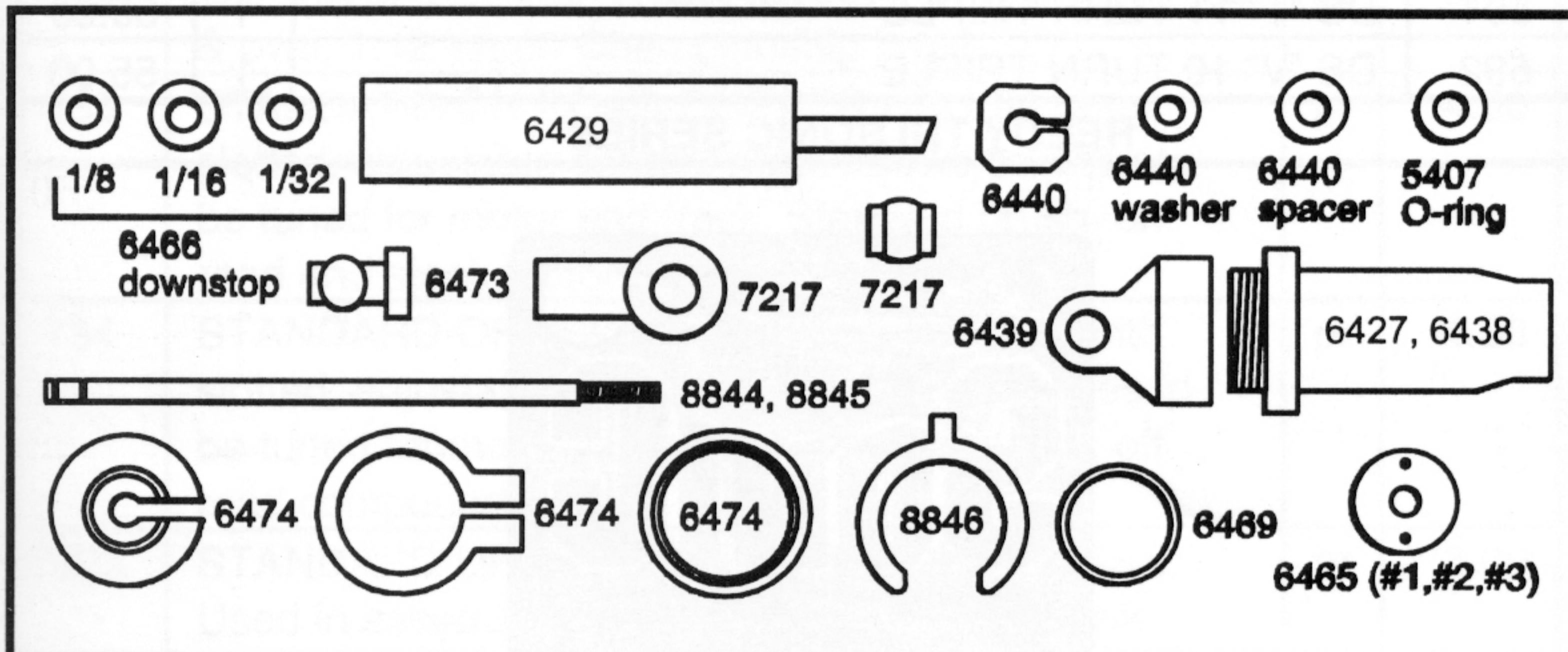

GOLD. Associated's standard shocks (#8840 & 8842) are precision machined to very close tolerances.

8840	DS FRONT SHOCK KIT, gold	1	25.00
8842	DS REAR SHOCK KIT, gold	1	25.00
6427	BODY, front, 0.56 STANDARD	1	6.75
6428	END CAP, plastic	1	2.25

GRAY. Associated's racing shocks (#8834-8841) are hard anodized and Teflon coated precision machined shock bodies for long wear and superior performance.

8839	DS FRONT SHOCK KIT, hard anodized	1	30.00
8841	DS REAR SHOCK KIT, hard anodized	1	30.00
6438	BODY, short front, .56 RACING	1	7.75
6439	END CAP FOR GRAY SHOCKS, aluminum	1	3.00

PARTS FOR ALL SHOCKS

6429	SHOCK ASSEMBLY TOOL	1	1.00
6440	REBUILD KIT for Standard and Racing shocks, for 4 shocks	set	4.00
8844	DS SHOCK SHAFT, .35 stroke	ea	3.00
8845	DS UNOBTAINIUM SHOCK SHAFT, .35 stroke	ea	6.00
8846	DS SHOCK PRE-LOAD SPACERS, four sizes	set	3.00
7217	SHOCK ROD END, nylon w/plastic pivot ball	2	3.00
6464	PISTON, all 0.4 bore shocks	4	3.00
6465	TEFLON SHOCK PISTON, 4 each of #1, #2 & #3. To adjust dampening.	12	3.00
6466	SHOCK DOWNSTOP	6	1.50
5407	RED O-RING, replacements for shock rebuild kits #6440 and #6467	8	2.00
6469	O-RING, shock end-cap to body seals	4	1.50
6473	SHOCK BUSHING	4	1.00
6474	SPRING CLAMP AND CUP, 4 sets	4	3.00

PRECISION RACING SPRINGS

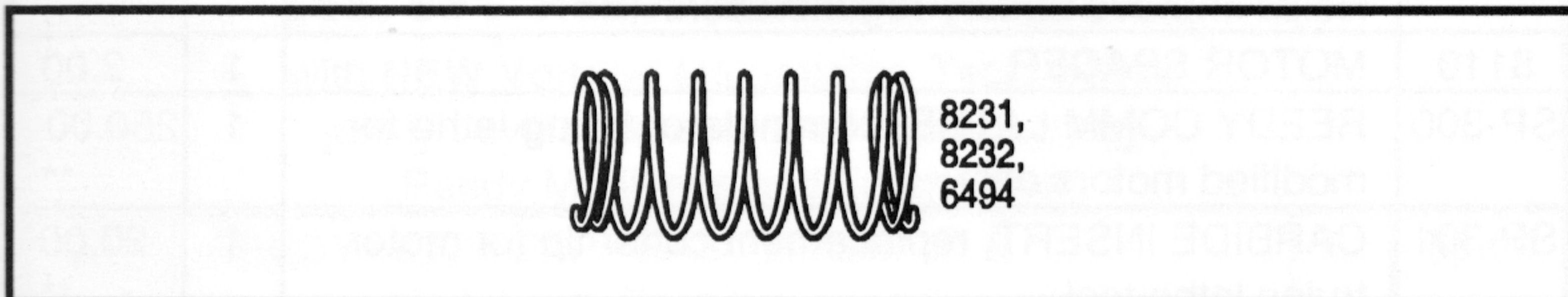

8231	Silver, 1.4" (Also fits 10L)	1	1.25
8232	Black, 1.4"	2	2.50
6494	Green, 1.4"	2	2.50

SHOCK OILS

5412	SHOCK OIL, 50 wt, 1 oz bottle	1	1.25
5413	SHOCK OIL, 40 wt, 1 oz bottle	1	1.25
5414	SHOCK OIL, 30 wt, 1 oz bottle	1	1.25
5415	SHOCK OIL, 20 wt, 1 oz bottle	1	1.25
5416	SHOCK OIL, 10 wt, 1 oz bottle	1	1.25
5420	SILICONE SHOCK OIL, 10 wt, 2 oz bottle	1	3.50
5427	SILICONE SHOCK OIL, 15 wt, 2 oz bottle	1	3.50
5421	SILICONE SHOCK OIL, 20 wt, 2 oz bottle	1	3.50

part #	description	qty	price
--------	-------------	-----	-------

5428	SILICONE SHOCK OIL, 25 wt, 2 oz bottle	1	3.50
5422	SILICONE SHOCK OIL, 30 wt, 2 oz bottle	1	3.50
5429	SILICONE SHOCK OIL, 35 wt, 2 oz bottle	1	3.50
5423	SILICONE SHOCK OIL, 40 wt, 2 oz bottle	1	3.50
5425	SILICONE SHOCK OIL, 80 wt, 2 oz bottle	1	3.50

PRECISION SPUR GEARS FOR STANDARD TRANNY with dif ball holes

8280	75 TOOTH, 48 PITCH	1	4.00
8281	78 TOOTH, 48 PITCH	1	4.00
8282	81 TOOTH, 48 PITCH	1	4.00
8283	83 TOOTH, 48 PITCH	1	4.00
8284	85 TOOTH, 48 PITCH	1	4.00
8285	87 TOOTH, 48 PITCH	1	4.00

PRECISION SPUR GEARS FOR STEALTH TRANNY no dif ball holes

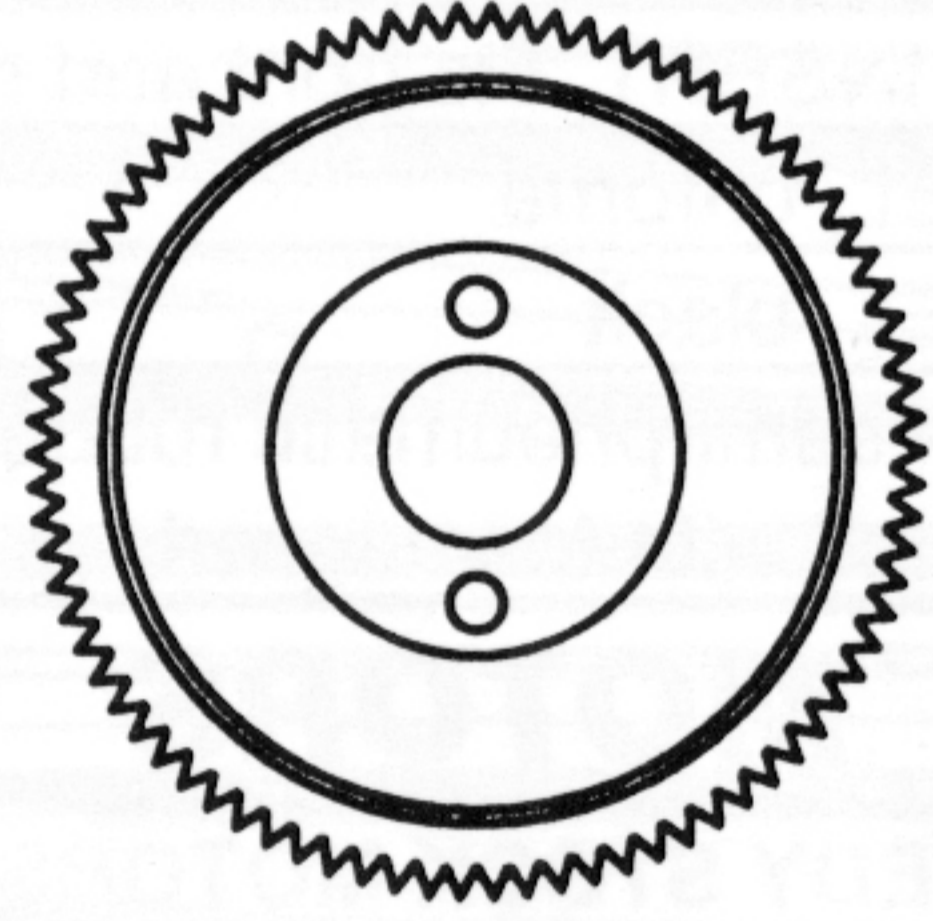

6693	81 TOOTH, 48 PITCH	1	4.00
6694	85 TOOTH, 48 PITCH	1	4.00
6695	87 TOOTH, 48 PITCH	1	4.00
6697	83 TOOTH, 48 PITCH	1	4.00

PRECISION MACHINED RACING PINION GEARS

8252	15 TOOTH, 48 PITCH	1	6.00
8253	16 TOOTH, 48 PITCH	1	6.00
8254	17 TOOTH, 48 PITCH	1	6.00
8255	18 TOOTH, 48 PITCH	1	6.00
8256	19 TOOTH, 48 PITCH	1	6.00
8257	20 TOOTH, 48 PITCH	1	6.00
8258	21 TOOTH, 48 PITCH	1	6.00
8259	22 TOOTH, 48 PITCH	1	6.00
8260	23 TOOTH, 48 PITCH	1	6.00
8261	24 TOOTH, 48 PITCH	1	6.00
8262	25 TOOTH, 48 PITCH	1	6.00
8263	26 TOOTH, 48 PITCH	1	6.00
6951	4-40 X 1/8" SET SCREW, with wrench	6	2.50

STOCK PINION GEARS

6672	14 TOOTH, 48 PITCH	1	4.00
6673	15 TOOTH, 48 PITCH	1	4.00
6674	16 TOOTH, 48 PITCH	1	4.00
6675	17 TOOTH, 48 PITCH	1	4.00
6676	18 TOOTH, 48 PITCH	1	4.00
6677	19 TOOTH, 48 PITCH	1	4.00
6678	20 TOOTH, 48 PITCH	1	4.00
6679	21 TOOTH, 48 PITCH	1	4.00
6680	22 TOOTH, 48 PITCH	1	4.00
6681	23 TOOTH, 48 PITCH	1	4.00

part #	description	qty	price
6682	24 TOOTH, 48 PITCH	1	4.00
6683	25 TOOTH, 48 PITCH	1	4.00
6684	26 TOOTH, 48 PITCH	1	4.00
6951	4-40 X 1/8" SET SCREW, with wrench	6	2.50

WHEELS & TIRES

See Associated's full-color Pictorial Catalog for pictures of all our wheels and tires

ACCESSORIES & SPRAY

6859	TRACTION ACTION TIRE SPRAY. Increases traction and life of tire. 4 oz. bottles sold in cases of 12 only . Price reflects \$6.00 per bottle. (Purchase individual bottles at your hobby shop or race track.)	1 case	72.00
8877	DS HUB CAP, yellow. Incl. front and rear pairs	4	6.00
8878	DS HUB CAP, black. Incl. front and rear pairs	4	6.00
8879	DS HUB CAP, gold. Incl. front and rear pairs	4	6.00

FRONT WHEELS & TIRES

8889	DS FOAM TIRE INSERT, fits front and rear tires	4	3.00
8880	DS FRONT WHEEL, chrome	pr	6.00
8881	DS FRONT WHEEL, black	pr	5.00
8885	DS FRONT TIRE, semi-pneumatic rubber, ProLine XTR-M2 compound with foam inserts	pr	11.50
6599	BUSHING, 3/16 X 3/8	4	2.00
6906	3/16" X 3/8" BALL BEARING, unflanged	pr	13.00

REAR WHEELS & TIRES

8889	DS FOAM TIRE INSERT, fits front and rear tires	4	3.00
8890	DS REAR WHEEL, chrome	pr	6.00
8891	DS REAR WHEEL, black	pr	5.00
8895	DS REAR TIRE, semi-pneumatic rubber, ProLine XTR-M2 compound with foam inserts	pr	12.50

MOTORS

REEDY STOCK MOTORS

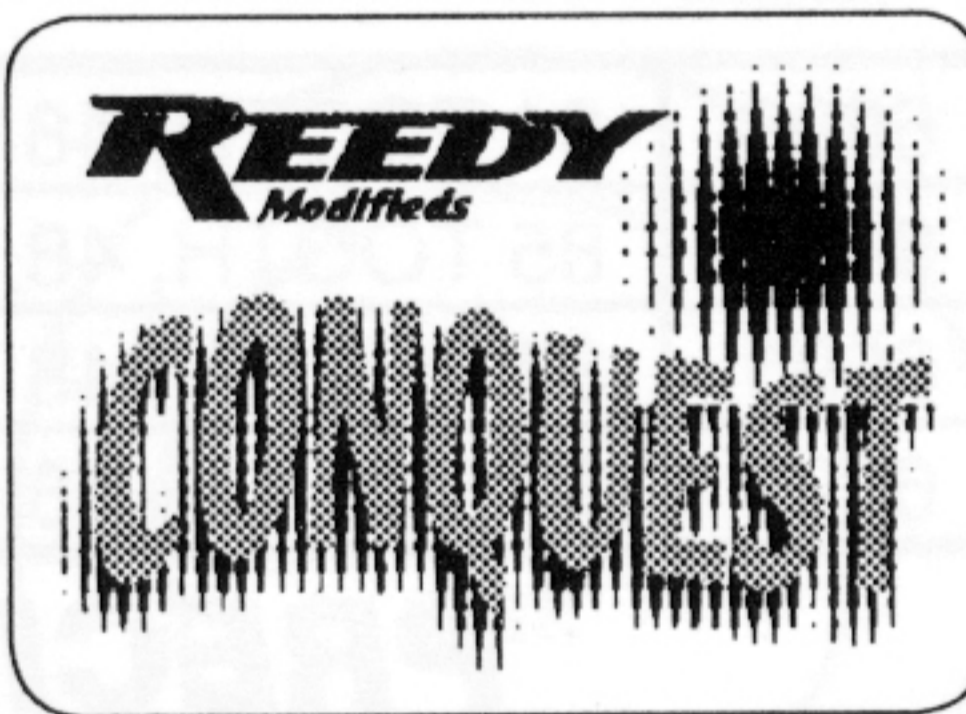

300	REEDY FIRE HAWK STOCK, 27 turn/ROAR specification	1	36.00
301	REEDY FIRE HAWK PLUS, dyno sheet included	1	40.00
302	REEDY CONQUEST 27 STOCK, 36°	1	36.00
303	REEDY CONQUEST PLUS, dyno sheet included	1	40.00
580	REEDY DS SPEC MOTOR, 23 turn, 0.8mm wire, 18° fixed timing, bushing, replaceable brushes. Standard, spec stock motor included in #8080 and 8081 DS kits.	1	30.00

REEDY DS MODIFIED COMPETITION MOTORS, #586-592. Designed for Trans Am and touring car racing, each motor is hand wound, dynamically balanced, and assembled complete with adjustable timing and dual ball bearings.



586	DS "Z" 17 TURN TRIPLE	1	55.00
587	DS "B" 15 TURN TRIPLE	1	55.00
588	DS "A" 14 TURN TRIPLE	1	55.00
589	DS "E" 13 TURN TRIPLE	1	55.00

part #	description	qty	price
590	DS "H" 12 TURN TRIPLE	1	55.00
591	DS "T" 11 TURN TRIPLE	1	55.00
592	DS "V" 10 TURN TRIPLE	1	55.00

REEDY TRI SONIC SERIES



310	TRI SONIC "S" on road, 12 double	1	90.00
311	TRI SONIC "I" on road, 12 turn quint	1	90.00
312	TRI SONIC "M" on road, 13 double	1	90.00
313	TRI SONIC "C" on road, 13 triple	1	90.00
314	TRI SONIC "D" on road, 14 quad	1	90.00
315	TRI SONIC "B" on road, 15 triple	1	90.00
316	TRI SONIC "V" on road, 16 quint	1	90.00
317	NEW! TRI SONIC "O" 11 turn double	1	90.00
318	NEW! TRI SONIC "P" 13 turn quint	1	90.00
319	NEW! TRI SONIC "A" 14 turn quint	1	90.00
320	NEW! TRI SONIC "B" 15 turn quint	1	90.00
321	NEW! TRI SONIC "X" 10 turn quad	1	90.00

MOTOR ACCESSORIES

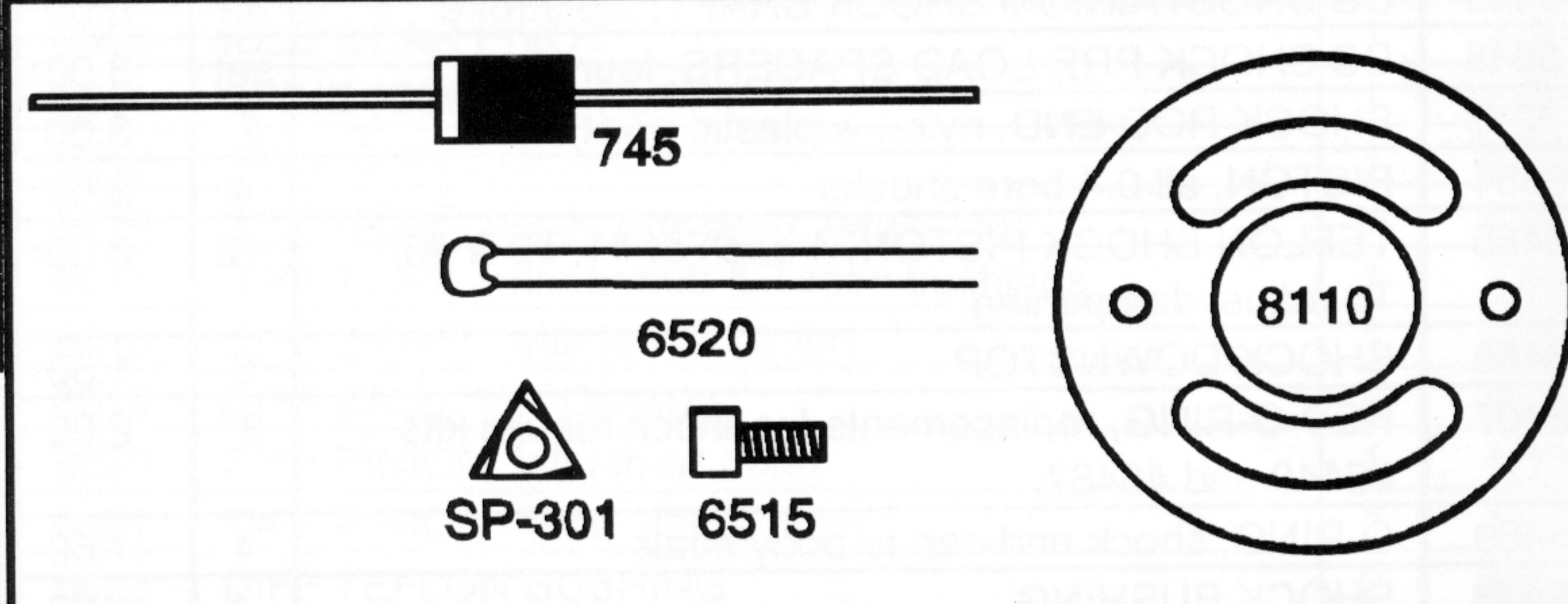

6515	MOTOR MOUNTING SCREW, 3mm metric	4	1.00
6520	CAPACITORS, noise suppression, 0.10 uf.	2	2.00
745	SCHOTTKY DIODE, special diode for high frequency motors. Brakes run cooler and work more effectively. Helps improve battery regeneration.	2	5.25
8110	MOTOR SPACER	1	2.00
SP-300	REEDY COMM LATHE, commutator truing lathe for modified motors only	1	250.00**
SP-301	CARBIDE INSERT, replacement cutter tip for motor truing lathe tool	1	20.00**
SP-302	LATHE BATTERY PACK, 5 cell (6 volt) for use as a lathe power source	1	20.00**

FOR STOCK, DS MODIFIED, and other small commutator motors

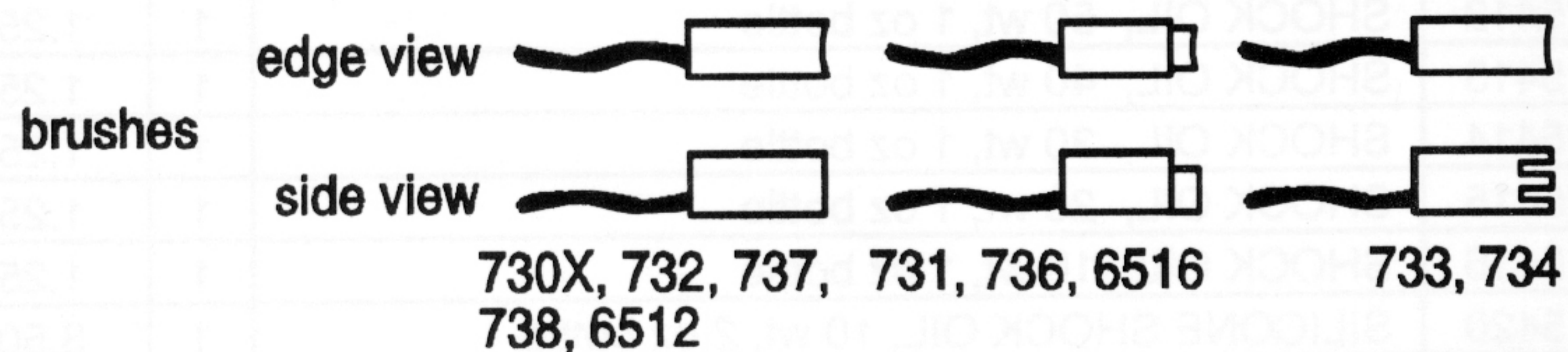

730X	ULTRA-BRUSH for on-road use. Low resistance, long life	pr	3.00
------	--	----	------

(*) denotes non-standard discount item. (**) denotes short discount or net item.

part #	description	qty	price
731	ULTRA BRUSH, CONTOUR CUT, for on-road use. low resistance, long life.	pr	4.50
732X	ON ROAD COMPETITION BRUSH, 1:12 & 1:10 road & oval, 1:12 World Championship brush	pr	3.00
733	STANDARD ON ROAD CLIPPER BRUSH, with slotted, adjustable contact area. Allows brushes to be tuned for motor and track. Standard brush, on road and stock motor compound	pr	4.50
734	STANDARD OFF ROAD CLIPPER BRUSH, with slotted, adjustable contact area. Allows brushes to be tuned for motor and track. Standard brush, off road compound	pr	4.50
737X	STANDARD UPRIGHT 1:10 OFF ROAD BRUSH. Used in assembly of all Mr., Nova, & Ultra Sonic series motors. Excellent power with good commutator wear.	pr	3.00
6512	BRUSHES, Yokomo motors	pr	3.00
6516	CUT BRUSHES, for Yokomo motors, 6512 compound	pr	4.25
740	COPPER HEAD SPRING, for off road racing	pr	2.50
741	COPPER HEAD SPRING, on road, low resistance, high temperature.	pr	2.50
742	NEW! SONIC MOTOR SPRING, high tension copper clad mat'l. Off road and on road uses. For laydown brush systems.	pr	3.00
765	NEW! STOCK MOTOR BRUSH, new laydown high performance compound	pr	3.00
766	NEW! STOCK MOTOR BRUSH, VERTICAL CUT, #765 brush compound with single vertical cut. Brush used on Fire Hawk Plus and Conquest Plus.	pr	4.00
6514	BRUSH SPRING for all Yokomo motors	pr	2.00

NI-CAD BATTERIES

650	BATTERY BRAID STRIPS	6	1.50
651	NEW! REEDY BATTERY BARS, silver treated battery bars for assembling individual cells into packs. Low electrical resistance for more power. Higher strength reinforces construction of your pack. Soldering is easier.	6	4.00
652	 652 BATTERY POWER CONNECTOR PINS. Eliminates hassle of soldering battery pack to radio leads. Quick connect/disconnect	5pr	10.00

NEW! REEDY ZAPPERS BATTERIES

with **NEW Voltage Maximizing Technology** jointly developed and used exclusively by Reedy Modifieds and Team Orion

640	REEDY NOVA ZAPPERS, unmatched & unassembled 6-cell. Each cell goes through special high voltage treatment process, giving you high voltage cells in a sport pack.	6	65.00
642	REEDY ZAPPERS, cycled & matched 6-cell with high voltage processing. Recommended for stock class racing and four minute off road racing.	6	90.00
643	REEDY ZAPPERS, cycled & matched 7-cell with high voltage processing.	7	105.00
644	REEDY WC ZAPPERS, cycled & matched premium 6-cell w/high voltage processing. Recommended for on road, oval and truck competition.	6	120.00
645	REEDY NOVA-ZAPPERS, unmatched, but have high voltage. Great for all-around racing.	6	90.00

part #	description	qty	price
646	REEDY ZAPPERS 2000, Incorporates the Sanyo RC2000 batteries and VMT. Recommended for off road racing and stock class racing.	6	115.00
647	REEDY WC ZAPPERS 2000, the top percentage of cells cycled, voltage processed, and matched. Recommended for on road racing and sex cell truck racing.	6	130.00
NOVA SERIES 1700 mAH SCRC			
636	NOVA, 6 cell matched pack, 1700 mAH SCRC-SP cells, for off road or club level on road.	1	61.50
637	NOVA 7 cell matched pack, 1700 mAH SCRC-SP cells, for off road or club level on road.	1	71.75

ELECTRICAL

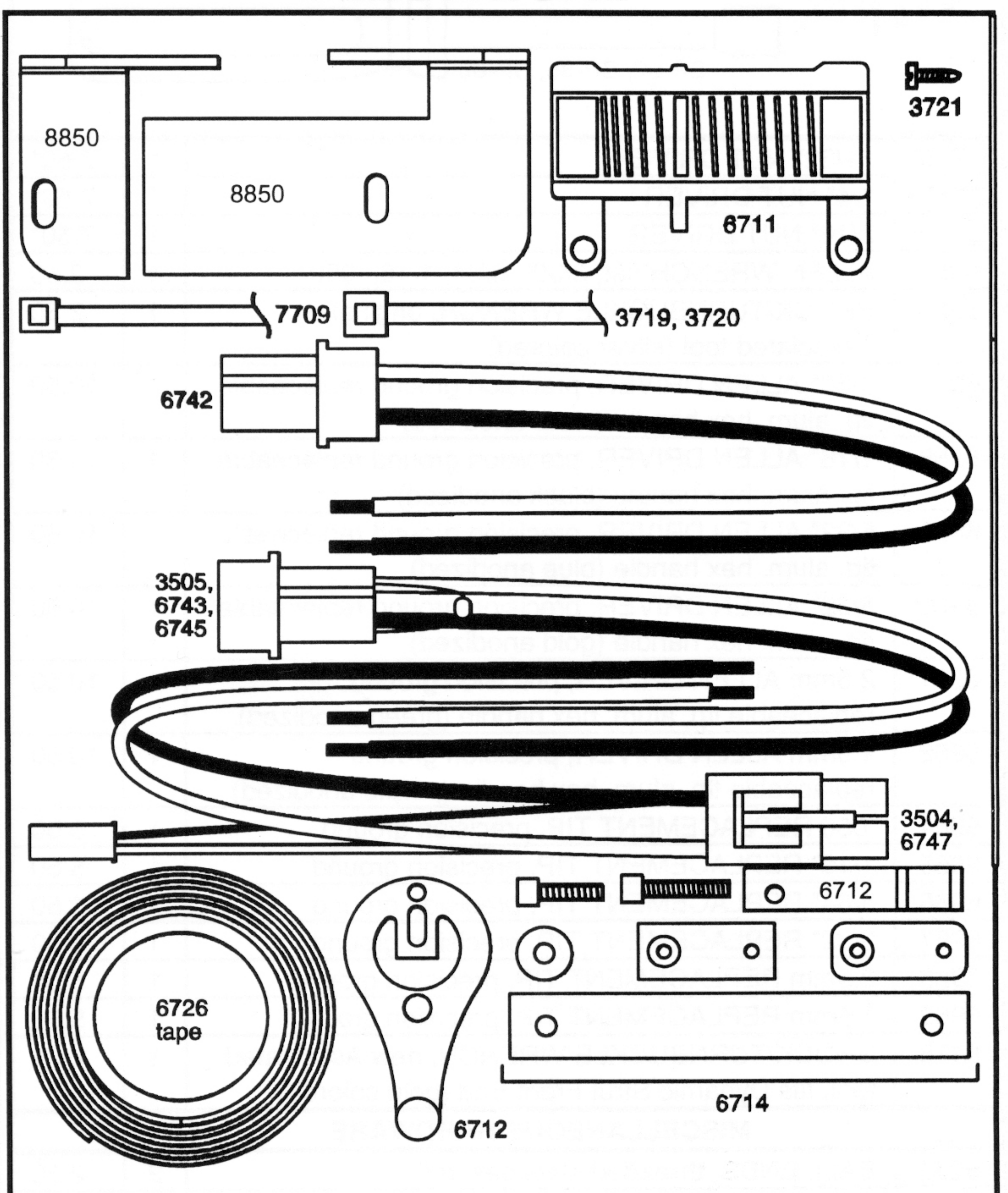

3504	MOTOR CONNECTOR, JST type	pr	1.00
3505	MOTOR CONNECTOR, AMPS type	pr	2.00
3715	RADIO DROPPING DIODE	2	1.00
3721	SELF-TAPPING SCREW, 2-56 X 1/4"	12	1.00
3737	16 GAUGE STRANDED, SUPERFLEX WIRE, high temp. silicon rubber insulation. 2 ft. of orange, 2 ft. of black	2	5.00
6726	NEW IMPROVED SERVO TAPE, black roll, same adhesion, but easier to remove	36"	2.50
7709	NYLON WIRE TIES, 4 inch each	12	1.25
3719	NYLON WIRE TIE, 6" heavy duty	12	2.00
3720	NYLON WIRE TIE, 8" heavy duty	12	2.00
7527	THROTTLE SERVO MOUNTS, MOLDED	2pr	2.50
6711	RESISTOR, throttle control, Yokomo	1	15.00
6712	WIPER, throttle control	2	2.50
6714	BYPASS KIT, for throttle resistor	1	3.50
3736	FAST-CHARGE CORD, 6-cell packs	1	5.50
6742	CONNECTOR, 2 male-pin, 7" silicon lead	1	2.50
6743	CONNECTOR, 2 female-pin 7" silicon lead	1	2.50
6744	WIRE HARNESS, input, 3-pin, w/radio diode	1	4.50
6745	WIRE HARNESS, output, 2-pin, with motor capacitor	1	3.00

part #	description	qty	price
6746	ADAPTER, Tamiya battery to RC10 or charger	1	4.00
6747	WIRE HARNESS, output, Tamiya plug with B.E.C. connector	1	3.00
8850	DS RESISTOR BRACKET, alum., black anodized	1	7.00

TOOLS & HARDWARE

TOOLS

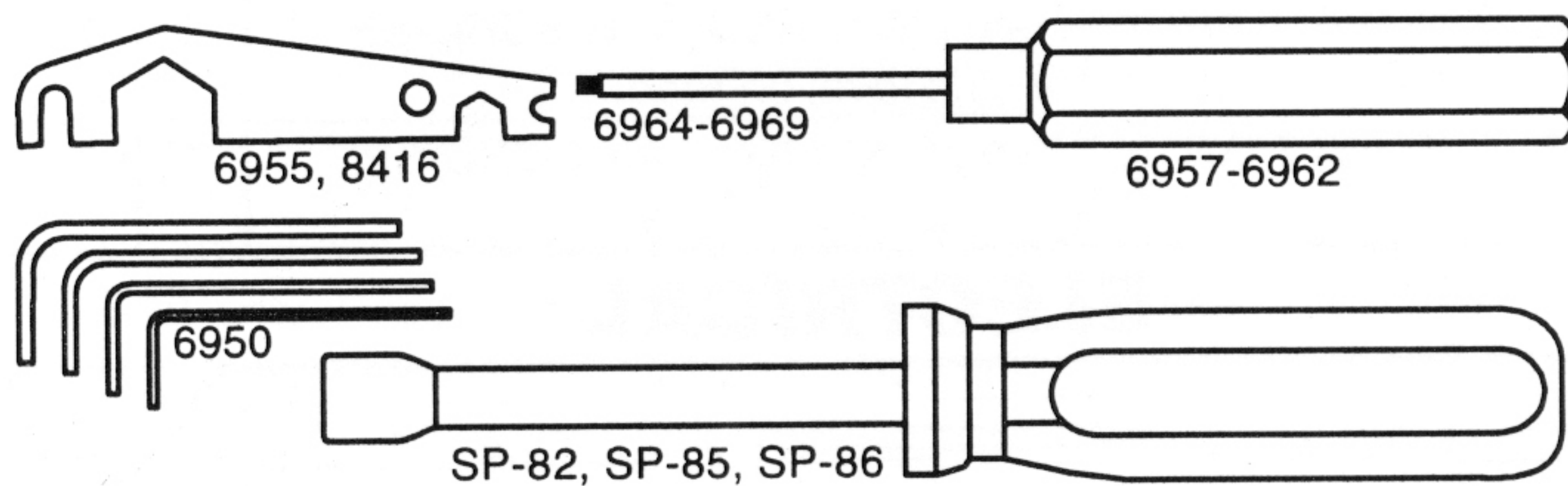

SP-82	11/32" NUT DRIVER	1	7.50*
SP-85	1/4" NUT DRIVER	1	7.50*
SP-86	3/16" NUT DRIVER	1	7.50*
6950	ALLEN WRENCH set, 3/32", 5/64, 1/16, .050	4	2.50
6955	SHOCK/TURNUCKLE WRENCH, original Associated tool (silver colored)	1	2.50
6957	.050" ALLEN DRIVER, precision ground replaceable tip, alum. hex handle (clear anodized)	1	10.50
6958	1/16" ALLEN DRIVER, precision ground replaceable tip, alum. hex handle (black anodized)	1	10.50
6959	5/32" ALLEN DRIVER, precision ground replaceable tip, alum. hex handle (blue anodized)	1	10.50
6960	3/32" ALLEN DRIVER, precision ground replaceable tip, alum. hex handle (gold anodized)	1	10.50
6961	2.5mm ALLEN DRIVER, precision ground replaceable tip, alum. hex handle (green anodized)	1	10.50
6962	1.5mm ALLEN DRIVER, precision ground replaceable tip, alum. hex handle (purple anodized)	1	10.50
6964	.050 REPLACEMENT TIP, precision ground	1	5.50
6965	1/16" REPLACEMENT TIP, precision ground	1	5.50
6966	5/64" REPLACEMENT TIP, precision ground	1	5.50
6967	3/32" REPLACEMENT TIP, precision ground	1	5.50
6968	2.5mm REPLACEMENT TIP, precision ground	1	5.50
6969	1.5mm REPLACEMENT TIP, precision ground	1	5.50
8416	SHOCK/TURNUCKLE WRENCH, new Associated tool, fits Dynamic Strut Front End (gold colored)	1	2.50

MISCELLANEOUS HARDWARE

6270	BALL ENDS, threaded steel ball end	2	2.50
6272	BALL CUP DUST COVER	28	2.00
6273	LONG BALL END, steel. #4-40 long threaded ball studs, with plastic ball cups and nuts. .10" longer thread than #6270	2	2.50
6299	E-CLIPS for 1/8" shafts	12	1.00

NUTS

3438	ALUMINUM 8-32 LOCKNUT	3	1.50
4184	4-40 NYLON LOCKNUT	6	1.00
4185	8-32 NYLON LOCKNUT	6	1.00
4449	4-40 LOCKNUT. Gold anodized, small pattern	5	2.50
6222	SELF-THREADING NYLON LOCKNUT, for #6220 axles	8	2.00
6295	4-40 NUT, 6 each plain nut, nylon and steel locknut	18	2.00
6296	8-32 NUT, 6 each aluminum and nylon locknuts	12	3.00
8182	SPECIAL NUT, 8-32. Used for rear suspension mount	6	2.00
6937	ALUMINUM #4 LOCKNUT. Blue anodized	6	3.00
7260	4-40 THIN PLAIN NUT	12	2.00

WASHERS

3216	#4 STEEL FLAT WASHER, 1/8" I.D.	12	1.00
3323	#8 ALUMINUM FLAT WASHER, thick	12	1.50
6936	#4 ALUMINUM FLAT WASHER	10	1.00

part #	description	qty	price
--------	-------------	-----	-------

SCREWS

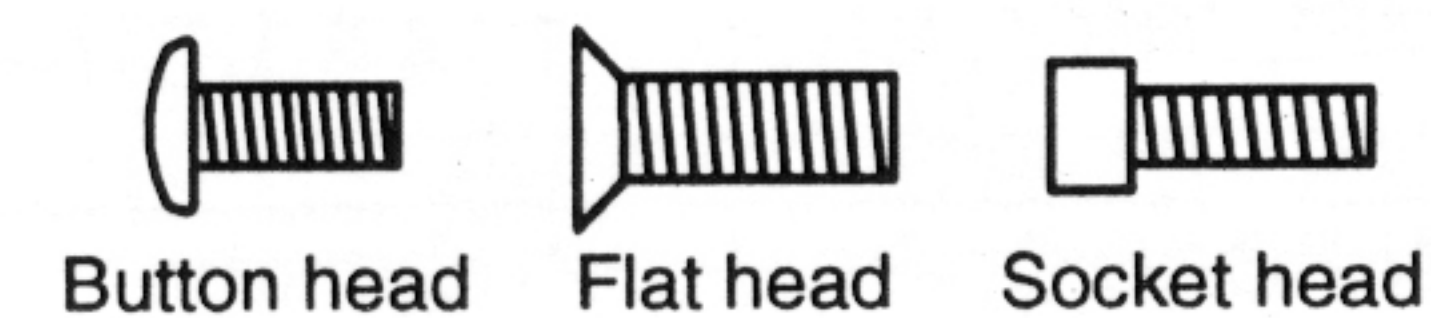

4334	2-56 X 5/16" BUTTON HEAD Socket Screw	8	1.50
6288	4-40 x 1/4" BUTTON HEAD Socket screw	6	2.00
6918	4-40 X 1/2" BUTTON HEAD Socket Screw	6	2.00
6920	4-40 X 3/16" BUTTON HEAD Socket screw	6	2.00
6919	4-40 X 5/16" BUTTON HEAD Socket Screw	6	2.00
7633	4-40 X 5/8" BUTTON HEAD Socket Screw	6	2.00
6931	8-32 X 1/4" FLAT HEAD Machine Screw	6	1.00
6280	8-32 X 1/2" ALUM. FLAT HEAD Screw	16	2.00
6291	4-40 X 1/4" FLAT HEAD Socket Screw	6	2.00
6933	4-40 x 5/16" ALUM. FLAT HEAD SOCKET Cap Screw	6	2.00
6292	4-40 X 3/8" FLAT HEAD Socket Screw	6	2.00
6934	4-40 x 3/8" ALUM. FLAT HEAD SOCKET Cap Screw	6	2.00
6922	4-40 X 1/2" FLAT HEAD Socket Screw	6	2.00
6938	4-40 x 1/2" ALUM. FLAT HEAD SOCKET Cap Screw	6	2.00
6923	4-40 X 3/4" FLAT HEAD Socket Screw	6	2.00
6284	4-40 x 1/4" ALUM. SOCKET HEAD Cap Screw	12	4.00
6285	4-40 X 1/4" SOCKET HEAD Cap Screw	12	2.00
6932	4-40 X 5/16" SOCKET HEAD CAP Screw	6	2.00
6860	4-40 X 3/8" ALUM. SOCKET HEAD Cap Screw	6	2.50
6929	4-40 X 3/8" SOCKET HEAD Cap Screw, with hole	4	2.00
6924	4-40 X 3/8" SOCKET HEAD Cap Screw	6	2.00
7874	4-40 X 7/16" SOCKET HEAD Cap Screw	8	2.50
6925	4-40 X 1/2" SOCKET HEAD CAP Screw	6	2.00
6926	4-40 X 5/8" SOCKET HEAD Cap Screw	6	2.00
6927	4-40 X 3/4" SOCKET HEAD CAP screw	6	2.00
6928	4-40 X 1" SOCKET HEAD CAP Screw	6	2.00
6935	4-40 X 1" ALUM. SOCKET HEAD CAP Screw	4	3.00
3721	2-56 X 1/4" SELF-TAPPING SCREW	12	1.00
6951	4-40 PINION SET SCREWS with wrench	6	2.50

MISCELLANEOUS

See Associated's Pictorial Catalog for full-color pictures of all items below

CAR CARRIER EQUIPMENT

SP-100	ASSOCIATED CAR CARRIER BOX, cardboard outer box w/locking end flap, unassembled. Includes three 24 x 12 x 6" inner boxes, unassembled (fits inside #SP-415 carrier bag). Due to its large size, an additional \$15.00 must be added to UPS standard shipping charges	1	15.00**
SP-101	INNER BOXES, 24 x 12 x 6", unassembled. Replacement cardboard inner boxes for car carrier box #SP-100	3	5.25**
SP-415	ASSOCIATED CAR CARRIER BAG, black nylon with brass zipper (fits over #SP-100 car carrier box)	1	39.95**

WEARABLES

SP-35	OFF ROAD WORLD TOUR T-SHIRT. Full color; front & back different; 1993 IFMAR World's Championship in Basildon, England on front, and Team's 12 World Championship cars on back. Specify M, L only.	1	11.00*
SP-36	1995 JAPAN OFF ROAD WORLD'S T-SHIRT. Speckled light gray shirt with fluorescent RC10 logo over stylized Japanese theme. Back depicts four previous RC10 World Champion off road cars in full color. Specify M, L only.	1	11.00*
SP-37	REEDY FIRE HAWK T-SHIRT. Fluorescent orange "Fire Hawk" and white Reedy logo on black T-shirt. Printed both sides. Specify XL only	1	11.00*
SP-38	ASSOCIATED B2 T-SHIRT. Full color RC10B2 design on front and back. Specify M, L, XL only.	1	11.00*

(*) denotes non-standard discount item. (**) denotes short discount or net item.

part #	description	qty	price
SP-38 XXL	ASSOCIATED B2 T-SHIRT. Specify XXL.	1	13.00*
SP-400	OFF ROAD WORLD TOUR SWEAT-SHIRT. Same full color designs as #SP-35 T-shirt. Specify L, XL, XXL only.	1	19.95 **
SP-405	ASSOCIATED CAP, baseball style wool/ acrylic blend. Gray with dark blue bill. Embroidered logos front and back. Adjustable fit.	1	15.95 **
SP-410	TEAM ASSOCIATED JACKET, red, white & blue. Fully lined. Specify M, L, XL, XXL, XXXL.	1	59.95 **
VIDEOS			
6973	VHS VIDEO, "R/C Car Racing '91" Learn from watching the world's best R/C drivers compete in the most exciting races in the world--the IFMAR World Championships!	1	19.95
6976	VHS VIDEO, "R/C Car Racing 1994". Highlights from some of 1994's greatest races.	1	19.95
6977	VHS VIDEO, "R/C Car Racing 1995"	1	19.95
6978	NEW! VHS VIDEO, "R/C Car Racing 1996"	1	19.95
6978P	NEW! PAL VIDEO, "R/C Car Racing 1996" Same as #6978, but in international PAL format.	1	19.95

part #	description	qty	price
--------	-------------	-----	-------

REEDY Modifieds

Reedy Modifieds is a leader in superior motors and batteries for R/C cars and trucks. To date, Reedy has powered 17 World Champions—more than all the other motor manufacturers combined.

Serious racers have catapulted his successful Sonic and Ultra Sonic modified motor series into must-have status for race-winning results. His stock and modified motors come in numerous winds to tune your vehicle to any track and temperament.

Mike Reedy's batteries have been favored by racers for years; they come in 6 and 7-cell matched packs.



Sonic2

ment over the old magnets.

No part of this motor was unchanged. The new end bell uses lightweight and temperature-stable, glass-filled nylon. The end bell also features a new self-centering alignment system. This assures optimum armature to magnet symmetry. Also built in is a new brush vibration dampening system. At high RPM's,

Reedy Modifieds has done it again with the release of the Z Series motor. This is an entirely new motor designed from the ground up.

We started with new tooling. This was changed to improve the placement and alignment of the magnets. The can is also a thicker 1.4mm material.

To go with the new can, Reedy used a new magnet material. This material maintains its strength when hot and the magnetic field is stronger at the magnet edge. A major improve-



TriSonic

the brushes begin to bounce and chatter. This robs horsepower. Mike Reedy developed this system to regain this power.

The final update is the armature. The new Sonic 2, large commutator, high torque motor uses an armature with laminations configured to maximize engine torque. At the opposite end, the new TriSonic motor has armature laminations that improve RPM instead of torque. Finally, for the new

Fire Hawk stock motor, Reedy used a combination of the new RPM laminations and armature configuration to improve both RPM and torque.

Try one of these new motors and see why Reedy is the dominant force in all classes.



Fire Hawk

LRP DIGITAL

Totally new digital technology! The LRP Digital Speed Control surpasses every other type of speed control available. It uses a digital miniature computer with simple, push-button setup. This results in significant advantages. It runs so cool that it does not require heat sinks. It does not waste battery power heating the heat sinks. This in turn results in longer run times. You may then gear higher and go faster, and still make the time. The all new Digital Computerized Technology allows the driver to adjust the amount of initial braking to suit both his driving style and the amount of traction on the track.

LRP ICS Digital DIGITAL

LRP's ICS was the first speed control to run so cool, it saved energy and didn't require heat sinks. This also resulted in longer run time and more top speed. There is also a special function which allows faster starts. LRP's Advanced Digital Technology, using finer pulse rates, actually gives the cars more traction in the corners. A simple push-button setup makes it easy to use and understand. The current limiter function is important on slippery tracks and for 1:12 on road racing. #LRP 8066, \$225.00



LRP ICS

FEATURE COMPARISONS

	Input voltage	On-Resistance	PWM Frequency	Current Limiter	Price
LRP8317	4.8 - 8.4V max	0.017 Ohm	2100Hz		99.50
LRP8322	4.8 - 8.4V max	0.009 Ohm	2300Hz	●	132.00
LRP8335	4.8 - 8.4V max	0.0045 Ohm	2500Hz	●	175.00

PRICES SUBJECT TO CHANGE WITHOUT NOTICE.

LRP F1 SERIES

FORWARD + REVERSE

Speed controls with forward and reverse are not new. But the old style forward and reverse speed controls require that you slam it into reverse while you're still going forward in order to slow the car down, and then finally go into reverse. It would be impossible to think about racing effectively with this handicap.

LRP's new F1 series of speed controls allow you to have full proportional throttle and full proportional EMK brake control, just like on the LRP ICS model. In addition, when the car comes to a complete stop, you have full proportional reverse for 5 seconds. Digital microchip controlled, high frequency, single button setup, bec integrated and fully protected, and temperature controlled protection. Another new, higher level of LRP speed controls.



#LRP8317

F1 DIGITAL



#LRP8322

F1-POWER DIGITAL

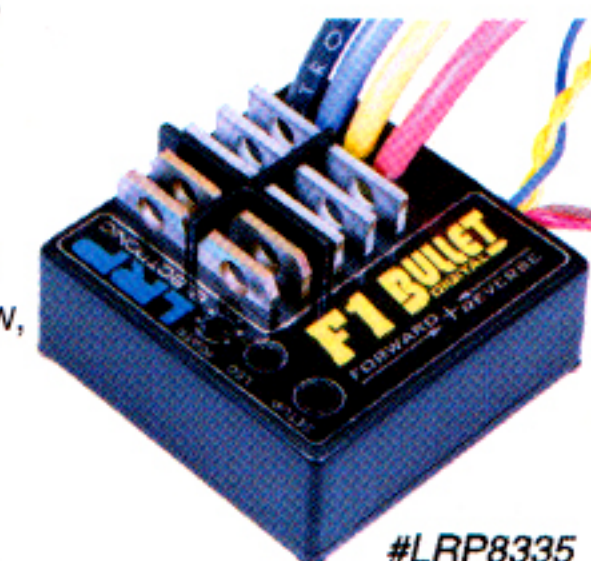

#LRP8335

F1 BULLET DIGITAL