

# 1/12 SCALE CATALOG



- 12 1993 ENGLAND 1/10 Off Road 2WD BRIAN KINWALD
- 11 1992 GRAND RAPIDS, MI 1/12 On Road TONY NEISINGER
- 10 1991 DETROIT, MI 1/10 Off Road 2WD MASAMI HIROSAKA
- 9 1990 SINGAPORE 1/12 On Road CHRIS DOSECK
- 8 1989 AUSTRALIA 1/10 Off Road 2WD MASAMI HIROSAKA
- 7 1988 HOLLAND 1/12 On Road MASAMI HIROSAKA
- 6 1987 POMONA, CA 1/8 Gas RE-PETE FUSCO
- 5 1986 LAS VEGAS, NV 1/12 On Road TONY NEISINGER
- 4 1985 DEL MAR, CA 1/10 Off Road JAY HALSEY
- 3 1984 DENMARK 1/12 On Road Modified TONY NEISINGER
- 2 1982 ANAHEIM, CA 1/12 On Road Stock KENT CLAUSEN
- 1 1977 POMONA, CA 1/8 Gas BUTCH KROELLS

22 TEAM ASSOCIATED

qty	part no.	description	pkg	list price	qty	part no.	description	pkg	list price
-----	----------	-------------	-----	------------	-----	----------	-------------	-----	------------

## ORDERING INSTRUCTIONS

**DO NOT SEND CASH. NO CREDIT CARD ORDERS ACCEPTED.**

California residents add sales tax: 7.75% in Orange County, 6.25% elsewhere.

Add shipping fee of \$4.00 to all orders except Blue & Red Label.

C.O.D. fee is \$4.50 (C.O.D. = "Cash On Delivery": paying purchase price directly to shipper upon delivery instead of prepaying us.)

All international orders must be paid by International Money Order in U.S. funds.

Extra charge for faster Blue & Red Label service.

CATALOG #12L NOV 1994

This free catalog is updated yearly; is yours current?

Prices subject to change without notice.

If you cannot obtain parts from your distributor or dealer, you may order them directly from us. (We're sorry, you cannot order car kits from us.)

## 1:12 ON ROAD CATALOG

**NEW!** LOOK FOR THIS ARROW POINTER TO FIND THE MOST RECENT NEW PRODUCTS IN THIS CATALOG.

Mail order to: **Associated Electrics, Inc.**

3585 Cadillac Ave.

Costa Mesa, CA 92626 USA

Phone orders: (714) 850-9342 FAX orders: 714-850-1744

Please have your order ready BEFORE calling.

You may write your order on a separate piece of paper to save your catalog.

NAME \_\_\_\_\_  
ADDRESS \_\_\_\_\_

TOTAL AMOUNT OF ORDER IN U.S. FUNDS: \$ \_\_\_\_\_

## 1:12 SCALE KIT DESCRIPTIONS

### RC12LS COMPETITION KIT

This kit includes the new Dynamic Strut front suspension for improved steering and stability. It is now easier and faster to make changes to the car's front end for caster, camber and toe-in and toe out to adjust for different track conditions. **NOTE: Requires 2-channel radio, which is NOT included.**

QTY	#4010 BASIC GRAPHITE KIT Complete graphite chassis kit. Includes new Dynamic Strut front suspension and eight ball bearings. DOES NOT INCLUDE BODY, MOTOR OR BATTERIES.	\$235.00
-----	---	----------

### RC12L COMPETITION KIT

The RC12L placed 1st, 2nd, and 3rd at the 1986 World Championships in Las Vegas. It placed 1st, 2nd and 3rd at the 1988 World Championships! **NOTE: Requires 2-channel radio, which is NOT included.**

QTY	<b>NEW!</b> #4303 CLUB RACER 12 KIT Complete graphite chassis kit, including front and rear ball bearings. DOES NOT INCLUDE BODY, MOTOR, BATTERIES OR ELECTRONICS. Available while supplies last.	\$120.00
-----	---	----------

## 1:12 SCALE CATALOG LISTINGS

### CLEAR BODIES

All bodies fit the RC12LS, 12LW, 12L, 12i & Club Racer 12 except where noted.

3151	FERRARI 312PB SPORTS	1	11.00
3152	PORSCHE 30KL SPORTS	1	11.00
3153	PANTERA GT COUPE	1	11.00
3154	FIREBIRD GT COUPE	1	11.00
3158	FERRARI BOXER 365 GT	1	11.00
3159	LIGIER MASERATI GT	1	11.00
3160	TOJ SPORTS	1	11.00
3165	LOLA T600 GTP	1	11.00
3168	MIRAGE GROUP C	1	11.00
3169	JAGUAR GROUP C	1	11.00
3170	FERRARI F1, MODEL 126 (not for RC12LS/LW) Fits Club Racer 12	1	11.00
3171	CORVETTE GTP	1	11.00
3172	CHEVY BERETTA STOCK	1	11.00
3173	LOLA CAN AM	1	11.00
3174	NISSAN GTP-90	1	11.00

### BODY ACCESSORIES

See body decals near end of catalog

3181	DRIVER, clear	1	1.00
3183	WING ONLY, clear	1	1.00
3188	HIGH DOWN FORCE SPORTS WING	1	1.50
3320	FRONT BODY MOUNTS with hardware	pr	1.00
3321	FRONT BODY MOUNT SPACERS with hardware	pr	1.00
3323	THICK ALUM. WASHER, #8 for ride height adjustment	12	1.00
3190	WING KIT with mounts	1	3.50
4329	BODY MOUNT KIT, front and rear	1	5.00
4220	SHORT FRONT BODY MOUNT with hardware	pr	1.00
4222	FRONT BODY MOUNT SPACER, 3/16"	pr	.50
8185	REAR BODY MOUNT, 3.00"	pr	3.50

### CHASSIS PARTS

FOR RC12LS & RC12LW

4420	CHASSIS, FIBERGLASS	1	16.00
4421	UPPER BRACE, FIBERGLASS	1	5.00
4422	LOWER BRACE, FIBERGLASS	1	6.00
4423	DAMPNER BRACE, FIBERGLASS	1	3.00
4424	CHASSIS, GRAPHITE For 12LS/LW (replaces #4425 RC12LW graphite chassis to simplify installation of body mounts for #4400 & #4401 new front suspension kits.)	1	40.00
4428	DAMPNER BRACE, GRAPHITE	1	5.00

FOR RC12L & CLUB RACER 12

4320	CHASSIS, FIBERGLASS	1	15.00
4323	CHASSIS, GRAPHITE	1	40.00
4371	GRAPHITE CHASSIS for oval racing. (1/4" longer wheelbase. Will accept RC12LW shock)	1	40.00

FOR RC12i

4211	CHASSIS PLATE, FIBERGLASS	1	13.00
4144	REAR BRACE/DAMPER PLATE	1	4.00
4174	RADIO TRAY MOUNTING POSTS with hardware	pr	1.50
4175	RADIO TRAY, routed	1	7.00

## DYNAMIC STRUT FRONT END

4400	DYNAMIC STRUT FRONT END KIT, with #4424 RC12LS/LW graphite chassis (above). (NOTE: To use this chassis on an RC12L, you must use the T-bar, T-bar spacer, and lower rear brace from the RC12LS/LW.)	1	79.00
4401	DYNAMIC STRUT FRONT END KIT, without chassis. (Will bolt onto standard 12L & early 12LW without modifications.)	1	39.00
4403	KINGPINS for #4400 & #4401	pr	4.00
4404	TURNBUCKLE, 1.75" for #4400 & #4401	pr	3.00
4424	CHASSIS, GRAPHITE (replaces #4425 RC12LW graphite chassis to simplify installation of body mounts for #4400 & #4401 dynamic strut front end kits.)	1	40.00

#4400, #4401 DYNAMIC STRUT FRONT END  
KIT FOR RC12LS/12LW/12L

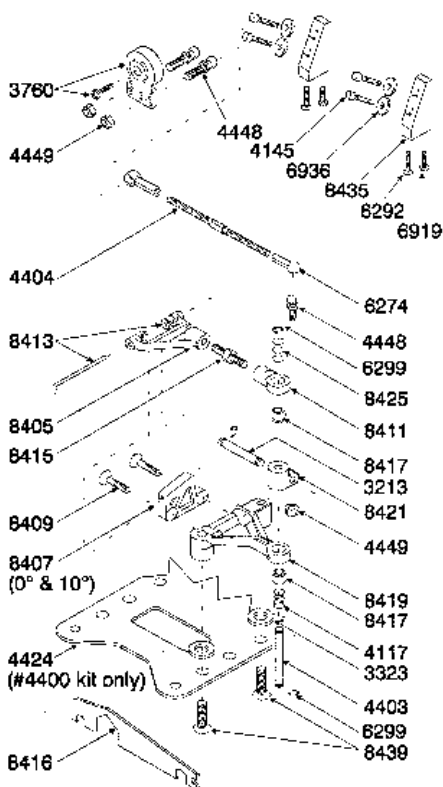

8405	UPPER SUSPENSION ARMS	pr	3.00
8407	UPPER SUSPENSION ARM MOUNTS	4	3.50
8409	UPPER SUSPENSION ARM SCREW, 4-40 X 1/2" FLAT HEAD Shoulder Screw	4	1.50
8411	UPPER SUSPENSION ARM EYELET	pr	1.50
8413	UPPER SUSPENSION ARM HINGE PIN with caster shims	pr	2.00
8415	UPPER SUSPENSION ARM TURNBUCKLES	pr	2.00
8416	TURNBUCKLE WRENCH	1	2.50
8417	UPPER & LOWER SUSPENSION ARM PIVOT BALL	4	6.00
8419	LOWER SUSPENSION ARM	pr	3.50
8421	OFFSET STEERING BLOCK	pr	2.00
3213	STUB AXLE	pr	2.00
4403	KINGPIN, 1:12 scale only	pr	4.00
8425	KINGPIN SHIM	10	1.50
8441	INLINE STEERING BLOCK, for Dynamic Strut Front End, use with #8443 axle.	pr	2.50

8443	ALUM. INLINE FRONT AXLE, w/set screws and axle nuts. Use with #8441 steering blocks. Requires the use of 4 3/16" x 5/16" flanged bearings for front wheels (#6902)	pr	6.00
6902	BALL BEARING, 3/16" x 5/16, flanged, use with #8443 axles	pr	14.00
4116	SPRING, .024	pr	2.00
4117	SPRING, .022	pr	2.00
4113	SPRING, .020 (#4400, 4401 kit spring)	pr	2.00
4114	SPRING, .018	pr	2.00
4119	SPRING, .016 (silver)	pr	2.00
4118	SPRINGS, .014 (black)	pr	2.00
3760	DIRECT MOUNT SERVO SAVER, for Cox, Airtronics, Sanwa servos	1	3.50
8435	SERVO MOUNT WITH SCREWS	1	1.50
4448	ALUM. BALL END AND CUP	2ea	3.00
4449	LOCKNUT, 4-40	5	2.50
6274	BALL CUPS	14	5.00
6262	STEERING TURNBUCKLE, 1.65"	pr	3.00
8439	FLAT HEAD SCREW, 8-32 X 5/8"	4	1.50
3323	THICK ALUM. WASHER, #8, for ride height adjustment	12	1.00
4145	ALUM. SOCKET HEAD CAP SCREW, 4-40 x 5/16"	4	1.50
6292	FLAT HEAD SCREW, 4-40 x 3/8"	6	2.00
6299	E-CLIP	12	1.00
6919	BUTTON HEAD Socket Screw, 4-40 X 5/16	6	2.00
6936	ALUM. WASHER, #4	10	1.00

## SUSPENSION SPRINGS FOR DYNAMIC & STANDARD FRONT ENDS

FOR ALL KITS

4116	SPRING, .024	pr	2.00
4117	SPRING, .022	pr	2.00
4113	SPRING, .020 (#4400, 4401 kit spring)	pr	2.00
4114	SPRING, .018	pr	2.00
4119	SPRING, .016 (silver)	pr	2.00
4118	SPRINGS, .014 (black)	pr	2.00

## STEERING SERVO SAVER

3758	DIRECT MOUNT SERVO SAVER, for Novak NES1A	1	3.50
3760	DIRECT MOUNT SERVO SAVER, for Cox, Airtronics, Sanwa servos	1	3.50
3761	DIRECT MOUNT SERVO SAVER, for splined shaft Futaba servos	1	3.50

## STANDARD FRONT END PARTS

FOR RC12LW, RC12L & CLUB RACER 12

3211	STEERING BLOCKS, RC12L	pr	2.00
3212	KINGPINS, WITH CLIPS	pr	1.50
3213	STUB AXLES WITH CLIPS	pr	2.00
3214	"E" CLIPS, 1/8"	10	1.00
3752	TIE ROD AND LINKAGE KIT	1	3.00
4115	SUSPENSION ARM for I.S. front end	pr	4.00
4127	SHIM SET, 0 and 2 degree	2pr	1.50
4187	FRONT AXLE SPACERS, 1/8" nylon	12	1.00
4327	FRONT END BRACE	1	1.25
4328	FRONT END SCREW SET, 8/32	6	1.00
4430	FRONT END BRACE, FOR 12LW (fits only standard front end)	1	2.00

qty	part no.	description	pkg	list price	qty	part no.	description	pkg	list price
-----	----------	-------------	-----	------------	-----	----------	-------------	-----	------------

FOR RC121				
	4111	INDEPENDENT front suspension kit. Includes suspension arms, stub axles, kingpins, two sets of springs and hardware	1	15.00
	4112	STEERING BLOCKS, .050 offset	pr	4.00
	4115	SUSPENSION ARM for I.S. front end	pr	4.00
	4120	CROSS BRACE for front end	1	1.00
	4122	STUB AXLES	pr	2.00
	4123	KINGPIN for I.S. front end only	pr	4.00
	4124	*C* CLIPS	12	1.00
	4125	LINKAGE	1	2.50
	4126	TIE ROD KIT, four Dubro ball ends, mounting nuts, threaded rod. Eases toe adjust	1	5.00

## T-BAR & DAMPNER PARTS

FOR RC12LS, RC12LW, RC12L & CLUB RACER 12				
	4333	T-BAR PIVOT BALL MOUNTING SCREWS & NUTS	2pr	.50
	4334	PIVOT SOCKET SCREW, 2-56 x 5/16" button head socket screw	8	1.50
	4335	PLASTIC T-BAR PIVOT SOCKET	set	1.50
	4336	STEEL T-BAR PIVOT BALL	1	1.50
	4338	ALUMINUM TUBE COLLAR, LOWER	1	.50
	4340	PLASTIC DAMPNER WASHER	2	1.00
	4341	DAMPNER SPRING	2	1.00
	4127	SHIM SET, 0 and 2 degree	2pr	1.50

FOR RC12LS & RC12LW ONLY				
	4433	T-BAR, .063	1	3.50
	4434	T-BAR, .075	1	3.50
	4435	T-BAR SPACER	1	2.00
	4436	TWEAK SET SCREW, 4-40 X 5/16"	4	1.50
	4440	DAMPNER POST	1	1.50
	4441	DAMPNER STANDOFF	1	1.00
	4442	CHASSIS/DAMPNER BRACE STANDOFF	1	1.50
	4443	SHOCK/ANTENNA MOUNT	1	1.50
	4444	SHOCK KIT	1	18.00
	4445	SHOCK, RED O-RING (for Delta shock)	4	2.00
	4446	SHOCK SPRING	1	1.00
	4448	ALUMINUM BALL ENDS AND CUPS	pr	3.00
	4449	ALUMINUM 4-40 LOCKNUTS	5	2.50

FOR RC12L & CLUB RACER 12 ONLY				
	4330	T-BAR, .062	1	3.50
	4331	T-BAR, .074	1	3.50
	4337	ALUMINUM DAMPNER TUBE	1	1.00
	4342	UPPER DAMPNER TUBE COLLAR	2	.75
	4137	GRAPHITE CHASSIS STIFFENER	1	2.00
	4140	REAR END KIT, with axle motor mounts, bearing adaptors, bushings, motor cam, brace/damper plate, axle, mounting hardware	1	14.00
	4141	REAR AXLE/MOTOR MOUNTS	pr	5.00
	4146	REAR DAMPER WASHER SET	1	1.00
	4170	WIRING HARNESS	1	6.00
	4180	2-56 NUT & SCREW SET, two each of screws, nuts, nylon nuts	1	1.00

## REAR END PARTS

FOR RC12LS, RC12LW, RC12L & CLUB RACER 12				
	897	BALL BEARING, 1/4 X 3/8, flanged (for rear axle)	2	13.00
	3432	DIFFERENTIAL BALL, 1/8"	16	1.00

	3434	THRUST BALLBEARING set, 1/4" ID x 9/16" OD, with thrust washers.	1 set	2.00
	3435	BELLEVILLE WASHER/SHIM set (for #3434 when used on diff)	1 set	.50
	3613	LEFT WHEEL HUB with set screw. Left & right hubs for non-diff axle. (May also use one left hub for diff axle.)	2pr	5.00
	4185	NYLON LOCKNUTS, 8-32	6	1.00
	4345	LEFT HAND PLASTIC BULKHEAD	1	2.50
	4346	RIGHT HAND PLASTIC BULKHEAD (will not fit RC12LW)	1	2.50
	4347	RIGHT HAND ALUMINUM MOTOR BULKHEAD	1	20.00
	4348	AXLE BEARING HEIGHT ADAPTOR, #0	pr	1.00
	4349	AXLE BEARING HEIGHT ADAPTOR, #1	pr	1.00
	4350	AXLE BEARING HEIGHT ADAPTOR, #2	pr	1.00
	4354	RIGHT HAND ALUMINUM BULKHEAD with cooling fins	1	25.00
	4355	REAR AXLE, GRAPHITE	1	15.00
	4359	RIGHT REAR WHEEL/DIFF SPACER	1	3.00
	4360	BEARING MOUNT FOR #4359 SPACER	1	1.00
	6619	CARBIDE DIFF BALLS, 1/8"	8	8.00
	6636	SILICONE DIFF GREASE	1	2.50
	8213	DIFF THRUST CONE with belleville washers (replaces #3434 & 3435 for diff)	1 set	2.00
	8110	MOTOR SPACER	1	2.00
	8321	REAR AXLE SPACERS (replaces #3434 thrust bearing for rear axle)	2	1.50

RC12L & CLUB RACER 12 ONLY				
	4321	UPPER REAR BRACE, FIBERGLASS	1	5.00
	4322	LOWER REAR BRACE, FIBERGLASS	1	5.00
	4324	UPPER REARBRACE, GRAPHITE	1	10.00
	4325	LOWER REAR BRACE, GRAPHITE	1	10.00

RC12LS, RC12LW ONLY				
	4421	UPPER REAR BRACKET, FIBERGLASS	1	5.00
	4422	LOWER REAR BRACE, FIBERGLASS	1	6.00
	4426	UPPER REARBRACKET, GRAPHITE	1	10.00
	4427	LOWER REAR BRACE, GRAPHITE	1	10.00

RC121 & RC12E REAR END PARTS				
	2222	BALL BEARINGS, 1/4" ID x 5/8" OD	pr	12.50
	3413	WING TUBES, ALUMINUM	pr	1.00
	3414	WING TUBE COLLARS, nylon	pr	1.00
	3430	DIFFERENTIAL, complete with special tube steel axle, hub, rings, carrier, gear and balls, thrust bearing, belleville washer, shims, and locknut.	1	15.00
	3431	REAR AXLE FOR DIFFERENTIAL, tubular alloy steel with diff. hub, stud, shims, and belleville washer	1	8.00
	3433	DRIVE RING SET, two hardened and ground rings and one aluminum ring carrier	set	5.00
	3436	ALUMINUM LOCKNUT, 10-32	6	2.50
	3437	DIFF AXLE, GRAPHITE, lightweight graphite (carbon fiber) to replace steel tube with diff hub, stud, shims, and belleville washer	1	15.00
	3438	ALUM. LOCKNUT, 8-32, for #3437 axle	3	1.00
	3440	DIFFERENTIAL, same as #3430 but with graphite (carbon fiber) axle	1	22.00
	3613	REAR WHEEL HUB, left & right hubs for non-diff axle and left hub for diff axle	2	5.00
	3723	THIN WASHERS, #8	12	1.00
	4147	REAR RIDE HEIGHT ADJUSTER	1	3.50

qty	part no.	description	pkg	list price	qty	part no.	description	pkg	list price
-----	----------	-------------	-----	------------	-----	----------	-------------	-----	------------

**STEALTH I DIFFERENTIAL  
FOR ALL 12L SERIES CARS**

	4450	STEALTH DIFF AXLE KIT, fits RC12L/LW/LS, lightweight graphite axle/diff assembly. Requires use of two 1/4" x 3/8" unflanged ball bearings (#7359)	1	22.00
	4451	GRAPHITE AXLE, for #4450 Stealth diff assembly, uses #6579 Stealth diff drive rings	1	18.00
	4452	STEALTH DIFF HUB/WHEEL SPACER, for use with the #4451 Stealth diff axle.	1	3.00
	6579	STEALTH DIFF DRIVE RINGS, for use with #4450 Stealth diff axle assembly	2	1.50
	897	BALL BEARING, 1/4 x 3/8, flanged (for rear axle)	2	13.00
	7359	BALL BEARING, 1/4" x 3/8, unflanged, for use with Stealth I & II diffs.	2	14.00

**NEW! STEALTH II DIFFERENTIAL  
FOR ALL 12L SERIES CARS**

	4455	STEALTH II DIFF AXLE KIT, uses #3609 rear wheel only	1	25.00
	4456	STEALTH II DIFF AXLE, for Stealth II diff only	1	18.00
	4457	STEALTH II WHEEL HUB, left hand only	1	3.50
	4458	STEALTH II DIFF HUB SPACER, right hand only	1	3.50
	4459	STEALTH II BELLEVILLE WASHER, for Stealth II diff only	3	1.00
	4460	SPUR GEAR, 75 tooth 48 pitch, fits Stealth I and II diffs only	1	4.00
	4461	SPUR GEAR, 78 tooth 48 pitch, fits Stealth I and II diffs only	1	4.00
	7359	BALL BEARING, 1/4" x 3/8, unflanged, for use with Stealth I & II diffs.	2	14.00

**RC12LS/LW SHOCK**

	4444	SHOCK KIT, DELTA SHOCK	1	18.00
	4445	O-RING, RED (for Delta shock)	4	2.00
	4446	SHOCK SPRING (for Delta shock)	1	1.00
	4448	ALUMINUM BALL ENDS AND CUPS	2pr	3.00
	4449	ALUMINUM SMALL LOCKNUTS 4-40	5	2.50
	5415	SHOCK OIL, 20 weight, 1 ounce bottle	1	1.25
	5421	SILICONE SHOCK OIL, 20 weight, 2 ounce bottle.	1	3.50

**32 PITCH GEARS**

	6657	PINION GEAR, 11 tooth, 32 pitch	1	3.00
	6659	PINION GEAR, 13 tooth, 32 pitch	1	3.00
	6661	PINION GEAR, 15 tooth, 32 pitch	1	3.00
	6665	PINION, precision 11 tooth, 32 pitch	1	5.00
	6666	PINION, precision 12 tooth, 32 pitch	1	5.00
	6668	PINION, precision 14 tooth, 32 pitch	1	5.00
	6669	PINION, precision 15 tooth, 32 pitch	1	5.00
	6670	PINION, precision 16 tooth, 32 pitch	1	5.00
	3425	SPUR GEAR, 44 tooth, 32 pitch	1	1.50
	3426	SPUR GEAR, 46 tooth, 32 pitch	1	1.50
	3427	SPUR GEAR, 48 tooth, 32 pitch	1	1.50

**PRECISION  
MACHINED 48 PITCH  
PINION GEARS**

	8250	13 TOOTH, 48 PITCH	1	5.00
	8251	14 TOOTH, 48 PITCH	1	5.00
	8252	15 TOOTH, 48 PITCH	1	5.00
	8253	16 TOOTH, 48 PITCH	1	5.00
	8254	17 TOOTH, 48 PITCH	1	5.00
	8255	18 TOOTH, 48 PITCH	1	5.00
	8256	19 TOOTH, 48 PITCH	1	5.00

	8257	20 TOOTH, 48 PITCH	1	5.00
	8258	21 TOOTH, 48 PITCH	1	5.00
	8259	22 TOOTH, 48 PITCH	1	5.00
	8260	23 TOOTH, 48 PITCH	1	5.00
	8261	24 TOOTH, 48 PITCH	1	5.00

**48 PITCH PRECISION  
SPUR GEARS  
with diff ball holes**

	8280	75 TOOTH, 48 PITCH	1	4.00
	8281	78 TOOTH, 48 PITCH	1	4.00
	8282	81 TOOTH, 48 PITCH	1	4.00
	8283	83 TOOTH, 48 PITCH	1	4.00
	8284	85 TOOTH, 48 PITCH	1	4.00
	8285	87 TOOTH, 48 PITCH	1	4.00

**REAR WHEELS AND  
ACCESSORIES**

	3609	<b>NEW!</b> DISHED REAR WHEEL, fits Stealth II diff only	pr	3.50
	3609B	<b>NEW!</b> DISHED REAR WHEEL, BLACK, fits Stealth II diff only	pr	3.50
	3609Y	<b>NEW!</b> DISHED REAR WHEEL, FLORESCENT YELLOW, fits Stealth II diff only	pr	3.50
	3610	SPOKED REAR WHEEL, fits standard diff and Stealth I diff only	pr	3.50
	3610B	<b>NEW!</b> SPOKED REAR WHEEL, BLACK, fits standard diff and Stealth diff I only	pr	3.50
	3610Y	<b>NEW!</b> SPOKED REAR WHEEL, FLORESCENT YELLOW, fits standard diff and Stealth diff I only	pr	3.50
	3615	ALLEN CAP SCREW, 5-40 x 5/8"	6	1.00
	3616	ALLEN SETSCREW, 10-32 x 1/4" w/wrench	6	1.00
	3618	REAR TIRE DONUT, high traction rubber, med. compound, YELLOW	pr	4.00
	3619	REAR TIRE DONUT, high traction rubber, firm compound, GREEN	pr	4.00
	3624	REAR WHEELS/TIRE, mounted/trued, medium, YELLOW	pr	9.50
	3625	REAR WHEELS/TIRE, mounted/trued, firm, GREEN	pr	9.50
	3630	YOKOMO REAR TIRE DONUT	pr	8.50

**FRONT WHEELS AND  
ACCESSORIES**

*NOTE: Rubber is coded with colored paint*

	3649	<b>NEW!</b> DISHED FRONT WHEEL, requires use of NEW #3656 1/8" x 5/16" unflanged ball bearings	pr	3.50
	3649B	<b>NEW!</b> DISHED FRONT WHEEL, BLACK, requires use of NEW #3656 1/8" x 5/16" unflanged ball bearings	pr	3.50
	3649Y	<b>NEW!</b> DISHED FRONT WHEEL, FLORESCENT YELLOW, requires use of NEW #3656 1/8" x 5/16" unflanged ball bearings	pr	3.50
	3650	SPOKED FRONT WHEEL, lightweight, uses standard #3655 1/8" x 5/16 flanged ball bearings	pr	3.50

qty	part no.	description	pkg	list price	qty	part no.	description	pkg	list price
	3650B	<b>NEW!</b> SPOKED FRONT WHEEL, BLACK, uses standard #3655 1/8" x 5/16" flanged ball bearings	pr	3.50					
	3650Y	<b>NEW!</b> SPOKED FRONT WHEEL, FLORESCENT YELLOW, uses standard #3655 1/8" x 5/16" flanged ball bearings	pr	3.50					
	3653	FRONT WHEEL BUSHING	pr	1.00					
	3655	BALL BEARING FOR FRONT WHEEL (two pr required), 1/8" ID x 5/16" OD flanges	pr	12.00					
	3656	<b>NEW!</b> BALL BEARING 1/8" x 5/16" unflanged, fits new #3649 front wheel only	pr	10.00					
	3667	FRONT DONUT, high trac for max steering, GREEN	pr	3.50					
	3669	FRONT WHEEL/TIRE, very high traction, mounted and trued, GREEN	pr	9.00					
	3670	YOKOMO FRONT TIRE DONUT	pr	7.00					
	4187	1/8" FRONT AXLE SPACER, nylon	12	1.00					

## MOTORS

STOCK MOTORS				
	554	FORCE I stock motor, fixed endbell, 27 turns, 22 gage, untweakable 22-24 deg. timing, New 4.9-M magnet with new armature design. ROAR legal for stock class.	1	28.00
	555	FORCE II stock motor, fixed endbell, 27 turns, 22 gage, 36 deg. timing, NEW 4.9 M magnet with new armature design.	1	28.00
	556	MACH I stock motor, with new "Turbo Cooling" feature, ROAR '91 stock motor spec. with 24 deg. timing, comm locking device, 4.95 wet magnet design, 27 turn 22 gage.	1	32.00
	557	MACH II stock motor, with new "Turbo Cooling" feature, 38 deg. timing, 4.95 wet magnet design, 27 turn, 22 gage.	1	32.00

### REEDY MODIFIED, "MR." SERIES

	501	MR. K'S, 17 turn quad, on-road	1	80.00
	502	MR. R'S, 16 turn triple, on-road	1	80.00
	503	MR. D'S, 14 turn quad, 4-cell	1	80.00
	504	MR. C'S, 13 turn quad, 4-cell	1	80.00
	505	MR. J'S, 12 turn quad, paved oval and 4-cell	1	80.00
	506	MR. E'S, 13 turn triple, paved oval and 4-cell	1	80.00
	507	MR. H'S, 12 turn triple, paved oval and 4-cell	1	80.00
	508	MR. A'S, 14 turn triple, 2 & 4WD off-road	1	80.00
	509	MR. L'S, 14 turn double, 4WD off-road	1	80.00
	510	MR. T'S, 11 turn triple, 1:10 paved and dirt oval	1	80.00
	511	MR. N'S 19 turn triple, 2WD off road, 1:12 on road	1	80.00
	512	MR. M'S, 13 turn double, 4WD off road	1	80.00
	513	MR. F'S, 15 turn quad, truck and 2WD off road	1	80.00
	514	MR. B'S, 15 turn triple, truck and 2WD off road	1	80.00
	515	MR. X's, 10 turn quad	1	80.00
	516	MR. S's, 12 turn double	1	80.00
	517	MR. O's, 11 turn double	1	80.00
	518	MR. G's, 11 turn quad	1	80.00
	519	MR. Y's, 10 turn triple	1	80.00
	520	MR. ?'s, 10 turn double, oval, 1:10 off road, 6-cell	1	80.00
	521	MR. Z's, 16 turn double, 1:12 on-road and 2WD. (1:12 scale IFMAR World's motor)	1	80.00
	522	MR. I's, 12 turn single, 6-cell 2WD & 4WD off-road and oval	1	80.00
	523	MR. Q's, 15 turn double. Motor that Top Qualified at the 1:12 Worlds.	1	80.00

REEDY MODIFIED, SONIC SERIES MOTOR				
"Turbo Cooled" modified motors with "M" magnets. See Sonic portion of Motor Accessories section for spring and brushes.				
	525	SONIC "A" 14 turn triple	1	85.00
	526	SONIC "B" 15 turn triple	1	85.00
	527	SONIC "C" 13 turn quad	1	85.00
	528	SONIC "D" 14 turn quad	1	85.00
	529	SONIC "E" 13 turn triple	1	85.00
	530	SONIC "F" 15 turn quad	1	85.00
	531	SONIC "G" 11 turn quad	1	85.00
	532	SONIC "J" 12 turn quad	1	85.00
	533	SONIC "L" 14 turn double	1	85.00
	534	SONIC "M" 13 turn double	1	85.00
	535	SONIC "O" 11 turn double	1	85.00
	536	SONIC "Q" 15 turn double	1	85.00
	537	SONIC "R" 16 turn triple	1	85.00
	538	SONIC "S" 12 turn double	1	85.00
	539	SONIC "?" 10 turn double	1	85.00
	540	SONIC "I" 12 turn single	1	85.00
	541	SONIC "T" 11 turn triple	1	85.00
	542	SONIC "Y" 10 turn triple	1	85.00

### REEDY MODIFIED, NOVA SERIES

	575	NOVA 14 turn double	1	55.00
	576	NOVA 13 turn double	1	55.00
	577	NOVA 12 turn double	1	55.00

### REEDY MODIFIED, ESPRIT SERIES

	580	ESPRIT 14, machine wound mod., 14 turn	1	28.00
	581	ESPRIT 15, machine wound mod., 15 turn	1	28.00
	582	ESPRIT 17, machine wound mod., 17 turn	1	28.00
	583	ESPRIT 23, machine wound mod., 23 turn	1	28.00
	584	ESPRIT PLUS 17, machine wound mod., 17 turn, ball bearing	1	28.00
	585	ESPRIT PLUS 15, machine wound, 15 turn, dry magnets	1	28.00

## MOTOR ACCESSORIES

### FOR ALL MOTORS

	6515	MOTOR MOUNTING SCREW, 3mm metric	4	1.00
	6520	CAPACITOR, noise suppression, 0.10 uf.	2	2.00
	745	SCHOTTKY DIODE, special diode for high frequency motors. Brakes run cooler and work more effectively. Helps improve battery regeneration.	2	5.25

### FOR STOCK, ESPRIT & MR. MOTORS

	730	ULTRA BRUSH, silver compound brush for on-road	pr	3.00
	731	ULTRA BRUSH, contour cut	pr	4.50
	732	ON ROAD COMPETITION BRUSH, 1/12 & 1/10 road & oval, 1/12 World Championship brush	pr	3.00

qty	part no.	description	pkg	list price	qty	part no.	description	pkg	list price
-----	----------	-------------	-----	------------	-----	----------	-------------	-----	------------

**Clipper Brush Series** Clip legs to tune your brush to your motor and track conditions.

Slots allow for increased cooling under heavy load conditions.

733, 734 standard  
763, 764 laydown

	733	STANDARD ON ROAD CLIPPER BRUSH, with slotted adjustable contact area. Allows brushes to be tuned for motor and track. Standard brush, on road and stock motor compound	pr	4.50
	734	STANDARD OFF ROAD CLIPPER BRUSH, with slotted adjustable contact area. Allows brushes to be tuned for motor and track. Standard brush, off road compound	pr	4.50
	736	ULTRA BRUSH, Contour Cut for off road	pr	4.50
	737	STANDARD 1:10 OFF ROAD BRUSH. Used in assembly of all MR. motors. Excellent power with good commutator wear.	pr	3.00
	738	STOCK MOTOR COMPETITION BRUSH, replaces #3512 brush. Best stock brush for all applications.	pr	3.00
	3513	"REEDY CUT" ULTRA BRUSH, 1:12 scale compound	pr	4.25
	6512	BRUSH, Yokomo motors	pr	3.00
	6516	CUT BRUSH, for Yokomo motors, 6512 compound	pr	4.25
	740	COPPER HEAD SPRING, for off road racing	pr	2.50
	741	COPPER HEAD SPRING, on road, low resistance, high temperature	pr	2.50
	3514	MOTOR SPRING, 1:12 scale	pr	2.00
	6514	BRUSH SPRING for all Yokomo motors	pr	2.00

#### FOR SONIC MOTORS

For Sonic motors and other motors that use a laydown brush system.

	742	SONIC MOTOR SPRING, High tension copper clad mat'l. Off road and on road uses.	pr	3.00
	760	SONIC OFF ROAD BRUSH, Same compound as the #737 and gives long wear on commutator and brushes under high current off road conditions.	pr	3.00
	761	SONIC ON ROAD BRUSH, A new, low-resistance compound, on road and stock motor racing.	pr	3.00
	762	SONIC SILVER ON ROAD BRUSH, Same compound as #730, 1/12 racing.	pr	3.00
	763	LAYDOWN ON ROAD CLIPPER BRUSH, with slotted adjustable contact area. Allows brushes to be tuned for motor and track. Laydown brush, on road and stock compound	pr	4.50
	764	LAYDOWN OFF ROAD CLIPPER BRUSH, with slotted adjustable contact area. Allows brushes to be tuned for motor and track. Laydown off road compound	pr	4.50

#### NI-CADS

	650	BATTERY STRAP BRAID	6	1.50
<b>1400 MAH SCR</b>				
	604	REEDY Matched 6-cell, "Team Pack"	1	48.00
	606	REEDY Matched 6-cell, "Ultra Power" (World)	1	60.00
	607	REEDY Matched 7-cell, "Ultra Power"	1	70.00

1700 MAH SCRC				
	634	Reedy Power Matched 6-cell, "Ultra Pack"	1	75.00
	635	Reedy Power Matched 7-cell, "Ultra Pack"	1	87.50
NOVA SERIES				
	636	NOVA, 6 cell matched pack, 1700 mah SCRC-SP cells, for off road or club level on road.	1	61.50
	637	NOVA 7 cell matched pack, 1700 mah SCRC-SP cells, for off road or club level on road.	1	71.75

#### ELECTRICAL ITEMS

	3504	MOTOR CONNECTOR, JST type	pr	1.00
	3505	MOTOR CONNECTOR, AMPS type	pr	1.00
	3506	MOTOR CAPACITOR, .01 ufd	1	.50
	3507	CONNECTOR PIN, female	8	1.00
	3508	CONNECTOR PIN, male	8	1.00
	3711	THROTTLE CONTROL RESISTER, RC12i & 12E	1	8.00
	3712	THROTTLE CONTROL WIPER	1	1.25
	3715	RADIO DROPPING DIODE	pr	1.00
	3716	ANTENNA TUBE WITHOUT MOUNT	1	.50
	3719	NYLON TIES, 6", heavy duty for battery packs	12	1.25
	7709	NYLON WIRE TIES, 4 inches each	12	1.25
	3720	NYLON TIES, 8", light duty for receiver	12	1.25
	3736	FAST-CHARGE CORD for 6-cell packs	1	5.50
	3737	16 GAGE STRANDED, SUPERFLEX WIRE, high temperature silicon rubber insulation. Extremely high grade wire. Use for flexible connection to throttle control wiper, or for all wiring on car. 2 ft. orange, 2 ft. black	2	5.00
	3740	BATTERY CONNECTOR, 3-pin mating pair	pr	1.50
	652	BATTERY POWER CONNECTOR PINS. Eliminates hassle of soldering battery pack to radio leads. Quick connect/disconnect	5pr	10.00
	3783	THROTTLE RESISTOR, ultra light, 8/10 ohm RC12i & 12E	1	10.00
	6726	NEW IMPROVED SERVO TAPE, black roll, 36" length (replaces #4326)	1	2.50
	4370	WIRING HARNESS	1	7.50

#### MISCELLANEOUS HARDWARE

A) Button Head B) Flat Head C) Socket Head				
	2207	HOOD PINS, SMALL	6	.50
	2208	HOOD PINS, LARGE	6	.75
	3320	FRONT BODY MOUNTS with hardware	pr	1.00
	3321	FRONT BODY MOUNT SPACERS w/ hrdwre	pr	1.00
	6951	SET SCREWS 4-40 x 1/8" with .050 Allen wrench	6	2.50

#### SCREWS

	3324	ALUM. FLATHEAD SCREW, 8-32 x 1/2"	16	2.00
	3325	ALUM. FLATHEAD SCREW, 8-32 x 1 1/2"	6	1.50
	4145	ALUM. SOCKET HEAD cap screw, 4-40 x 5/16"	4	1.50
	4180	2-56 SCREW & NUT SET, 2 each of screws, nuts, nylon nts.	set	1.00
	4181	ALUM. FLAT HEAD SCREW, 8-32 x 7/8"	6	1.00
	4183	ALUM. ROUND HEAD SCREW, 8-32 x 1/2"	6	1.00
	4179	LIGHTWEIGHT SCREW SET, aluminum, blue anodized	26	7.00
	4334	BUTTON HEAD SOCKET screw, 2-56 x 5/16"	8	1.50
	6284	ALUM. SOCKET HEAD cap screw, 4-40 x 1/4"	12	4.00
	6291	FLAT HEAD SS, 4-40 x 1/4"	6	2.00
	6292	FLAT HEAD SS, 4-40 x 3/8"	6	2.00
	6285	SOCKET HEAD CAP screw, 4-40 x 1/4"	6	2.00

qty	part no.	description	pkg	list price	qty	part no.	description	pkg	list price
-----	----------	-------------	-----	------------	-----	----------	-------------	-----	------------

6860	ALUM. SOCKET HEAD cap screw, 4-40 x 3/8"	6	2.00
6917	BUTTON HEAD socket screw 4-40 x 3/8"	6	2.00
6918	BUTTON HEAD SOCKET screw, 4-40 x 1/2"	6	2.00
6919	BUTTON HEAD SOCKET screw, 4-40 x 5/16	6	2.00
6920	BUTTON HEAD SOCKET screw, 4-40 x 3/16	6	2.00
6922	FHSS, 4-40 x 1/2"	6	2.00
6923	FHSS, 4-40 x 3/4"	6	2.00
6924	SOCKET HEAD CAP screw, 4-40 x 3/8"	6	2.00
6925	SOCKET HEAD CAP screw, 4-40 x 1/2"	6	2.00
6926	SOCKET HEAD CAP screw, 4-40 x 5/8"	6	2.00
6927	SOCKET HEAD CAP screw, 4-40 x 3/4"	6	2.00
6928	SOCKET HEAD CAP screw, 4-40 x 1"	6	2.00
6929	SOCKET HEAD CAP screw, 4-40 x 3/8"	6	2.00
6932	SOCKET HEAD CAP screw, 4-40 x 5/16"	6	2.00
6933	ALUM. FLAT HEAD SOCKET CAP screw, 4-40 x 5/16"	6	2.00
6934	ALUM. FLAT HEAD SOCKET CAP screw, 4-40 x 3/8"	6	2.00
6935	ALUM. SOCKET HEAD cap screw, 4-40 x 1"	4	2.00
6938	ALUM. FLAT HEAD SOCKET screw, 4-40 x 1/2"	6	2.00
6939	ALUM. FLAT HEAD socket screw, 4-40 x 1/4"	6	2.00
7658	FLAT HEAD machine screw, 8-32 x 3/8" (black)	6	2.00
7801	ALUM. SOCKET HEAD cap screw, 4-40 x 5/8"	8	2.50
7873	ALUM. SOCKET HEAD cap screw, 4-40 x 7/16"	8	2.50
7874	SOCKET HEAD cap screw 4-40 x 7/16"	8	2.50

#### NUTS

3438	ALUMINUM LOCKNUT, 8-32	3	1.00
4180	2-56 NUT & SCREW SET, 2 each of screws, nuts, nylon nuts.	set	1.00
4184	NYLON LOCKNUT, 4-40	6	1.00
4185	NYLON LOCKNUT, 8-32	6	1.00
4186	NYLON LOCKNUT, 10-32	6	1.00
4449	SMALL PATTERN LOCKNUT, 4-40	5	2.50
6296	8-32 LOCKNUT, 6 aluminum & 6 nylon.	12	2.00
6937	ALUMINUM LOCKNUT, #4	6	3.00
7260	THIN SMALL PATTERN PLAIN NUT, 4-40	12	2.00

#### WASHERS

3216	AXLE WASHER, 1/8" ID	12	1.00
3323	THICK ALUM. WASHER, #8, for body mount spacers	12	1.00
3327	CHASSIS SHIM/TWEAK WASHER	12	1.00
4187	NYLON FRONT AXLE WASHER	12	1.00
4188	MOTOR MOUNT WASHER	12	1.50
6936	ALUMINUM FLAT WASHER, #4	10	1.00

#### DECALS

712	REEDY MODIFIED DECALS, pink	1	2.00
713	REEDY MODIFIED DECALS, blue	1	2.00
714	REEDY MODIFIED DECALS, red	1	2.00
715	REEDY MODIFIED DECALS, black	1	1.50
716	REEDY MODIFIED DECALS, white	1	1.50
3809	RC12L DECALS, 3 sizes, florescent red & yellow	1	2.00
3818	TEAM ASSOCIATED LOGO decal sheet, mylar peel and stick, black, six decals	1	1.00
3819	TEAM ASSOCIATED LOGO decal sheet, mylar peel and stick, white, six decals	1	1.00
6196	MISC. SPONSOR decal sheet, 5 colors	1	2.00

## MISCELLANEOUS

SP-32	RC10 "ELECTRIC" T-SHIRT with Associated's electric RC10T truck, RC10, and RC10L. Specify M, L, XL only.	1	11.00*
SP-33	REEDY SAFARI T-SHIRT. Shirt is speckled light grey; designs are black, flores. purple and green. Spec. M, L, XL	1	11.00*
SP-34	ASSOCIATED "WORLD TOUR" T-SHIRT. Full color front/back, 10 World Championship cars on back. Specify M, L, XL only.	1	11.00*
SP-35	OFF ROAD WORLD TOUR T-SHIRT. Full color front & back. 1993 IFMAR World Championships in Basildon, England on front, and Team's 12 World Championship cars on back. Specify M, L, XL only.	1	11.00*
SP-70	3/32 "T" HANDLE ALLEN WRENCH	1	3.50*
SP-76	HUNTER PHILLIPS HEAD SCREWDRIVER, #2 size, fits aluminum flathead screws	1	5.75*
SP-79	HUNTER 3/8" NUT DRIVER, fits differential adjustment nut	1	6.00*
SP-82	HUNTER 11/32" NUT DRIVER, fits graphite diff. adjustment nut	1	6.00*
SP-83	KIMBROUGH PRODUCTS TIRE HORN	1	2.50*
SP-85	HUNTER 1/4" NUT DRIVER	1	6.00
6950	RC12L ALLEN WRENCH SET	1	2.50
6951	PINION SET SCREWS with wrench	6	2.50
6957	.050" ALLEN DRIVER, precision ground replaceable tip, alum. hex handle (black)	1	10.50
6958	1/16" ALLEN DRIVER, precision ground replaceable tip, alum. hex handle (black)	1	10.50
6959	5/64" ALLEN DRIVER, precision ground replaceable tip, alum. hex handle (black)	1	10.50
6960	3/32" ALLEN DRIVER, precision ground replaceable tip, alum. hex handle (black)	1	10.50
6961	2.5 mm ALLEN DRIVER, precision ground replaceable tip, alum. hex handle (black)	1	10.50
6962	1.5 mm ALLEN DRIVER, precision ground replaceable tip, alum. hex handle (black)	1	10.50
<b>NEW!</b>  <b>REPLACEMENT TIPS for Allen drivers above, #6964 - 6969</b>			
6964	.050" REPLACEMENT TIP, for Allen wrench	1	5.50
6965	1/16" REPLACEMENT TIP, for Allen wrench	1	5.50
6966	5/64" REPLACEMENT TIP, for Allen wrench	1	5.50
6967	3/32" REPLACEMENT TIP, for Allen wrench	1	5.50
6968	2.5 mm REPLACEMENT TIP, for Allen wrench	1	5.50
6969	1.5 mm REPLACEMENT TIP, for Allen wrench	1	5.50
6973	VHS VIDEO, "R/C Car Racing '91." Learn from watching the best R/C drivers compete in the most exciting races in the world!	1	19.95
6975	VHS VIDEO, "R/C Car Racing '93." Watch and learn from the best drivers in the world. Some of the best races from the 1993 Nationals and World Championship races.	1	19.95
6975P	PAL VIDEO, "R/C Car Racing '93." International PAL format. Watch and learn from the best drivers in the world. Some of the best races from the 1993 Nationals and World Championship races.	1	19.95