

# RC18

## 1:18 Series Manual and Parts Listing

20100: 18T RTR 4wd Mini Truck

20102: 18T Factory Team 4wd Mini Truck Kit

20105: 18B RTR 4wd Mini Buggy

20107: 18B Factory Team 4wd Mini Buggy Kit

20110: 18MT RTR 4wd Monster Truck



**RC18T**

**20100:**

**18T RTR 4wd Mini Truck**

Prebuilt, Ready to Run 4wd Race Truck! Includes the following options:

- Mini-Pin Racing Tires
- White Dish Racing Wheels
- Super-370 Size Motor
- Choice of Red or Blue Pre-Painted Race Truck Bodies
- Individual Servo, ESC & Receiver
- 1100mah Battery & Wall Charger



**FT RC18T**

**20105:**

**18B RTR 4wd Mini Buggy**

Prebuilt, Ready to Run 4wd Race Buggy! Includes the following options:

- Mini-Pin Racing Tires
- White Spoked Racing Wheels
- Super-370 Size Motor
- Choice of Red or Orange Pre-Painted Buggy Bodies
- Individual Servo, ESC & Receiver
- 1100mah Battery & Wall Charger



**RC18B**

**20102:**

**18T Factory Team 4wd Mini Truck Kit**

Unbuilt kit with no electronics. Includes the following Factory Team option parts:

- Blue Aluminum Dogbones
- Blue Aluminum Finned Motor Mount
- Carbide Differential Balls
- Blue Woven Graphite Battery Strap Saver
- Blue Aluminum Threaded Shocks
- Blue Aluminum Wheelnuts
- Titanium Turnbuckles
- Clear Body, Decals & Window Masks
- Includes Extra Hitec Servo Saver
- Includes a 12t, 13t & 14t Pinion



**RC18MT**

**20107:**

**18B Factory Team 4wd Mini Buggy Kit**

Unbuilt kit with no electronics. Includes the following Factory Team option parts:

- Blue Aluminum Dogbones
- Blue Aluminum Finned Motor Mount
- Carbide Differential Balls
- Blue Woven Graphite Battery Strap Saver
- Blue Aluminum Threaded Shocks
- Blue Aluminum Wheelnuts
- Titanium Turnbuckles
- Clear Body, Decals & Window Masks
- Includes Extra Hitec Servo Saver
- Includes a 12t, 13t & 14t Pinion



**20110:**

**18MT RTR 4wd Monster Truck**

Prebuilt, Ready to Run 4wd Monster Truck! Includes the following options:

- Large, AE Pattern Monster Truck Tires
- Chrome Monster Truck Wheels
- Super-370 Size Motor
- American Flag-Design Monster Truck Body
- Individual Servo, ESC and Receiver
- Bed-Mounted AE-Logo Flag
- 1100mah Battery & Wall Charger

# 1:18 Scale 4wd Electric Vehicles

## Thank you for choosing Team Associated.

Team Associated wants you to enjoy driving and maintaining of your new RC Car. If you come across any problems or need help with the maintenance of your RC Car, please give us a call and we will do our very best to help you.

### The RTR

Your new RC Car comes factory assembled with radio gear and battery. You will need to purchase 8 AA batteries for your transmitter. Please see the Quick Start Guide for installing your AA batteries.

### The Manual

Examine each step carefully before building. Special notes for each step will be marked with a ▽.

Certain steps will notate left and right sides of the vehicle. For assembly, the left side of the vehicle is the 'driver' side of the car....it would be built as if you are sitting in the driver's seat.

### Customer Support

Tel: 714.850.9342  
Fax: 714.850.1744

Hours: 8:00am - 4:00pm, pst

<http://www.rc10.com>  
<http://www.TeamAssociated.com>



#### recommended servo list

using kit mount:  
XP C1016 • ACE C1016 • Airtronics 94091  
Futaba S3106

using optional mount (part # 21049, included in FT kit):  
Hitec HS-56HB

#### recommended tools for assembly and maintenance



4-way wrench  
(included)



hex wrench, 1.5mm, 3/32"  
(included)



#1 Phillips screwdriver

#### items required to operate your vehicle



8 AA size batteries

### Chassis Specs

	18T	18MT	18B
Length:	218mm	225mm	235mm
Width:	182mm	188mm	182mm
Wheelbase:	154mm	154mm	154mm
Internal Gear Ratio:	2.5:1	2.5:1	2.5:1
Weight:	540g (with body)	605g (with body)	541g (with body)
Drivetrain:	Shaft drive	Shaft drive	Shaft drive

#### ▶ Bag A - Step 1



21041, qty 1  
servo saver



21050, qty 1  
steering bellcrank



21082, **21240**, qty 2  
ball stud, 5mm



#### ▶ Step 2



21041, qty 2  
M2.5 x 9 bhps



21050, qty 1  
steering drag link

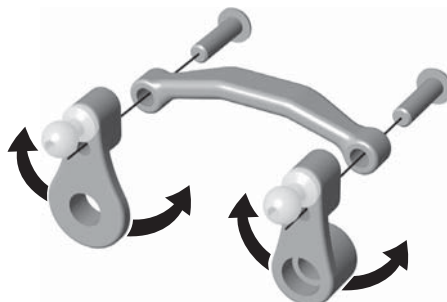

! should be 'free' movement

#### ▶ Step 3



21041, qty 1  
M2.0 x 9 bhps  
XP/Futaba



21041, qty 1  
servo saver bushing  
XP/Futaba



21041, qty 1  
servo saver spring



21041, qty 2  
M2.5 x 9 bhps  
Sanwa/Airtronics



21049, qty 1  
aluminum servo saver bushing  
Hitec/Sanwa/Airtronics



21041, qty 1  
servo saver horn

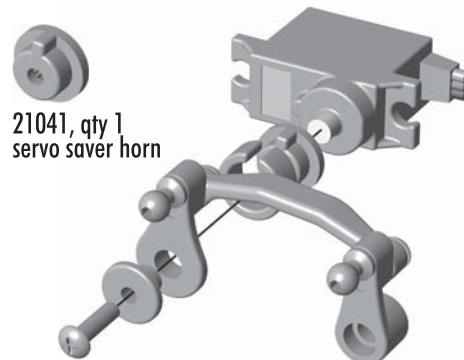

! if you are using a Hitec HS-56 servo, please refer to the Hitec servo saver bag for detailed instructions on installing the Hitec servo saver assembly (FT Kit only)

## Associated Electrics, Inc.

3585 Cadillac Ave.  
Costa Mesa, CA 92626 USA

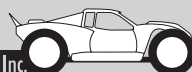



▶ Step 4

- 21050, qty 2 steering bellcrank bushing
- 21050, qty 1 steering bellcrank hinge pin

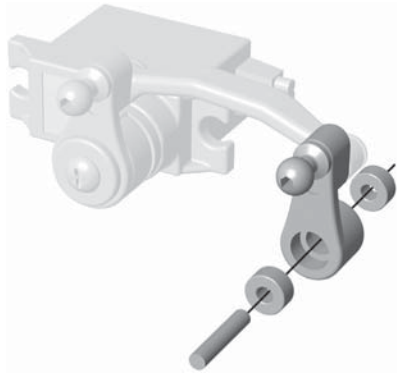

▶ Step 5

- 21040, qty 1 servo mount

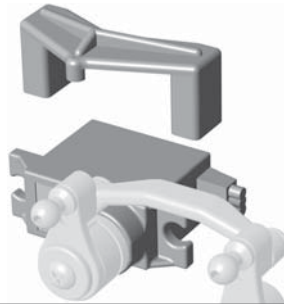

! if you are using a Hitec HS-56 servo, please refer to the Hitec servo bag for detailed instructions on installing the servo with the Hitec mount

▶ Bag B - Step 1

- 21027, qty 1 diff outdrive (long)
- 21115, qty 1 diff drive ring

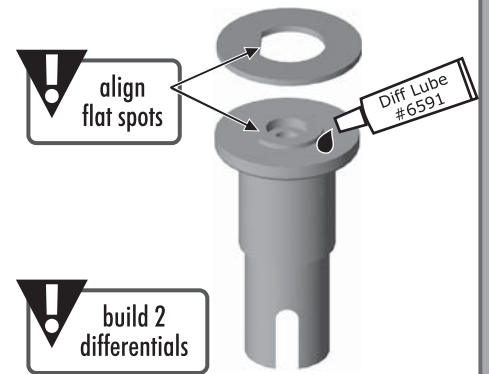

! build 2 differentials

▶ Step 2

- 21027, qty 1 diff outdrive (short)
- 21115, qty 1 diff drive ring

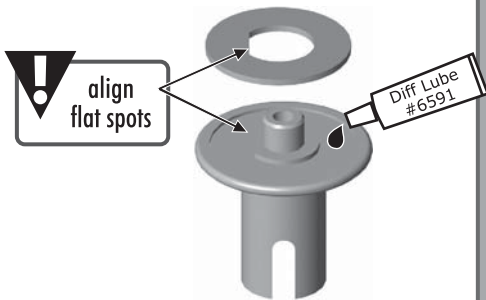

▶ Step 3

- 21022, qty 1 diff gear



▶ Step 4

- 21115, 21116\*, qty 8 diff balls, 2mm

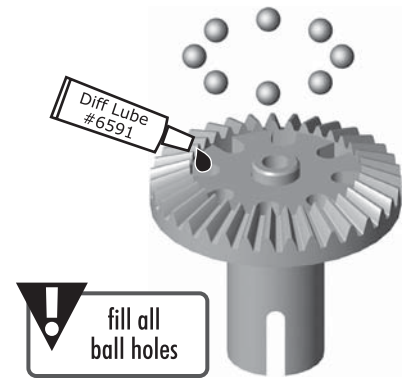

! fill all ball holes

▶ Step 5

- 21115, qty 3 thrust washer
- 21115, qty 1 diff spring
- 21115, qty 1 diff bolt
- 21115, qty 7 thrust balls, 1.5mm

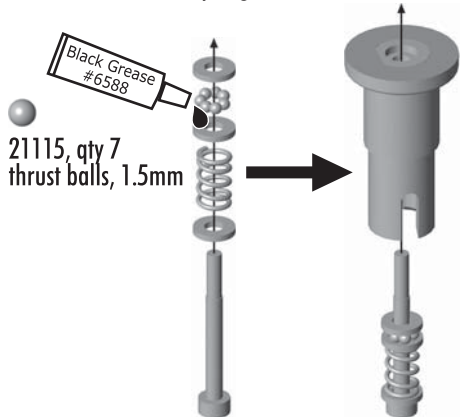

▶ Step 6

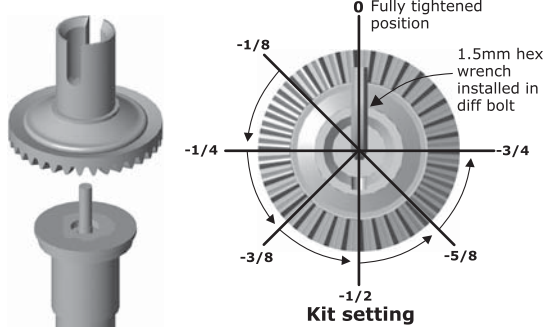

! Do not over-tighten diff bolt!  
When fully compressed, set at 1/2 turn out (see diagram)

▶ Step 7

- 21027, qty 1 dogbone spring cup
- 21106, qty 2 8 x 12 x 3.5 bearing cup
- 21141, qty 2 18T diff shim



▶ Bag C - Step 1

21001, qty 1 chassis  
 21025, qty 2 gearbox cases  
 21077 55t, qty 1  
 21078 60t(std), qty 1 gear cover

25196, qty 2 M2 x 8 fhps

see gearing chart, page 11

▶ Step 2

25196, qty 2 M2 x 8 fhps

▶ Step 3

note direction of differentials

▶ Step 4

21022, qty 2 input bevel gear  
 21033, qty 1 55t spur gear  
 21035, qty 1 (std) 60t spur gear  
 21089, qty 1 main driveshaft

21105, qty 2 4 x 8 x 3 bearing  
 21106, qty 1 8 x 12 x 3.5 bearing

▶ Step 5

21133, qty 2 M2.5 x 6 bhps

▶ Bag D - Step 1

21017, **21221**, qty 1 18T/18MT shock tower, front  
 21082, **21241**, qty 2 ballstud, 5mm

21245, **21265**, qty 1 18B shock tower, front

18T & 18MT  
 18B

front

▶ Step 2

21017, **21222**, qty 1 18T/18MT shock tower, rear  
 21082, **21241**, qty 2 ballstud, 5mm

21245, **21266**, qty 1 18B shock tower, rear

18T & 18MT  
 18B

rear

▶ Step 3

21134, qty 2 M2.5 x 9 bhps  
 21248, qty 2 18B wing mount

18B

rear

▶ Step 4



21259, qty 1  
chassis top plate



21132, qty 4  
M2 x 9 bhps

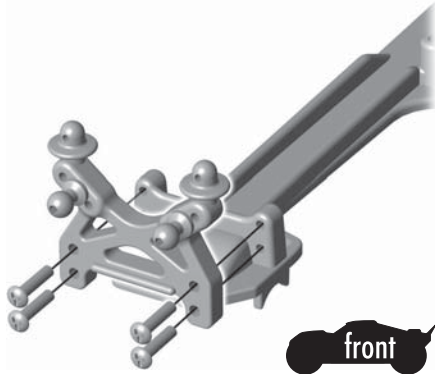

front

▶ Step 5



21132, qty 4  
M2 x 9 bhps

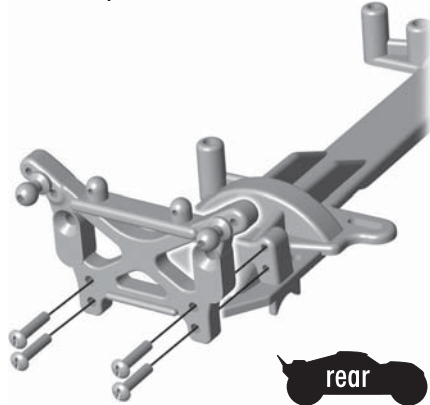

rear

▶ Step 6



21082, **21241**, qty 4  
ballstud, 8mm



21132, qty 6  
M2 x 9 bhps

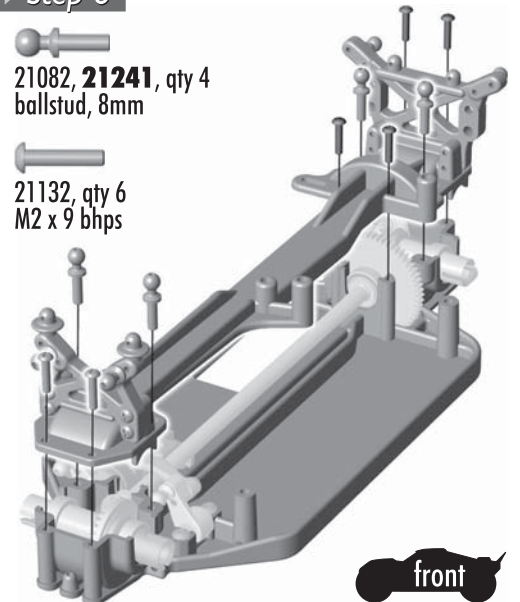

front

▶ Bag E - Step 1



21082, **21241**, qty 4  
ballstud, 5mm



21008, **21220**, qty 4  
suspension arm

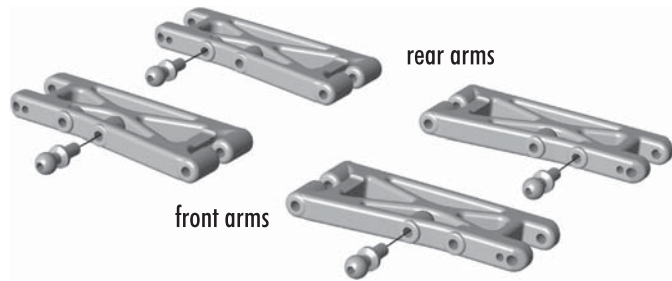

front arms

rear arms

▶ Step 2



21085, qty 2  
hinge pins, inner

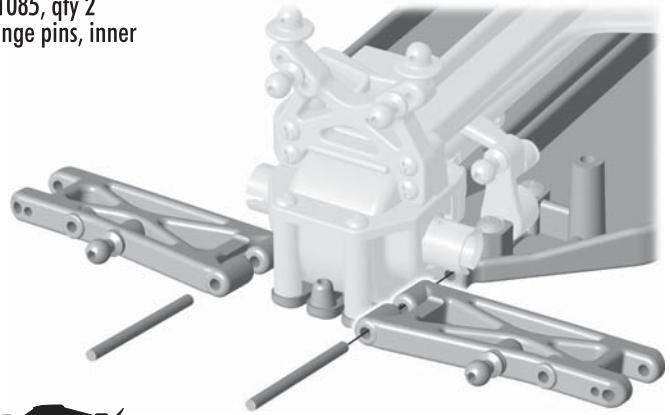

front

▶ Step 3



21005, qty 1  
front bumper/arm  
mount



21135, qty 2  
M2 x 12 fhps



25196, qty 1  
M2 x 8 fhps

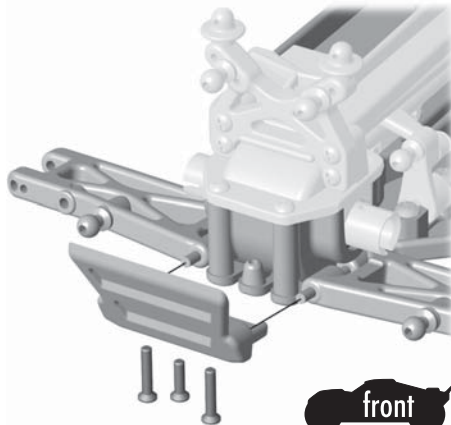

front

▶ Step 4



21085, qty 2  
hinge pins, inner

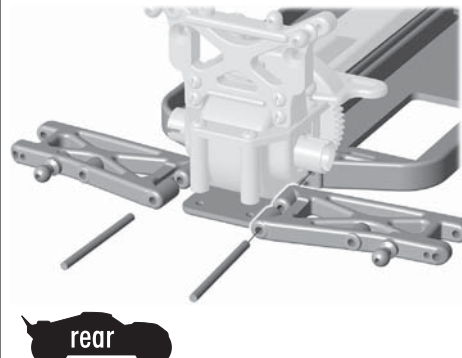

rear

▶ Step 5



21005, qty 1  
rear arm mount



21135, qty 2  
M2 x 12 fhps

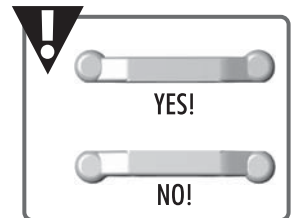

YES!

NO!

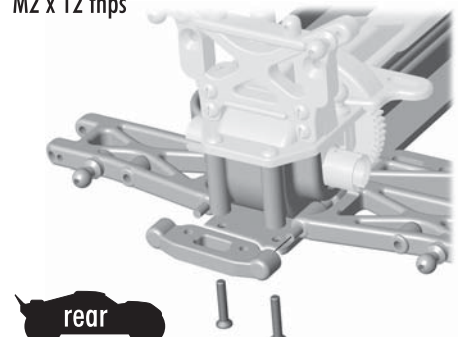

rear



► Bag F - Step 1

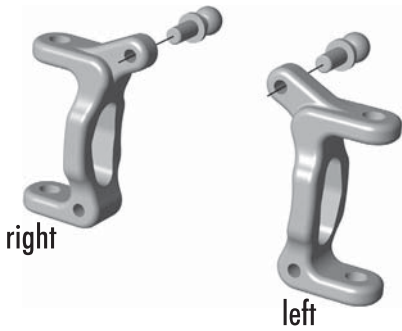
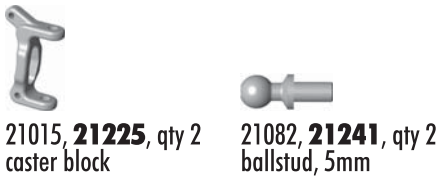

► Step 2

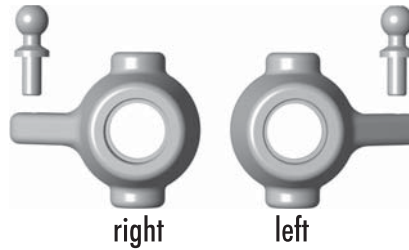
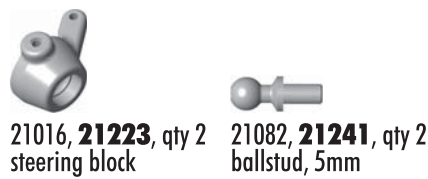

► Step 3

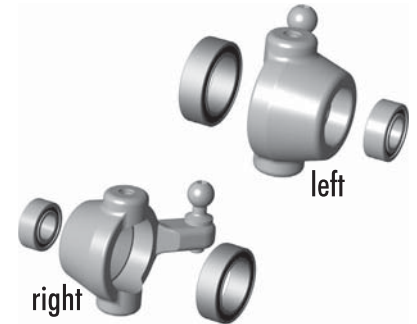
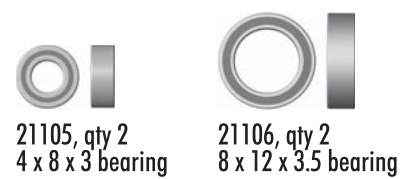

► Step 4

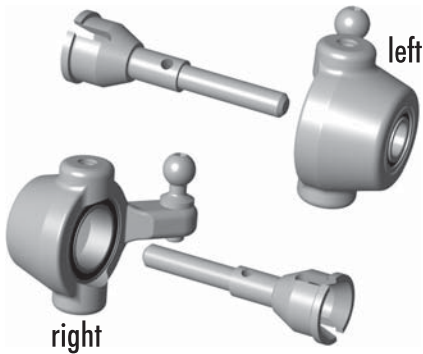

► Step 5

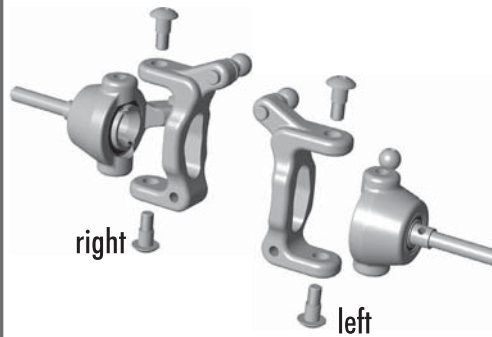

► Step 6

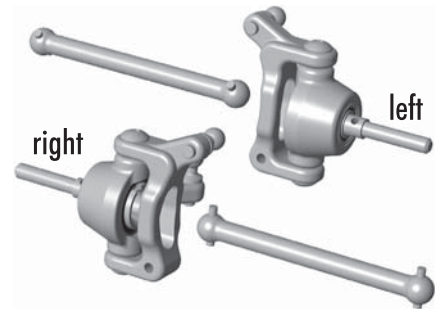

► Step 7

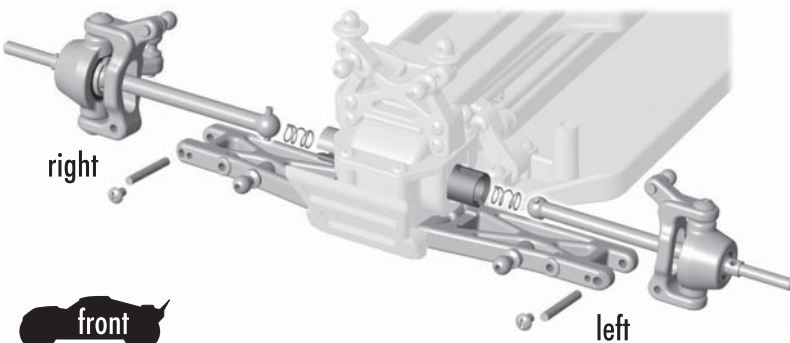

► Step 8

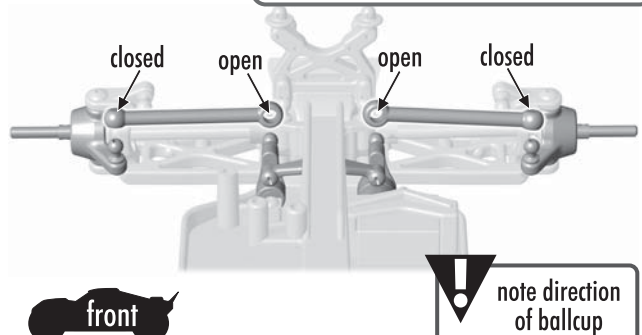
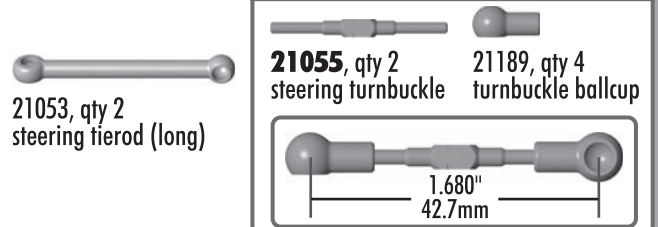

▶ Step 9

**Factory Team Only**

21053, qty 2  
suspension upper tierod  
(short)

**21055**, qty 2  
camber turnbuckle

21189, qty 4  
turnbuckle ballcup

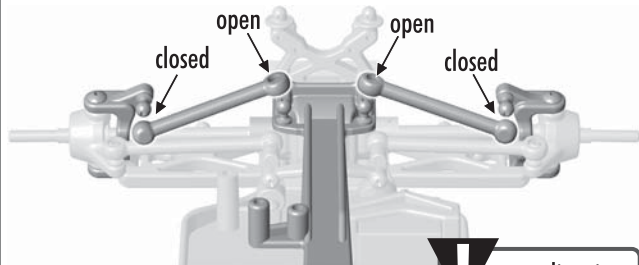
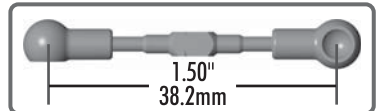

front

! note direction  
of ballcup

▶ Step 10



21010, **21224**, qty 2  
rear hub carrier

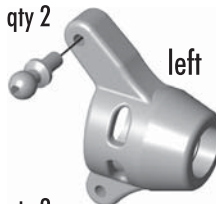

left



21082, **21241**, qty 2  
ballstud, 5mm



right

▶ Step 11



21105, qty 2  
4 x 8x 3 bearing



21106, qty 2  
8 x 12 x 3.5 bearing



left

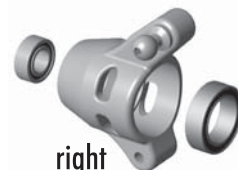

right

▶ Step 12



21095, **21230**, qty 2  
stub axle

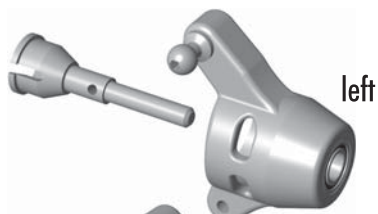

left

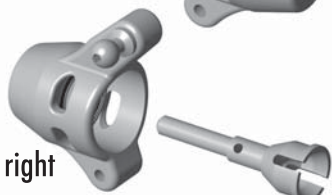

right

▶ Step 13



21030, **21031**, qty 2  
dogbone



left



right

**Having Problems?**

**Associated Electrics, Inc.**

3585 Cadillac Ave.  
Costa Mesa, CA 92626 USA

**Customer Support**

Tel: 714.850.9342  
Fax: 714.850.1744

Hours: 8:00am - 4:00pm, pst

<http://www.rc10.com>  
<http://www.TeamAssociated.com>



▶ Step 14

4118, 21030, qty 2  
dogbone spring

21085, qty 2  
hinge pins, outer

21130, qty 2  
M2 x 3 bhps

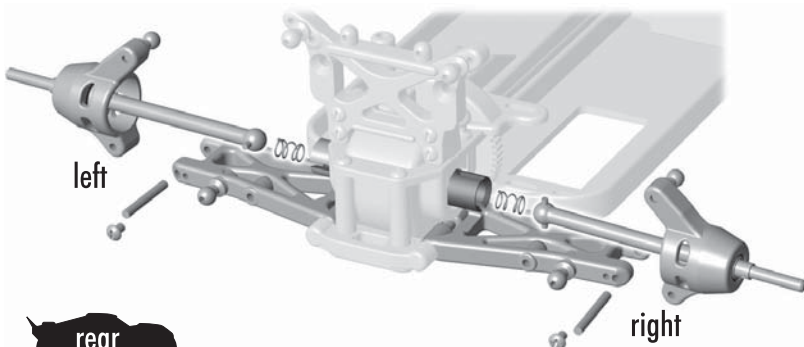

left

right

rear

▶ Step 15

**Factory Team Only**

21053, qty 2  
suspension upper tierod  
(short)

**21055**, qty 2  
camber turnbuckle

21189, qty 4  
turnbuckle ballcup

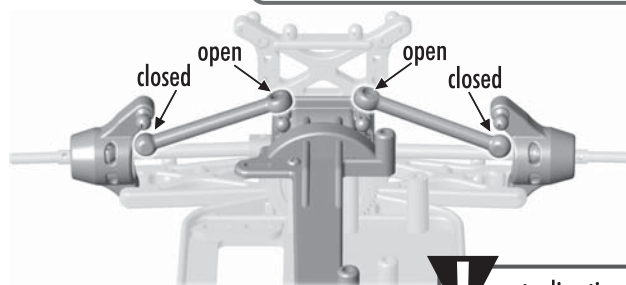
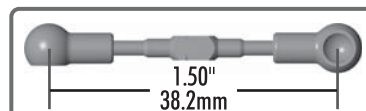

rear

! note direction  
of ballcup



Exploded View

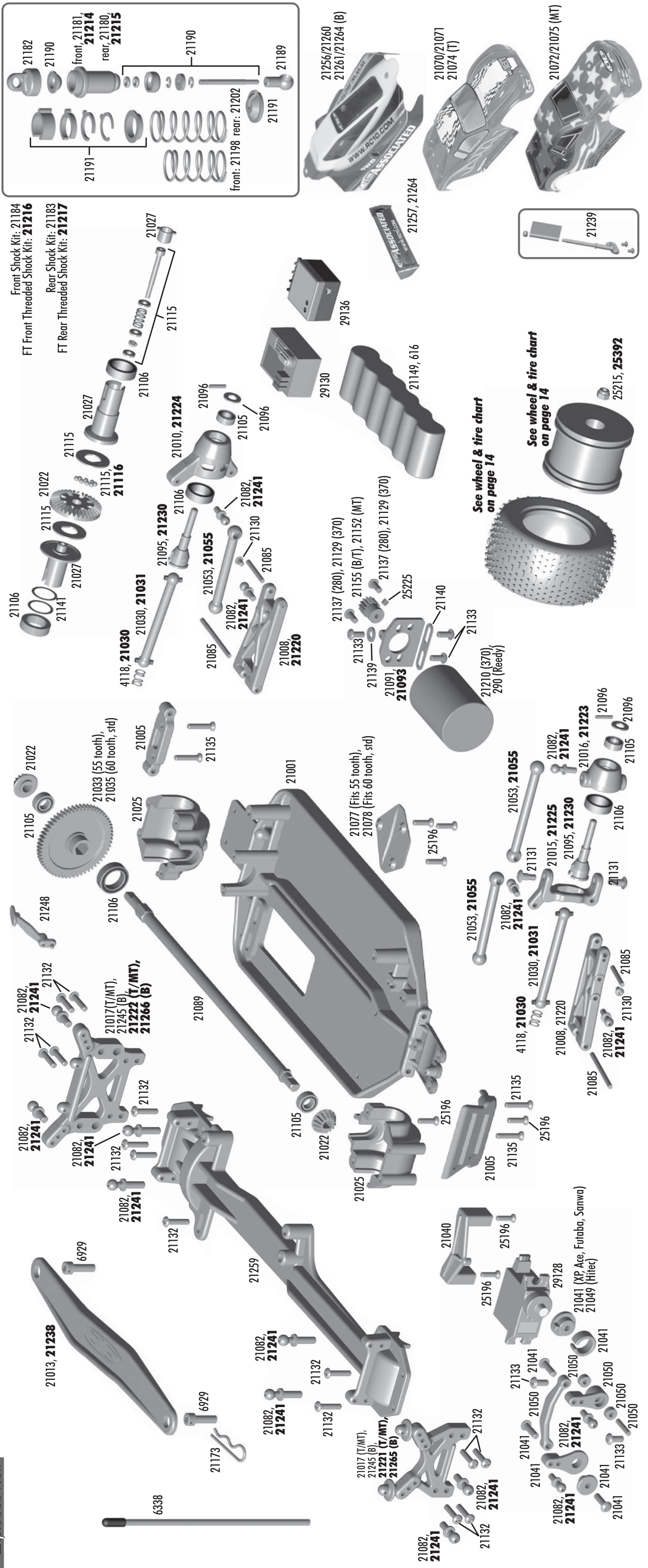

Parts List

Part No.	Description	QTY	Price
4118	014 Spring (Dogbone Spring)	Pr.	\$2.00
6338	Antenna Tube & Cap	1	2.00
21001	Chassis	1	6.99
21005	Arm Mount, front & rear	Set	2.99
21008	Suspension Arm	Pr.	2.99
21010	Rear Hub Carrier	2	2.99
21013	Battery Brace, 4 cell, 5/6 cell	Set	3.99
21015	Caster Block, left or right	2	2.99
21016	Steering Block	2	2.99
21017	Shock Towers, front & rear (T/MT)	Pr.	3.99
21022	Differential & Input Gear	Set	3.99
21024	Complete Differential Kit	1	8.99
21025	Gearbox Cases	2	4.99
21027	Differential Outdrives, long & short	Set	2.99
21030	Dogbones & Springs	Set	3.99
21033	Spur Gear/Drive Cup, 55t	1	2.99
21035	Spur Gear/Drive Cup, 60t, std	1	2.99
21040	Servo Mount	1	1.99
21041	Servo Saver, XP, Ace, Futaba, Sanwa	Set	2.99
21049	Servo Saver, Hitec HS-56	Set	2.99
21050	Steering Bellcrank Parts	Set	2.99
21052	Turnbuckle Set, steel, with ballcaps	Set	7.99
21053	Suspension Linkage	Set	\$3.99
21069	Body Decal Sheet & Window Mask (T/MT)	Set	3.99
21070	Truck Painted Body, blue, with decals (T/MT)	1	19.99
21071	Truck Painted Body, red, with decals (T/MT)	1	19.99
21072	MT Flag Body, with decals (T/MT)	1	17.99
21074	Truck Clear Body, w/decals/window mask (T/MT)	1	13.99
21075	MT Clear Body, w/decals/window mask (T/MT)	1	11.99
21076	MT Decal Sheet & Window Masks	1	3.99
21077	Chassis Gear Cover - 55t	1	1.99
21078	Chassis Gear Cover - 60t, std	1	1.99
21082	Ballstud Set	Set	8.99
21085	HingePin Set	Set	2.99
21089	Main Driveshaft	1	6.99
21091	Motor Mount	1	3.99
21095	Stub Axles	2	8.99
21096	Stub Axle Pins & Spacers	Set	2.99
21105	Bearing, 4 x 8 x 3	2	4.50
21106	Bearing, 8 x 12 x 3.5, rubber sealed	2	4.50
21107	Bearing Set	Set	27.99
21115	Differential Rebuild Kit	1	3.99
21129	M3 x 5 BHPS	20	1.99
21130	M2 x 3 BHPS	20	2.99
21131	M2.5 x 3 BHPS	4	\$2.50
21132	M2 x 9 BHPS	20	2.99
21133	M2.5 x 6 BHPS	20	2.99
21134	M2.5 x 9 BHPS	20	2.99
21135	M2 x 12 FHPS	20	2.99
21137	M2.5 x 4 BHPS	20	1.99
21139	M2.5 Washers	20	1.99
21140	Motor Mount Plate	2	1.99
21141	Diff Shims	4	1.00
21146	Screw Set	Set	6.99
21152	Pinion Gear, 10t (MT kit)	1	3.99
21153	Pinion Gear, 12t	1	3.99
21154	Pinion Gear, 13t	1	3.99
21155	Pinion Gear, 14t (B/T Kit)	1	3.99
21156	Pinion Gear, 15t	1	3.99
21157	Pinion Gear, 11t	1	3.99
21173	Body Clips	12	1.99
21180	Shock Body, rear	Pr.	2.50
21181	Shock Body, front	Pr.	2.50
21182	Shock Caps	4	3.50
21183	Shock Kit, rear	Pr.	9.99
21184	Shock Kit, front	Pr.	9.99
21189	Ballcup, short, for shocks	12	\$2.99
21190	Shock Rebuild Kit, rebuilds 4 shocks	Set	9.99
21191	Shock Accessories	Set	3.99
21197	Shock Spring, front, silver, 2.55 lb/in	Pr.	2.50
21198	Shock Spring, front, blue, 3.0 lb/in	Pr.	2.50
21199	Shock Spring, front, gold, 3.45 lb/in	Pr.	2.50
21201	Shock Spring, rear, silver, 1.64 lb/in	Pr.	2.50
21202	Shock Shaft, rear, blue, 1.90 lb/in	Pr.	2.50
21256	Buggy Clear Body, Wing & Dirt Deflectors (B)	Set	11.99
21257	Buggy Clear Body, Wing & Dirt Deflectors (B)	Set	2.99
21258	Buggy Decal Sheet & Window Mask (B)	Set	3.99
21259	Top Plate	1	3.99
21260	Buggy Painted Body, Red, with decals (B)	1	19.99
21261	Buggy Painted Body, Orange, with decals (B)	1	19.99
21264	Buggy Graphite-Pattern Wing/Dirt Deflectors (B)	Set	3.99
21203	Shock Spring, rear, gold, 2.35 lb/in	Pr.	2.50
21239	Flag Kit	1	6.99
21245	Shock Tower, front & rear (B)	1	3.99
21248	Wing Mount (B)	2	2.99
25196	M2 x 8 FHPS	4	3.50
25215	M3 Locknuts	20	2.99
25225	M3 x 3 Setscrews	20	4.50
29128	XP C1016 Servo	Set	6.99
29129	XP C1016 Servo	Set	6.99
29130	XP TR203A Receiver	1	39.99
29136	XPS Micro Speed Control	1	79.99
29137	XPS Speed Control Heatsink, blue	1	3.99
29151	AC 110v 120mah 10 Hour Wall Charger	1	9.99
29152	AC 230v 120mah 10 Hour Wall Charger	1	11.99
20100	18T RTR 4wd Mini Race Truck	1	\$279.99
20102	18T Factory Team 4wd Mini Truck Kit	1	279.99
20105	18B RTR 4wd Buggy	1	279.99
20107	18B Factory Team 4wd Mini Buggy Kit	1	279.99
20110	18MT RTR 4wd Mini Monster Truck	1	279.99
21240	Factory Billet Aluminum Upgrade Kit (T/MT)	Set	199.99
21270	Factory Billet Aluminum Upgrade Kit (B)	Set	199.99

Power System

291	Reedy Mini-Mod 17T Modified Motor	1	\$47.99
292	Reedy Mini-Mod 19T Modified Motor	1	47.99
617	Reedy VMX R-12 6 Cell 1200mah NiMH Battery	1	xxxxxxx
21149	1100mah NiMH 6 Cell Battery Pack	1	24.99
21161	4 Cell Alkaline Battery Harness	1	3.99
21210	Super 370 Motor	1	11.99
29120	XP2 Transmitter, 2ch, 27mhz	1	49.50
29128	XP C1016 Servo	Set	29.99
29129	XP C1016 Servo	Set	6.99
29130	XP TR203A Receiver	1	39.99
29136	XPS Micro Speed Control	1	79.99
29137	XPS Speed Control Heatsink, blue	1	3.99
29151	AC 110v 120mah 10 Hour Wall Charger	1	9.99
29152	AC 230v 120mah 10 Hour Wall Charger	1	11.99

Kits

20100	18T RTR 4wd Mini Race Truck	1	\$279.99
20102	18T Factory Team 4wd Mini Truck Kit	1	279.99
20105	18B RTR 4wd Buggy	1	279.99
20107	18B Factory Team 4wd Mini Buggy Kit	1	279.99
20110	18MT RTR 4wd Mini Monster Truck	1	279.99
21240	Factory Billet Aluminum Upgrade Kit (T/MT)	Set	199.99
21270	Factory Billet Aluminum Upgrade Kit (B)	Set	199.99



▶ Bag G - Step 1 Front Shocks



21190, qty 2 e-clip



21190, qty 1 piston



21190, qty 1 front shock shaft (short)



! build 2 shocks

▶ Step 2



21181, **21214**, qty 1 front shock body (short)



21190, qty 2 o-ring



21190, qty 1 shock body seal cap



! cap should 'snap' in place

▶ Step 3



21189, qty 1 ball cup, short



#5422



grip shaft (where shown) with needle-nose pliers

▶ Step 4 Rear Shocks



21190, qty 2 e-clip



21190, qty 1 piston



21190, qty 1 rear shock shaft (long)



! build 2 shocks

▶ Step 5



21180, **21215**, qty 1 rear shock body (long)



21190, qty 2 o-ring



21190, qty 1 shock body seal cap



! cap should 'snap' in place

▶ Step 6



21189, qty 1 ball cup, short



#5422

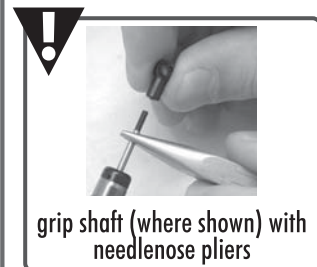

grip shaft (where shown) with needle-nose pliers

▶ Step 7

fill to top with oil



#5422



move shaft up & down to remove air bubbles



fill to top with oil



#5422



install bladder



21190, qty 1 shock bladder



retain oil as you screw the cap on



21182, qty 1 shock cap



▶ Step 8 Front Shocks

  
21198, qty 1  
front spring, blue, 3.0

  
21191, qty 1  
upper spring perch

  
21191, qty 1  
lower spring retainer

  
21191 - B, T & MT, qty 1 each  
ride height clip, 5mm, 2mm



Factory Team Only

  
21214, qty 1  
threaded shock collar

! adjust  
ride height  
to 7mm



front

▶ Step 9 Rear Shocks

  
21202, qty 1  
rear spring, blue, 1.9lb

  
21191, qty 1  
upper spring perch

  
21191, qty 1  
lower spring retainer

  
21191 - B/T, qty 1  
ride height clip, 5mm  
21191 - MT, qty 1 each  
ride height clip, 5mm,  
2mm, 1 mm



Factory Team Only

  
21215, qty 1  
threaded shock collar

! adjust  
ride height  
to 5mm (B/T)

! adjust  
ride height  
to 8mm (MT)

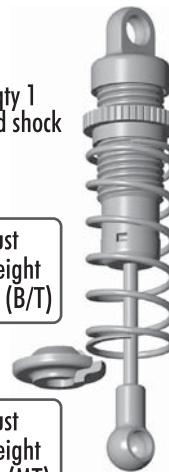

rear

▶ Step 10

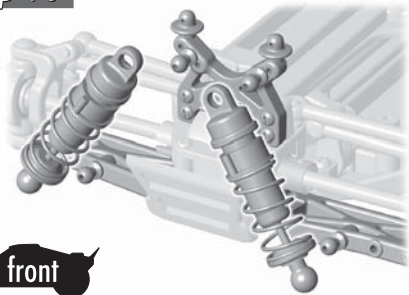

front

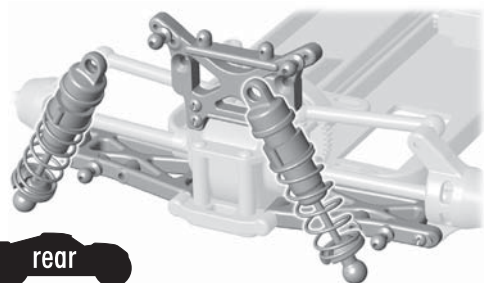

rear

▶ Bag H - Step 1

  
21210, qty 1  
super 370 motor

  
21155 (B/T), qty 1  
14t motor pinion  
21152 (MT), qty 1  
10t motor pinion

  
25225, qty 1  
M3 x 3 setscrew



! refer below for proper  
gearing for the motor you are using

▶ Step 2

  
21091, **21093**, qty 1  
motor mount  
  
21129, qty 2  
M3 x 5 bhps

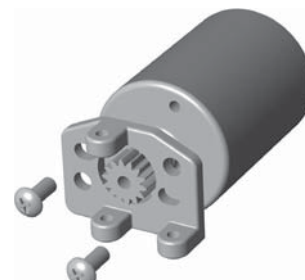

! assemble using holes that  
best fit your motor

▶ 18B/T/MT Gear Chart

Motor	55t Spur	60t Spur	MT 60t Spur
Reedy Mini Max Motor - Large Track	12	13	11
Reedy Mini Max Motor - Short Track	-	12	10
Other Modified 280 Motor - Large Track	13	14	11
Other Modified 280 Motor - Short Track	12	13	10
Super 370 Size Motor - Large Track	13	14	11
Super 370 Size Motor - Short Track	12	13	10
Super 280 Motor - Large Track	14	15	-
Super 280 Motor - Short Track	13	14	-

Motor gearing is a starting recommendation only. You may need to adjust your gearing according to your track size.

▶ Step 3

  
21133, qty 3  
M2.5 x 6 bhps  
  
21139, qty 1  
M2.6 x 6  
washer  
  
21140, qty 1  
motor mount plate

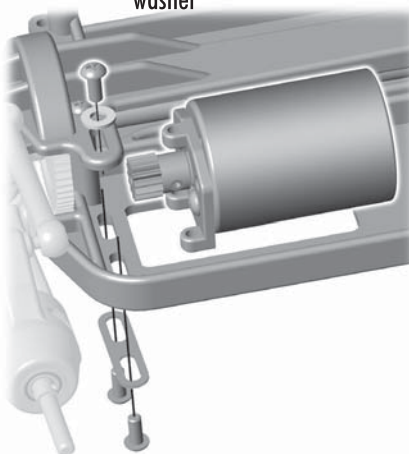

▶ Step 4

  
25196, qty 2  
M2 x 8 fhps

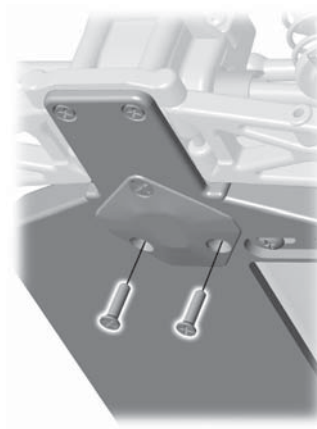



▶ Step 5

6338, qty 1  
antenna tube & cap

6727, qty 1  
servo tape

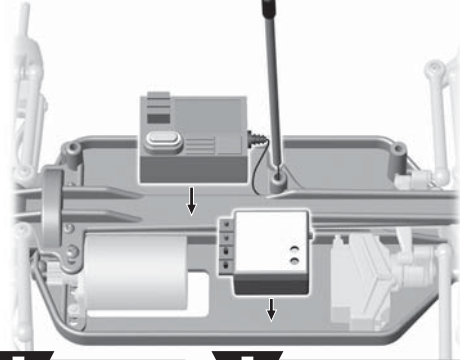

! feed antenna wire as shown

! attach receiver & esc to chassis with servo tape

▶ Step 6

6929, qty 2  
4-40 x 3/8" shcs w/hole

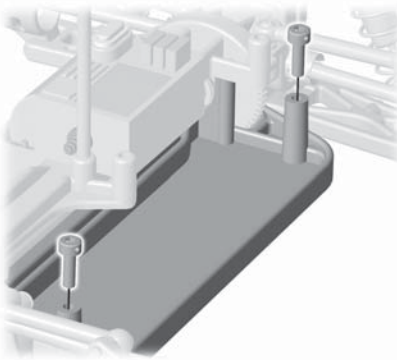

▶ Step 7

21013, **21238**, qty 1  
6 cell battery brace

21173, qty 2  
body clips

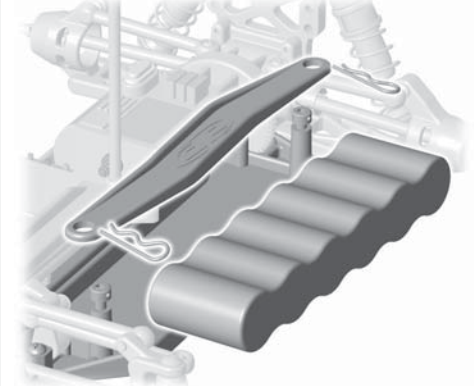

▶ Step 8

21058, qty 1  
18T white wheel

21059, qty 1  
18T mini pin tire/insert

21251 - front, qty 1  
21252 - rear, qty 1  
18B spoked wheel

21254, qty 1  
18B narrow mini pin tire/insert

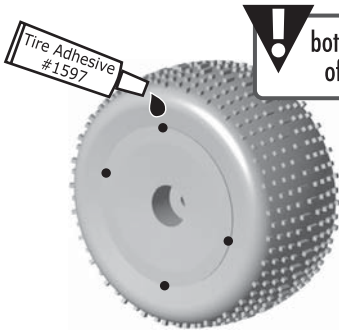

! both sides of tires

! **WARNING!**  
Follow the adhesive manufacturer's instructions for proper use and safety. Wear eye and hand protection.

▶ Wheels



▶ Tires



▶ Step 9

21060, qty 1  
18T wheel/tire/insert, mounted  
21065, qty 1  
18MT wheel/tire/insert, mounted

21096, qty 1  
stub axle pin

21096, qty 1  
stub axle spacer

21253, qty 1  
18B narrow wheel/tire/insert, mounted  
21255, qty 1  
18B standard wheel/tire/insert, mounted

25215, **25392**, qty 1  
M3 locknuts

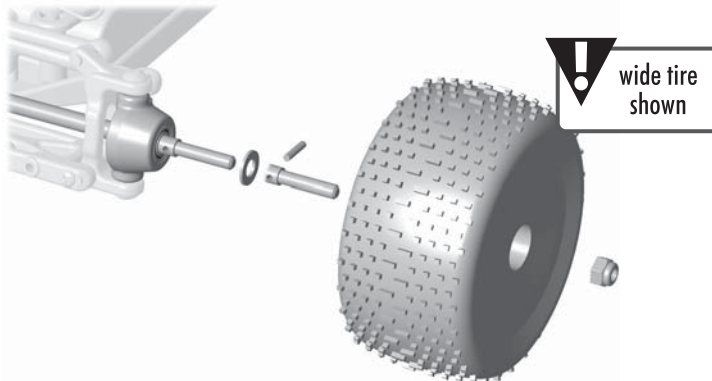

! wide tire shown

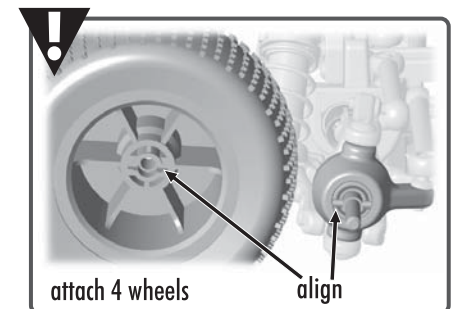

attach 4 wheels

align

▶ Step 10 - 18T/MT



21070/21071, 21074, qty 1  
18T body, blue/red/clear  
21072/21075, qty 1  
18MT body, flag design/clear



21173, qty 4  
body clips



21239, qty 1  
18MT flag kit

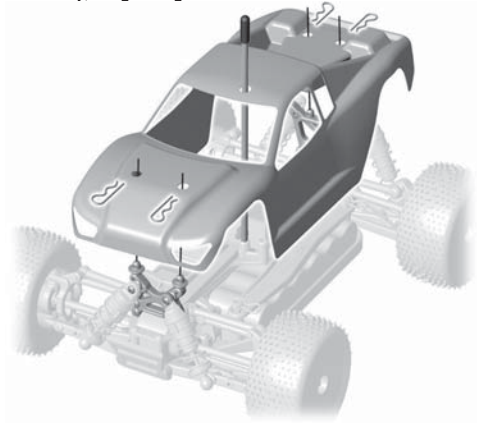

! locate into holes in bed of MT body

▶ Step 10 - 18B



21133, qty 2  
M2.5 x 6 bhps  
(for wing)



21139, qty 2  
M2.6 x 6 steel washer



21264/21257, qty 1  
18B wing, carbon, clear

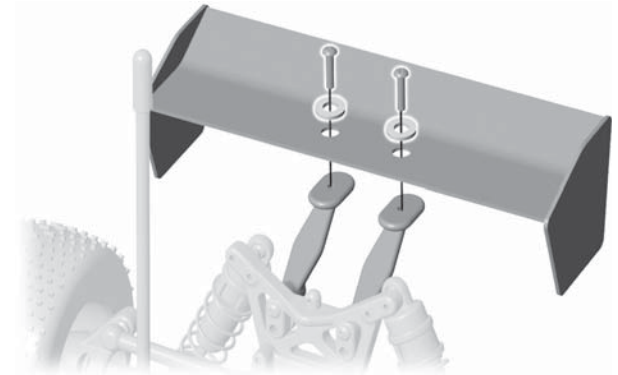

▶ Step 10 - 18B



21173, qty 4  
body clips



21260/21261/21256, qty 1  
18B body, red, orange, clear

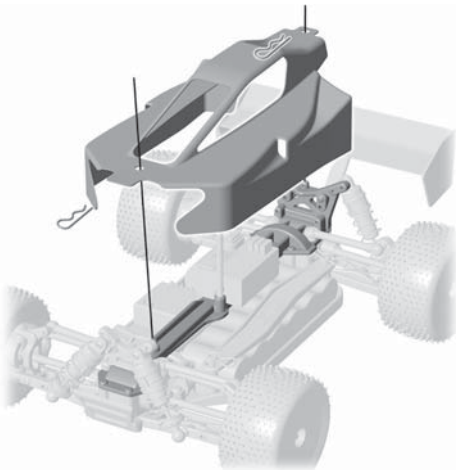

**RC18T Racing Truck**



**RC18B Offroad Buggy**



▶ Customer Support

Tel: 714.850.9342  
Fax: 714.850.1744

Hours: Monday-Friday  
8:00am - 4:00pm, pst



▶ Additional Support

Visit the following  
web sites for tips,  
setup help and  
racing information:



[www.RC10.com](http://www.RC10.com)  
[www.TeamAssociated.com](http://www.TeamAssociated.com)  
[www.CompetitionX.com](http://www.CompetitionX.com)



► Available AE Wheel/Tire Guide

**Mounted Wheel & Tire Sets**

All sets are mounted, glued and are sold in pairs.



	Black	White	Chrome	Dish	Spoked	Beadlock	Mini-Pin	Foam	Monster Truck	Narrow	Standard	Price
21060		X		X			X				X	\$12.99
21062			X	X			X				X	14.99
21065			X		X			X			X	17.99
21068		X		X			X				X	13.99
21253		X			X		X		X			12.99
21255		X			X		X			X		12.99
21271		X		X			X		X			12.99
21273			X	X			X		X			12.99
21276			X		X		X			X		12.99
21277	X				X		X		X			12.99
21280			X		X		X			X		12.99
21281	X				X		X			X		12.99

**Wheels**

All wheels and are sold in pairs.



	Black	White	Chrome	Dish	Spoked	Beadlock	Narrow	Standard	Price
21058		X		X				X	\$3.99
21061			X	X				X	5.99
21063			X		X			X	7.99
21250		X			X		X		3.99
21251		X		X			X		3.99
21252		X		X				X	3.99
21272			X	X			X		5.99
21274			X		X		X		5.99
21275	X				X		X		3.99
21278			X		X			X	5.99
21279	X				X			X	3.99

**Tires**

All tires and are sold in pairs.



	Mini-Pin	Monster Truck	Narrow	Standard	Price
21059	X			X	\$9.99
21064		X		X	10.99
21254	X		X		9.99

For additional information and pictures of all Team Associated 1:18 scale wheels and tires, go to:  
[www.RC10.com](http://www.RC10.com) -or- [www.TeamAssociated.com](http://www.TeamAssociated.com)

► 1:18 Series Body Guide



**RC18T**

- 21070 Painted Truck Body, blue, with decals
- 21071 Painted Truck Body, red, with decals
- 21074 Clear Truck Body, with decals & window mask



**RC18MT**

- 21072 Painted Monster Truck Flag Body, with decals
- 21075 Clear Monster Truck Body, with decals & window mask
- 21239 Monster Truck Flag Kit



**RC18B**

- 21256 Clear Buggy Body/Wing/Dirt Deflectors, with window mask
- 21260 Painted Buggy Body, red, with decals
- 21261 Painted Buggy Body, orange, with decals



- 21257 Clear Buggy Wing & Dirt Deflectors
- 21264 Graphite-Pattern Wing & Dirt Deflectors

# RC 18

For more setups and setup sheets, click here:  
www.RC10.com • www.TeamAssociated.com  
www.CompetitionX.com

Driver: \_\_\_\_\_  
Track: \_\_\_\_\_  
Event: \_\_\_\_\_  
Conditions: \_\_\_\_\_  
Additional Comments: \_\_\_\_\_

Date: \_\_\_\_\_  
 Indoor  Outdoor

## Front Suspension

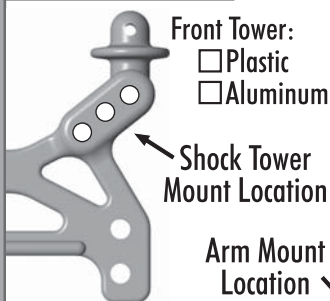

Front Arm:  
 Plastic  Aluminum

Notes: \_\_\_\_\_

### Upright

Ballstud:  Short  Long  
Ballstud Washers: \_\_\_\_\_  
Steering Block:  
 Plastic  
 Aluminum

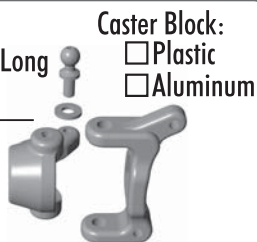

### Shocks

Piston: \_\_\_\_\_ Oil: \_\_\_\_\_ wt  
Spring: \_\_\_\_\_ Limiters: \_\_\_\_\_  
Ride Height: \_\_\_\_\_ mm  
Shock Body:  Plastic  Threaded Aluminum

### Alignment

Camber: \_\_\_\_\_°  
Inner Camber Shims: \_\_\_\_\_  
Toe: \_\_\_\_\_°

### Differential

Diff Setting: \_\_\_\_\_  
 Solid Axle  
 Oneway

### Drivebones

Plastic Dogbones  
 Aluminum Dogbones  
 MIP CVD's

## Rear Suspension

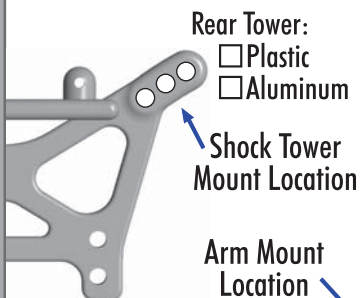

Rear Arm:  
 Plastic  Aluminum

Notes: \_\_\_\_\_

### Upright

Hub Carrier:  
 Plastic  
 Aluminum



### Anti-Squat

Standard - 0°  
 Optional - 3.5°

### Shocks

Piston: \_\_\_\_\_ Oil: \_\_\_\_\_ wt  
Spring: \_\_\_\_\_ Limiters: \_\_\_\_\_  
Ride Height: \_\_\_\_\_ mm  
Shock Body:  Plastic  Threaded Aluminum

### Alignment

Camber: \_\_\_\_\_°  
Inner Camber Shims: \_\_\_\_\_

### Differential

Diff Setting: \_\_\_\_\_  
 Solid Axle

### Drivebones

Plastic Dogbones  
 Aluminum Dogbones  
 MIP CVD's

## Body & Wing

Body: \_\_\_\_\_ Wing: \_\_\_\_\_  
Notes: \_\_\_\_\_

## Tires

<b>Front</b>	<b>Rear</b>
Type: _____	Type: _____
Insert: _____	Insert: _____
Wheel: _____	Wheel: _____
Traction Compound: _____	
Notes: _____	

## Electronics

Motor: \_\_\_\_\_ Gear: \_\_\_\_\_ t/ \_\_\_\_\_ t  
Motor Brush: \_\_\_\_\_ Motor Spring: \_\_\_\_\_  
Motor Timing: \_\_\_\_\_  
Battery: \_\_\_\_\_ Position:  Fwd  Back  
ESC: \_\_\_\_\_ Mode: \_\_\_\_\_  
Drag Brake: \_\_\_\_\_ Initial Brake: \_\_\_\_\_

## Race Comments

Main: \_\_\_\_\_ Qualifying Position: \_\_\_\_\_ Finish: \_\_\_\_\_  
Notes: \_\_\_\_\_

## Car Comments

Notes: \_\_\_\_\_  
\_\_\_\_\_  
\_\_\_\_\_



# 1:18 Factory Team Parts

21031	FT Aluminum Dogbones, blue	Pr.	\$8.99
21055	FT Titanium Turnbuckle Set	Set	29.99
21093	FT Aluminum Finned Motor Mount, blue	1	14.99
21116	FT Carbide Diff Balls	8	6.99
21214	FT Alum. Threaded Shock Body, front, blue, w/collar	Pr.	12.99
21215	FT Alum. Threaded Shock Body, rear, blue, w/collar	Pr.	12.99
21216	FT Alum. Threaded Shock Kit, front, blue	Pr.	19.99
21217	FT Alum. Threaded Shock Kit, rear, blue	Pr.	19.99
21220	Factory Blue Aluminum Suspension Arms, blue	Pr.	29.99
21221	Factory Blue Aluminum Shock Tower, front (T/MT)	1	24.99
21222	Factory Blue Aluminum Shock Tower, rear (T/MT)	1	29.99
21223	Factory Blue Aluminum Steering Blocks, blue	Pr.	29.99
21224	Factory Blue Aluminum Hub Carriers, blue	Pr.	29.99

21225	Factory Blue Aluminum Caster Blocks, 0 deg, blue	Pr.	\$29.99
21227	Body Mount Supports, for front aluminum tower	2	1.99
21230	MIP CVD Assemblies	Pr.	21.99
21231	MIP Rebuild Kit	Set	3.99
21238	FT Woven Graphite Battery Strap	1	9.99
21240	Factory Billet Aluminum Upgrade Kit (T/MT)	Set	199.99
21241	FT Blue Aluminum Ballstuds	10	12.99
21243	FT Blue Outdrive Sleeves	4	7.99
21265	Factory Blue Aluminum Shock Tower, front (B)	1	17.99
21266	Factory Blue Aluminum Shock Tower, rear (B)	1	29.99
21270	Factory Billet Aluminum Upgrade Kit (B)	Set	199.99
25392	FT Aluminum M3 Locknuts, blue	10	7.99
29137	FT Aluminum XPS ESC Heatsink, blue	1	3.99



**21116**  
Carbide Diff Balls

**21223, 21224, 21225, 21221, 21222**  
Alum Steering & Caster Blocks, Hub Carriers, Shock Towers



**21230**  
MIP CVD Assemblies



**21055**  
Titanium Turnbuckles



**21238**  
Graphite Battery Strap

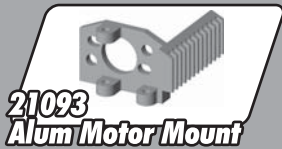

**21093**  
Alum Motor Mount



**21220**  
Alum Suspension Arms



**21061**  
Chrome Dish Wheels

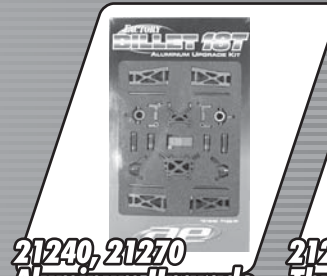

**21240, 21270**  
Aluminum Upgrade Kits

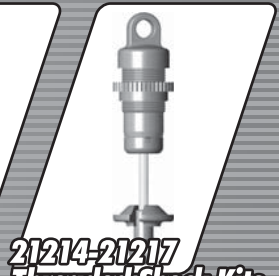

**21214-21217**  
Threaded Shock Kits



**25392**  
Alum M3 Locknuts



**29137**  
XPS ESC Heatsink



**21031**  
Aluminum Dogbones

Check our web site at [www.TeamAssociated.com](http://www.TeamAssociated.com) or [www.RC10.com](http://www.RC10.com) for the latest updates to our 18T line!!!

## Tools

1111	Factory Team Turnbuckle Wrench	1	\$5.99
1541	Factory Team Hex Driver Set, 7 pieces	Set	59.99
1542	Factory Team Hex Driver, .050"	1	10.50
1543	Factory Team Hex Driver, 1/16"	1	10.50
1544	Factory Team Hex Driver, 1.5mm	1	10.50
1545	Factory Team Hex Driver, 5/64"	1	10.50
1546	Factory Team Hex Driver, 3/32"	1	10.50
1547	Factory Team Hex Driver, 2.5mm	1	10.50
1548	Factory Team Hex Driver, 3mm	1	10.50
1561	Factory Team Nut Driver Set, 6 pieces	Set	69.99
1562	Factory Team Nut Driver, 3/16"	1	12.99
1563	Factory Team Nut Driver, 1/4"	1	12.99
1564	Factory Team Nut Driver, 5.5mm	1	12.99
1565	Factory Team Nut Driver, 11/32"	1	12.99
1566	Factory Team Nut Driver, 7mm	1	12.99
1567	Factory Team Nut Driver, 8mm	1	12.99
1593	Factory Team Body Reamer Tip	1	9.95
1594	Factory Team Body Reamer	1	22.00
1737	Factory Team Body Scissors	1	5.99

## Shock-Oil

5420	10 Weight Silicone Shock Oil, 2oz bottle	1	\$3.50
5421	20 Weight Silicone Shock Oil, 2oz bottle	1	3.50
5422	30 Weight Silicone Shock Oil, 2oz bottle	1	3.50
5423	40 Weight Silicone Shock Oil, 2oz bottle	1	3.50
5425	80 Weight Silicone Shock Oil, 2oz bottle	1	3.50
5427	15 Weight Silicone Shock Oil, 2oz bottle	1	3.50
5428	25 Weight Silicone Shock Oil, 2oz bottle	1	3.50
5429	35 Weight Silicone Shock Oil, 2oz bottle	1	3.50
5435	50 Weight Silicone Shock Oil, 2oz bottle	1	3.50
5436	60 Weight Silicone Shock Oil, 2oz bottle	1	3.50
5437	70 Weight Silicone Shock Oil, 2oz bottle	1	3.50

## Apparel

SP409	Associated Team Cap, dark blue. Size: S or L.	1	\$19.99
SP50	AE Flame T-Shirt, black. Size: S/M/L/XL/XXL	1	15.99
SP52	AE Flame T-Shirt, blue. Size: S/M/L/XL/XXL	1	15.99

## Decals

3820	AE Logo Decal Sheet	1	\$2.00
3834	AE Blue Embossed Logo Sticker, 4" with silver trim	1	3.00
21069	18T Sticker Sheet & Window Mask	1	3.99
21076	18MT Sticker Sheet & Window Mask	1	3.99