

10R5 FACTORY Team

1:10 Scale Electric 2WD Competition Car Kit



1:10 Scale Electric 2WD Competition Car Kit Manual

TEAM ASSOCIATED



Thank you!

...for selecting this Team Associated model.

Associated's Factory Team RC10R5 is Area-51's answer to the newly formed World GT class. Based off the entirely new RC12R5 platform, along with many decades of race winning experience and new ideas, the RC10R5 spec chassis conforms to WGT's rules and regulations. The result is a cost effective race car that offers the performance and durability to stand up to the highest demands of racing.....Associated's Factory Team RC10R5!

Team Associated wants you to enjoy the process of building, driving and maintaining your new model. If you discover any problems or need help with the assembly of your model, please give us a call and we will do our very best to help you!

Manual

Examine each step carefully before building. Special notes will be listed for each step.

Bags

Open the bags in order according to each step. Some bags contain a large amount of small parts. We recommend using a small container to keep the parts together.

Items Needed

You will need the following to complete you vehicle:

1. R/C two channel surface frequency radio system.
2. Electronic Speed Control.
3. R/C Electric Motor.
4. Battery pack (4-cell).
5. Peak detection battery charger
6. Pinion gear (64P).
7. 200mm scale Lexan body.
8. Wheels and tires.

Customer Support

Tel: 949.544.7500
Fax: 949.544.7501

Hours: Monday-Friday
8:00am - 4:00pm, pst

Visit the following web sites for tips, setup help and racing information:

www.RC10.com
www.TeamAssociated.com



Supplied

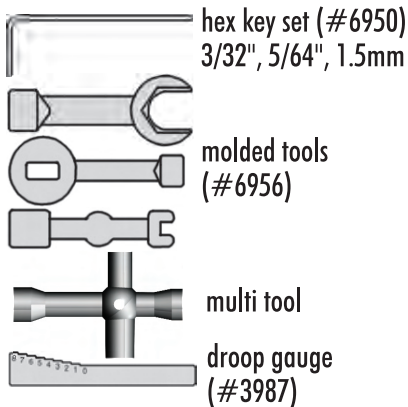

Recommended

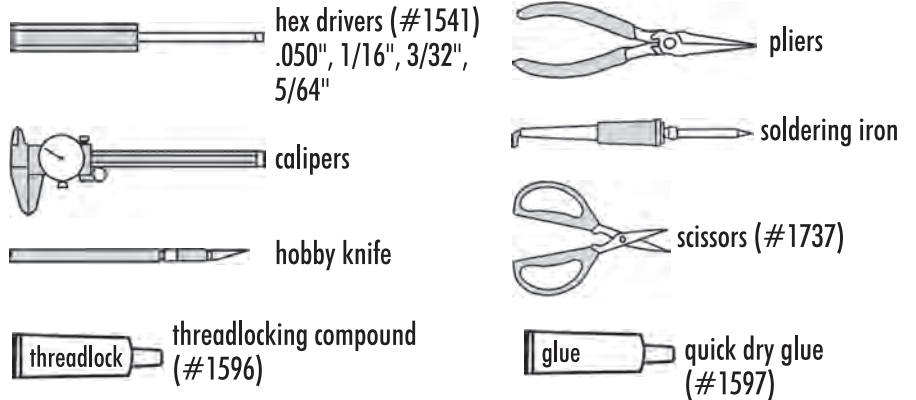

Suppl.

We are constantly developing new parts to improve our kits. These changes, if any, will be noted on supplementary sheets located in the appropriate parts bags. Check each bag for these sheets before you start to build.

Notes

There is an included 1:1 fold out in the back of the manual. Fold it out while building your kit for easy parts sizing!

:: Shocks

BAG A

STEP 1

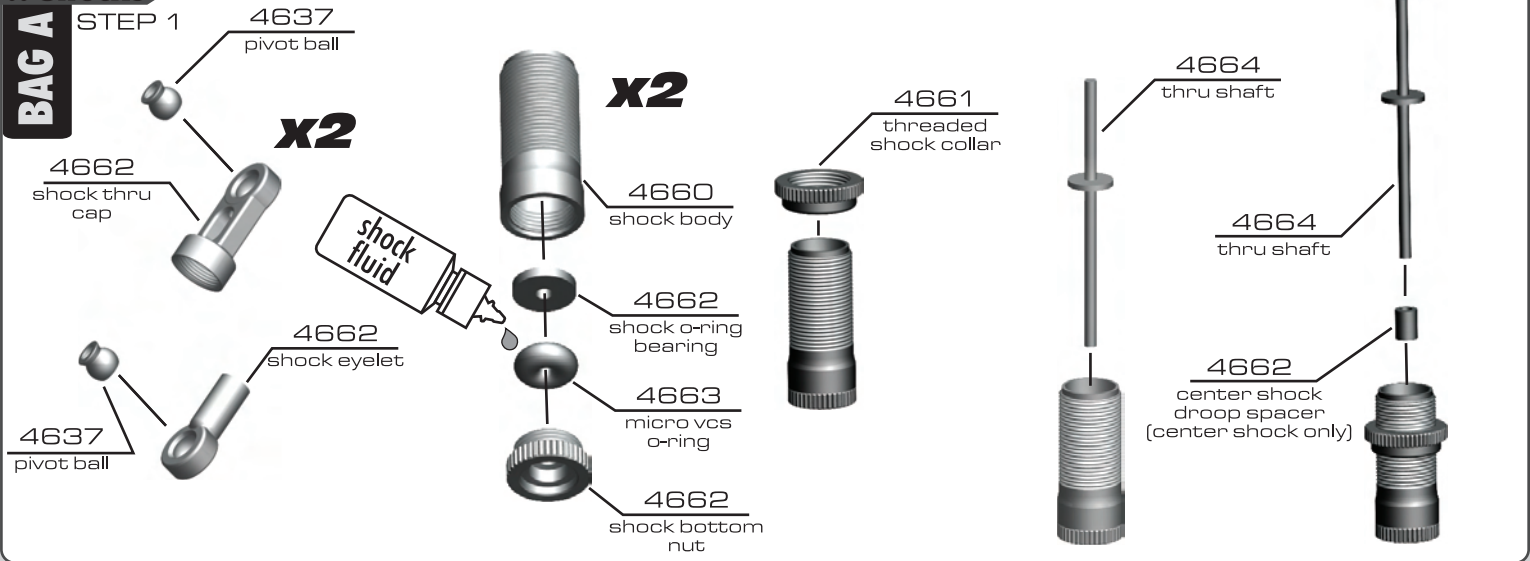

:: Shocks (cont.)

STEP 2

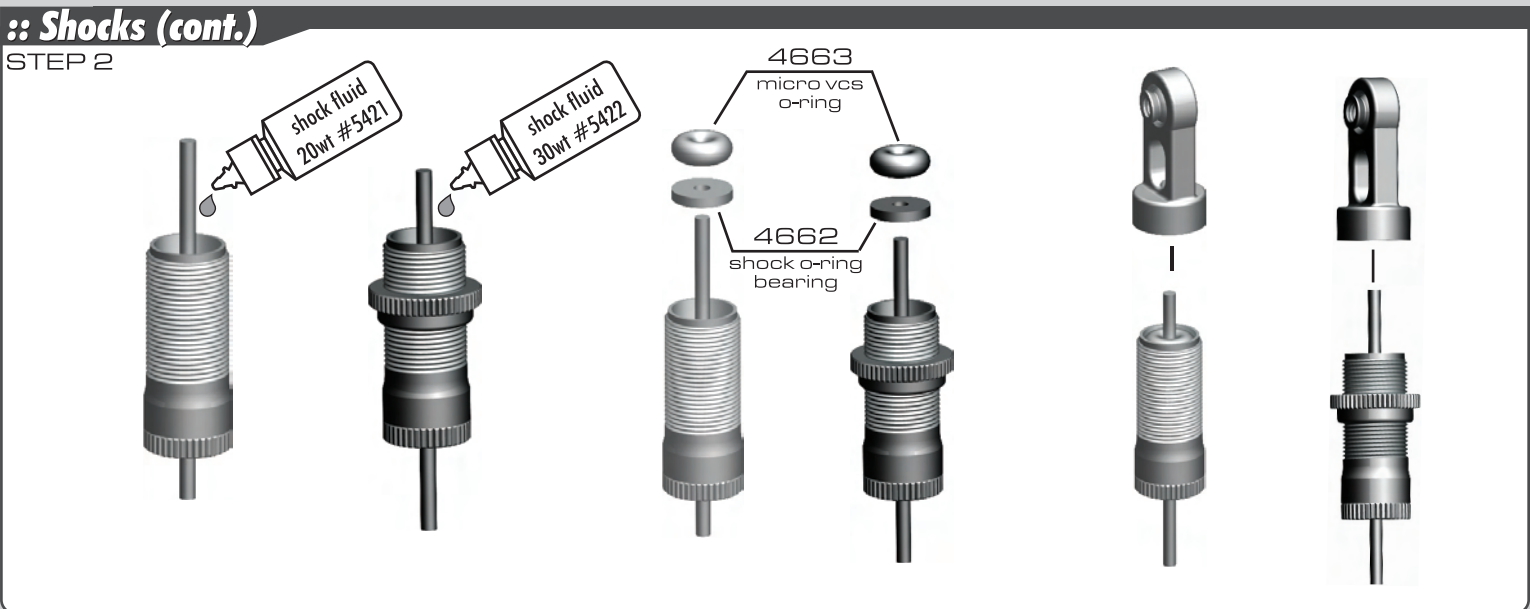

:: Shocks (cont.)

STEP 3

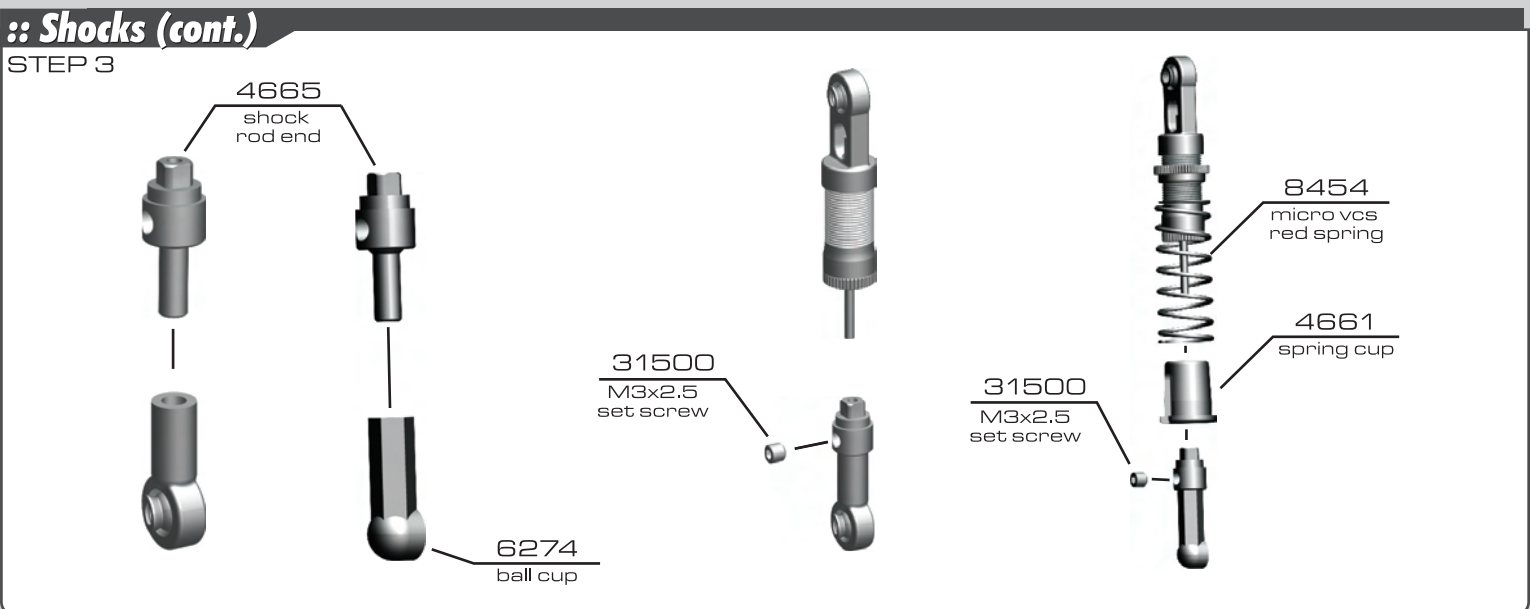

:: Turnbuckles

BAG B

STEP 1

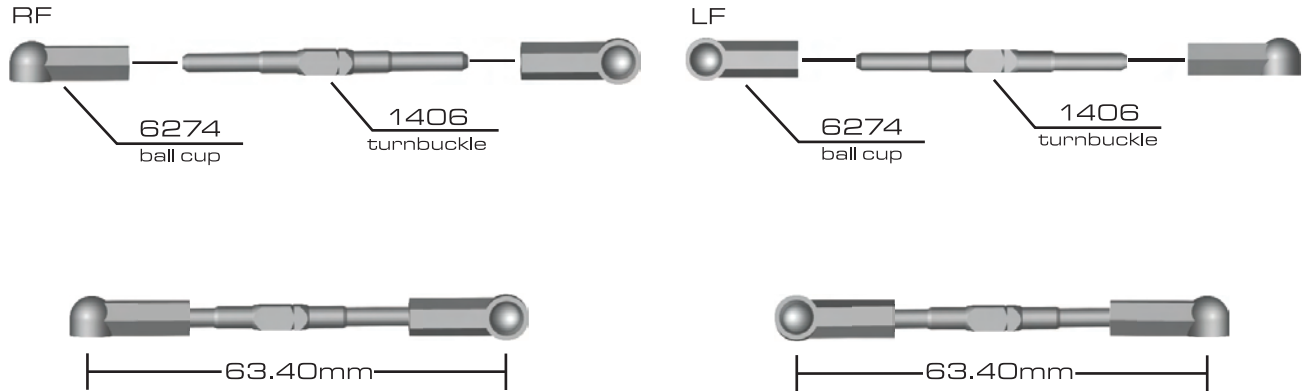

:: Chassis Prep

STEP 2



:: Pivot Brace Link Assemblies

BAG C

STEP 1

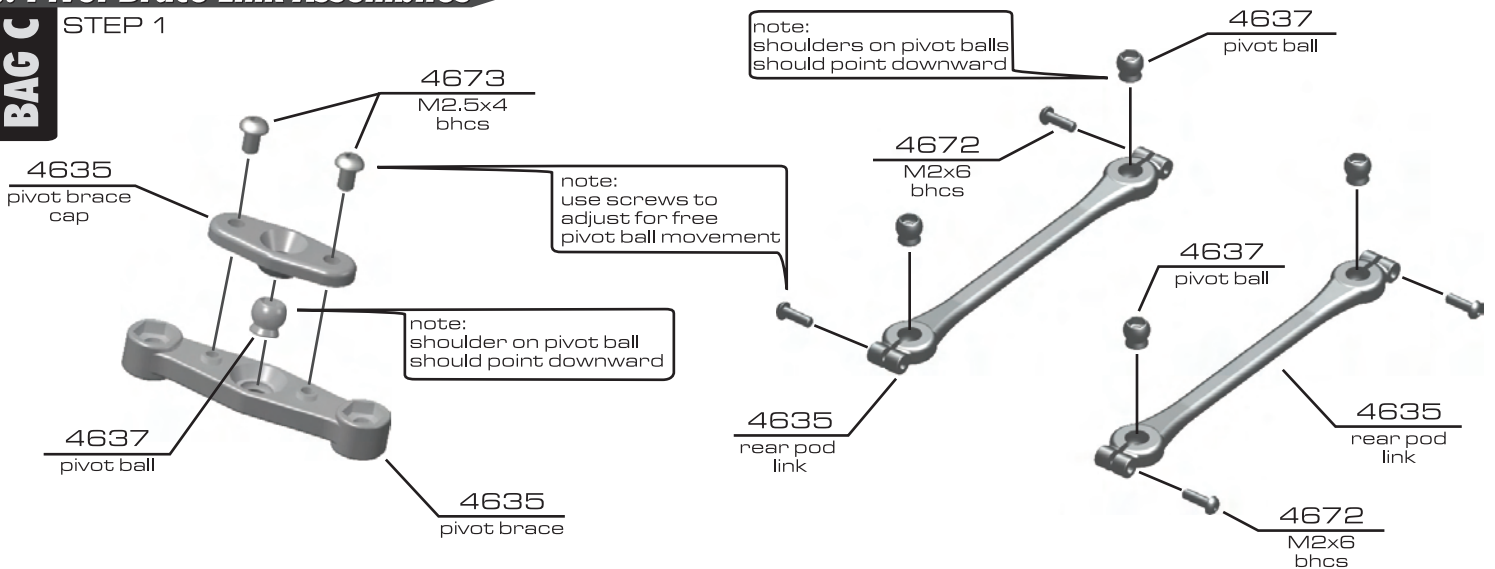

:: Pivot Brace (cont.)

STEP 2

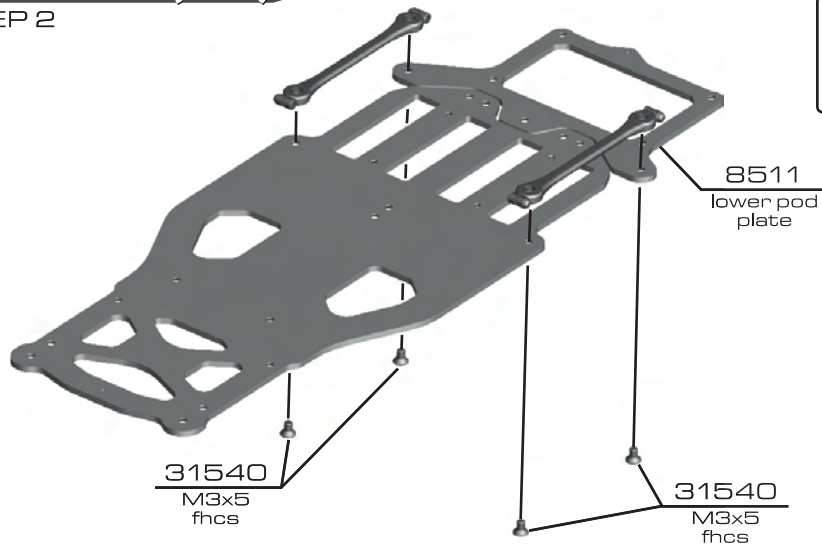

note:
leave the locknuts loose,
rock the chassis and the
backplate side to side.
Slowly tighten each side
so the plates rotate freely.

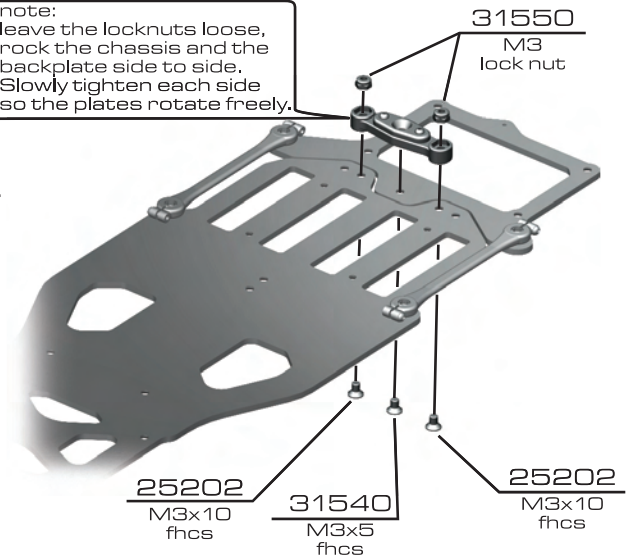

:: Motor Mounts

STEP 3

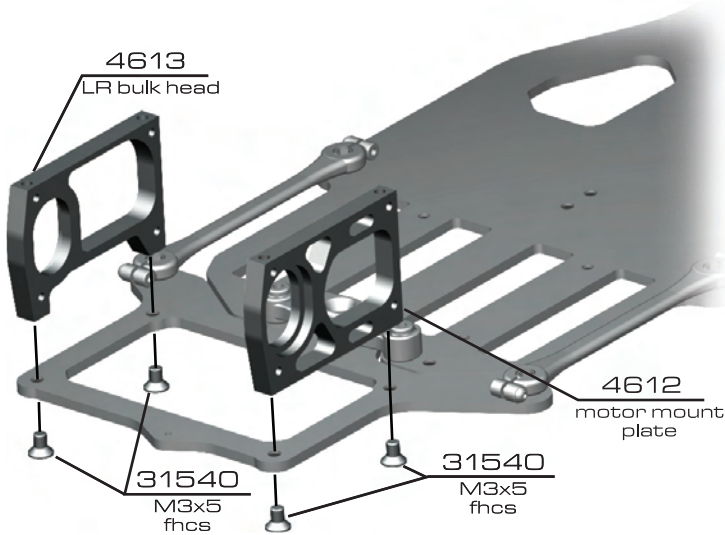

:: Chassis Brace

STEP 4

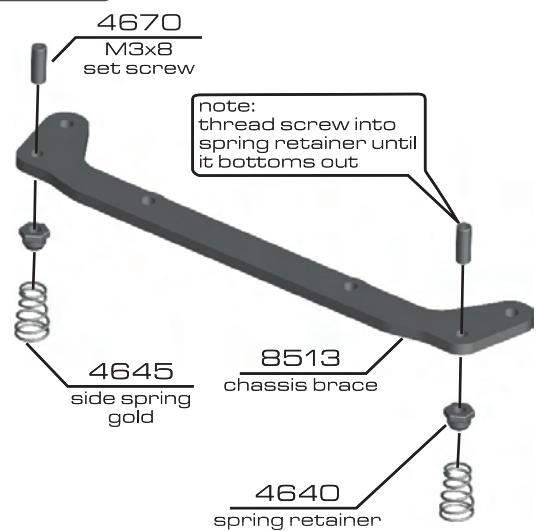

note:
thread screw into
spring retainer until
it bottoms out

:: Chassis Brace (cont.)

STEP 5

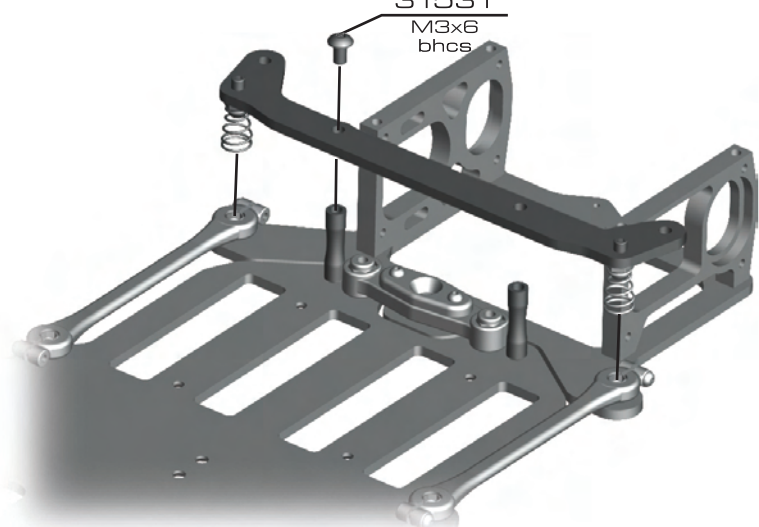
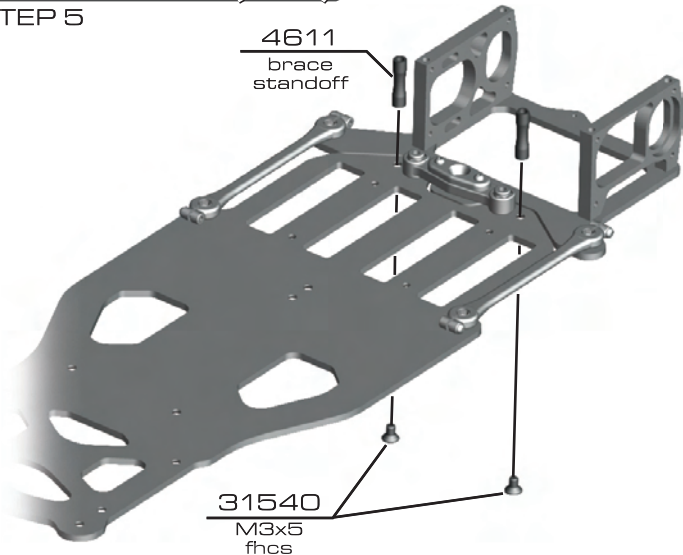

:: Upper Pod Plate / Side Shock

STEP 6

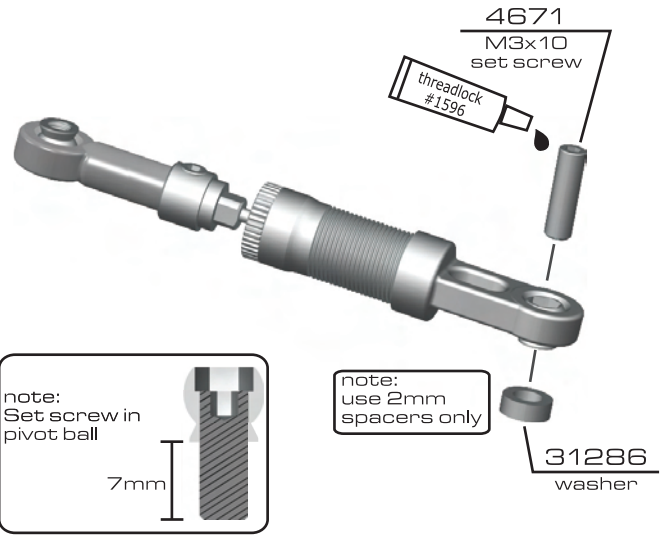
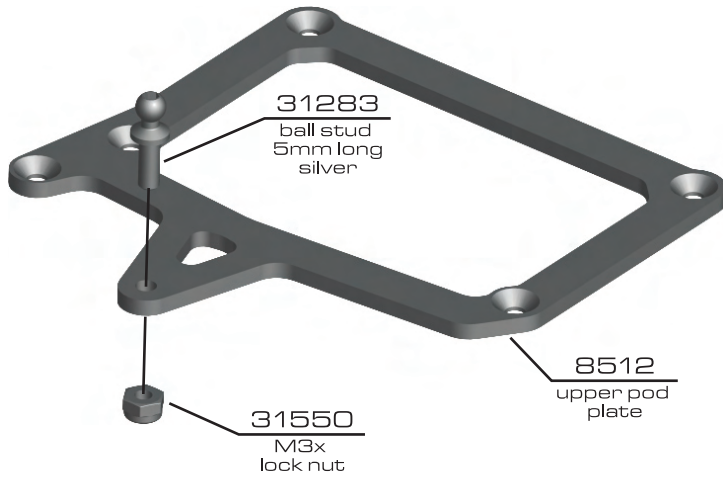

:: Upper Pod Plate / Side Shock (cont.)

STEP 7

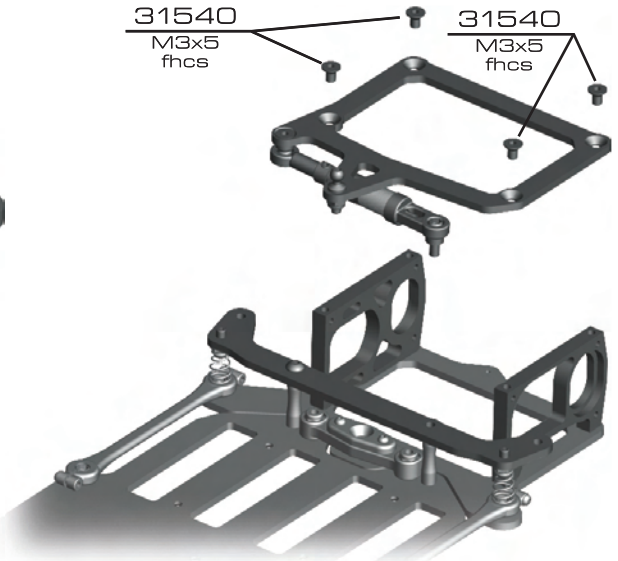
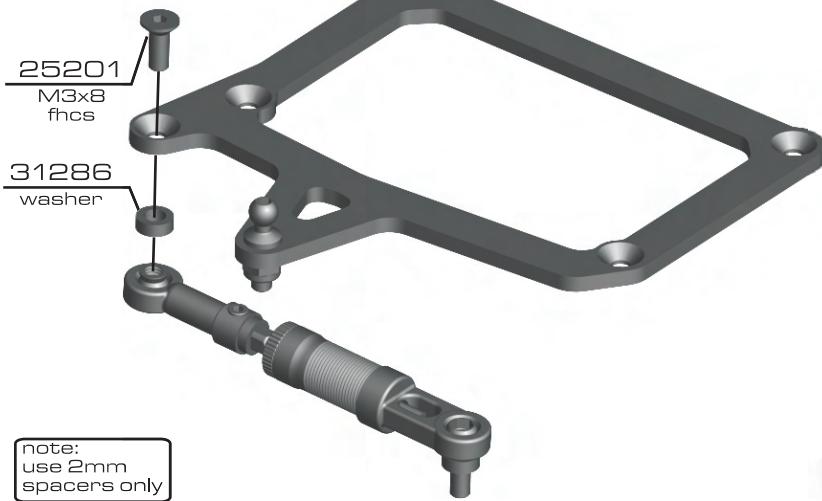

:: Front Arms

STEP 1

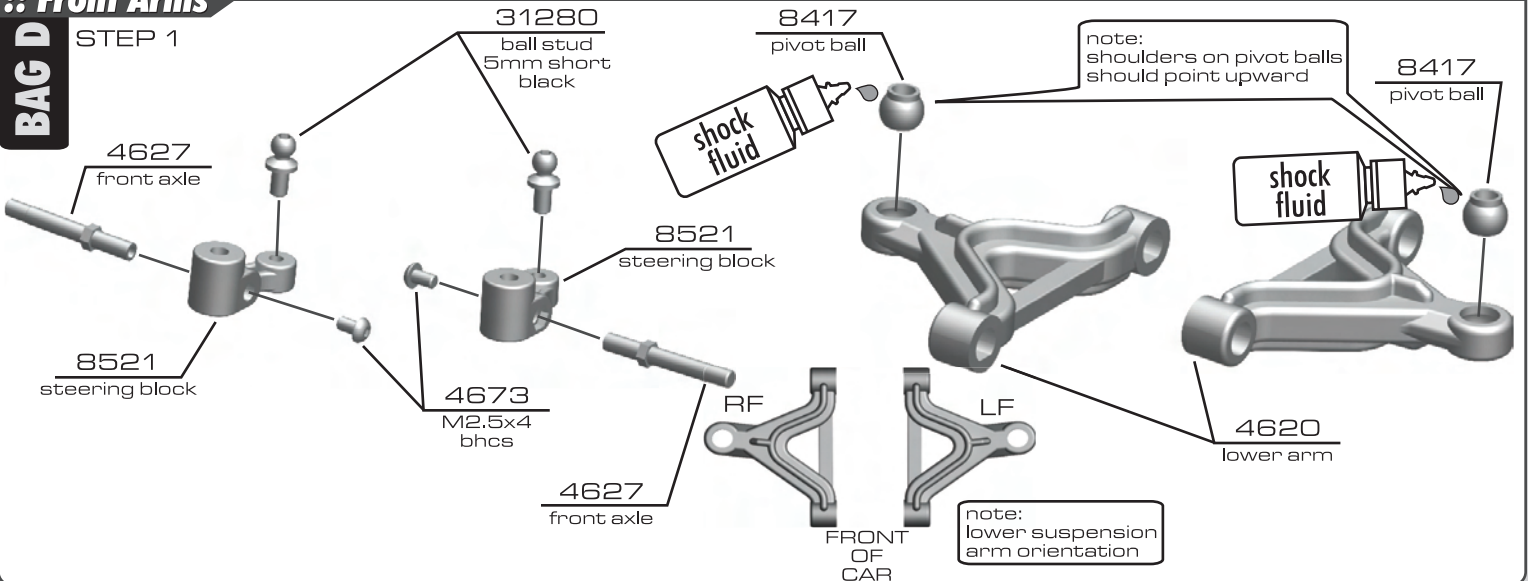

BAG D

:: Front Arms (cont.)

STEP 2

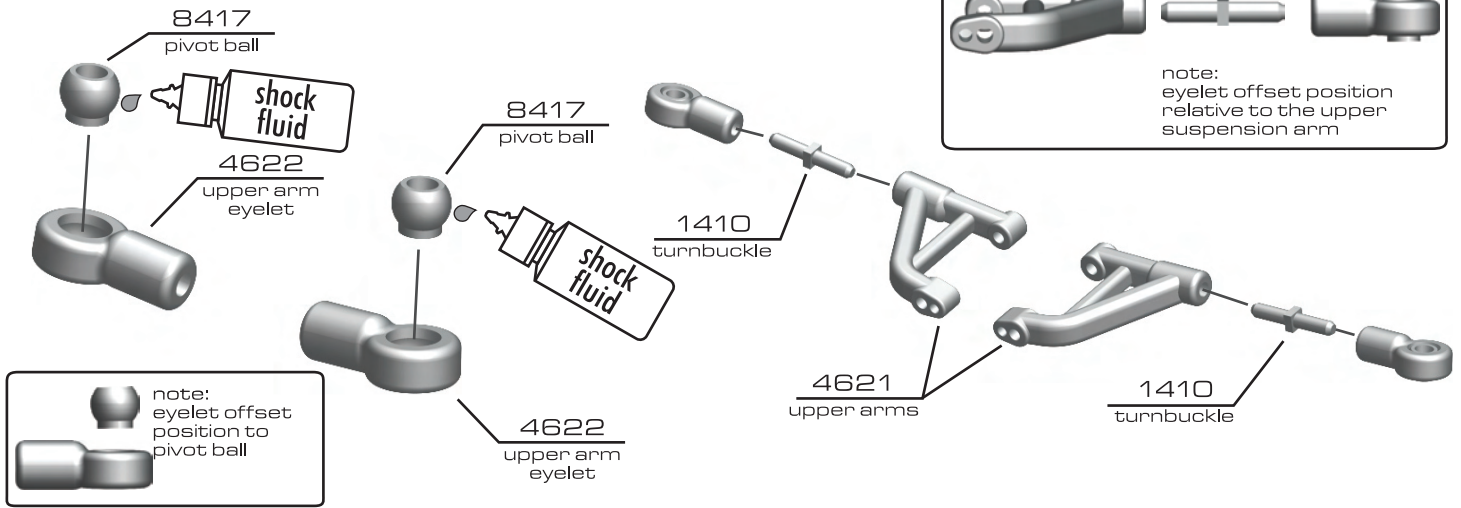

:: Front Arms (cont.)

STEP 3

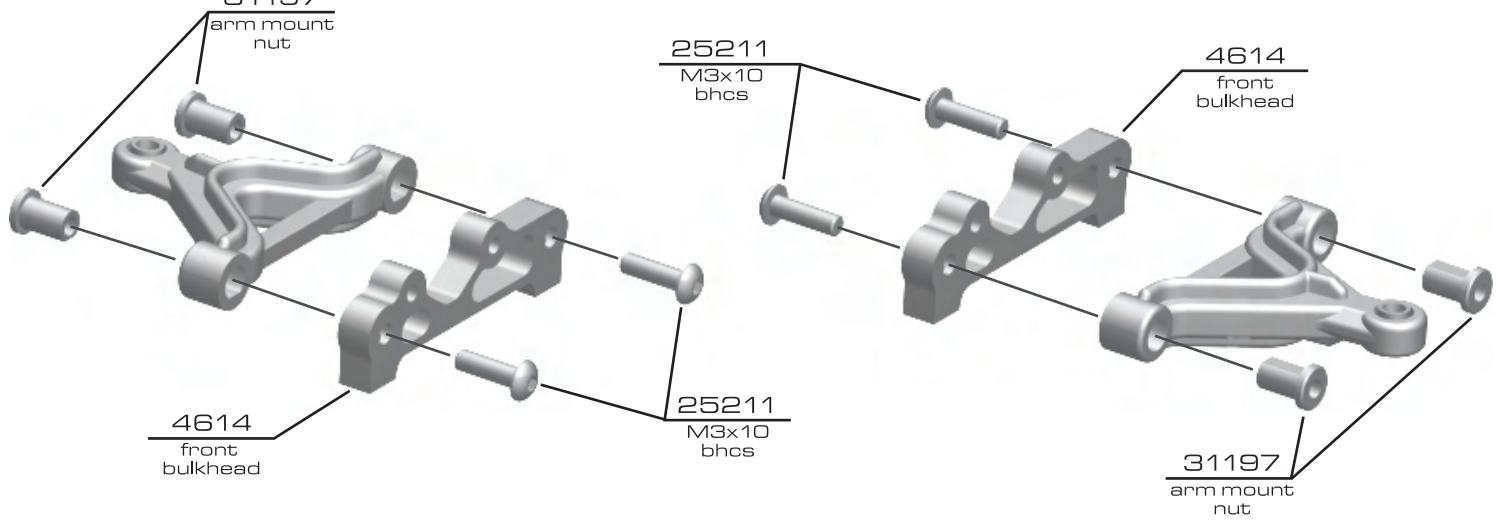

:: Front Arms (cont.)

Upper Suspension Mount Active Caster Settings

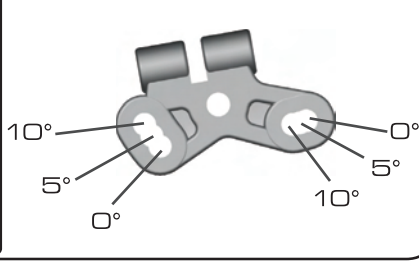

STEP 4

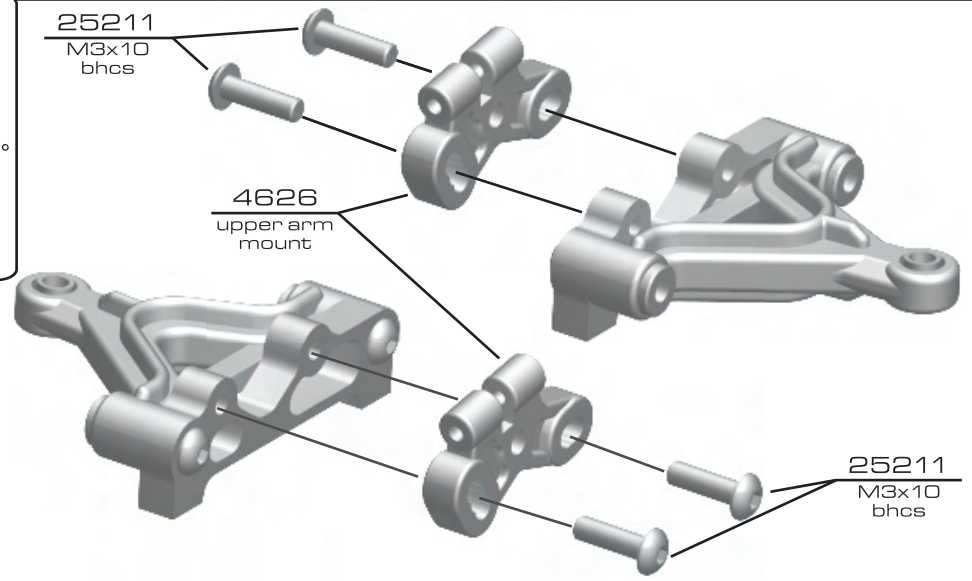

:: Front Arms (cont.)

STEP 5

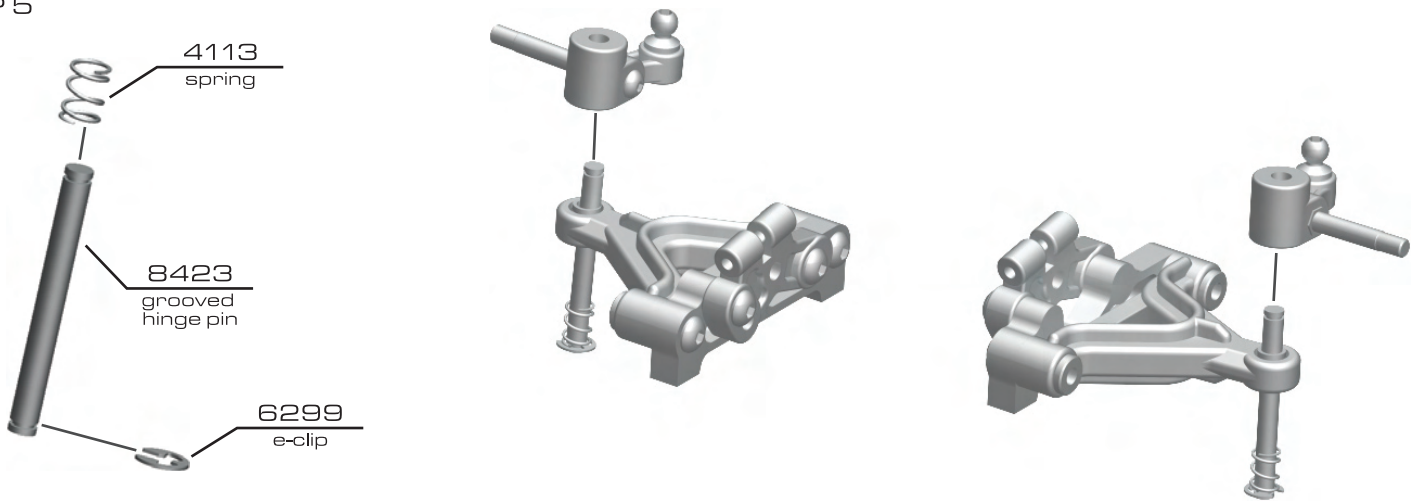

:: Front Arms (cont.)

STEP 6

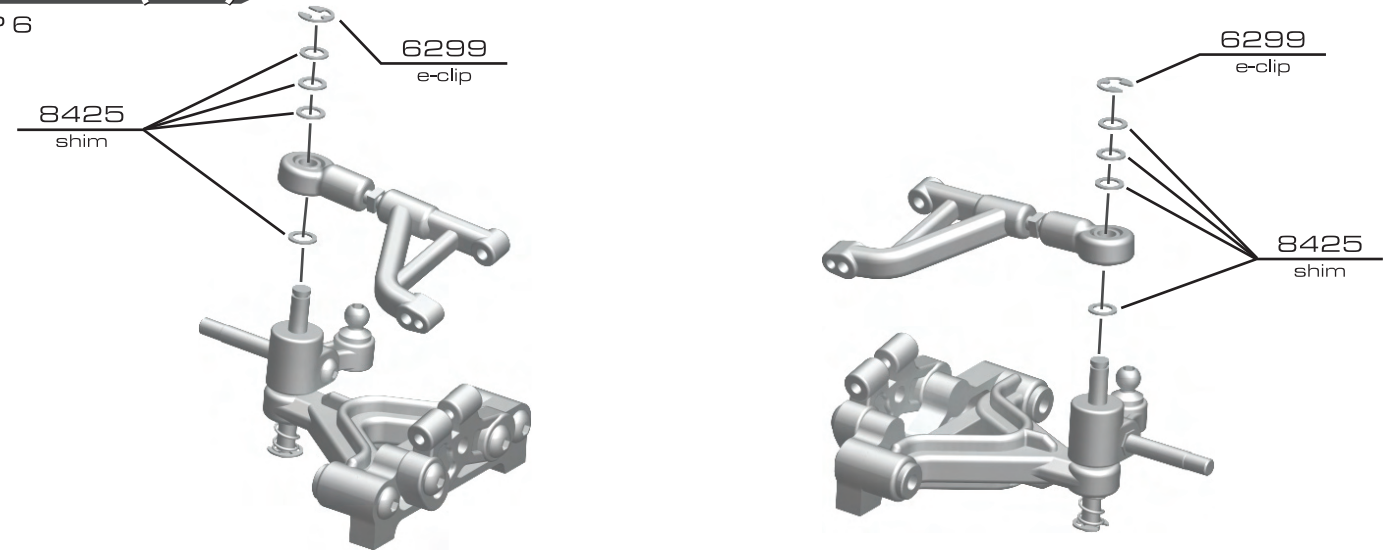

:: Front Bulkhead

STEP 7

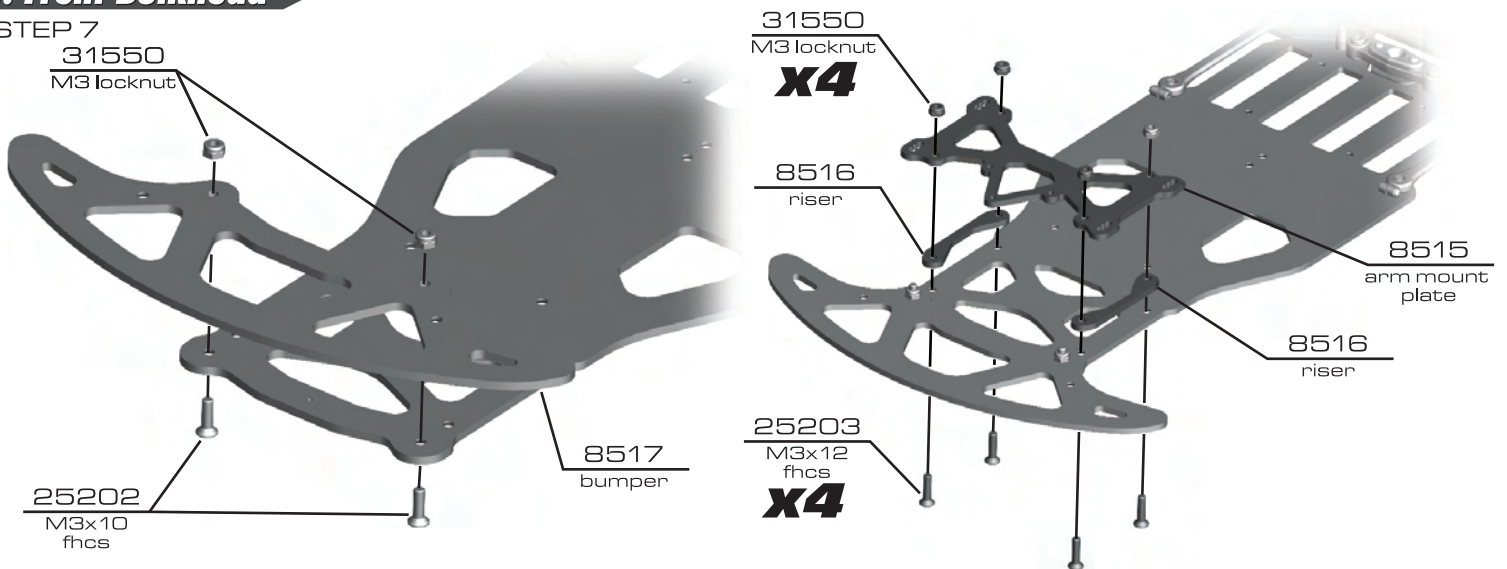

:: Front Bulkhead (cont.)

STEP 8

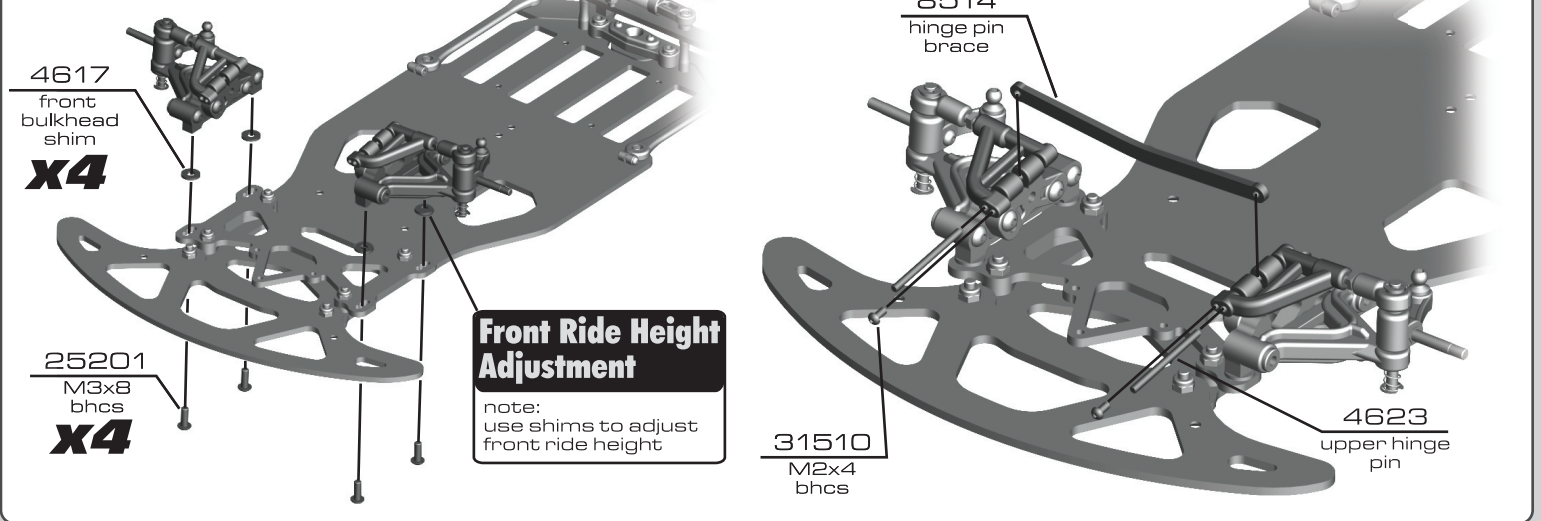

:: Front Bulkhead (cont.)

STEP 9

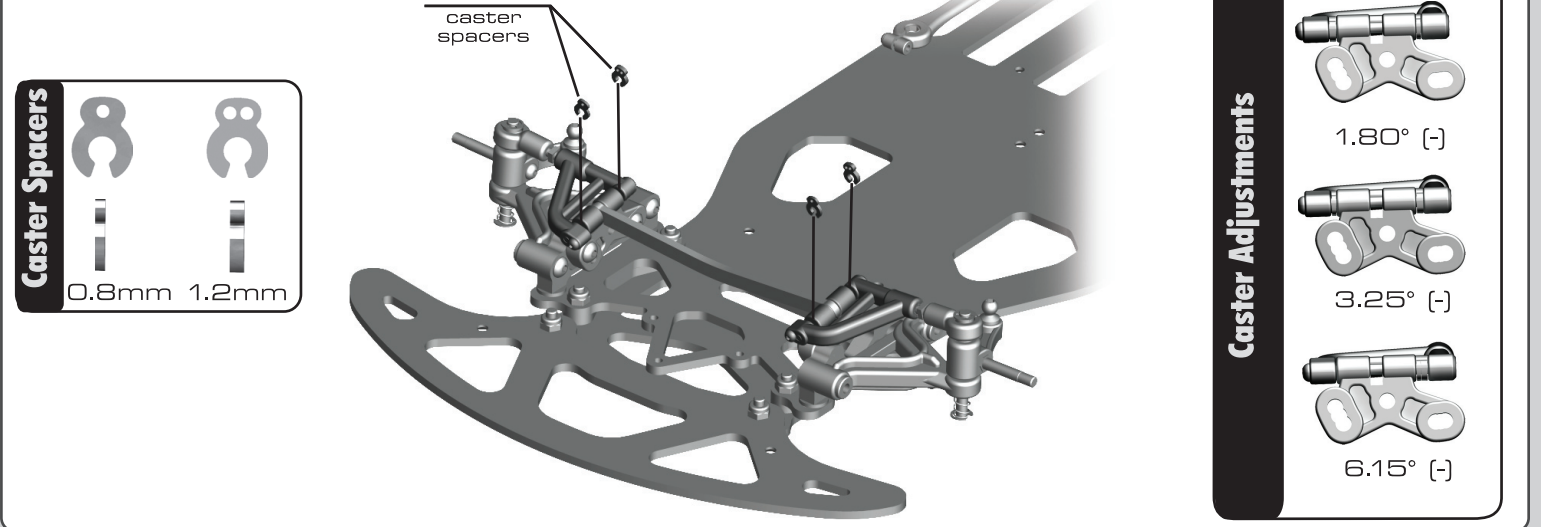

:: Rear Axle

STEP 1

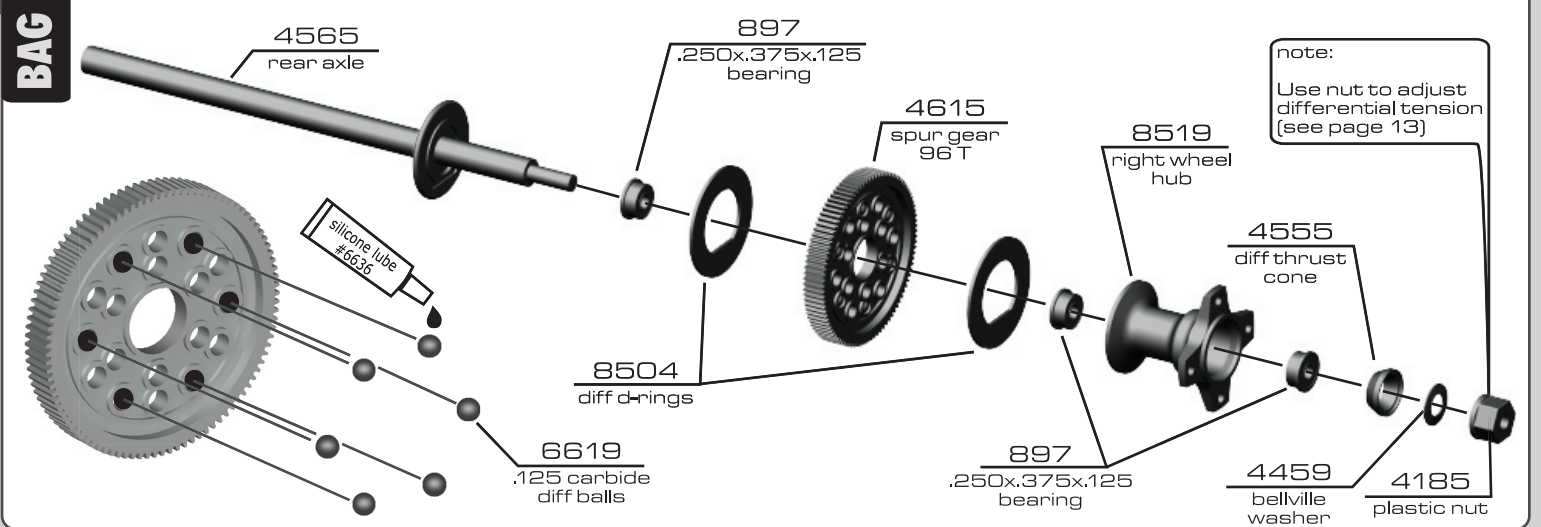

:: Rear Axle (cont.)

STEP 2

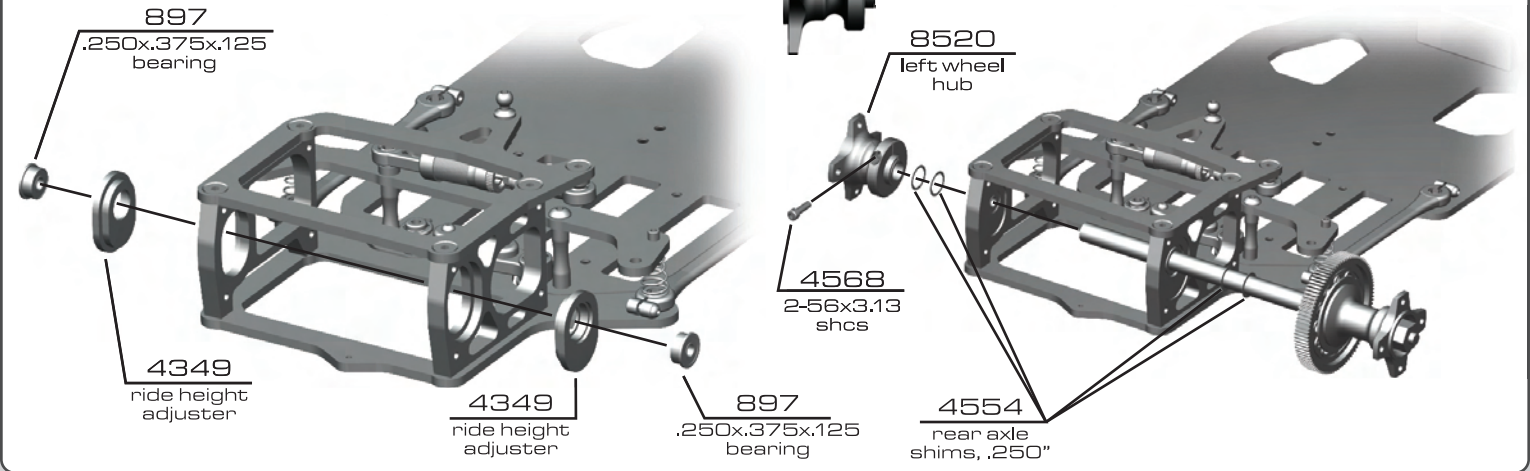

:: Center Shock

BAG F

STEP 1

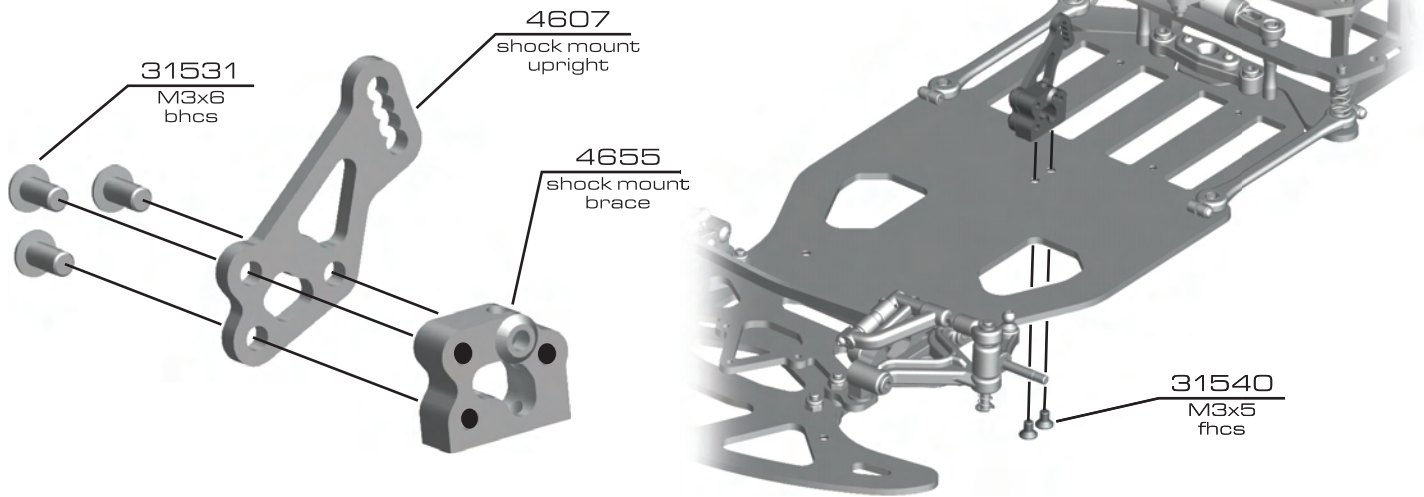

:: Center Shock (cont.)

STEP 2

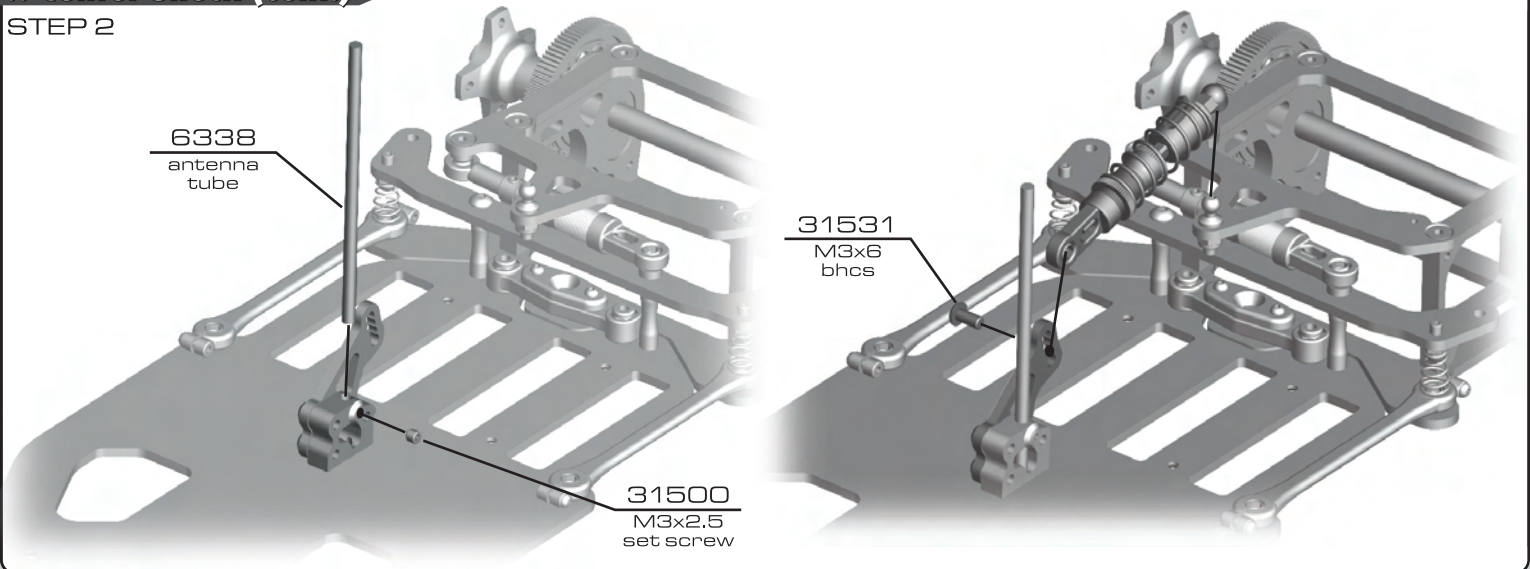

:: Servo Assembly

STEP 3

Ackerman Adjustment Spacers

note:
use spacers to
adjust ackerman
settings

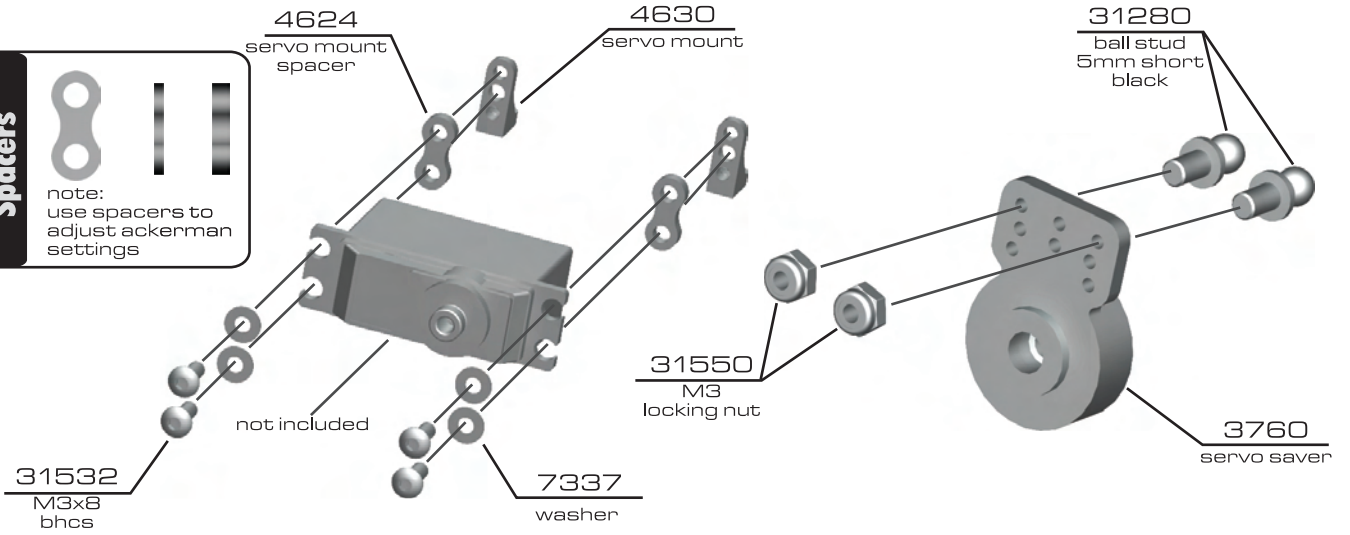

:: Servo Assembly (cont.)

STEP 4

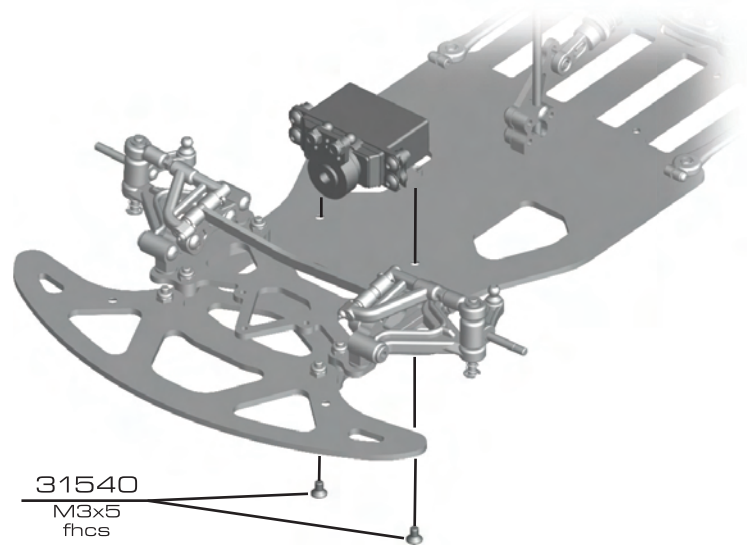
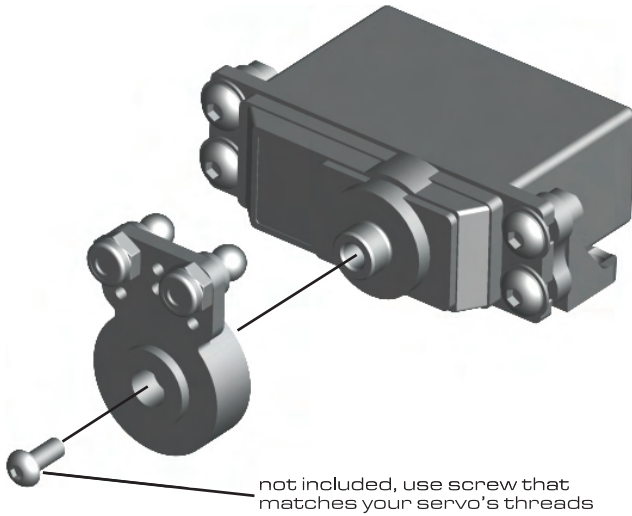

:: Servo Assembly (cont.)

STEP 5

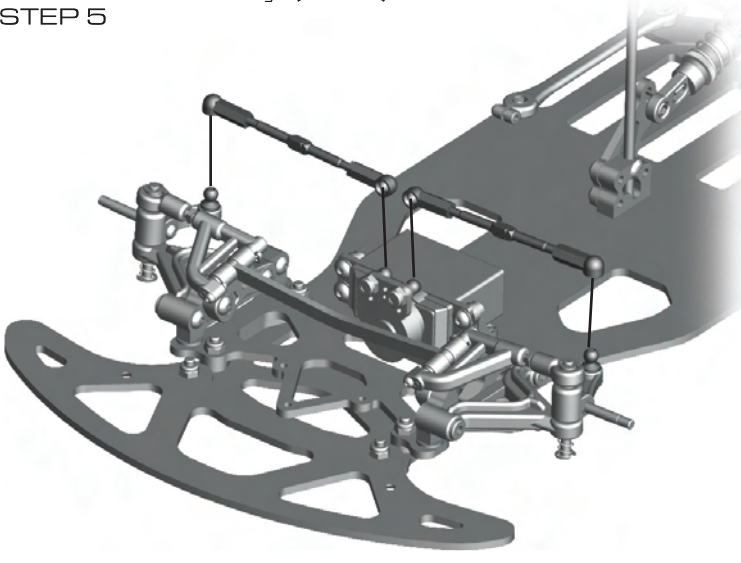

:: Body Posts

STEP 6

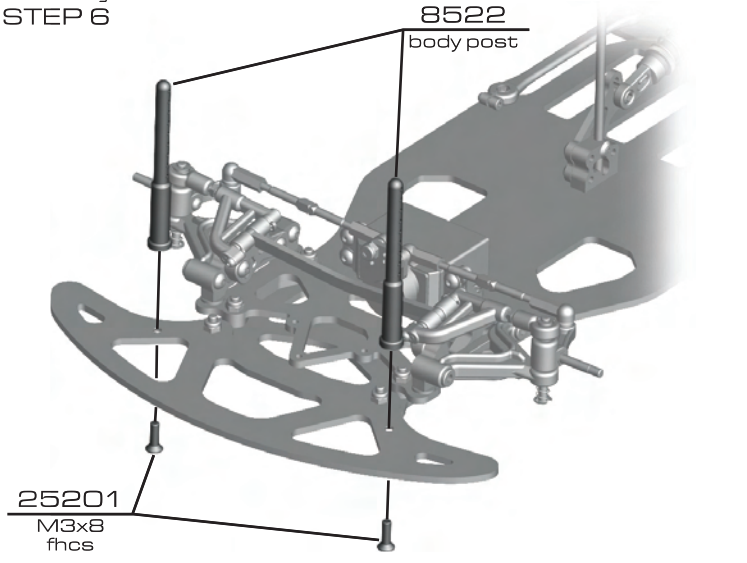

:: Body Posts (cont.)

STEP 7

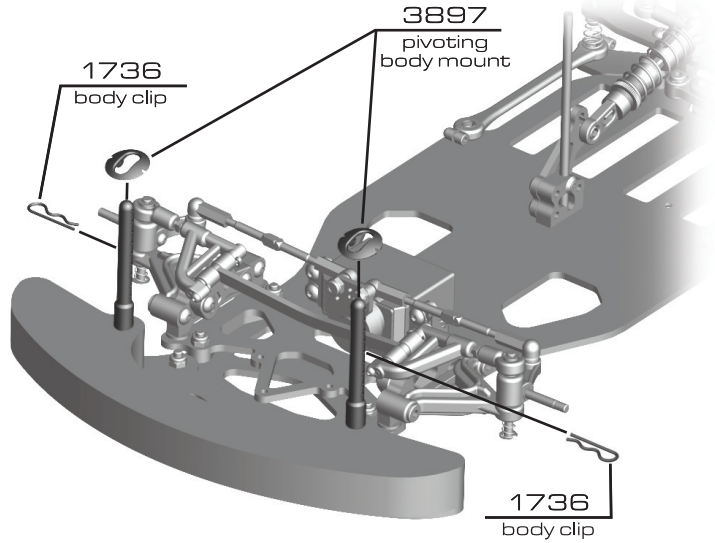
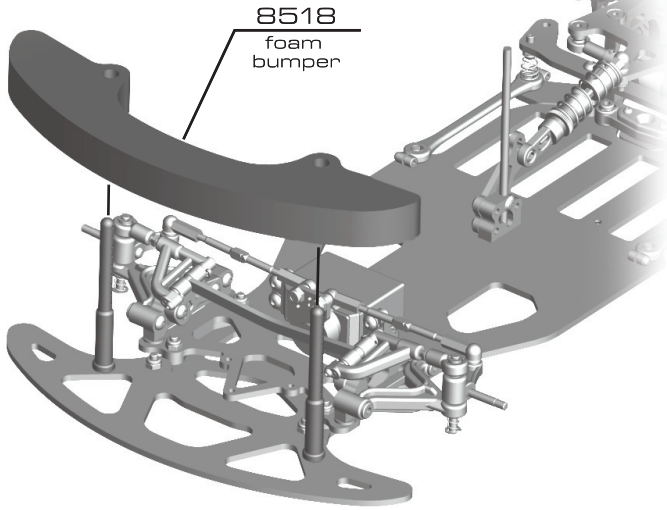

:: Body Posts (cont.)

STEP 8

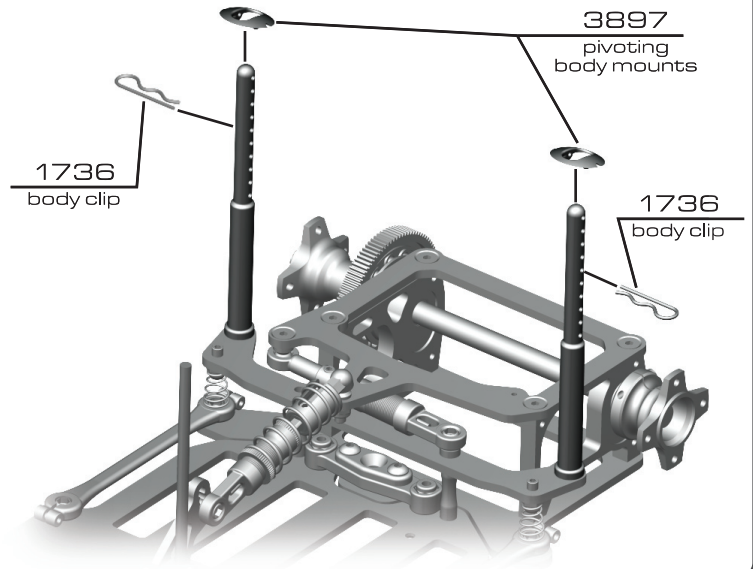
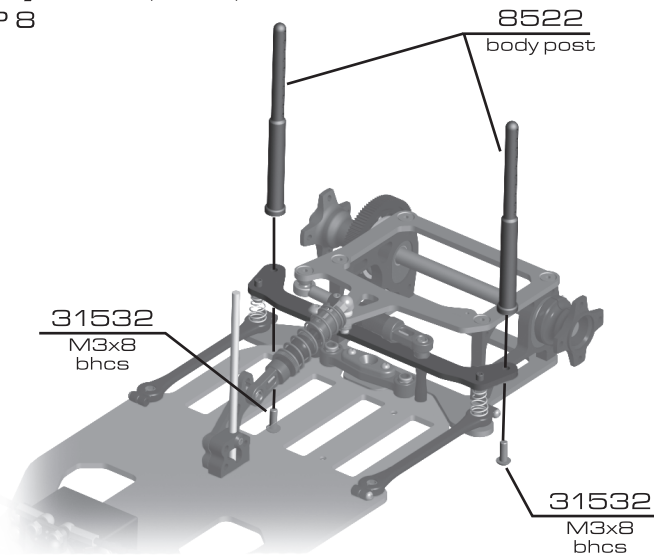

:: Battery Index

STEP 9

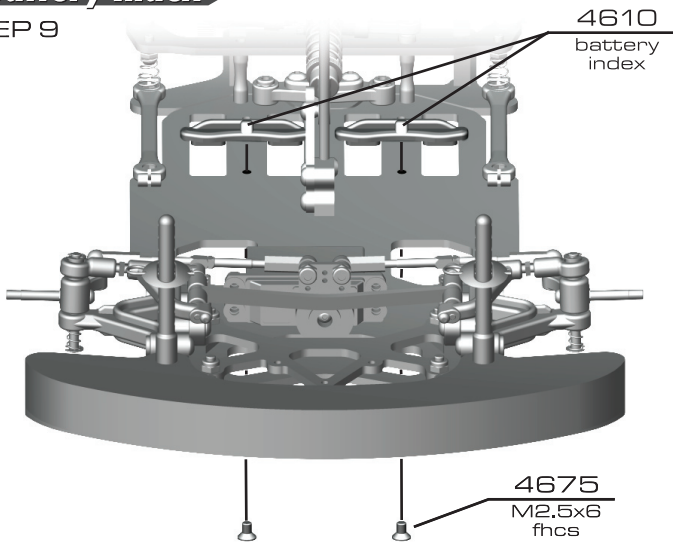

:: Tires / Wheels

STEP 10

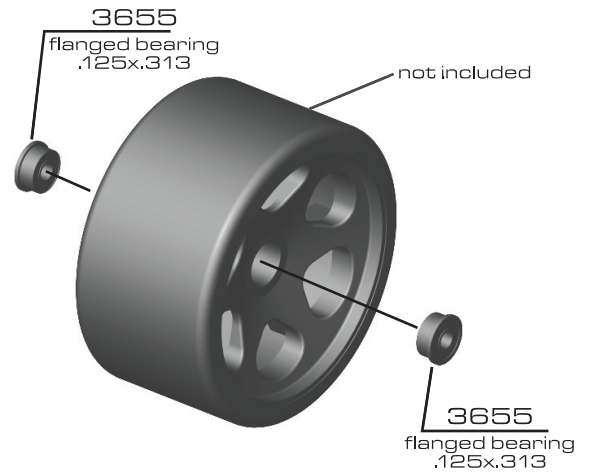

:: Tires / Wheels (cont.)

STEP 11

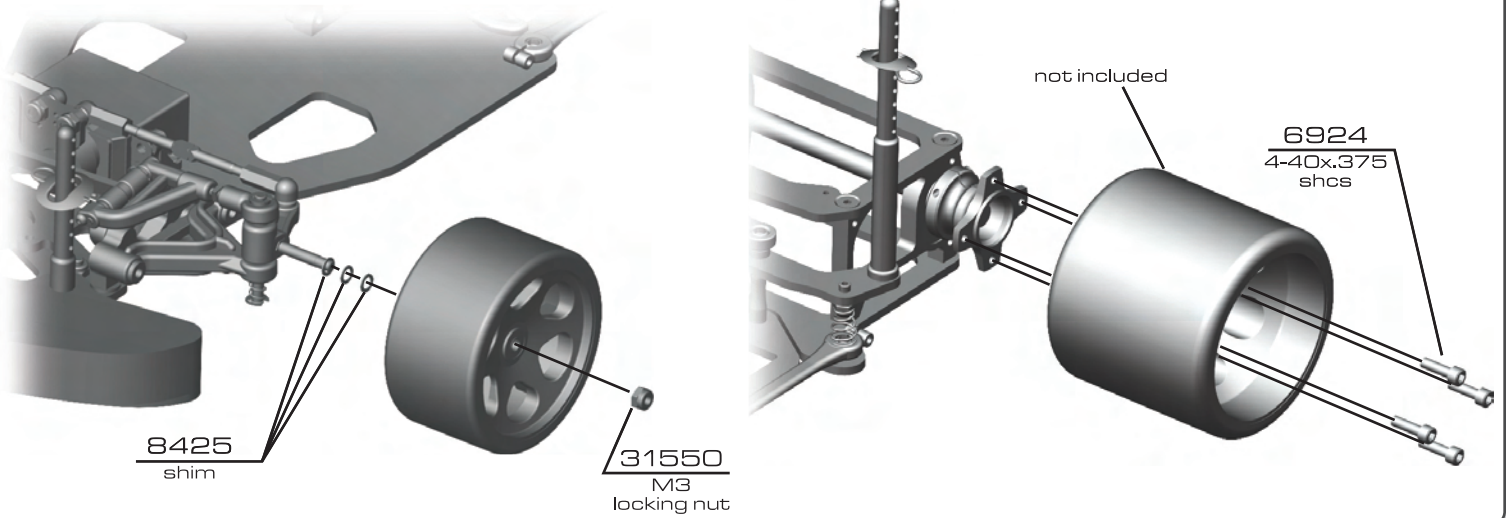

:: Electronics

STEP 1

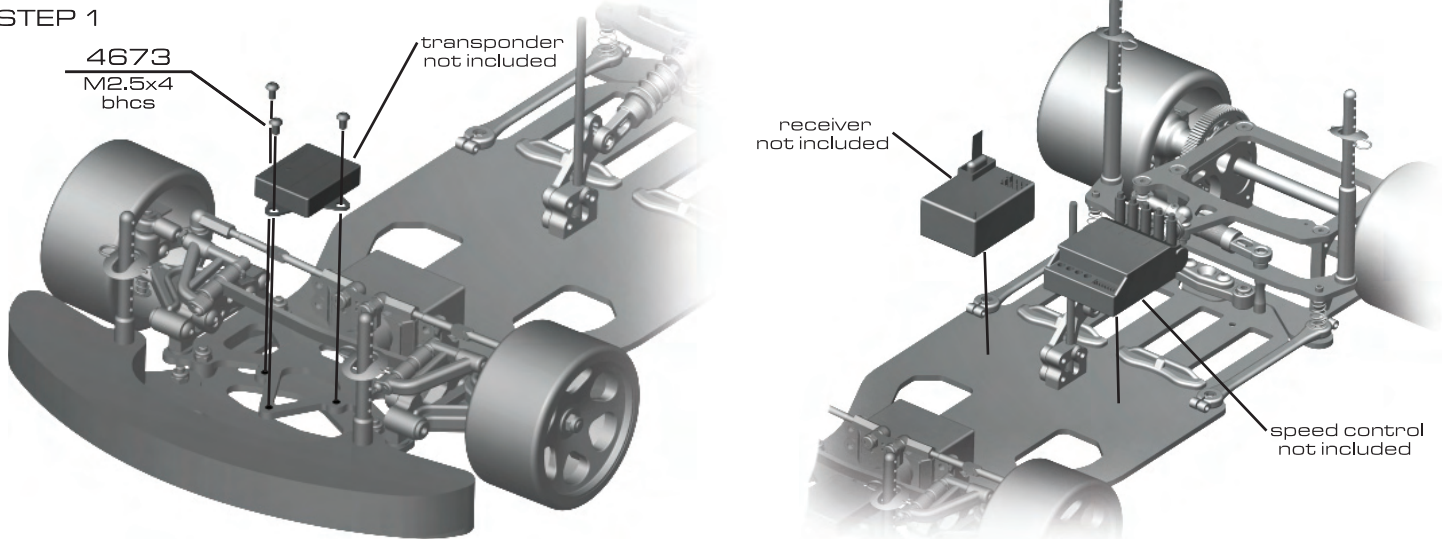

:: Electronics (cont.)

STEP 2

Differential Adjustment:
 While holding both rear wheels with your hands, use your right thumb and index finger to try to rotate the spur gear. The spur gear should be very difficult to rotate. If you can rotate it easily, tighten the #4185 11/32" nut at the end of the axle, **a little at a time**, until the spur gear is difficult to rotate.

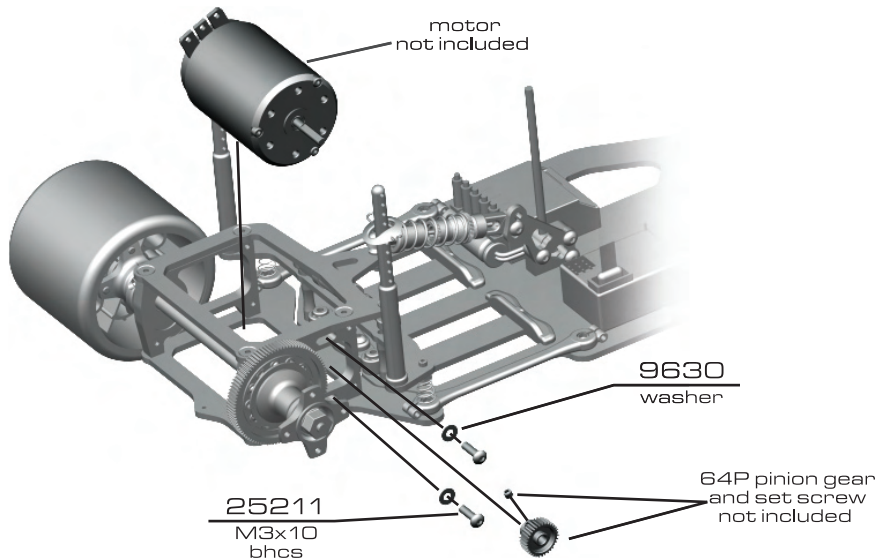

:: Electronics (cont.)

STEP 3

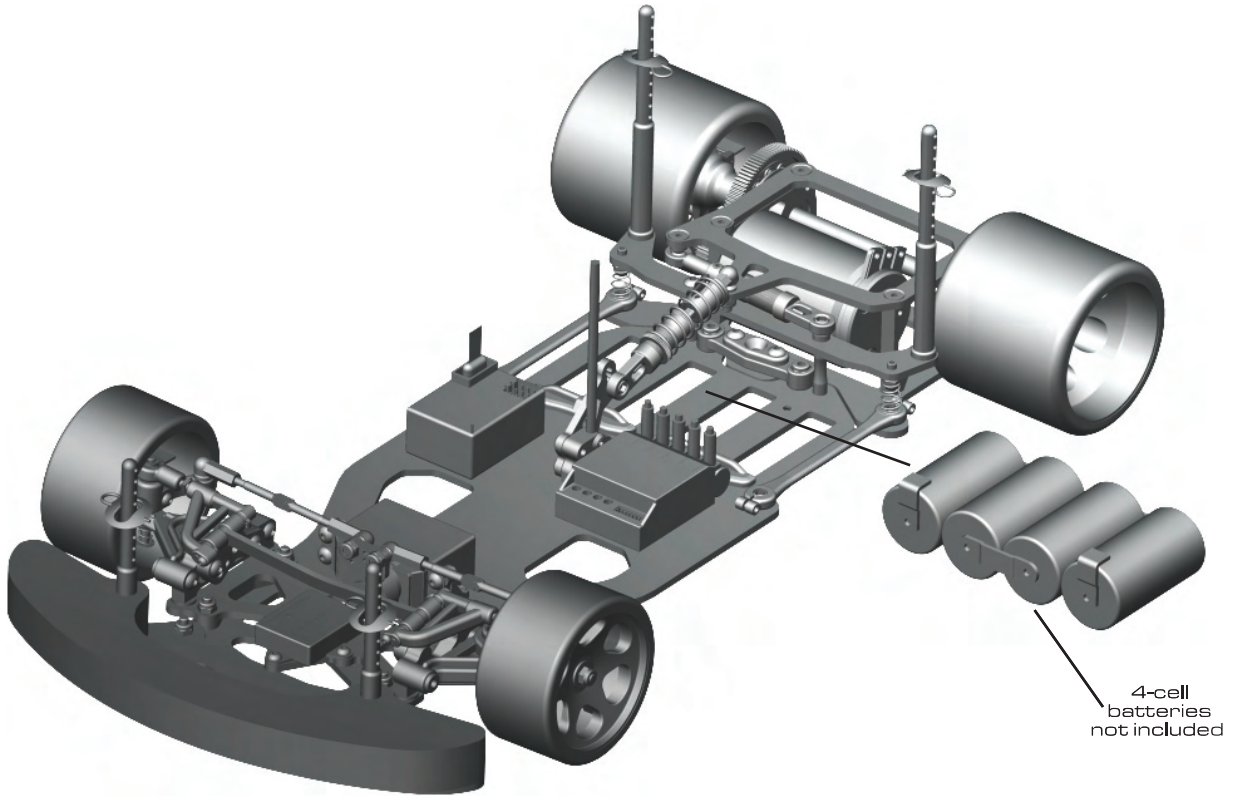

:: Finished Model

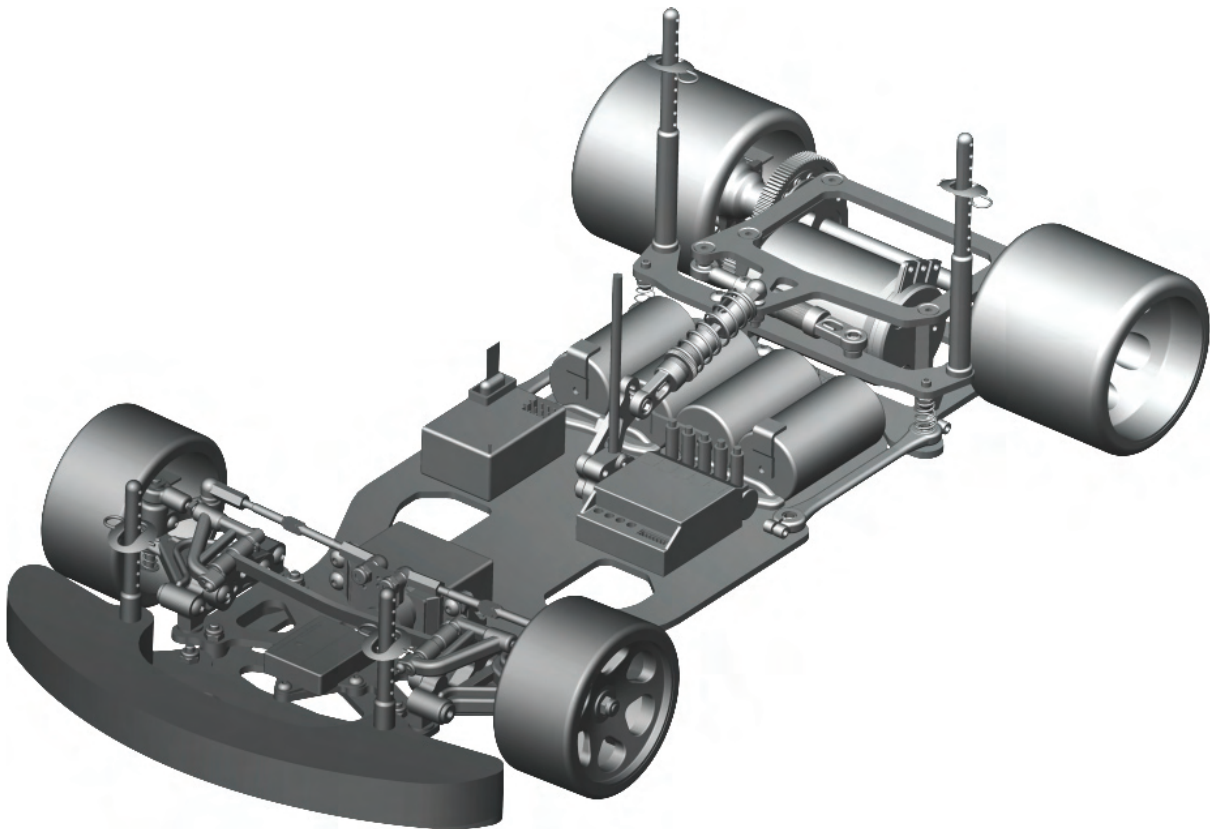

10R5

:: Driver: Team Associated **:: Date:** _____
:: Track: Standard 10R5 Setup
:: Event: _____

Setup Sheet for Team Associated's 10R5

Rev. 1

:: Front Suspension

Kingpin Lube: _____ Springs: .018"

Upper Arm Mounts: 0° 5° 10°

Camber: -2°

Wheelbase: 

Caster:

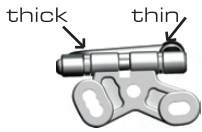

1.80°

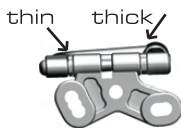

3.25°



6.15°

Ride Height: 5.5mm

Notes: _____

:: Rear Suspension

Side Spring: gold

T-Plate: _____

Ride Height Adjuster: _____

Ride Height: 5.5mm

Side Shock

Oil: 30 Wt

Center Shock

Oil: 40wt

Spring: red

Position: 

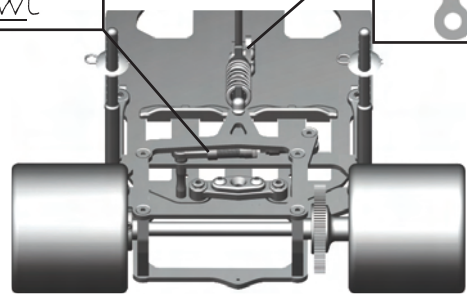

Notes: _____

:: Front Tires

Tire: _____

Diameter: _____

Wheel Type: _____

Additive: _____

Notes: _____

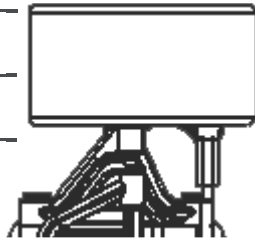

:: Rear Tires

Tire: _____

Diameter: _____

Wheel Type: _____

Additive: _____

Notes: _____

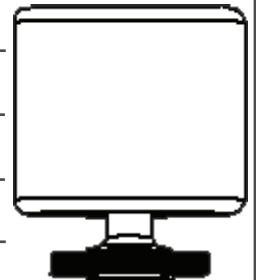

:: Body

Body Type and Make: _____

Notes: _____

:: Track Info

smooth: bumpy:

traction: high med. low

Notes: _____

:: Motor/Battery

Motor: _____

Brush: _____ Spring: _____

Timing: _____ Gear: _____ /

Battery: _____

Battery Position:

Front Back

:: Speed Control

S.C. : _____

S.C. Settings: _____

:: Transmitter

Turning Circle: _____

Steering Expo: _____



Brake E.P. : _____

Throttle Expo: _____



Notes: _____

:: Hardware - 1:1





cap head (shcs)

-  2-56x.313 (4568)
-  4-40x.375 (6924)



nuts (lock/plain)

-  m2.5 locknut (4676)
-  m3 locknut (31550)







setscrews

-  3x2.5mm (31500)
-  3x5mm (89219)
-  3x8mm (4670)
-  3x10mm (4671)

pivot balls

-  hard anodized pivot ball (4637)
-  plastic pivot ball (8417)





button head (bhcs)

-  2x4mm (31510)
-  2x6mm (4672)
-  2.5x4mm (4673)
-  3x6mm (31531)
-  3x8mm (31532)
-  3x10mm (25211)



flat head (fhcs)

-  2.5x6mm (4675)
-  3x5mm (31540)
-  3x8mm (25201)
-  3x10mm (25202)
-  3x12mm (25203)
-  2-56X3/8 (31125)

shims & washers

-  washer (9630)
-  kingpin shim (8425)
-  blue aluminum shims
1 mm, 2mm (31286)
-  washer (7337)
-  bulkhead shim (4617)
0.5mm, 1 mm, 2mm
-  t-plate spacers (4650)
-  rear axle shim .005" (4554)

ball bearings

-  rear axle bearing (897)
.250x.375x.125
-  front wheel bearing (3655)
.125x.313

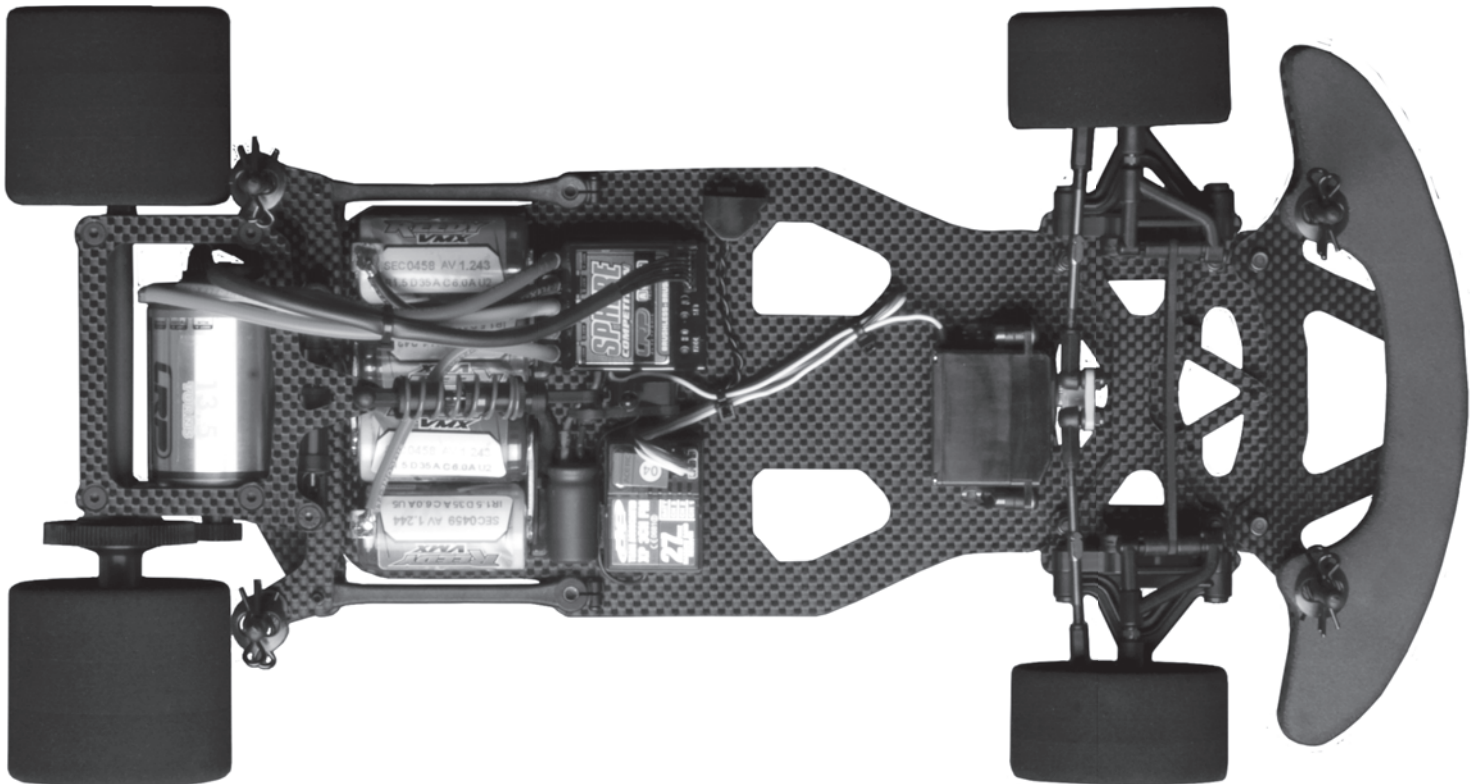

10R5

:: Driver: _____ **:: Date:** _____

:: Track: _____

:: Event: _____

Setup Sheet for Team Associated's 10R5

Rev. 1

:: Front Suspension

Kingpin Lube: _____ Springs: _____

Upper Arm Mounts: 0° 5° 10°

Camber: _____

Wheelbase: _____



Caster:

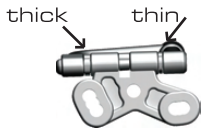

1.80°

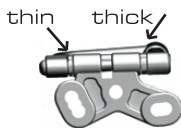

3.25°



6.15°

Ride Height: _____

Notes: _____

:: Rear Suspension

Side Spring: _____

T-Plate: _____

Ride Height Adjuster: _____

Ride Height: _____

Side Shock

Oil: _____

Center Shock

Oil: _____

Spring: _____

Position: _____

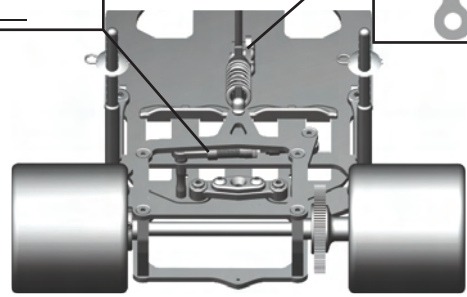

Notes: _____

:: Front Tires

Tire: _____

Diameter: _____

Wheel Type: _____

Additive: _____

Notes: _____

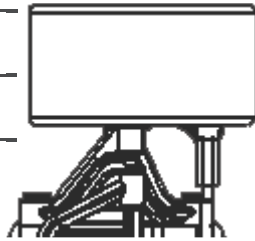

:: Rear Tires

Tire: _____

Diameter: _____

Wheel Type: _____

Additive: _____

Notes: _____

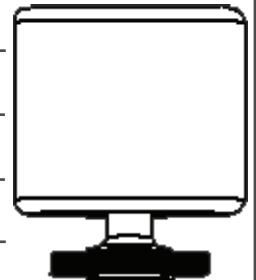

:: Body

Body Type and Make: _____

Notes: _____

:: Track Info

smooth: bumpy:

traction: high med. low

Notes: _____

:: Motor/Battery

Motor: _____

Brush: _____ Spring: _____

Timing: _____ Gear: _____ /

Battery: _____

Battery Position:

Front Back

:: Speed Control

S.C. : _____

S.C. Settings: _____

:: Transmitter

Turning Circle: _____

Steering Expo: _____

Brake E.P. : _____

Throttle Expo: _____

Notes: _____

:: Factory Team

FACTORY Team PERFORMANCE GEAR FOR THE 10R5

(Available separately from your local hobby store. Not included in this kit.)

FACTORY TEAM ACCESSORIES

- 1105 GREEN SLIME SHOCK OIL
- 1111 FT TURNBUCKLE WRENCH
- 1450 FT RIDE HEIGHT GAUGE
- 1595 LEAD WEIGHTS
- 1596 THREAD LOCKING ADHESIVE
- 1597 FT TIRE ADHESIVE
- 1736 BODY CLIPS - BLUE
- 1737 BODY SCISSORS
- 6588 BLACK GREASE
- 6591 DIFF LUBE
- 6636 SILICONE LUBE
- 6727 SERVO TAPE STRIPS



- SP58 AE 07 T-SHIRT BLACK (M,L,XL,XXL)
- SP59 AE 07 T-SHIRT BLUE (M,L,XL,XXL)



REEDY PERFORMANCE

- 300 REEDY STOCKSTAR 27T STOCK
- 410 REEDY FLASH 12T
- 411 REEDY FLASH 13T
- 412 REEDY FLASH 14T
- 413 REEDY FLASH 15T
- 414 REEDY FLASH 17T
- 415 REEDY FLASH 19T
- 517 REEDY CHALLENGER 19T SPEC
- 605 REEDY MOTOR COOLING FAN
- 651 REEDY BATTERY BARS
- 672 REEDY VMX R-42 IB4200 MATCHED BATTERIES
- 676 REEDY VMX R-46 IB4600 MATCHED BATTERIES



FACTORY TEAM TOOLS

- ### FACTORY TEAM NUT DRIVERS
- #1561 FULL SET OF 6
 - #1562 3/16" BLACK
 - #1563 1/4" RED
 - #1564 5.5MM PURPLE
 - #1565 11/32" GREEN
 - #1566 7MM SILVER
 - #1567 8MM GOLD

- ### FACTORY TEAM HEX DRIVERS
- #1541 FULL SET OF 7
 - #1542 .050" SILVER
 - #1543 1/16" BLACK
 - #1545 5/64" BLUE
 - #1546 3/32" GOLD
 - #1544 1.5MM PURPLE
 - #1547 2.5MM GREEN
 - #1548 3MM RED

- ### FACTORY TEAM BALL HEX DRIVERS
- #1592 BALL HEX DRIVER SET (3)
 - #1589 5/64" BALL HEX BLUE
 - #1590 3/32" BALL HEX GOLD
 - #1591 2.5MM BALL HEX GREEN

- ### FACTORY TEAM SCREWDRIVERS
- #1551 FT SCREWDRIVERS (2)
 - #1554 FT SPRING HOOK



SILICONE SHOCK FLUIDS

- #5420 10wt. SHOCK FLUID, 2oz
- #5421 20wt. SHOCK FLUID, 2oz
- #5422 30wt. SHOCK FLUID, 2oz
- #5423 40wt. SHOCK FLUID, 2oz
- #5427 15wt. SHOCK FLUID, 2oz
- #5428 25wt. SHOCK FLUID, 2oz
- #5429 35wt. SHOCK FLUID, 2oz
- #5430 45wt. SHOCK FLUID, 2oz
- #5431 55wt. SHOCK FLUID, 2oz
- #5435 50wt. SHOCK FLUID, 2oz
- #5436 60wt. SHOCK FLUID, 2oz

