

SC10RS

SHORT COURSE-RACE SPEC



- #7046 SC10RS RTR Lucas Oil
- #7047 SC10RS RTR Monster Energy
- #7048 SC10RS RTR ProComp
- #7049 SC10RS RTR Rockstar/Makita

BRUSHLESS
Ready-To-Run

1:10 Scale Electric 2WD Off Road Race Truck Manual & Catalog

TEAM ASSOCIATED



Designed in California, USA

:: Introduction

Thank you for purchasing this Team Associated product. This assembly manual contains instructions and tips for building and maintaining your new SC10. Please take a moment to read through this manual to help familiarize yourself with these steps.

We are continually changing and improving our designs; therefore, actual parts may appear slightly different than in the illustrations. New parts will be noted on supplementary sheets located in the appropriate parts bags. Check each bag for these sheets before you start to build.

:: SC10 RS RTR Features

Team Associated, the only RC car company with 24 World Championships is proud to present the SC10 RS RTR!

Features in the SC10 RS RTR:

- 2010 ROAR National Champion short course race truck
- XP3-SS 2.4GHz 3-channel radio system with XP S1903MG metal gear steering servo
- Water Resistant High-Power XP SC700 Brushless Speed Control
- Reedy Power 3300 KV Brushless Motor
- Water-Resistant enclosed receiver box
- Blue anodized V2 coil-over shocks with adjustable pre-load
- 2.6:1 ratio gearbox with heavy duty sealed gear differential and externally adjustable V2 slipper clutch
- KMC® replica hex-drive wheels front and rear
- JConcepts racing compound rear tires and inserts
- Championship short course racing truck body
- Realistic bumpers front and rear with AE logo mud flaps
- Molded battery hold-down strap fits NiMH & LiPo battery packs
- 14 precision rubber sealed ball bearings

:: Additional

:: SC10 RS RTR

Your new SC10 RS RTR comes factory assembled including radio gear, motor, and ESC. However, there are some items you will need to complete your kit.

Items needed:

- AA-size batteries for transmitter (x8)
- Peak Detection battery charger
- 6 cell NiMH battery pack or 2S LiPo battery pack w/Deans® Ultra Plug® connector

Tools included:

- Allen wrenches #6950 (.050", 1/16", 3/32", 5/64")
- 1.5mm allen wrench
- Molded tools #6956
- Camber gauge #1719

:: Optional

Optional parts and gear to accessorize and maintain your SC10:

- | | |
|---|--------------------------------------|
| • Green Slime shock lube (AE Part # 1105) | • Hobby Knife |
| • Cyanoacrylate glue (AE Part # 1597) | • Needle Nose Pliers |
| • Thread Locking Compound (AE Part # 1596) | • Wire Cutters |
| • Silicone Shock Fluid (Refer to catalog for complete listings) | • Soldering Iron |
| • Silicone Diff Fluid (Refer to catalog for complete listings) | • Calipers or a Precision Ruler |
| • Body Scissors (AE Part # 1737) | • Reamer / Hole Punch |
| • 8 Piece Hex Driver Set (AE Part # 1655) | • FT Nut Driver Set (AE Part # 1561) |
| • FT Hex Wrenches (AE Part # 1541) | |



* These Symbols Indicate a special note or instructions.

There is a 1:1 fold out in the back of the manual. Fold it out while building your kit for easy parts sizing!

Associated Electrics, Inc.
26021 Commercentre Dr.
Lake Forest, CA 92630



Customer Service
Tel: 949.544.7500
Fax: 949.544.7501

<http://www.TeamAssociated.com> • <http://www.RC10.com> • http://twitter.com/Team_Associated • <http://bit.ly/AEonFacebook>

:: Steering Rack Build

BAG A

A2

STEP 1

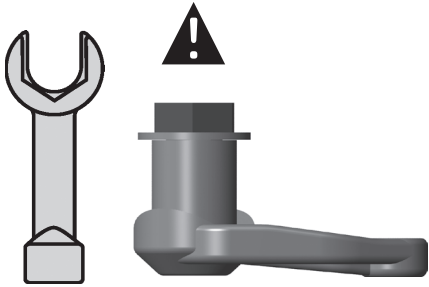

* With supplied wrench, tighten servo saver bolt completely, **until it hits bottom**. Do not over tighten.

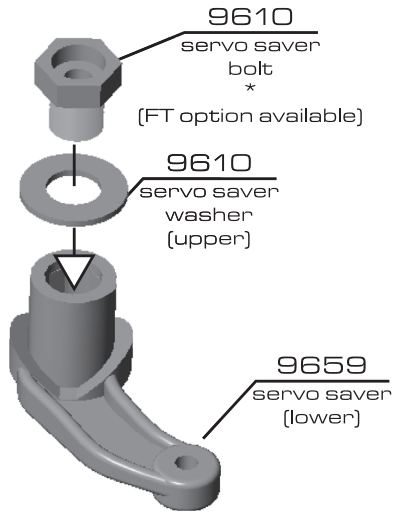

Remove bolt and washer, continue assembly per instructions.

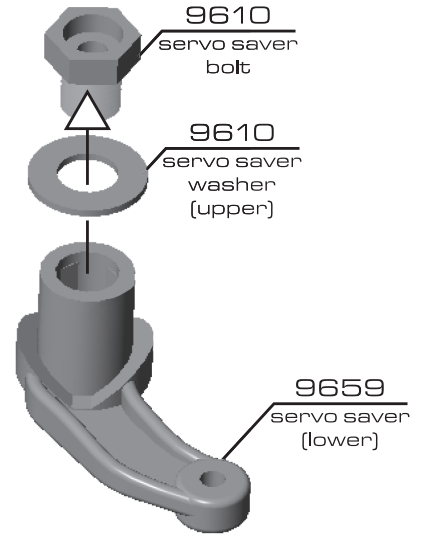

:: Steering Rack Build (cont.)

A2

STEP 2

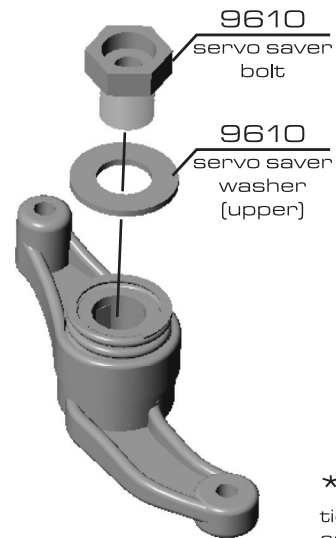
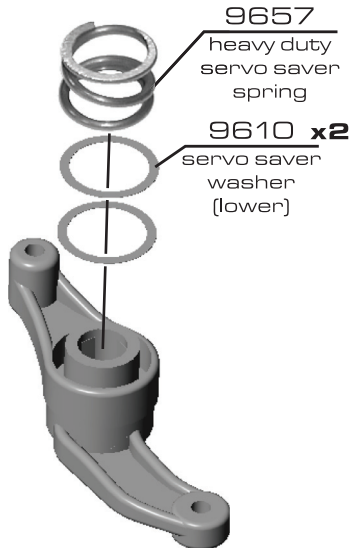
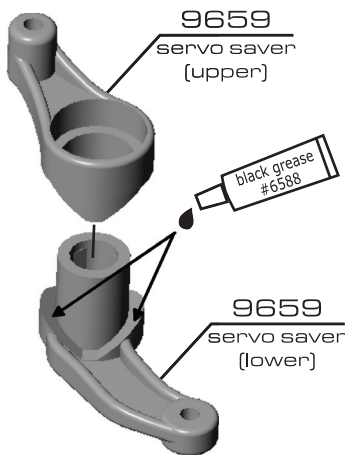

* With supplied wrench, tighten servo saver bolt completely, but take care not to over tighten.

:: Steering Rack Build (cont.)

A2 / 3

STEP 2

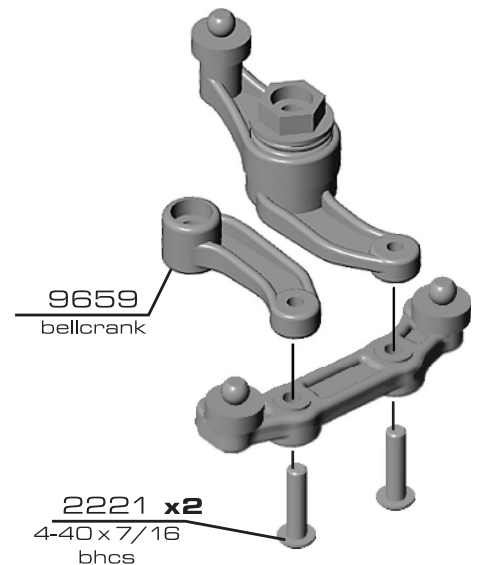
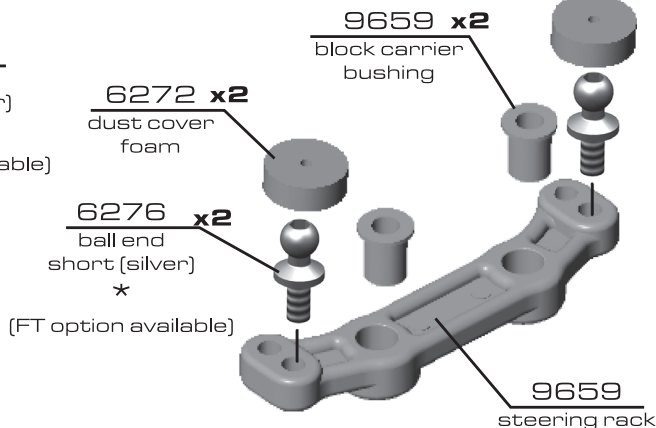
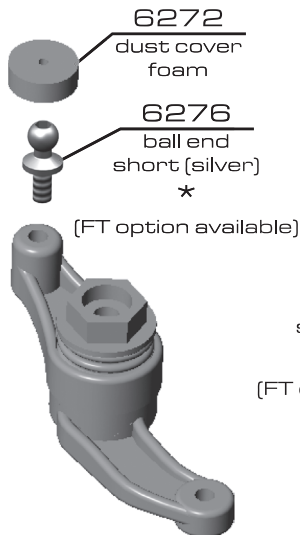

:: Steering Rack Build (cont.)

A 4 / 5
STEP 2

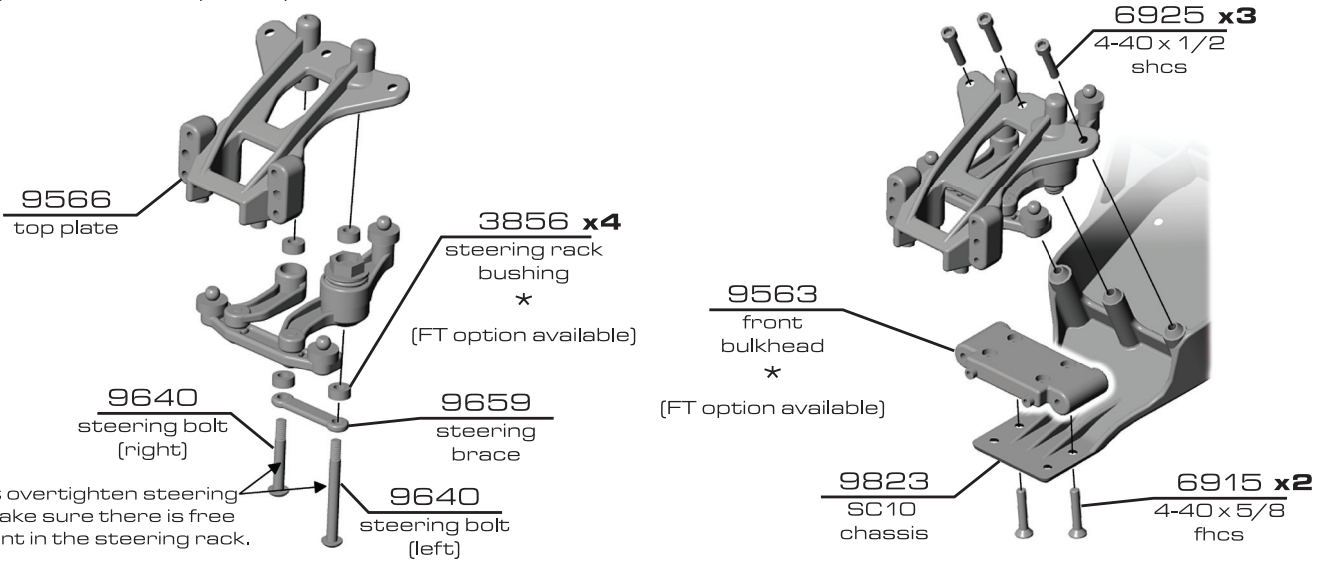

* Do not overtighten steering bolts. Make sure there is free movement in the steering rack.

:: Steering Knuckles Build

BAG B

B 2
STEP 1

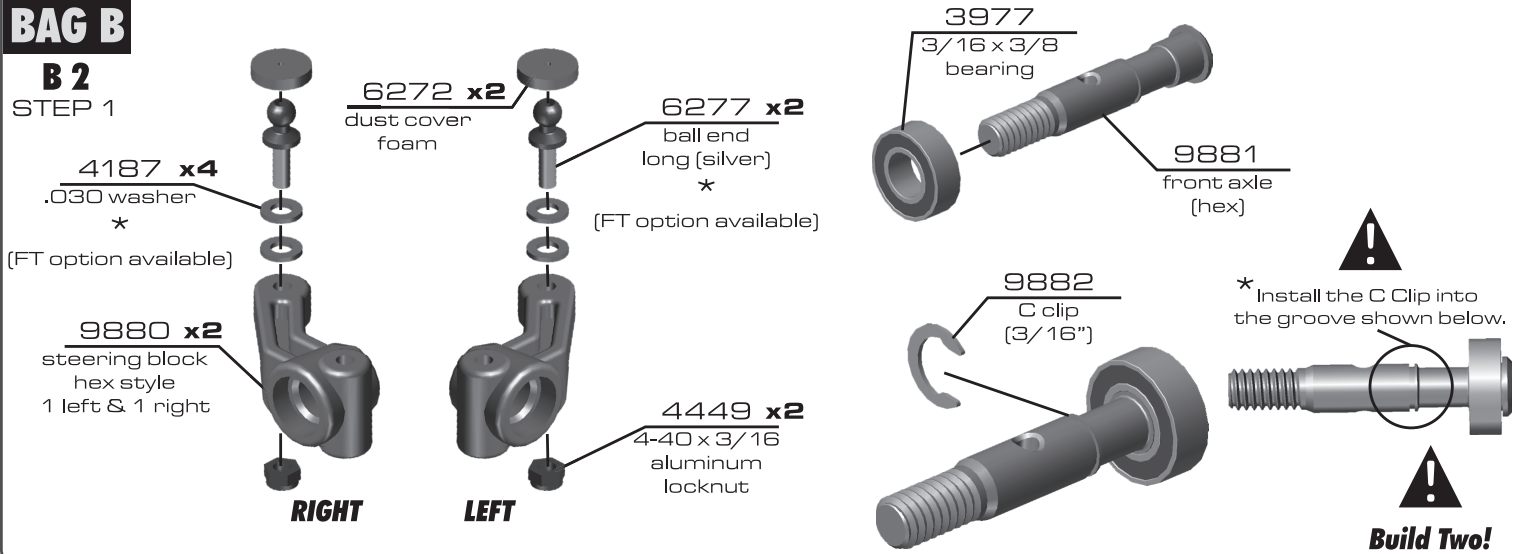

:: Steering Knuckles Build (cont.)

B 2
STEP 2

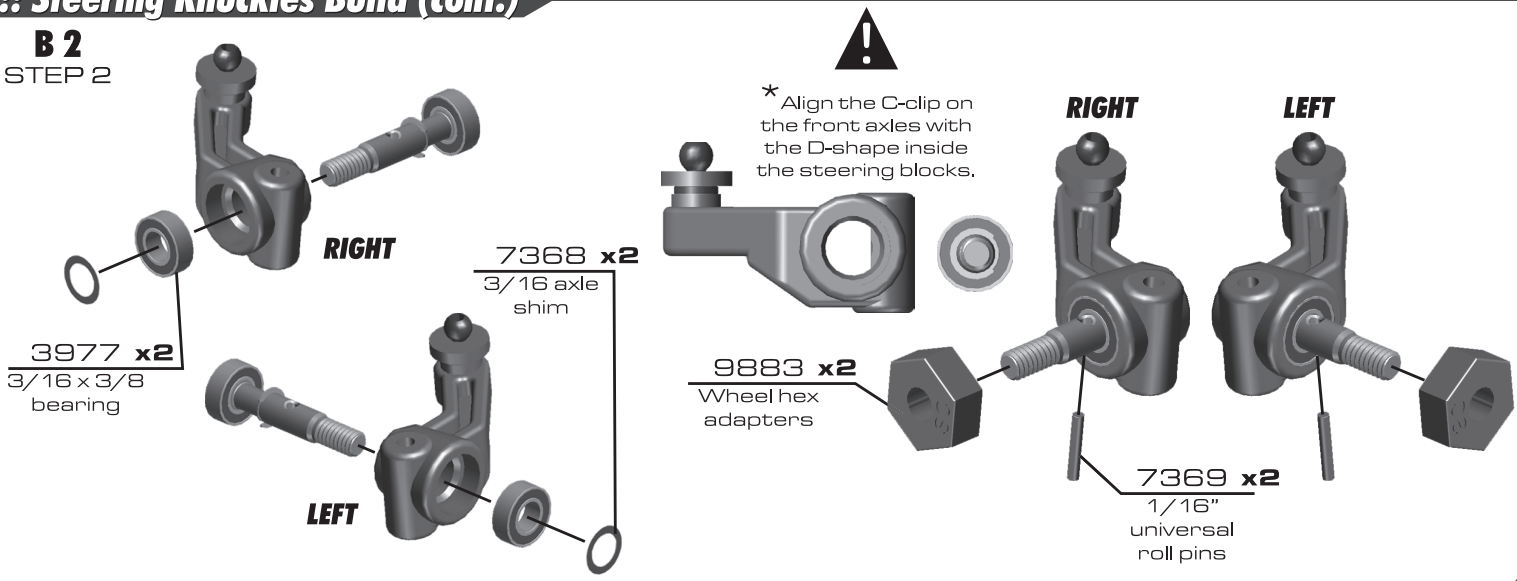

:: Steering Knuckles (cont.)

B 2
STEP 3

7260 x2
4-40 small plain nut

7922 x2
caster block
1 left & 1 right
(30°)

3983 x2
ball end long (black)
*
(FT option available)

6272 x2
dust cover foam

RIGHT

LEFT

RIGHT

LEFT

9622 x2
kingpin

:: Steering Knuckles (cont.)

B 2
STEP 4

RIGHT

LEFT

9645 x2
2-56 x 1/8
bhcs

RIGHT Complete

LEFT Complete

:: Front Arms

B 3
STEP 5

LEFT

RIGHT

9580 x2
spacer

9622 x2
hinge pin
front outer

7446 x2
A-arms, front
1 left, 1 right

9645 x4
2-56 x 1/8
bhcs

:: Front Arms (cont.)

B 3

STEP 6

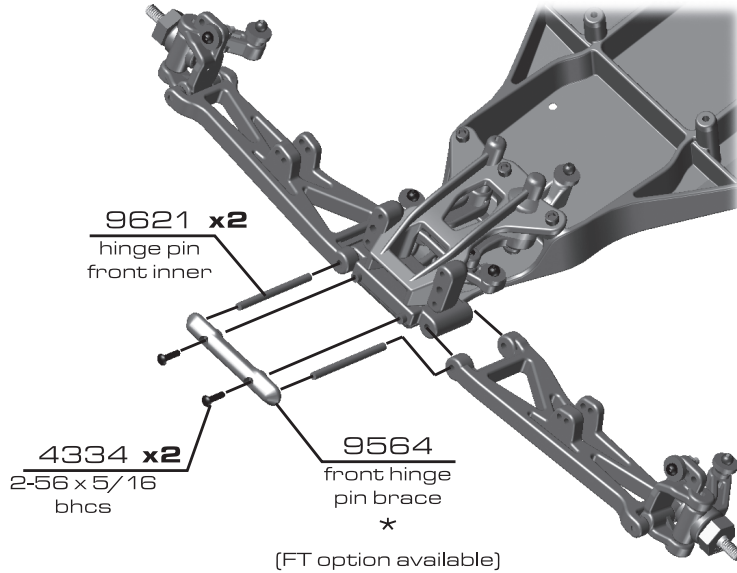

:: Front Shock Tower

B 4

STEP 7

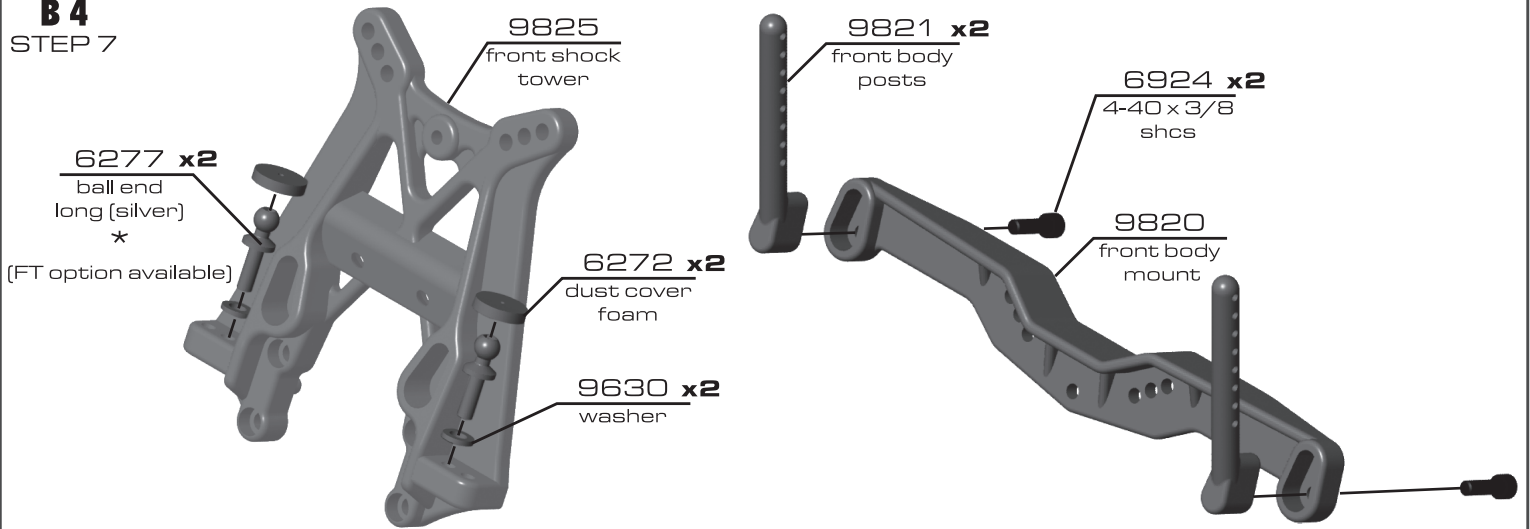

:: Front Shock Tower (cont.)

B 4

STEP 8

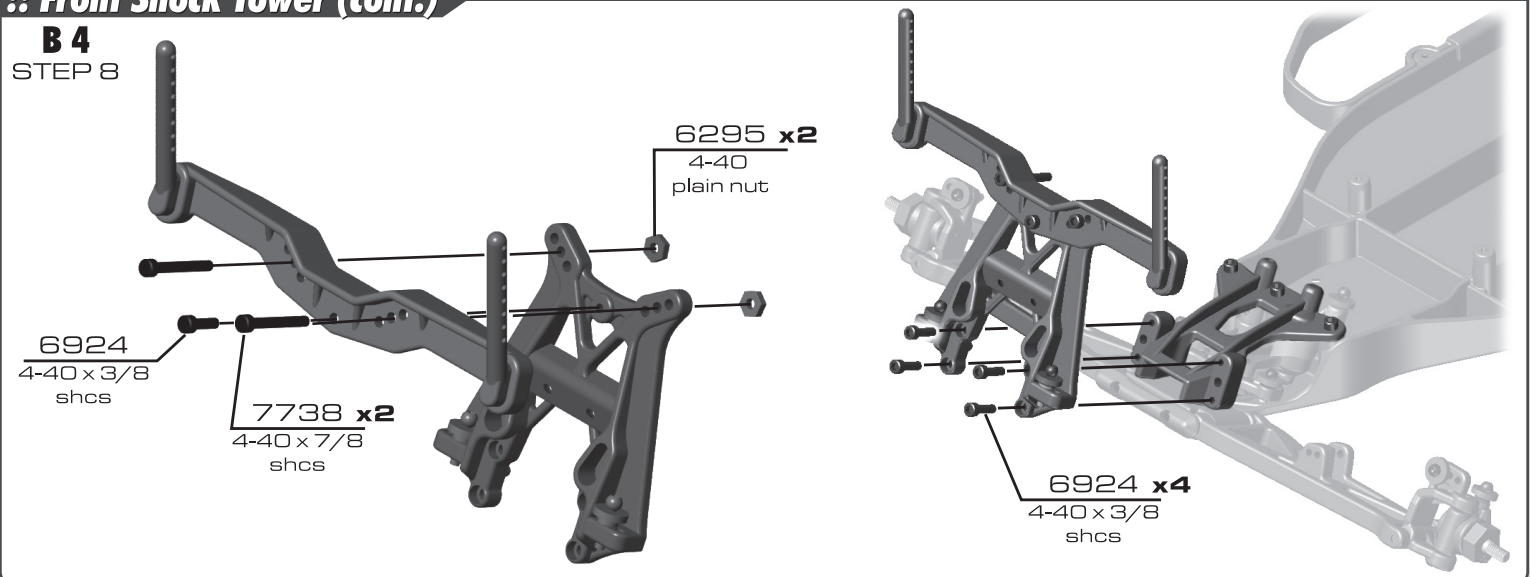

:: Front Bumper

B 5

STEP 6

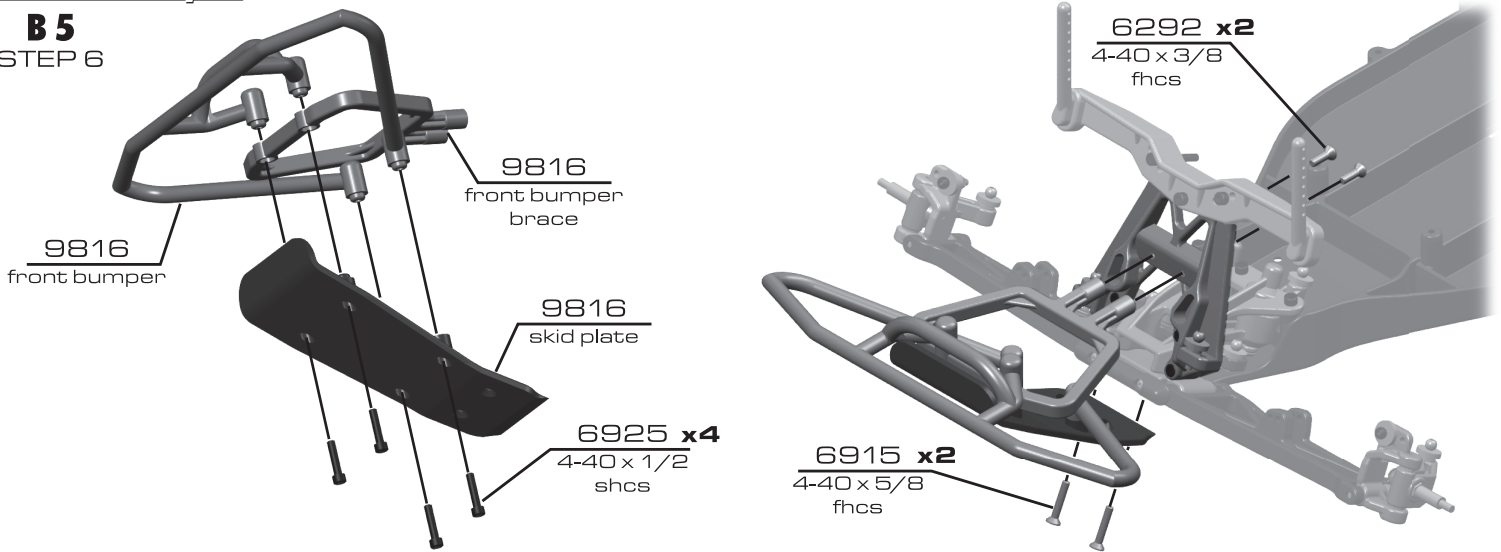

:: Front Turnbuckles

B 6

STEP 7

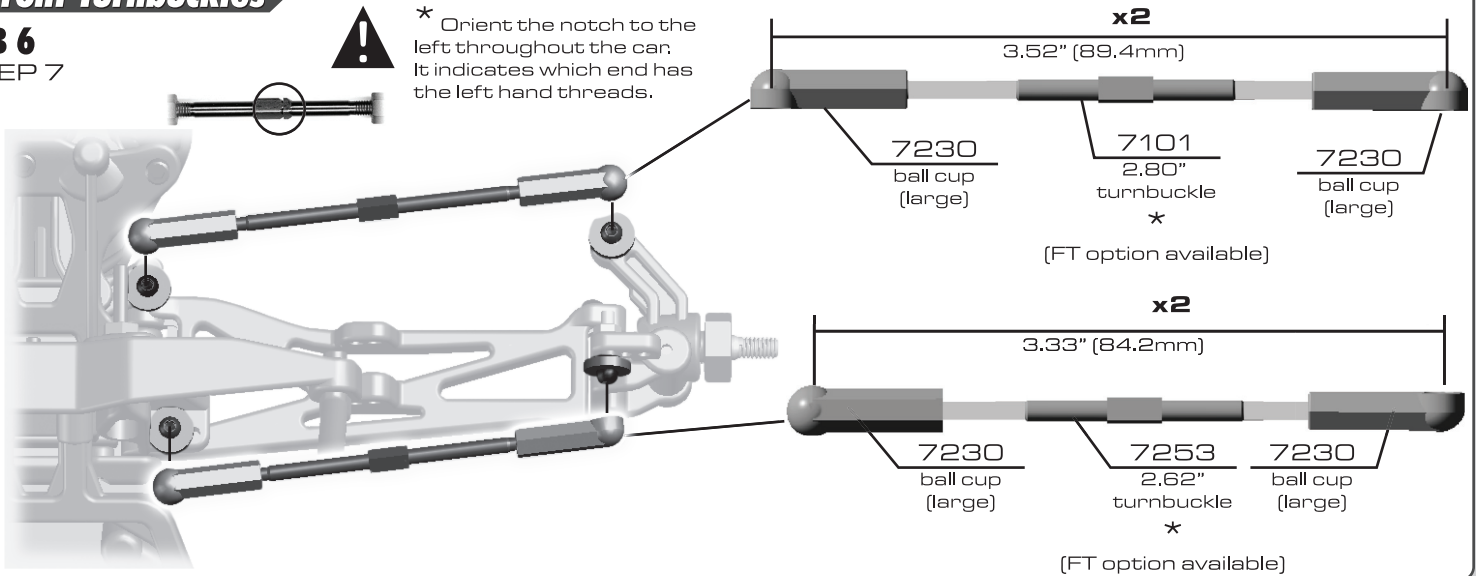

:: Side Nerf Bars

B 7

STEP 8

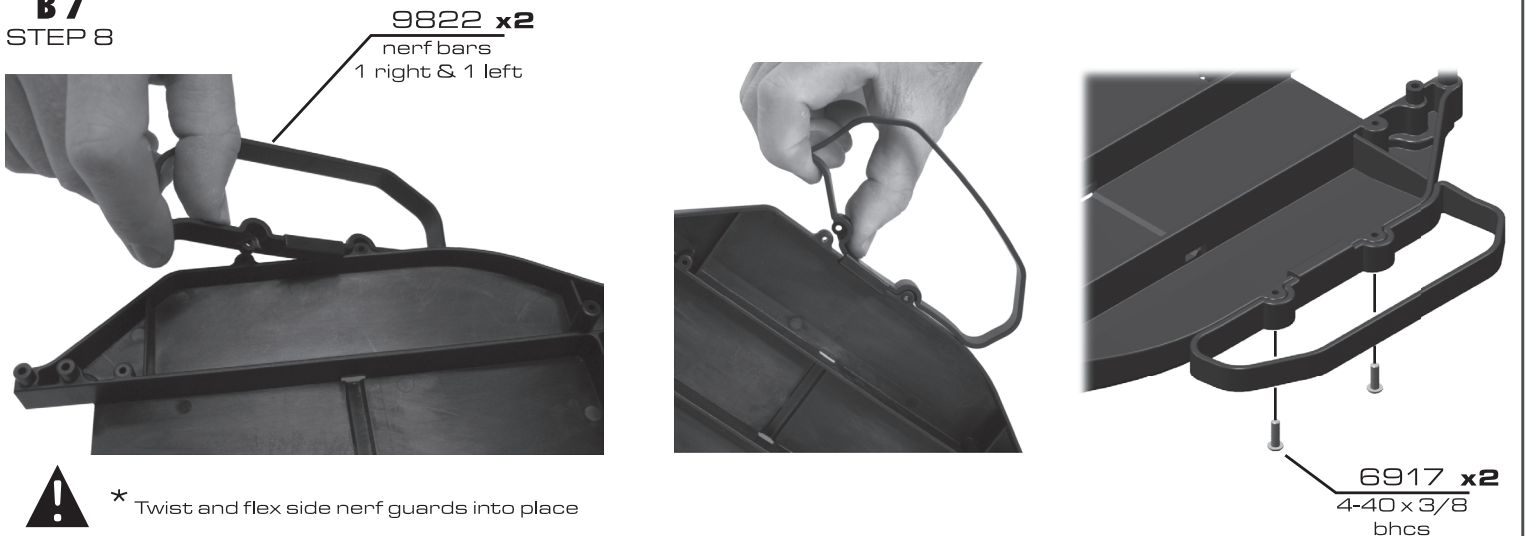

:: Transmission

BAG C

C2
STEP 1

9831
3.6mm x 0.7mm
o-ring

9830
outdrive cup

black grease
#6588

black grease
#6588

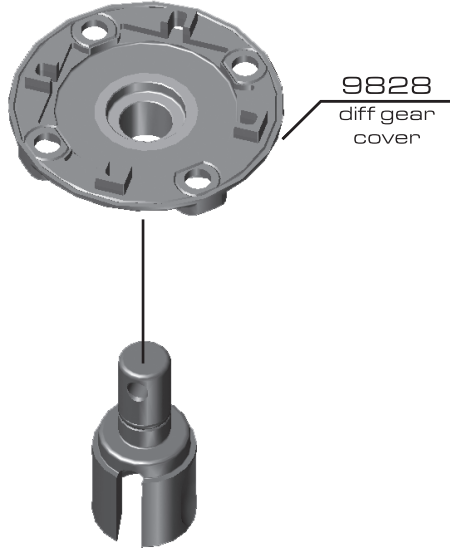
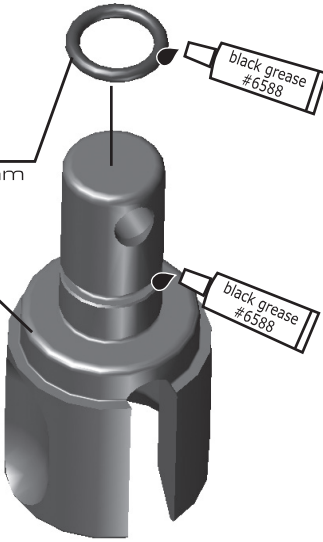

9828
diff gear
cover

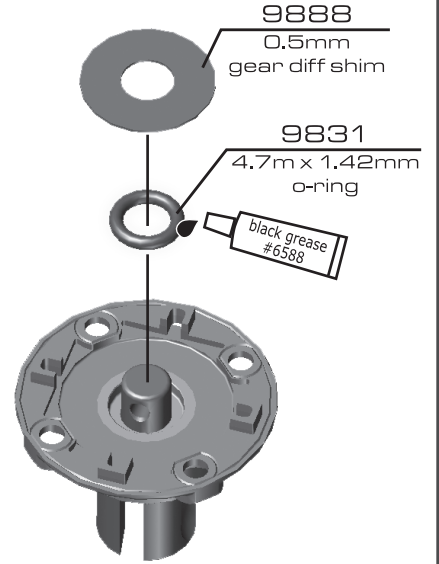

9888
0.5mm
gear diff shim

9831
4.7m x 1.42mm
o-ring

black grease
#6588

:: Transmission (cont.)

C2/3
STEP 2

9830
2mm x 8mm
round end pin

9829
sun gear

9828
differential
gear
52T, 48P

black grease
#6588

black grease
#6588

align pin
with groove
in sun gear

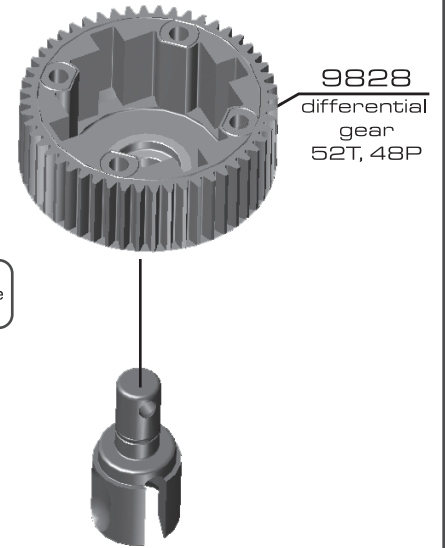
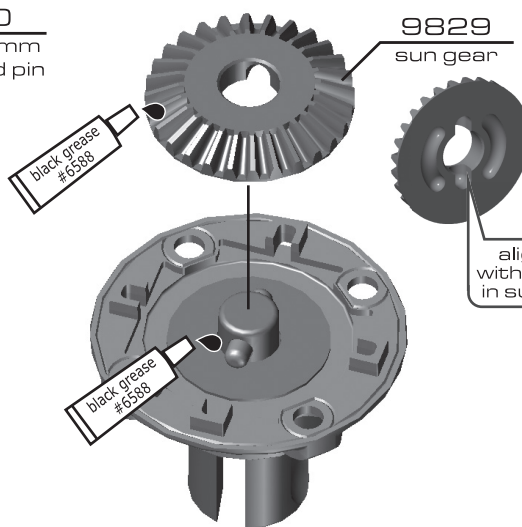
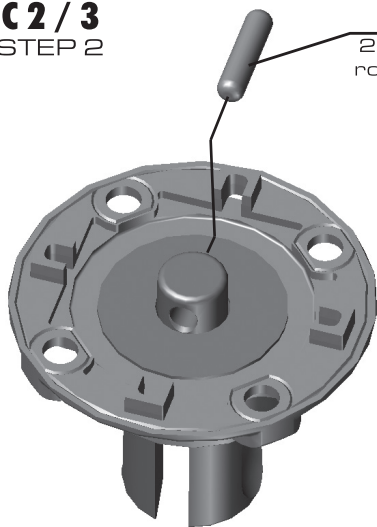

:: Transmission (cont.)

C2
STEP 3

9888
0.5mm
gear diff shim

9831
4.7m x 1.42mm
o-ring

black grease
#6588

9830
2mm x 8mm
round end pin

9829
sun gear

black grease
#6588

black grease
#6588

align pin
with groove
in sun gear

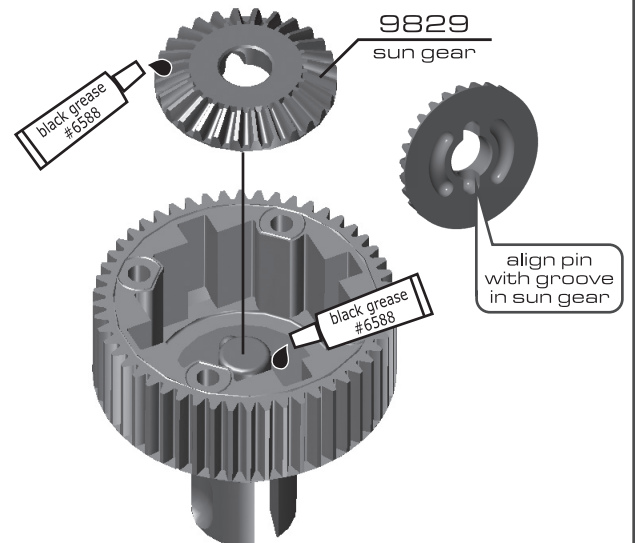
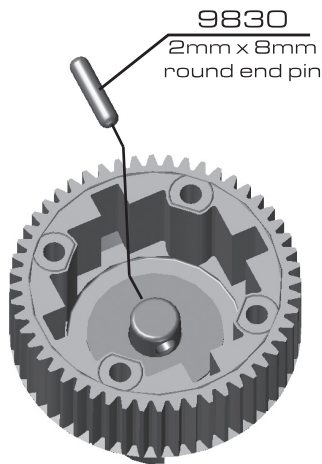
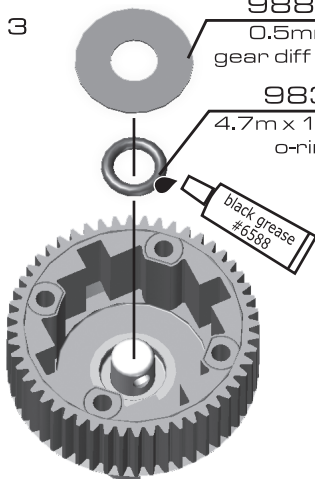

:: Transmission (cont.)

C2 / 4
STEP 4

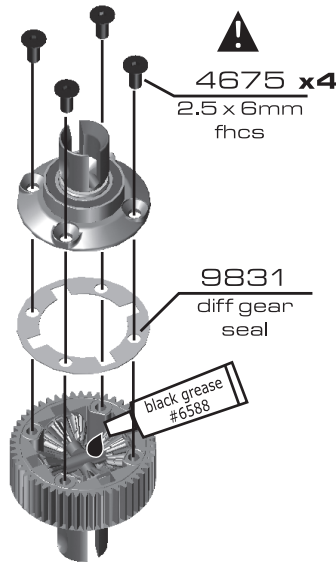
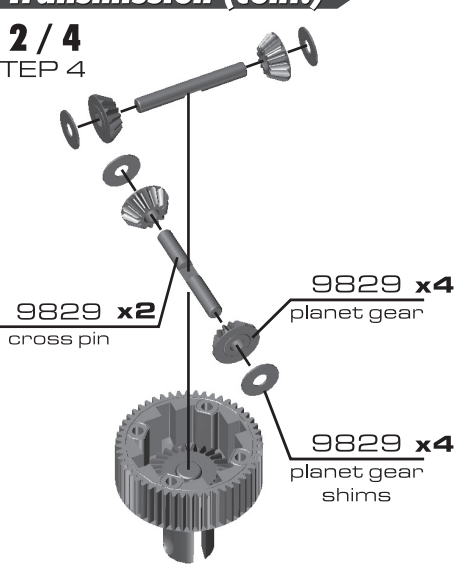

! * Use the 1.5mm allen wrench to tighten the 2.5x6mm fhcs on the diff gear cover

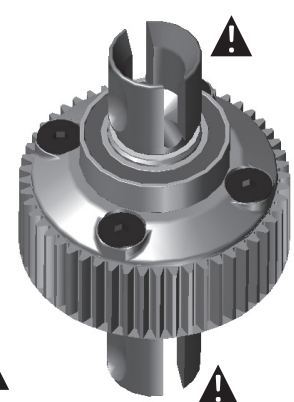

! * Ensure free outdrive rotation before installation!

:: Transmission (cont.)

C5 / 6
STEP 5

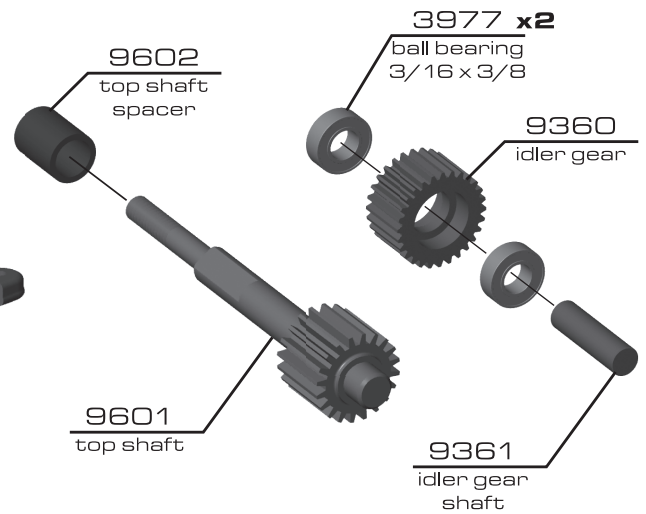
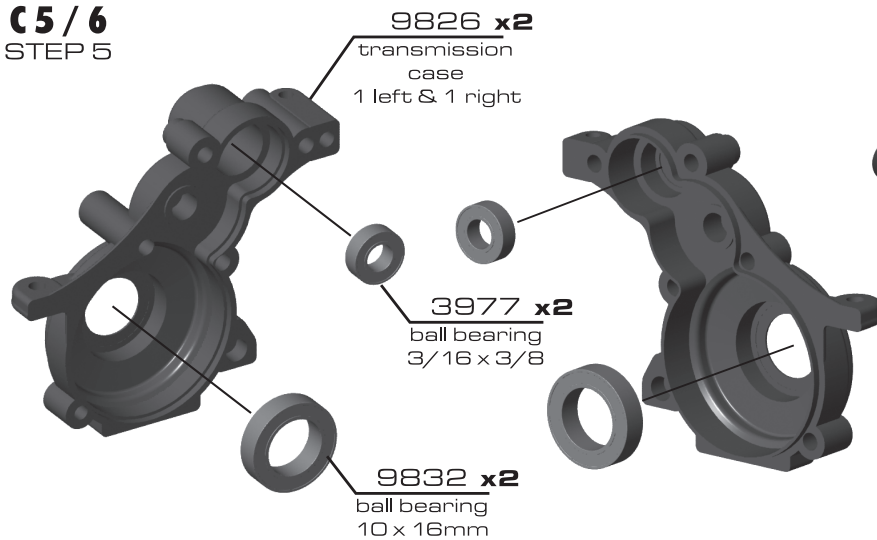

:: Transmission (cont.)

C7
STEP 6

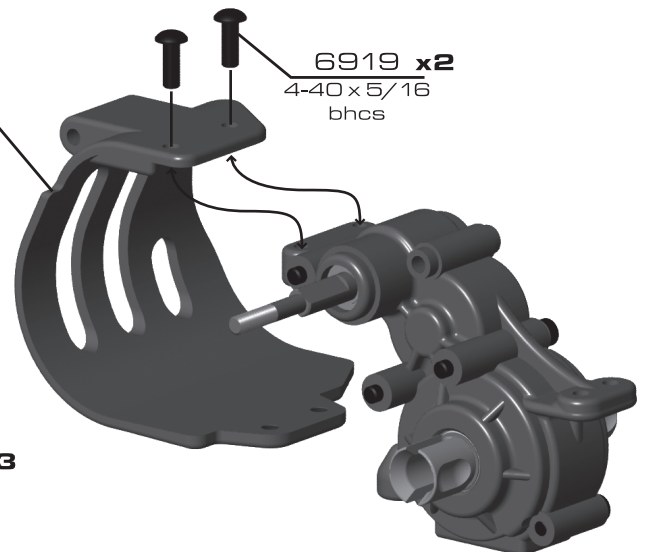
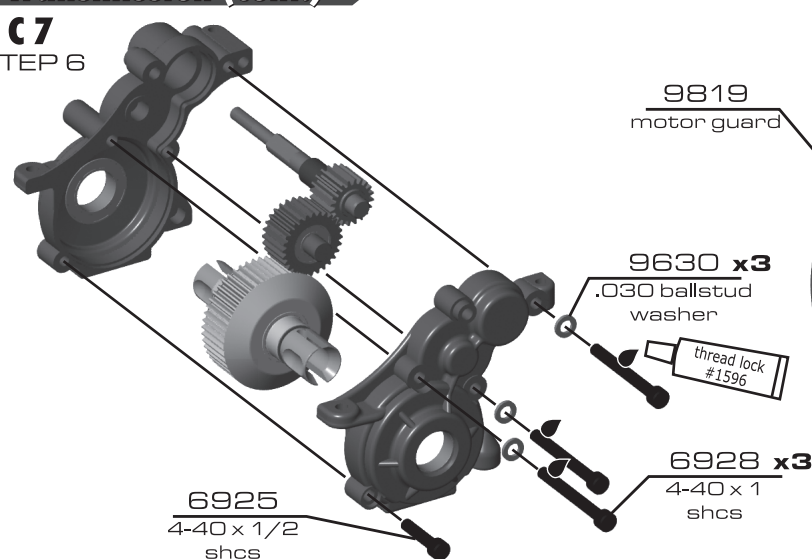

:: Transmission (cont.)

C 8 / 9
STEP 7

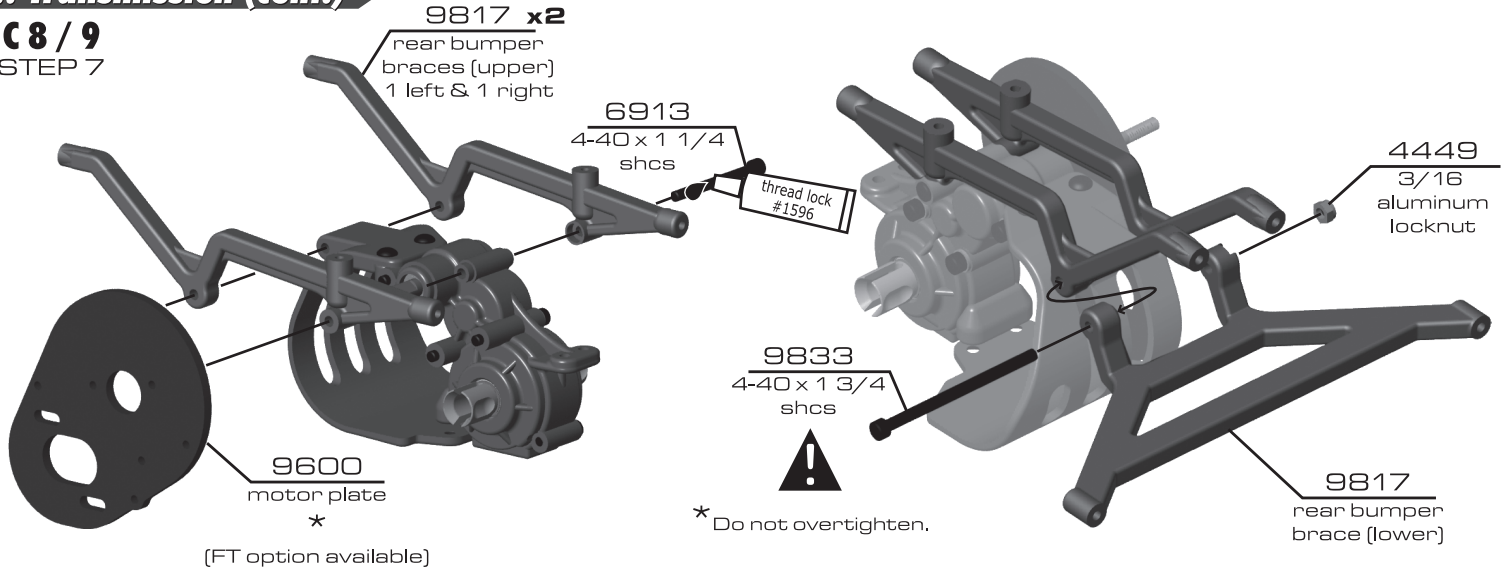

:: Transmission (cont.)

C 10
STEP 8

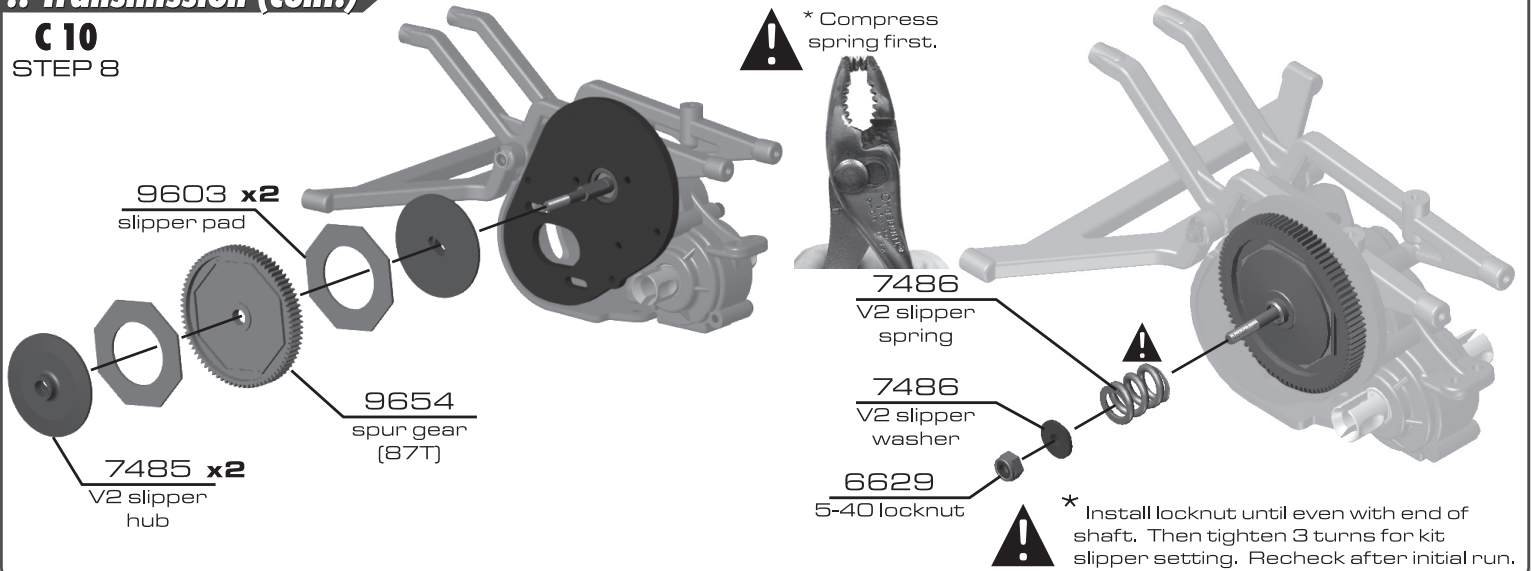

:: Rear Arms

BAG D

D 2
STEP 1

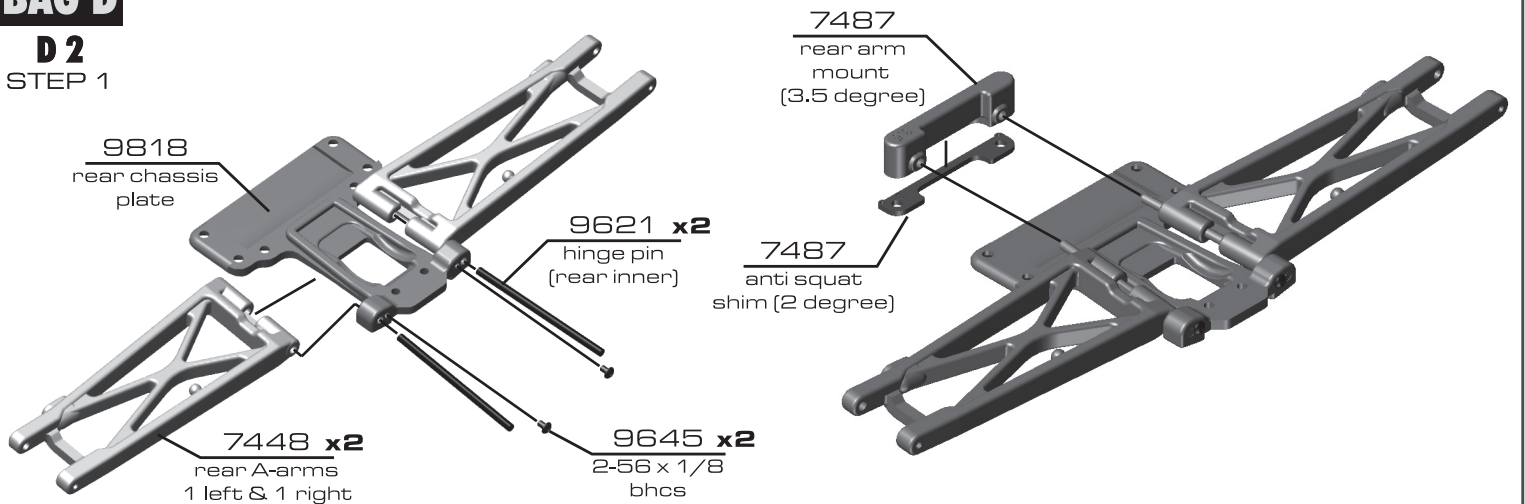

:: Rear Arms (cont.)

D 2
STEP 2

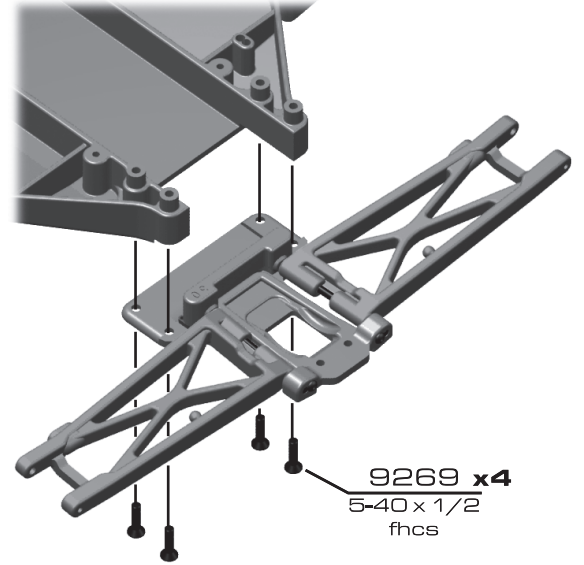
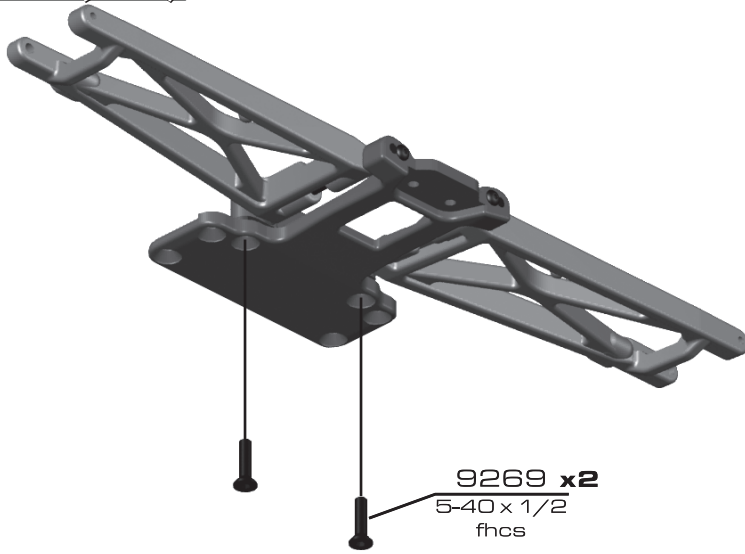

:: Rear Brace

D 3
STEP 3

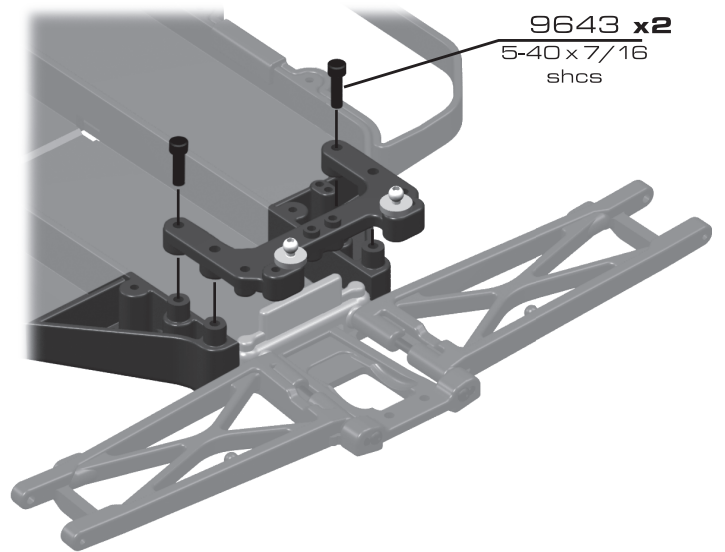
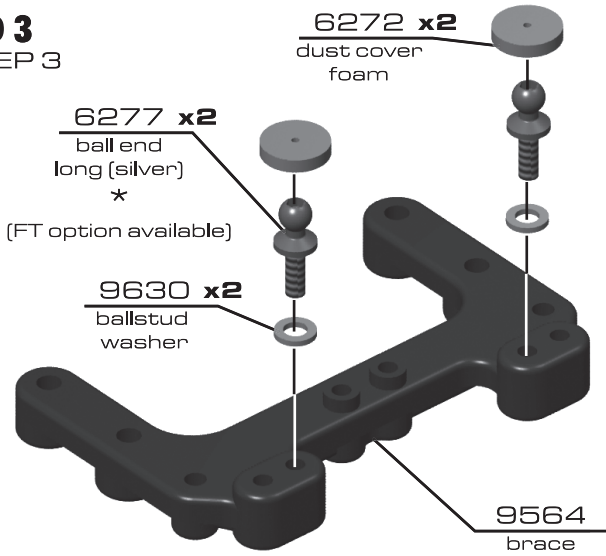

:: Rear Shock Tower

D 3
STEP 4

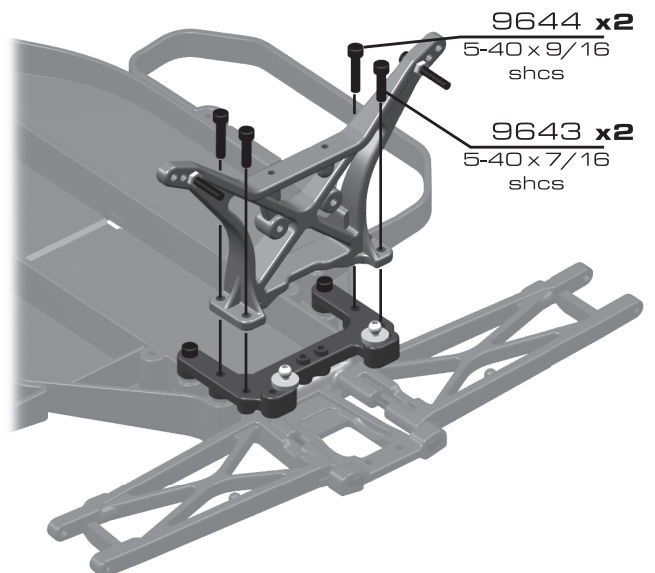
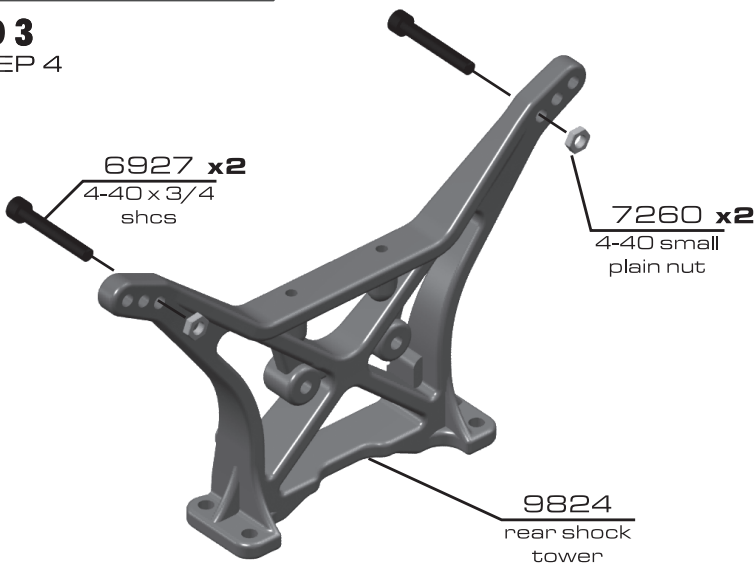

:: Transmission Install

D 4

STEP 5

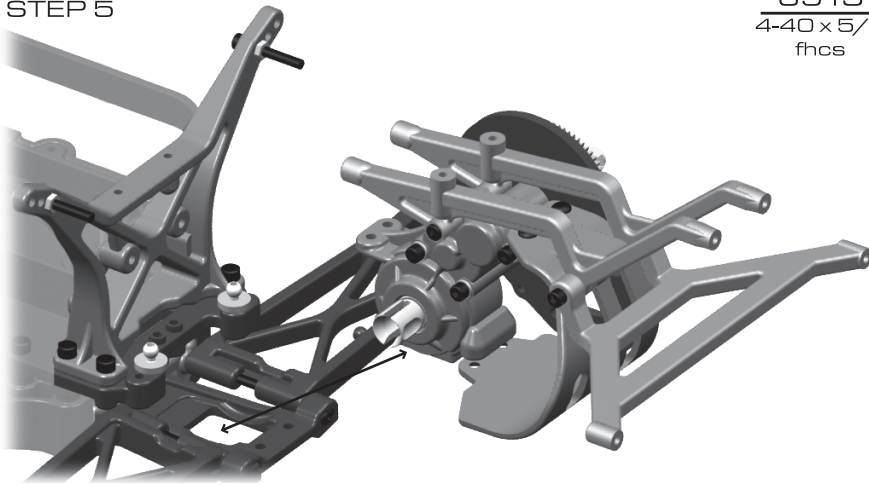

6915 x2
4-40 x 5/8
fhcs

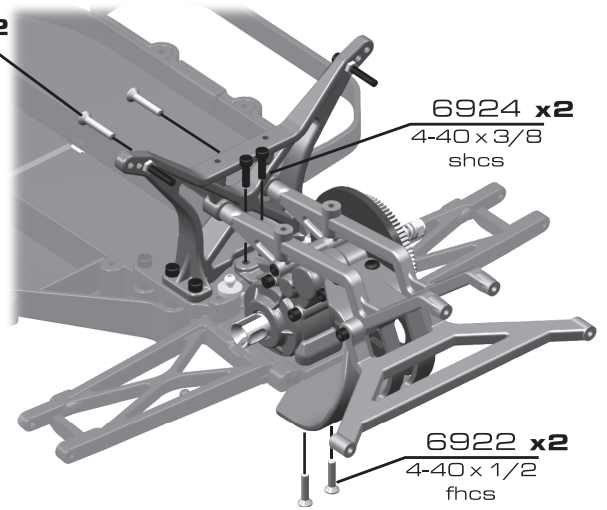

6924 x2
4-40 x 3/8
shcs

6922 x2
4-40 x 1/2
fhcs

:: Rear Upper Plate

D 5

STEP 6

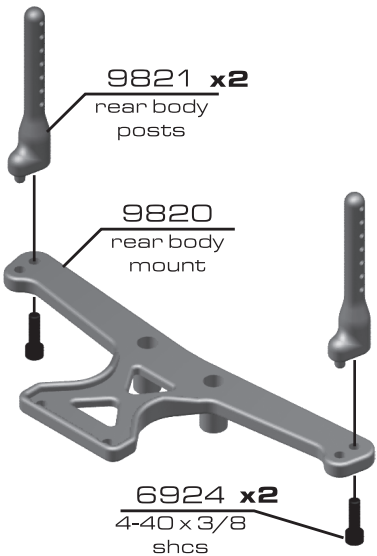

9821 x2
rear body
posts

9820
rear body
mount

6924 x2
4-40 x 3/8
shcs

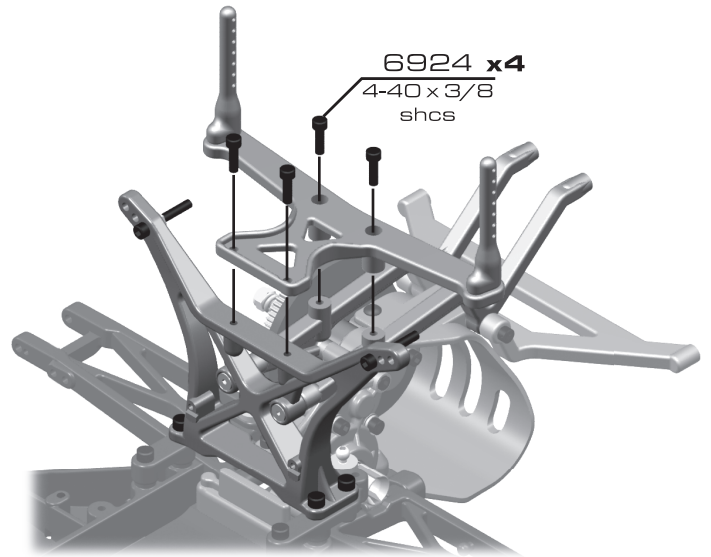

6924 x4
4-40 x 3/8
shcs

:: Rear Bumper

D 6

STEP 7

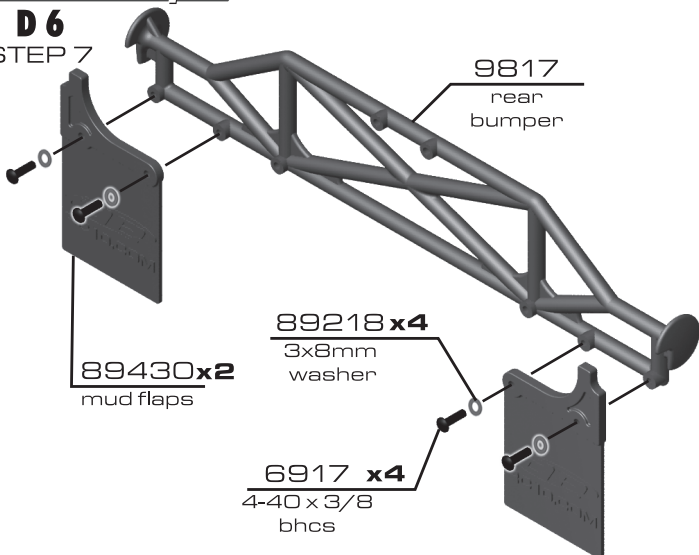

9817
rear
bumper

89430 x2
mud flaps

89218 x4
3x8mm
washer

6917 x4
4-40 x 3/8
bhcs

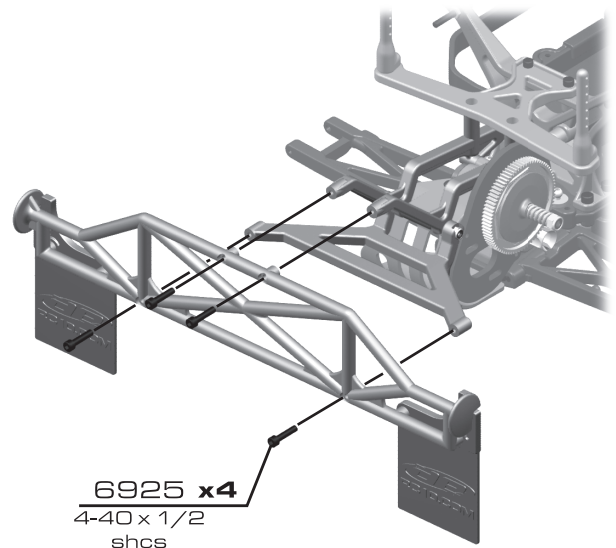

6925 x4
4-40 x 1/2
shcs

:: Rear Hubs

BAG E

E2
STEP 1

3983 ball stud long (black) *
(FT option available)

6272 dust cover foam

7260 4-40 small plain nut

9584 rear hub carriers 1 left & 1 right *
(FT option available)

3977 x2 ball bearing 3/16 x 3/8

9670 rear axle

7377 bearing spacer

7368 3/16 axle shim

7369 x2 1/16" universal roll pins

9883 x2 Wheel hex adapters

LEFT

LEFT

LEFT

Build left and right side. (left side shown)

:: Rear Hubs (cont.)

E3 / 4 / 5
STEP 2

5407 x2 o-ring

7462 dogbone

4187 x2 spacer

9645 2-56 x 1/8 bhcs

9622 hinge pin (rear outer)

Build left and right side. (left side shown)

:: Rear Camber Turnbuckles

E6
STEP 3

! * Orient the notch to the left throughout the car. It indicates which end has the left hand threads.

7230 ball cup (large)

7101 2.80" turnbuckle *

7230 ball cup (large)

x2

3.59" (91.186mm)

(FT option available)

:: Shocks
BAG F

F2
STEP 1

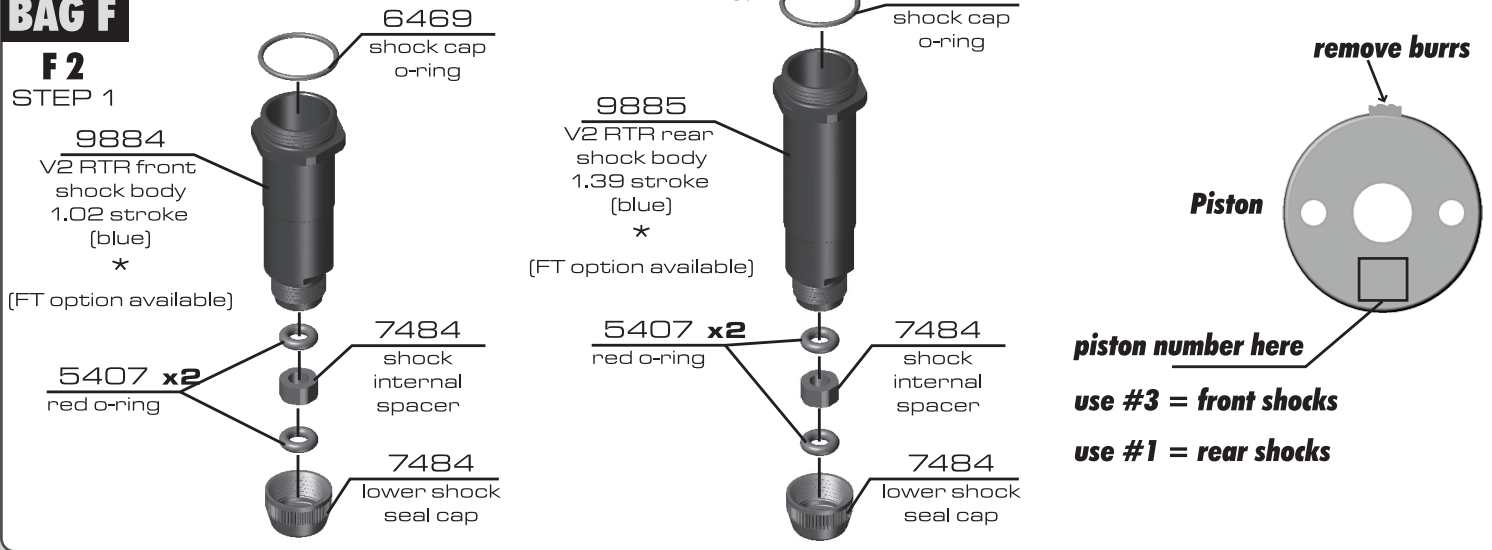

:: Shocks (cont.)

F2 / 3
STEP 2

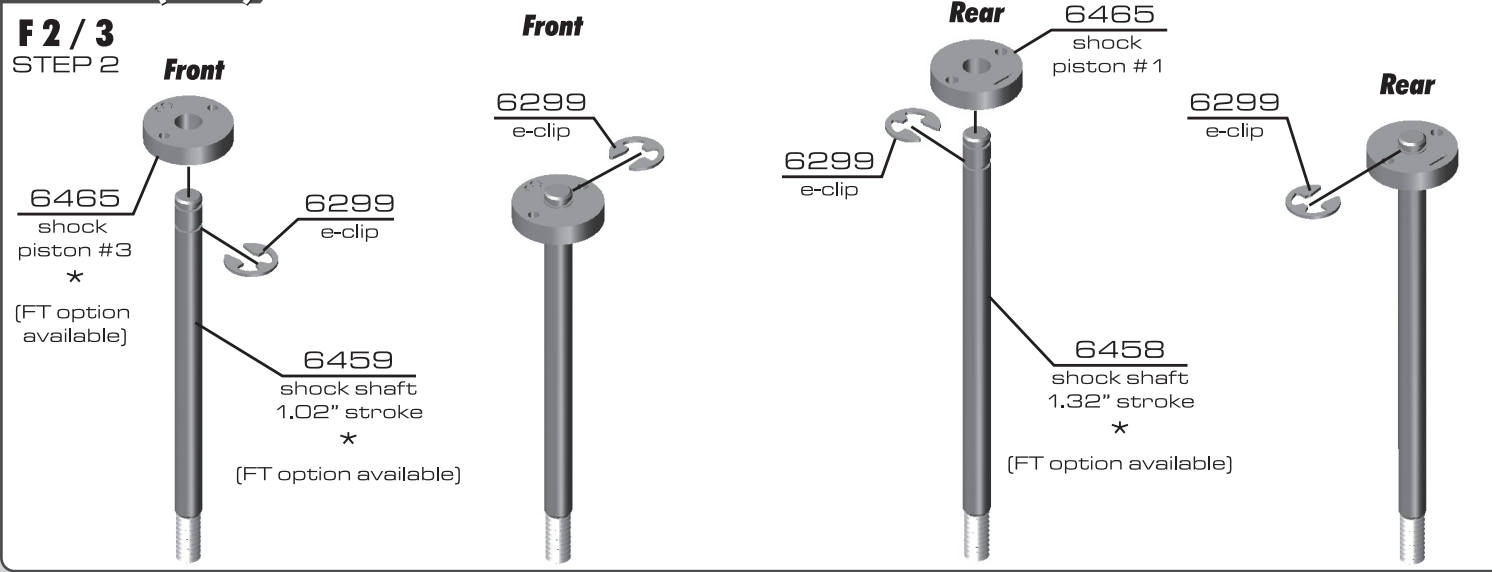

:: Shocks (cont.)

F3
STEP 3

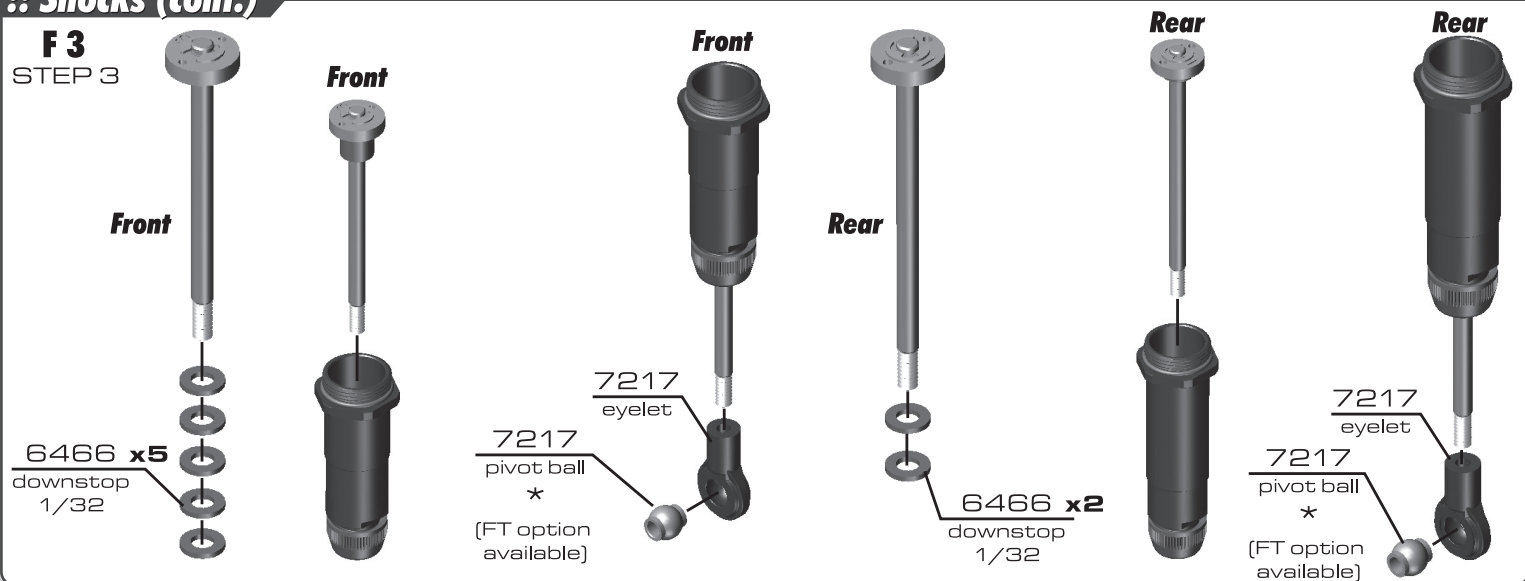

:: Shocks (cont.)

STEP 4

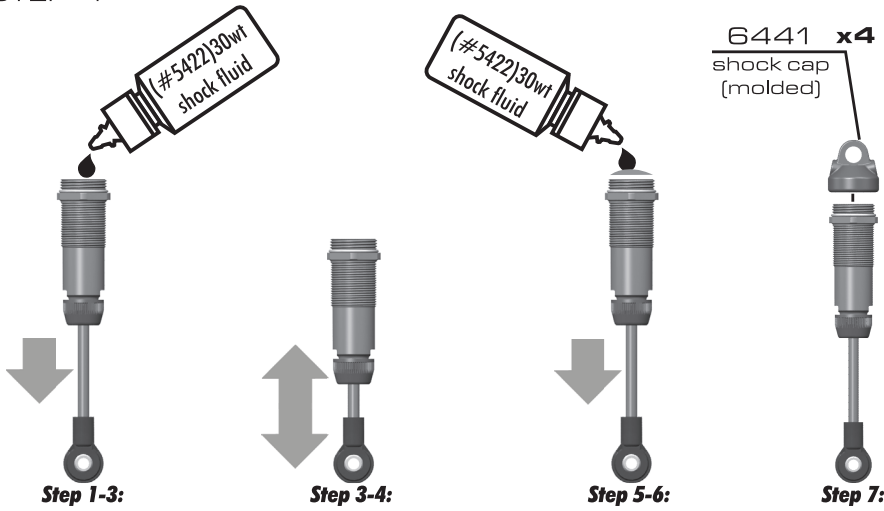

*** Shock Bleeding Steps:**

1. Pull shock shaft down.
2. Fill shock body 3/4 full with silicone fluid.
3. Slowly move the shock shaft up and down to remove air from under piston.
4. Wait for bubbles to come to surface.
5. Fill shock body to top with silicone fluid.
6. Place a drop of oil in the cap and on cap threads.
7. Install cap and tighten completely.
8. Slowly compress shaft all the way to the top. If there is pressure at the top of the stroke, there is too much oil or air. You must bleed it out.
9. Slowly pull shaft out.
10. Unscrew the cap 3/4 turn and tilt the shock at a slight angle.
11. Slowly compress the shaft to push out excess oil and air. You should see bubbles coming out from under the cap.
12. With the shaft compressed, tighten the cap and re-check for pressure at the top of the stroke. If there is still pressure, repeat steps 9 thru 11.

:: Shocks (cont.)

F4 / 5
STEP 5

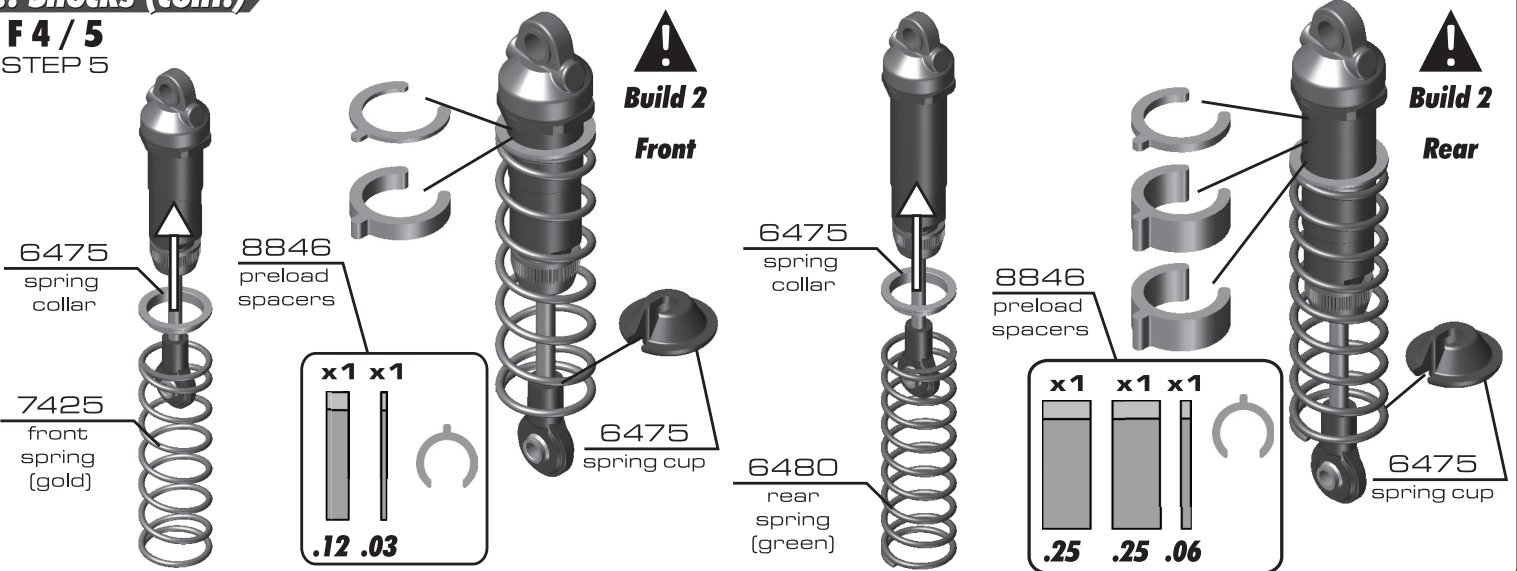

:: Shocks (cont.)

F6
STEP 6

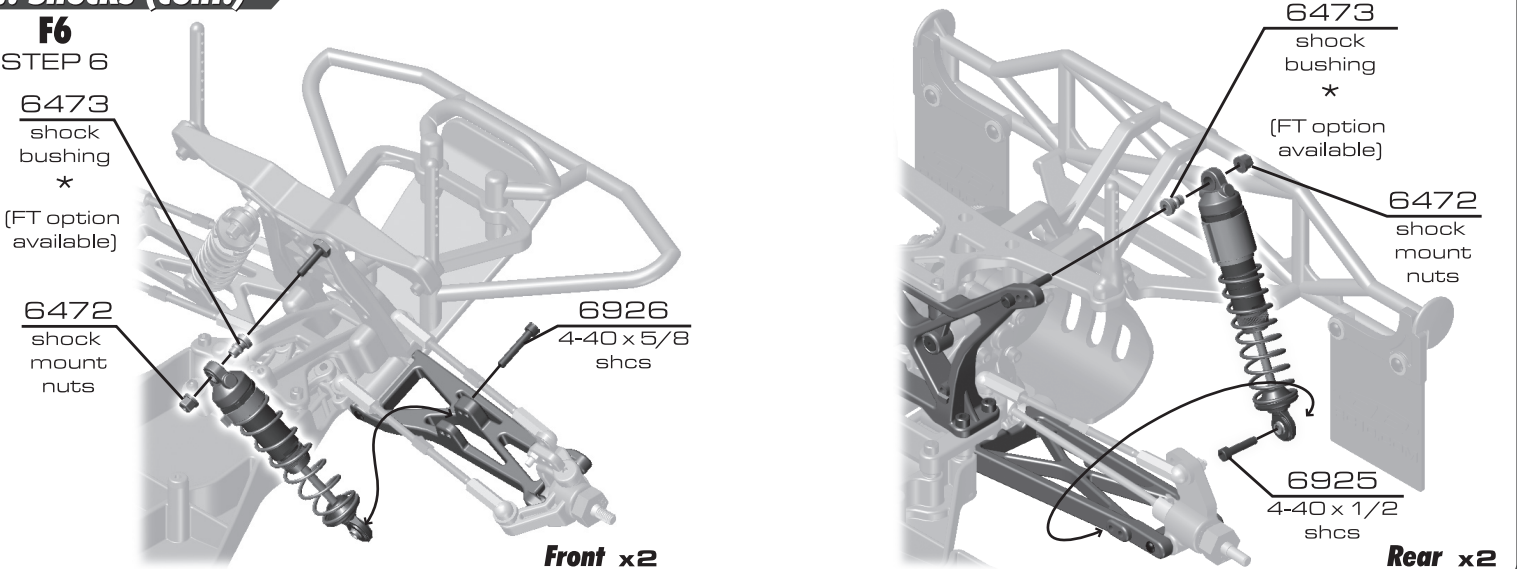

:: Steering Servo

BAG G

G 2 / 3
STEP 1

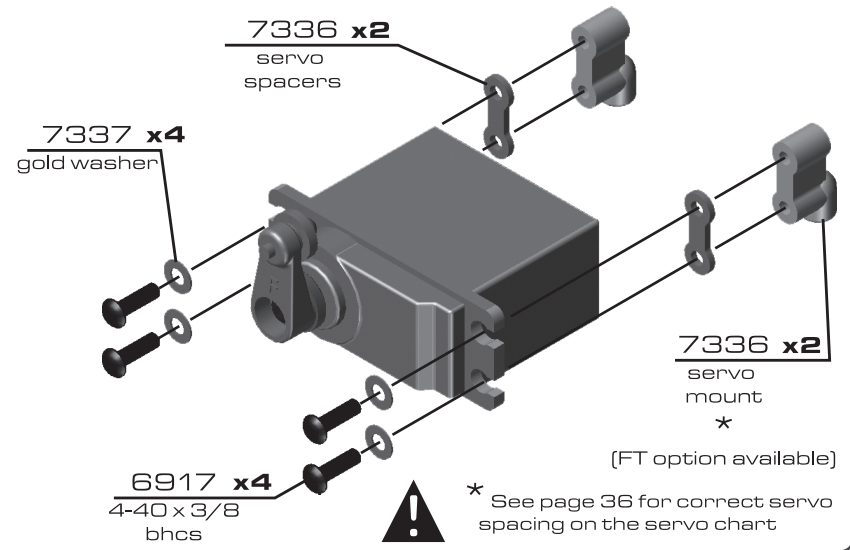
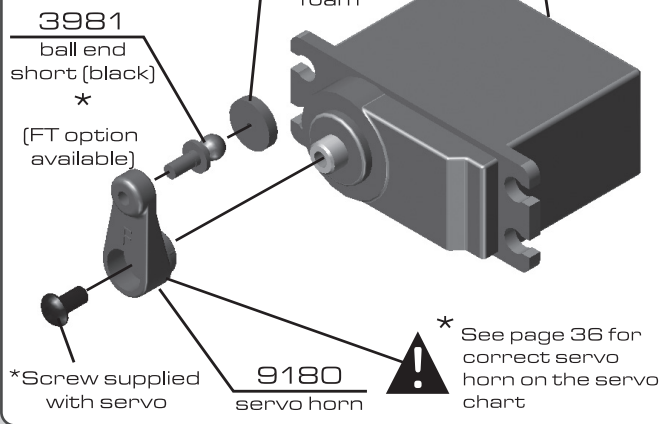

:: Steering Servo (cont.)

G 4
STEP 2

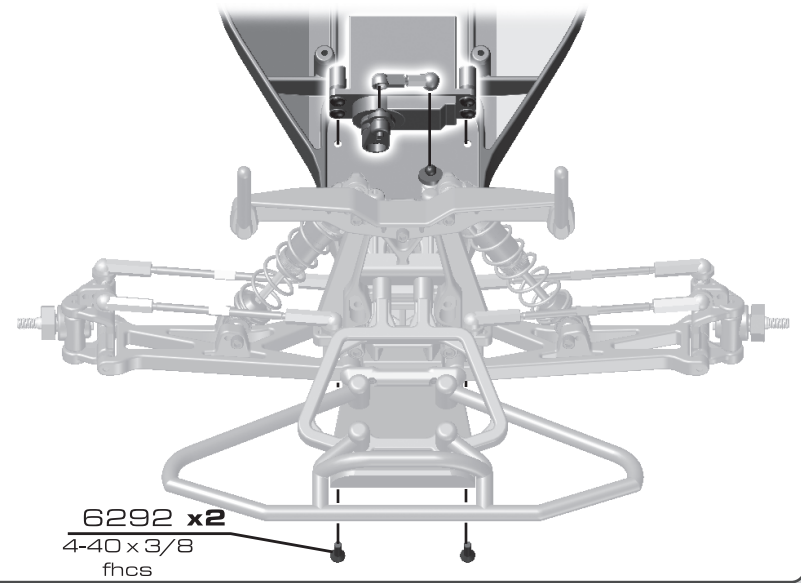
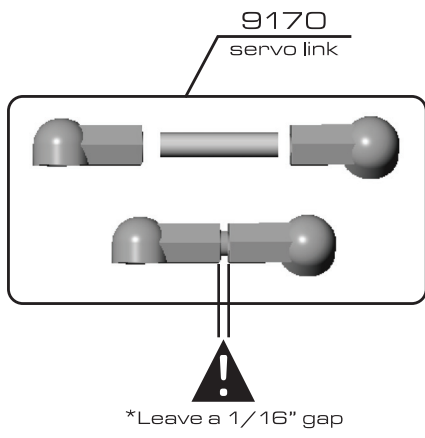

:: Motor / Gear Cover

G 5 / 6
STEP 3

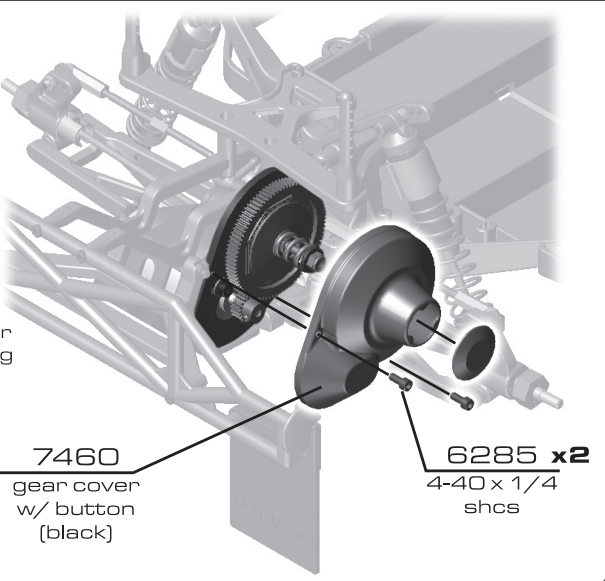
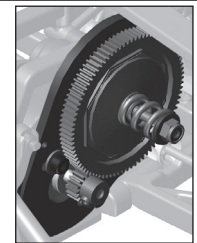
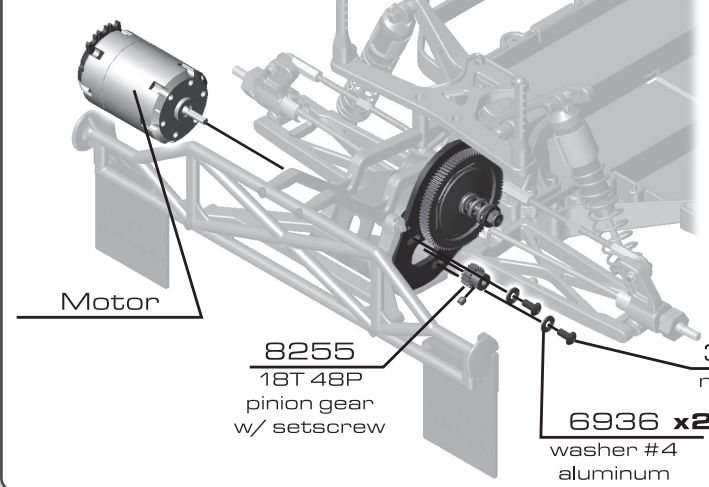

:: Electronics

G 7 / 8
STEP 4

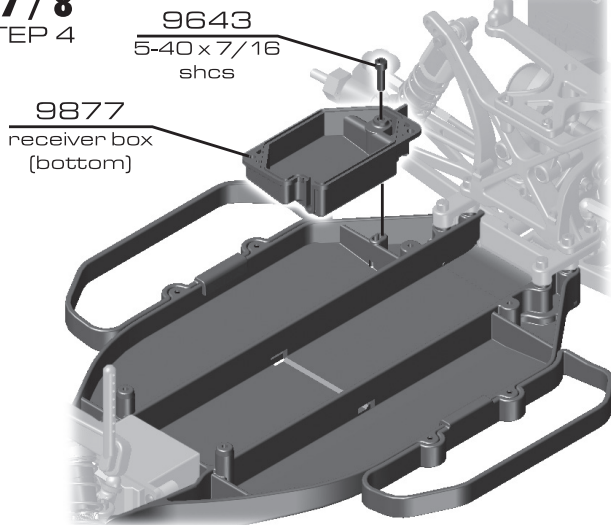

Speed Control

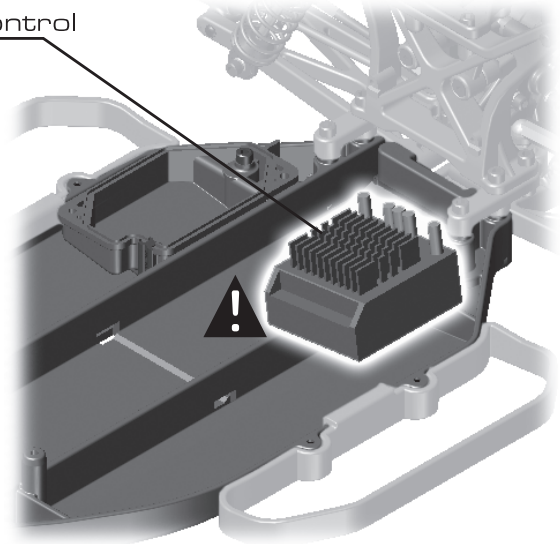

!
* Install the ESC with servo tape.

:: Electronics (cont.)

G 7 / 8
STEP 5

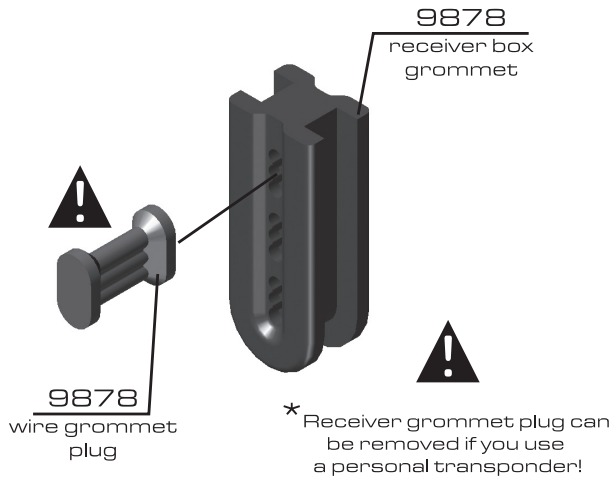

!
* Install the ESC wires and the Servo wires into the wire grommet before installing the grommet into the receiver box!

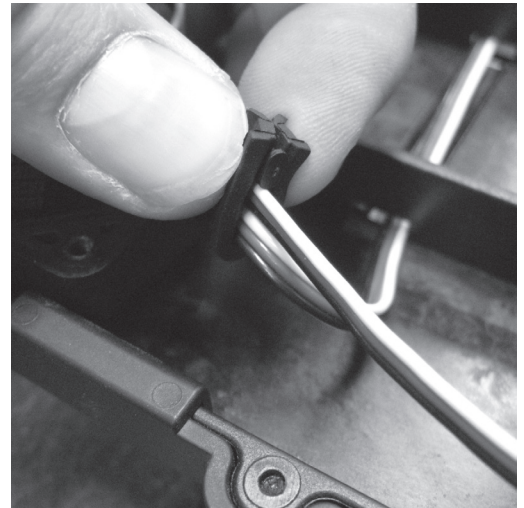

:: Electronics (cont.)

G 7 / 8
STEP 6

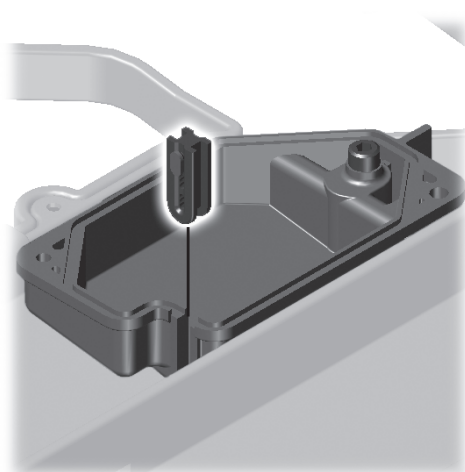

Receiver

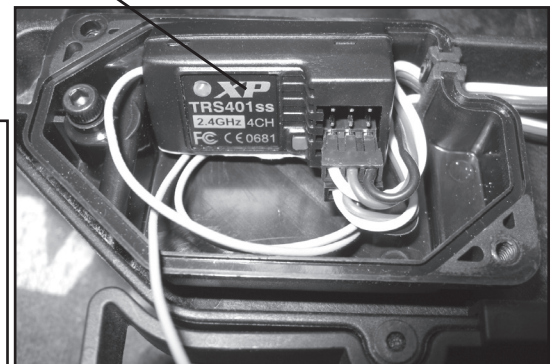

!
* You may need to reposition the receiver in order to get it to fit with the plugs installed and the receiver box lid installed. Once you find a good fit, use servo tape to install your receiver.

:: Electronics (cont.)

G 7 / 8
STEP 7

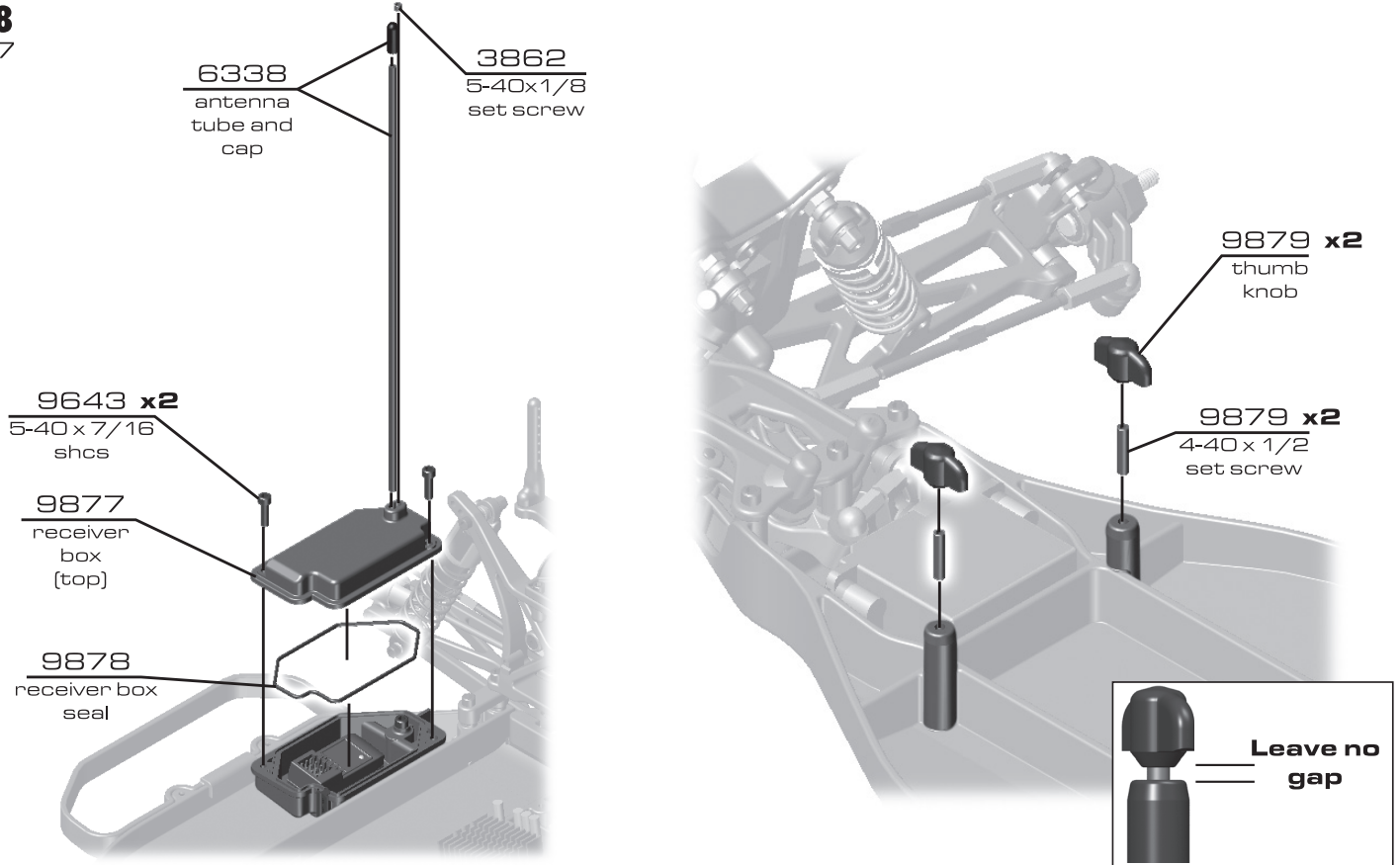

:: Electronics (cont.)

G 7 / 8
STEP 8

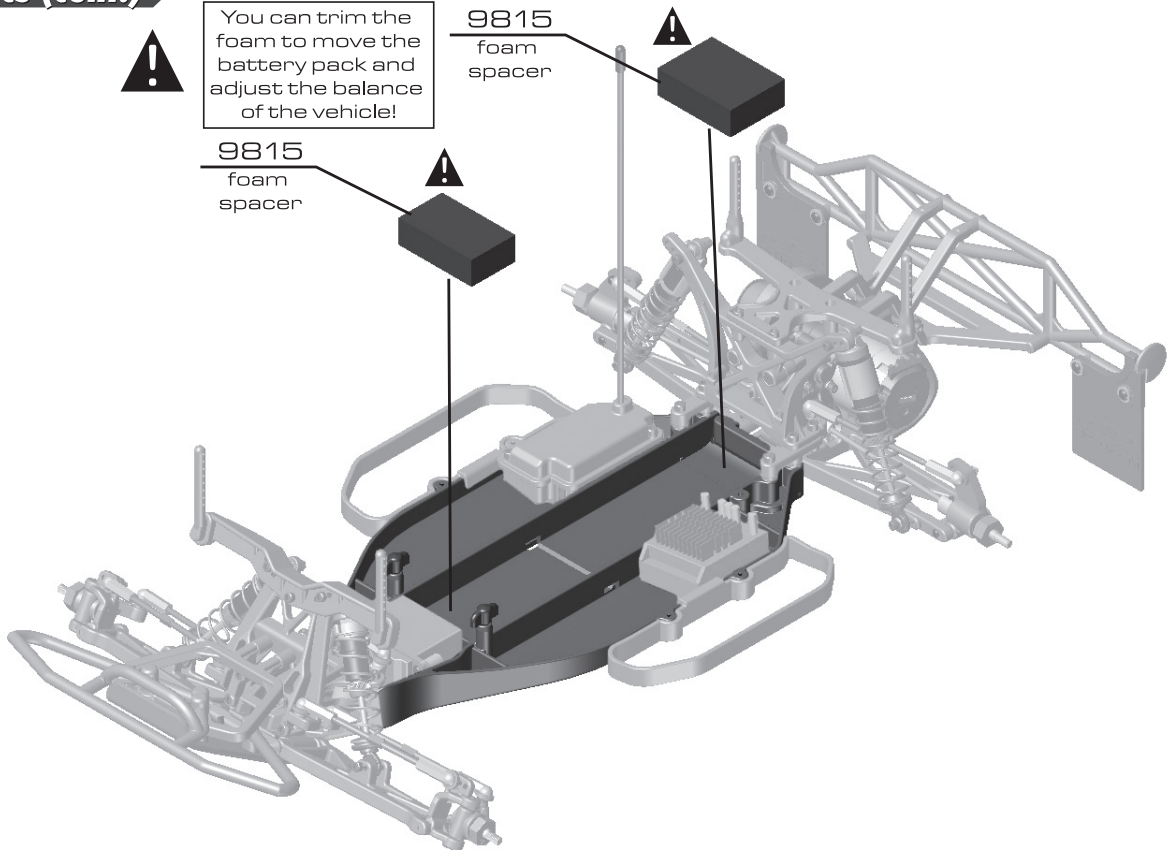

:: Electronics (cont.)

G 7 / 8
STEP 9

9879
LiPo battery strap
*
[FT option available]

* battery not included in kit

* To install the battery strap, slide the back section in between the top of the battery and the bottom of the shock tower!

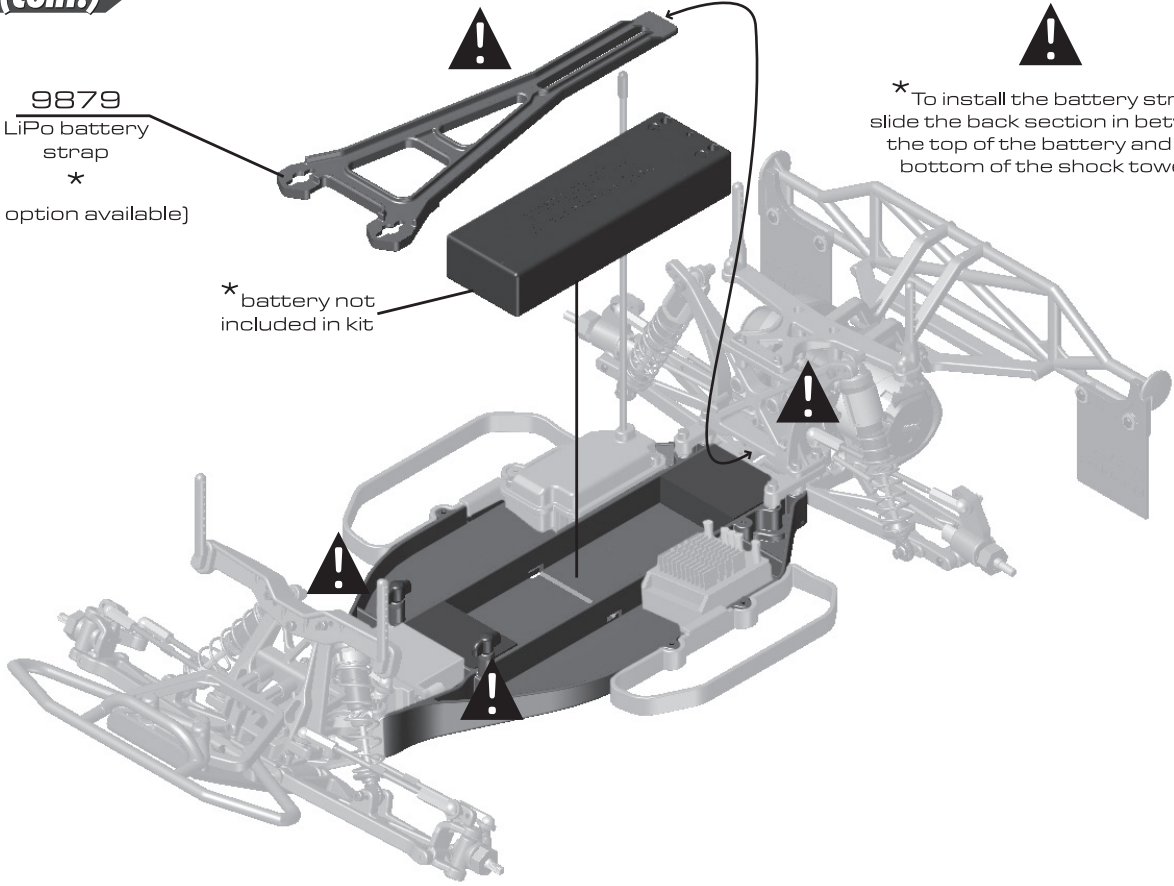

:: Electronics (cont.)

G 7 / 8
STEP 10

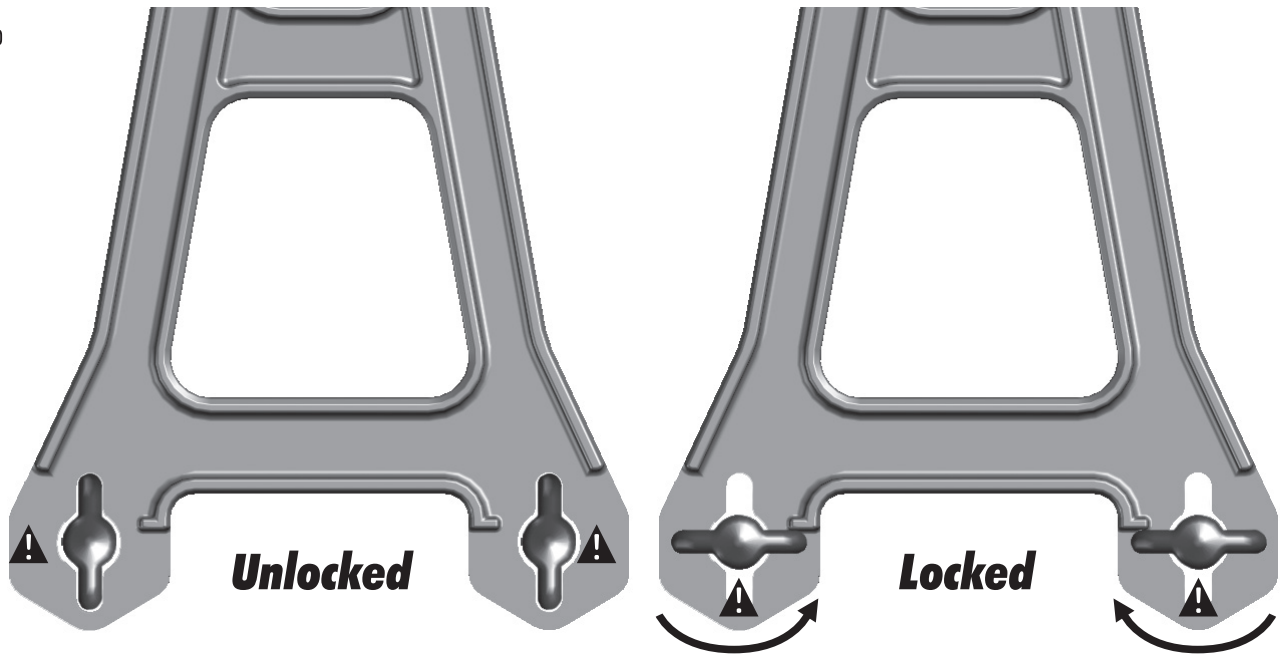

To remove your battery pack from the vehicle, twist the thumb screws to the unlocked position, remove the battery strap, and then remove the battery.
When you install your battery pack, install the battery strap and make sure the thumb screws are locked before operation.

You may need to adjust the height of the thumb screws and/or the set screws that the thumb screws are attached to for your specific battery pack.

:: Wheels and Tires

BAG H

H 1
STEP 1

91101 x2
hex wheel
(black)

9809 x2
tire foam

9809 x2
SC10 tire

* The rear tires included in this RTR are made by JConcepts. JConcepts tires can be purchased at their website: <http://www.jconcepts.net>

* Carefully Apply tire adhesive to the tire bead on both sides. Do one side at a time, allow it to dry before gluing the other side.

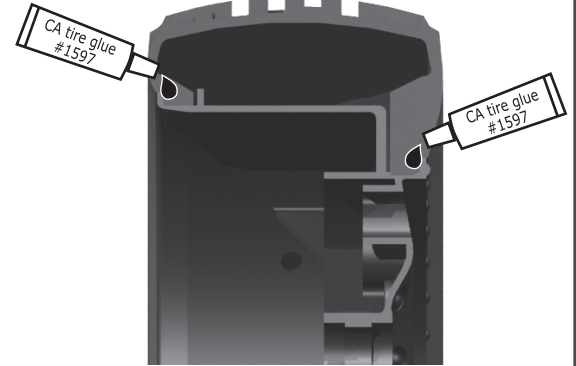

:: Wheels and Tires (cont.)

H 2
STEP 2

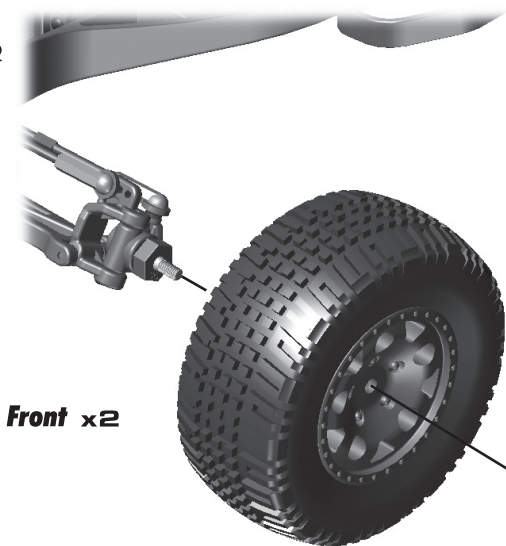

Front x2

6953
8-32 LP steel
locknut (silver)

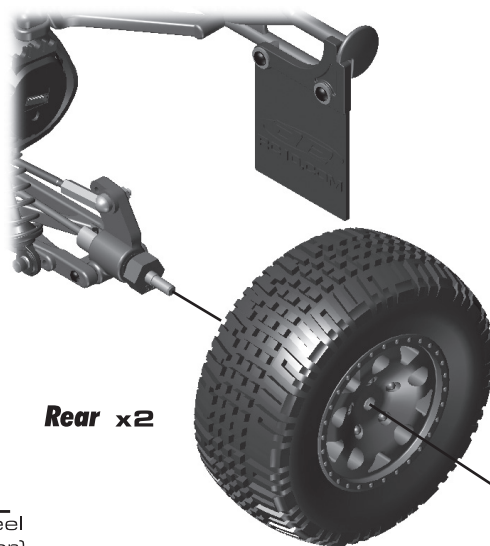

Rear x2

6952
8-32 steel
locknut (silver)

:: Body

H 2
STEP 3

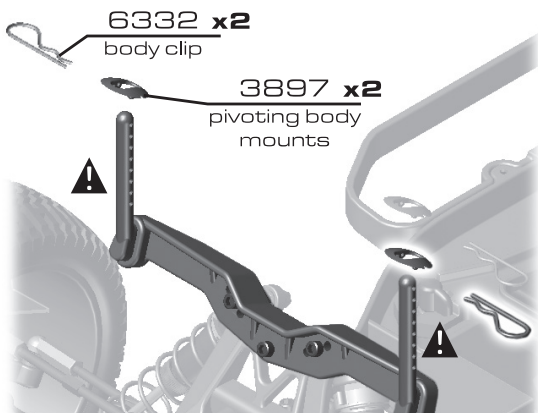

Front

6332 x2
body clip

3897 x2
pivoting body
mounts

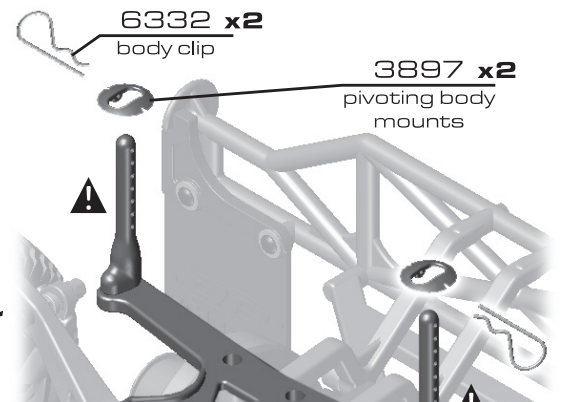

Rear

6332 x2
body clip

3897 x2
pivoting body
mounts

* Install body clips through the pivot body mounts into the body posts.

Front body mounts: 3rd hole from bottom
Rear body mounts: 5th hole from bottom

:: Body (cont.)

H 2

STEP 4

9837
SC10 '09
clear body
number plate



6222 x10
nylon locknuts
4-40/5-40

6288 x10
4-40 x 1/4
bhcs

9837
SC10 '09
clear body
rear fin



9837
SC10 '09
clear body

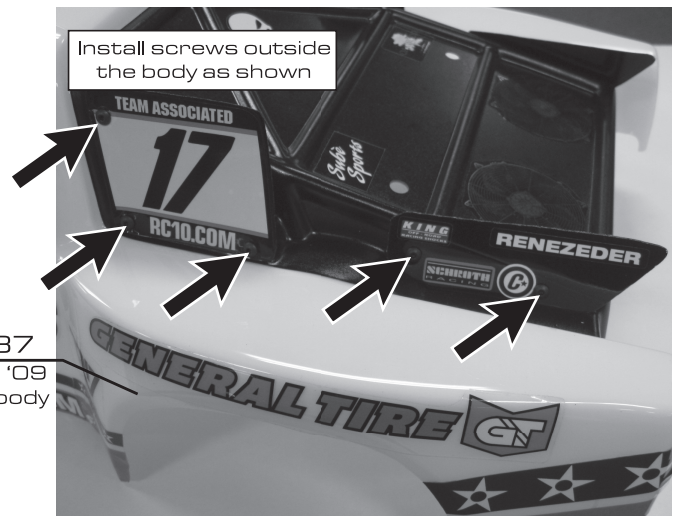

Build left and right sides

:: Body (cont.)

H 2

STEP 5

6332 x4
body clip

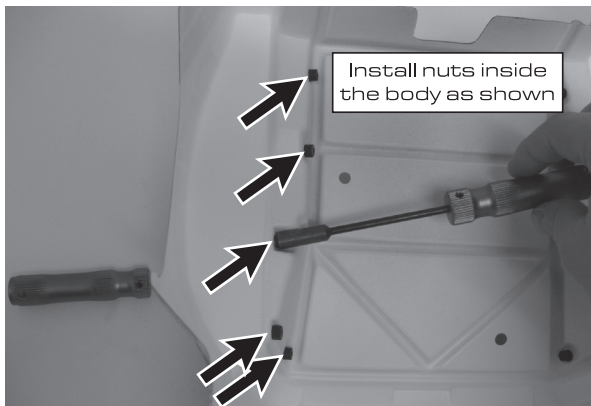

:: Final Adjustments

Use the following steps to make the final adjustments on your truck.

1. Turn the transmitter on.
2. Make sure the motor is disconnected.
3. Connect your battery pack and turn the power switch on.
4. Move the steering control on the transmitter to the right and left. Do the wheels move in the correct direction? If not, you must reverse the steering servo direction on your transmitter (see transmitter manual).
5. Adjust your steering trim (see radio manual) until the steering rack is centered under the top plate. Then, using the two steering turnbuckles, adjust the front wheels so they are pointing straight ahead.
6. Adjust the ESC (electronic speed control) according to the speed control manufacturer's instructions. **Some manufacturers have the motor connected during adjustment and some do not.** Now turn the power switch off.
7. Connect the motor. Place your car on a block or car stand so that all four wheels are elevated. Turn the power switch on again. Check the throttle, brake, and steering settings you have made and then turn the power switch back off.
8. Remember this! The transmitter is always the **FIRST TO BE TURNED ON** and **THE LAST TO BE TURNED OFF.**

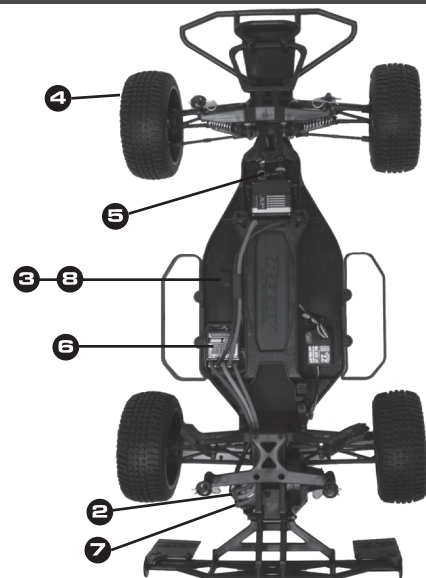

:: Shocks

5407	Red O-Rings	8	
6299	1/8" E-Clips	12	
6441	Shock Cap, Molded	4	
6458	Shock Shaft, 1.32" stroke	1	
6459	Shock Shaft, 1.02" stroke	1	
6465	Shock Pistons, 4 each of #1,2, & 3	1	
6466	Shock Down Stops, Set	1	
6469	Black Shock Cap O-Ring	4	
6472	Shock Mount Nut	4	
6473	Shock Bushings	4	
6475	Preload Spacers, Collars & Cups 4 thicknesses, 4 sets each	1	
6925	4-40 x 1/2" SHCS	6	
6926	4-40 x 5/8" SHCS	6	
7217	Shock Rod Ends / Plastic Pivot Balls	2	
7484	V2 1/10 Shocks Rebuild Kit (rebuilds 4)	1	
8846	Preload Spacers, 4 each of 4 different sizes	1	
9884	V2 RTR Front Shock Bodies 1.02"	Pr.	
9885	V2 RTR Rear Shock Bodies 1.39"	Pr.	

:: Shock Springs

1580	Factory Team Truck Front Spring Kit. I pair of green, silver, blue, gold, and red front springs	1	
1582	Factory Team Truck Front Spring Kit. I pair of green, silver, blue, gold, and red rear springs	1	
6478	Rear Spring Silver 2.10 lb	Pr.	
6480	Rear Spring Green 1.90 lb (Kit)	Pr.	
6481	Rear Spring Black 1.74 lb	Pr.	
6482	Rear Spring Gray 2.33 lb	Pr.	
7425	Front Spring Gold 3.70 lb (Kit)	Pr.	
7426	Front Spring Black 2.765 lb	Pr.	
7427	Front Spring Green 2.99 lb	Pr.	
7428	Front Spring Silver 3.225 lb	Pr.	
7429	Front Spring Blue 3.45 lb	Pr.	
7430	Front Spring Red 3.90 lb	Pr.	
7434	Rear Spring Blue 2.55 lb	Pr.	
7435	Rear Spring Gold 2.75 lb	Pr.	
7436	Rear Spring Red 2.95 lb	Pr.	

:: Shock Oil

5420	10 Weight Silicone Shock Oil	2oz.
5421	20 Weight Silicone Shock Oil	2oz.
5422	30 Weight Silicone Shock Oil	2oz.
5423	40 Weight Silicone Shock Oil	2oz.
5424	22.5 Weight Silicone Shock Oil	2oz.
5426	27.5 Weight Silicone Shock Oil	2oz.
5427	15 Weight Silicone Shock Oil	2oz.
5428	25 Weight Silicone Shock Oil	2oz.
5429	35 Weight Silicone Shock Oil	2oz.
5430	45 Weight Silicone Shock Oil	2oz.
5432	32.5 Weight Silicone Shock Oil	2oz.
5433	37.5 Weight Silicone Shock Oil	2oz.
5434	42.5 Weight Silicone Shock Oil	2oz.
5438	47.5 Weight Silicone Shock Oil	2oz.

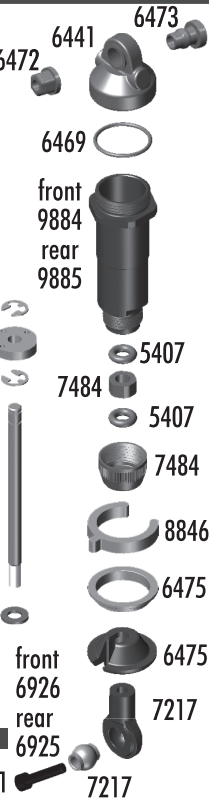

:: Transmission

3977	Ball Bearing, 3/16" x 3/8"	2
6913	4-40 x 1 1/4" SHCS	6
6925	4-40 x 1/2" SHCS	6
6928	4-40 x 1" SHCS	6
9360	Idler Gear, molded	1
9361	Idler Gear Shaft	1
9600	B4/T4 Motor Plate	1
9601	B4/T4 Top Shaft	1
9602	B4/T4 Top Shaft Spacer	1
9630	Ball End Washer	10
9826	SC10 Transmission Case (left & right)	1
9832	Ball Bearing, 10 x 16mm	2

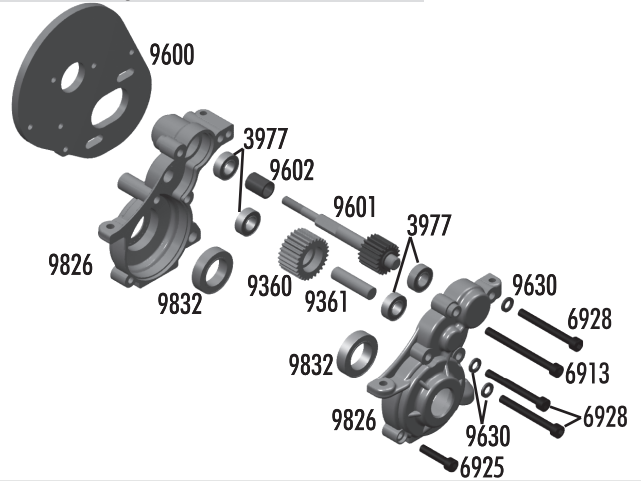

:: Slipper Clutch

6285	4-40 x 1/4 SHCS	12
6629	5-40 Locknuts	6
7460	Molded B4/T4 Gear Cover, black (Kit)	1
7461	Molded B4/T4 Gear Cover, clear	1
7486	V2 Slipper Spring and Washer	1
7485	V2 Slipper Hubs	2
9603	B4/T4 Slipper Pad	2
9650	75T 48P Spur Gear	1
9651	81T 48P Spur Gear	1
9652	78T 48P Spur Gear	1
9653	84T 48P Spur Gear	1
9654	87T 48P Spur Gear (Kit)	1

:: Pinion

8252	15T 48P Pinion Gear	1
8253	16T 48P Pinion Gear	1
8254	17T 48P Pinion Gear	1
8255	18T 48P Pinion Gear (Kit)	1
8256	19T 48P Pinion Gear	1
8257	20T 48P Pinion Gear	1
8258	21T 48P Pinion Gear	1
8259	22T 48P Pinion Gear	1
8260	23T 48P Pinion Gear	1
8261	24T 48P Pinion Gear	1
8262	25T 48P Pinion Gear	1
8263	26T 48P Pinion Gear	1



:: Gear Differential

9827	Complete Gear Diff	1
9828	Diff Gear and Cover	1
9829	Gear Diff Rebuild	1
9830	Gear Diff Outdrives, Set	1
9831	Gear Diff O-Ring Set	1
9832	10x16mm Bearing	2
9888	0.5mm Gear Diff Shim	2

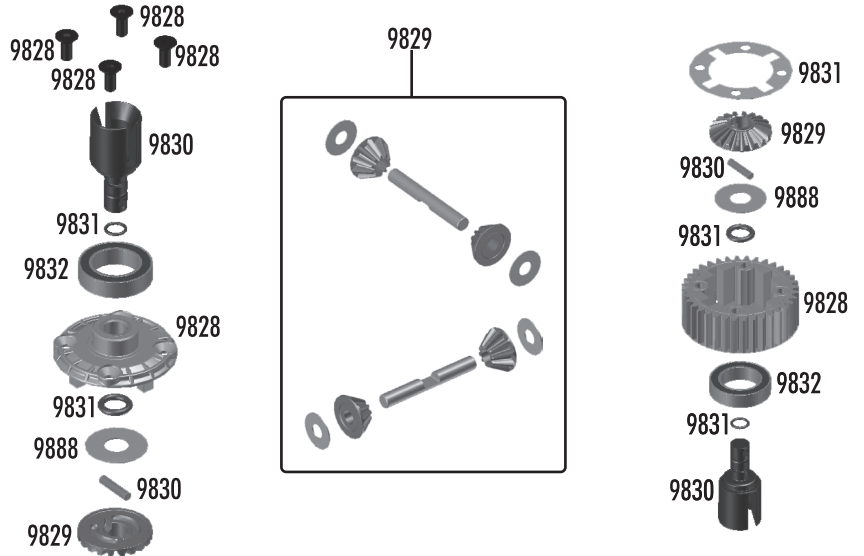

:: Diff Fluids

5450	Silicone Diff Fluid 1000CST	1
5451	Silicone Diff Fluid 2000CST	1
5452	Silicone Diff Fluid 3000CST	1
5453	Silicone Diff Fluid 5000CST	1
5454	Silicone Diff Fluid 7000CST	1
5455	Silicone Diff Fluid 10000CST	1

:: Front Bumper / Shock Tower

3897	Pivoting Body Mounts, Set	1
6272	Foam Ballend Dust Covers	28
6277	Ballstud .30 Silver (short)	4
6292	4-40 x 3/8" FHCS	6
6295	4-40 Nut	18
6332	Body Clips	6
6915	4-40 x 5/8" FHCS	6
6924	4-40 x 3/8" SHCS	6
6925	4-40 x 1/2" SHCS	6
7738	4-40 x 7/8" SHCS	6
9630	.030" Ballstud Washer	10
9816	SC10 Front Bumper, Front Bumper Brace, Skid Plate Set	1
9820	SC10 Front Body Mount	1
9821	SC10 Front Body Posts, Set	1
9825	SC10 Front Shock Tower	1

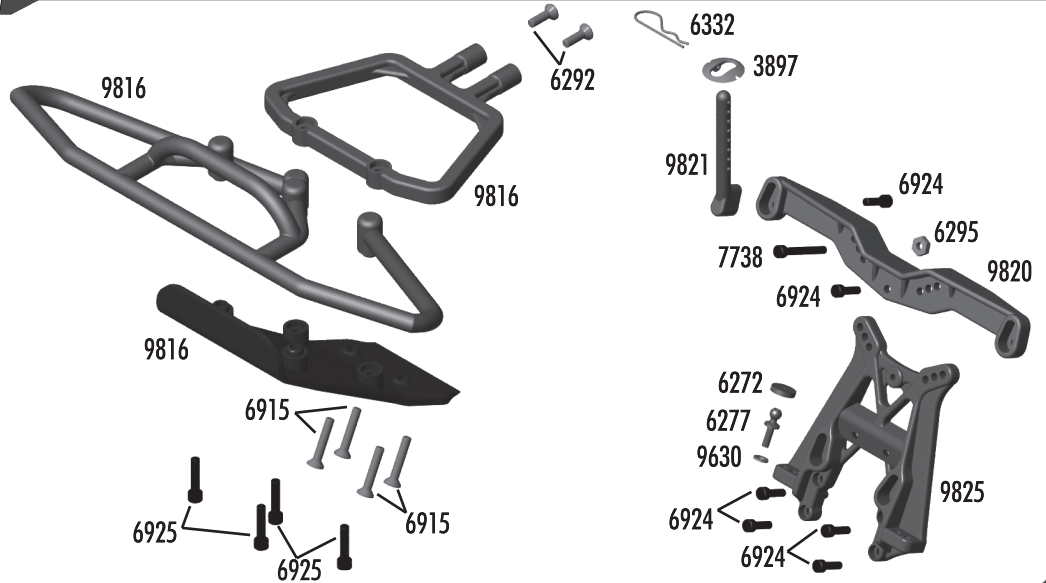

:: Front Arms / Steering

3977	Ball Bearing 3/16" x 3/8"	2
3983	Ballstud .30" Black (short)	6
4187	.030 Nylon Washers	12
4449	4-40x3/16 Aluminum Locknut	5
6272	Foam Ballend Dust Covers	28
6277	Ballstud .30 Silver (short)	4
6953	8-32 LP Locking Nut, Steel	6
7260	4-40 Plain Nut	12
7369	1/16" Unoiversal Roll Pin	4
7446	T4 Front A-Arm (left & right)	Pr.
7922	30° Caster Blocks (left & right)	Pr.
9580	Caster Block Spacers, Set	1
9621	B4 Inner Hinge Pin Set	1
9622	B4 Outer Hinge Pin Set	1
9645	2-56 x 1/8" BHCS	8
9880	Steering Blocks, hex style	Pr.

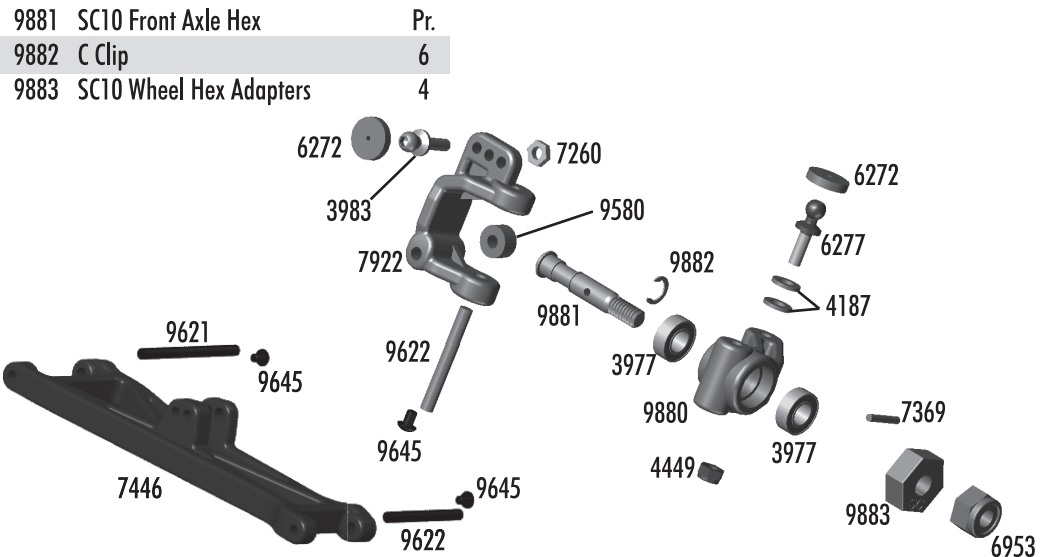

:: Front Bulkhead

2221	4-40 x 7/16" BHCS	6
3856	Steering Bushings, Set	1
6272	Foam Ball end Dust Covers	28
6276	Ballstud .20" Silver (short)	6
6925	4-40 x 1/2" SHCS	6
9566	B4 / T4 Top Plate	1
9610	Servo Saver / Steering Hardware	1
9640	B4 / T4 Steering Bolt, left & right	1
9657	B4 / T4 HD Servo Saver Spring	1
9659	B4 / T4 Steering Set. Includes Rack, Bellcrank, Servo Saver, Steering Brace	1

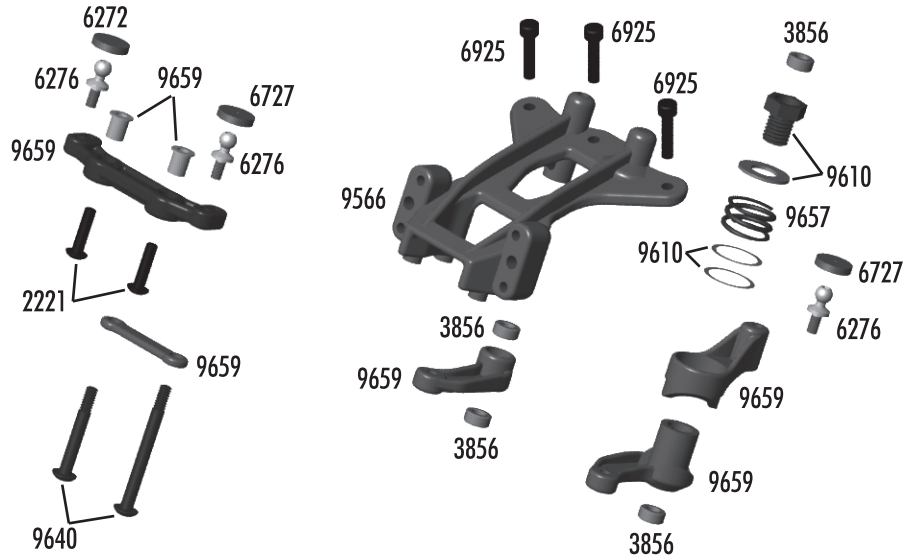

:: Turnbuckles / Servo

3981	Ballstud .20" Black (short)	6
6272	Foam Ballend Dust Cover	28
6292	4-40 x 3/8" FHCS	6
6917	4-40 x 3/8" BHCS	6
7101	Turnbuckle 2.80"	Pr.
7230	Ballcups, large	12
7253	Turnbuckle 2.62"	Pr.
7336	Servo Mount Set	1
7337	Gold Washer	4
9170	B4 / T4 Servo Link	1
9180	Servo Horns Set	1

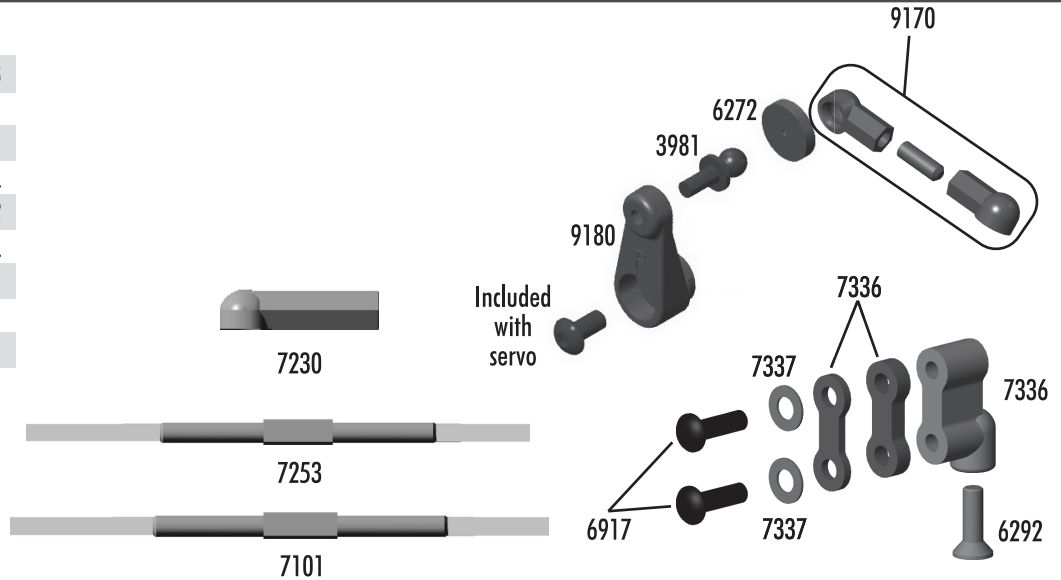

:: Battery Strap

9815	SC10 Foam Battery Spacer	1
9879	SC10 LiPo Battery Strap. Thumb Screws, and Set Screws	1

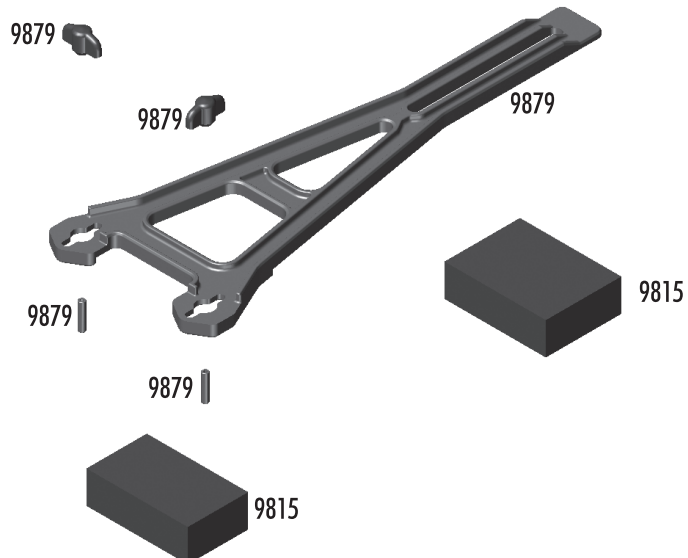

:: Chassis

3862	5-40 x 1/8" Set Screw	6
4334	2-56 x 5/16" BHCS	8
6272	Foam Ballend Dust Cover	28
6277	Ballstud .30" Silver (long)	4
6338	Antenna Tube (black)	1
6917	4-40 x 3/8" BHCS	6
6919	4-40 x 5/16" BHCS	6
6922	4-40 x 1/2" FHCS	6
6924	4-40 x 3/8" SHCS	6
7487	Arm Mounts, 2.5, 3, 3.5, 4	1
9269	5-40 x 1/2" FHCS	6
9563	B4 / T4 / GT2 Front Bulkhead	1
9564	RR / FR Hinge Brace	1
9621	B4 Inner Hinge Pin Set	4
9630	.030 Ballstud Washer	10
9643	5-40 x 7/16" SHCS	6
9645	2-56 x 1/8" BHCS	8
9818	SC10 Arm Mount / Chassis Plate	1
9819	SC10 Rear Motor Guard	1
9822	SC10 Nerf Bars	Pr.
9823	SC10 Chassis	1
9877	SC10 Receiver Box	1
9878	SC10 Receiver Box Seals	1

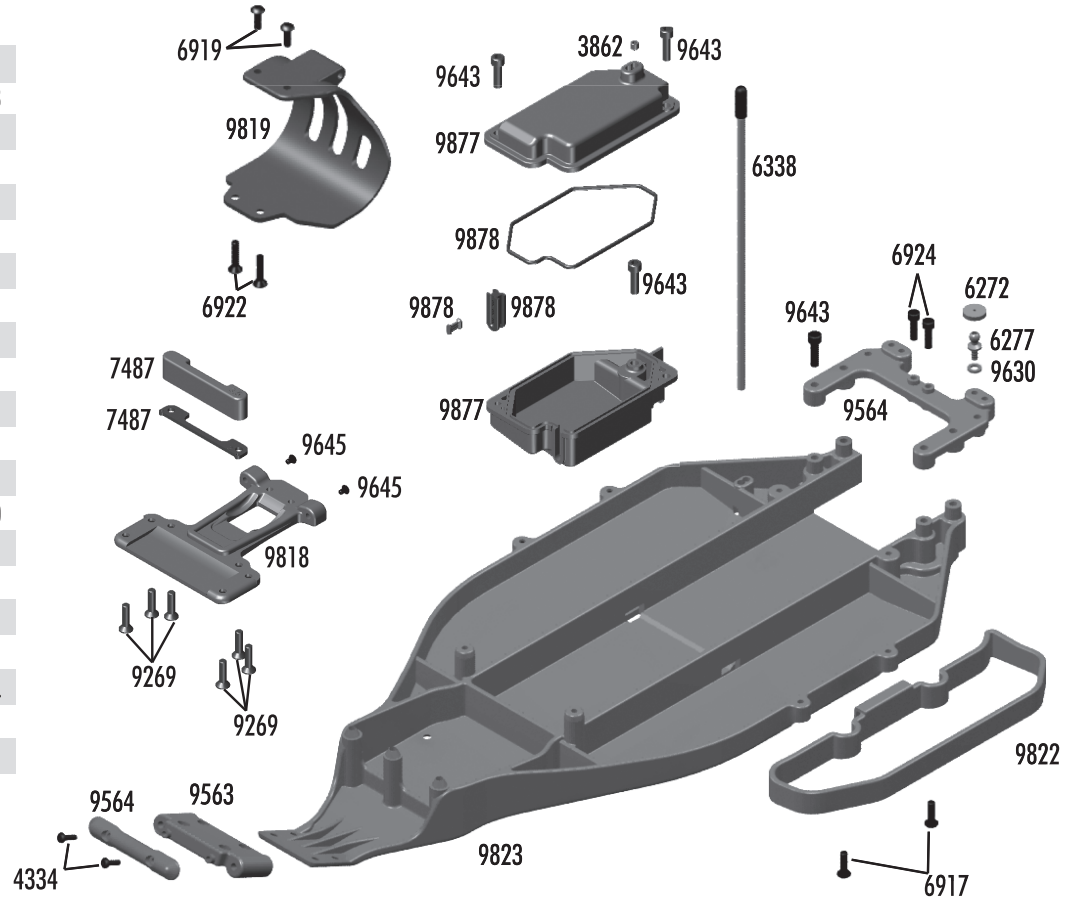

:: Rear Arms / Hubs

3977	Ball Bearing 3/16 x 3/8"	2
3983	Ballstud .30" Black (long)	6
4187	.030 Nylon Washers	12
5407	Red O-Ring	8
6272	Foam Ballend Dust Cover	28
6952	8-32 Locking Nut, steel	6
7260	4-40 Plain Nut	12
7369	1/16" Axle Roll Pins	4
7377	Axle Spacer Crush Tubes	2
7448	T4 Rear A-Arms	Pr.
7462	T4 / GT2 RTR Dogbone	1
9584	B4 / T4 RR Hub Carrier (left & right)	Pr.
9621	B4 Inner Hinge Pin Set	4
9622	B4 Outer Hinge Pin Set	6
9645	2-56 x 1/8" BHCS	8
9670	3/16" Rear Axle	1
9883	SC10 Wheel Hex Adapters	4

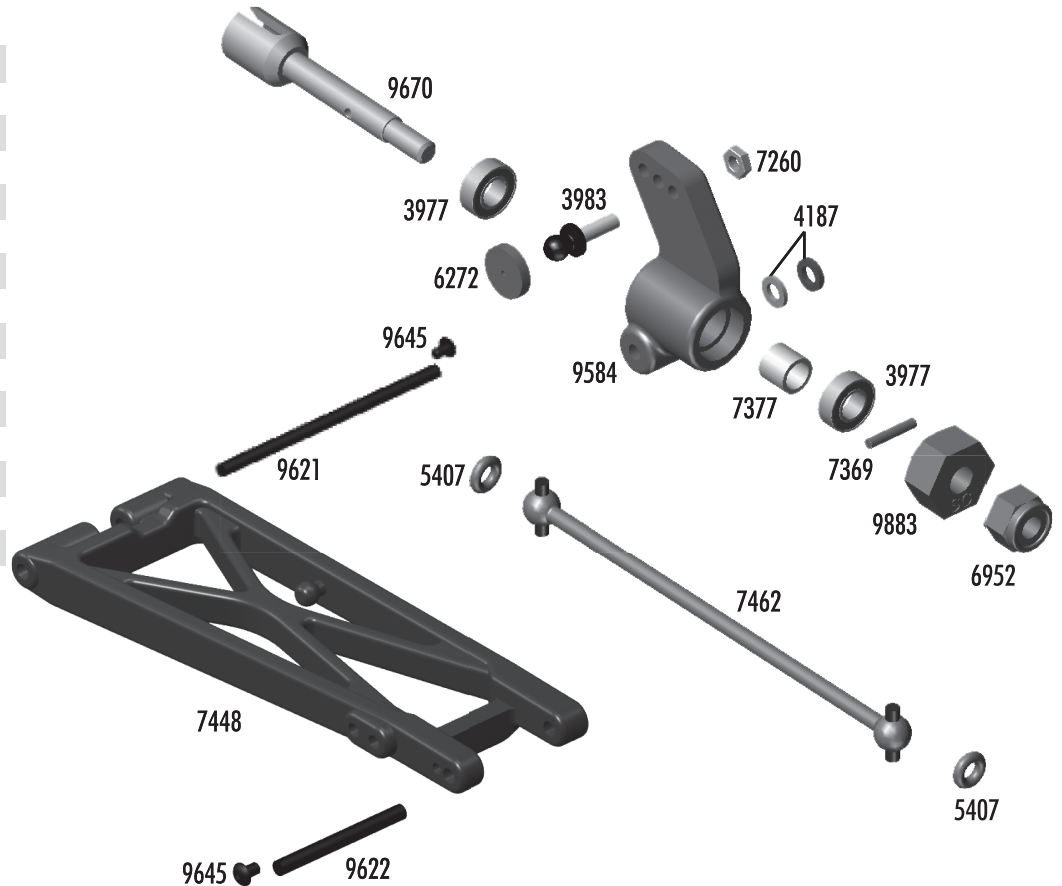

:: Rear Shock Tower

3897	Pivoting Body Mounts, Set	1
6332	Body Clips	6
6915	4-40 x 5/8" FHCS	6
6924	4-40 x 3/8" SHCS	6
6927	4-40 x 3/4" SHCS	6
7260	4-40 Plain Nut	12
9643	5-40 x 7/16" SHCS	6
9644	5-40 x 9/16" SHCS	6
9820	SC10 Body Mounts FR / RR	1
9821	SC10 Body Posts, Set	1
9824	T4 / SC10 Rear Shock Tower	1

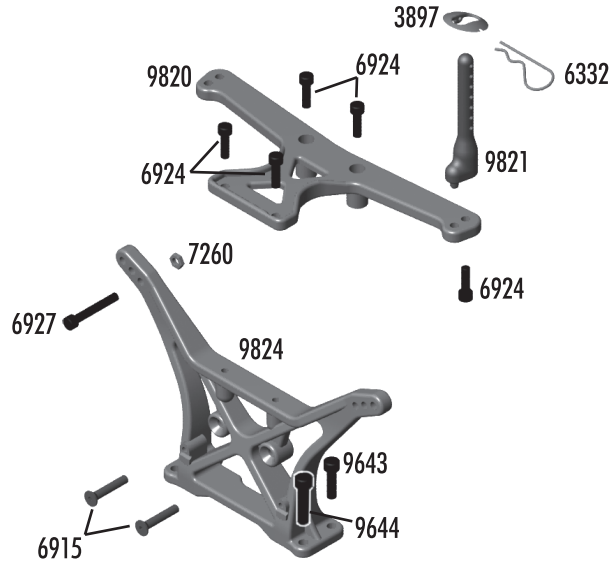

:: Rear Bumper / Braces

4449	4-40 x 3/16" Aluminum Locknut	5
6917	4-40 x 3/8" BHCS	6
6925	4-40 x 1/2" SHCS	6
9817	SC10 RR Bumper and Brace, Includes Bumper, Braces (left, right, upper, and lower),	1
9833	4-40 x 1 3/4" SHCS	6
89218	3x8mm washer	10
89430	Mud Flaps	Pr.

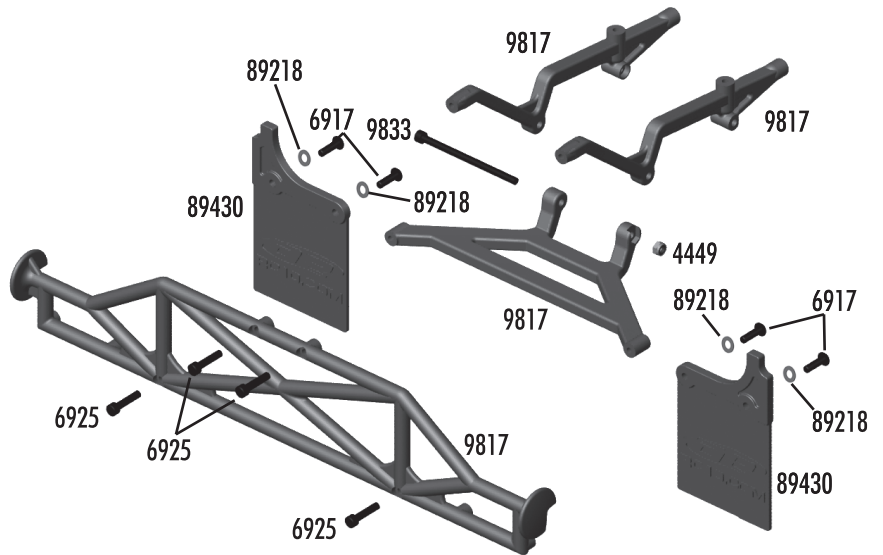

:: Wheels / Tires

9809	SC10 Tire with Foam Insert	2
9889	Mounted Subcultures on Hex Wheels, Black	2
89413	1/8 Molded Tire Insert	2
91101	KMC Hex Wheels, Black (Kit)	2
91102	KMC Hex Wheels, Silver	2
91103	KMC Hex Wheels, Chrome	2
91104	KMC Hex Wheels/Tire Black (Kit)	2
91105	KMC Hex Wheels/Tire Silver	2
91106	KMC Hex Wheels/Tire Chrome	2

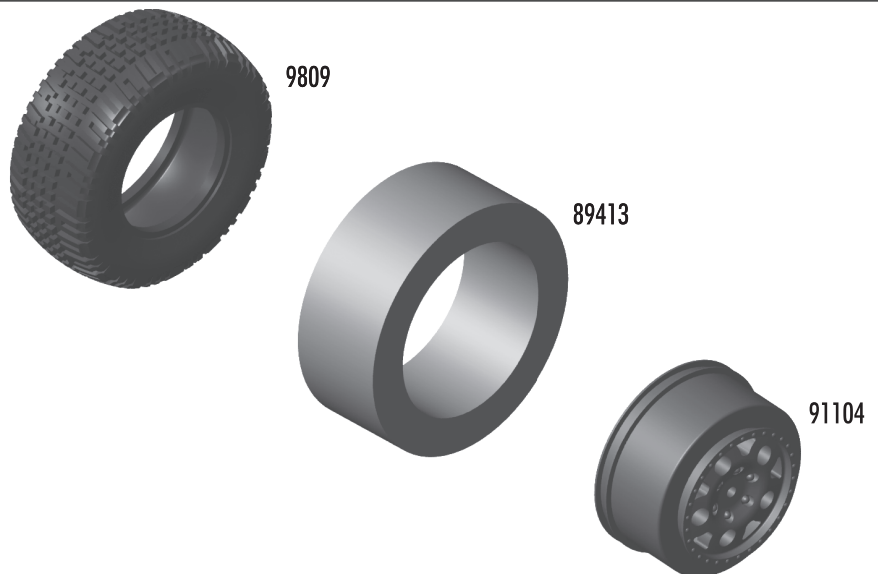

:: Factory Team and Option Parts

1283	FT T4 Ti Turnbuckle Set	1
1408	FT Ti Turnbuckle, 2.65" (blue) for front steering	Pr.
1409	FT Ti Turnbuckle, 1" (sway bar) (blue)	Pr.
1417	FT Ti Turnbuckle, 2.80" (blue) for front / rear camber	Pr.
1585	FT B4 Aluminum Trailing Axle, requires # 9581, 4187 Not for hex	Pr.
1598	FT Blue Aluminum Shock Caps, (blue) see also #6439	4
1654	FT Solid Axle Pins	4
1734	FT Blue Body Clip, 4 long, 6 short	10
1735	FT Blue Body Clip, long	4
1736	FT Blue Body Clip, short	6
1770	FT Milled Aluminum Motor Plate, (blue)	1
1777	Blue Aluminum Shock Ball Ends with Eyelets, Set	1
1778	FT Milled Aluminum Motor Plate, (black)	1
1779	FT Servo Mounts, blue aluminum	Pr.
1780	FT Blue Aluminum Threaded Shock Bushings	4
1781	FT Rear Shock Bushing (short)	4
1787	FT Battery Strap Thumb Screws, Set	1
3438	8-32 LP Locknuts (blue)	3
3971	Steering Rack Bearings	4
6416	Gold Shock Shaft, 1.32" stroke	1
6417	Gold Shock Shaft, 1.02" stroke	1
6439	FT Blue Aluminum Shock Caps, (blue) see also #1598	1
6443	Bleeder Shock Caps, 1/10	4
6463	Shock Pistons, Blank	8
6584	3/32" Ceramic Diff Balls	12
6906	Ball Bearing, PTFE Sealed 3/16 x 3/8"	2
6937	FT 4-40 Aluminum Locknuts (blue)	6
6943	FT 8-32 Aluminum Locknuts (blue)	6
7381	CVD/CVA Rebuild Kit	1
7416	FT Threaded Shock Collar & O-Rings	Pr.
7447	T4 Front A-Arm, Carbon	Pr.
7449	T4 Rear A-Arm, Carbon	Pr.
7453	CVD Axle Bone T4 (black)	Pr.
7455	CVD Set T4	Pr.
7476	FT V2 1.02" Threaded Shocks Kit	Pr.
7477	FT V2 1.02" Threaded Shock Bodies	Pr.
7482	FT V2 1.39" Threaded Shocks Kit	Pr.
7483	FT V2 1.39" Threaded Shock Bodies	Pr.
7495	FT Vented V2 Slipper Hubs	2
7922	Caster Block 30 deg, (left & right) (Kit)	Pr.
7933	Crush Tube (for use with FT Aluminum Hubs Only)	2
7935	.187 x .50 x .196 Bearing (for use with FT Aluminum Hubs Only)	2
7990	Aluminum Front Bulkhead (blue)	1
9565	B4 / T4 Chassis Brace, Hinge Pin Brace, Carbon	1
9567	B4 / T4 Top Plate, Carbon	1
9592	B4 / T4 Caster Block 20 deg, (left & right)	Pr.
9596	FT SC10 / T4 CVA Bones, requires #9761	Pr.
9598	CVD Axles B4, T4, SC10	Pr.
9600B	FT B4 / T4 Aluminum Motor Plate (blue)	1
9608	RR Axle Wheel Spacer (silver)	Pr.
9610B	B4 / T4 Blue Servo Saver Bolt	1
9635	B4 / T4 Sway Bar Kit.	1
9665	FT B4 / T4 Aluminum Hinge Pin Brace V2	1

:: Factory Team and Option Parts (cont.)

9674	T4 Shiny CVD Dogbone, requires #9598	Pr.
9678	FT SC10 / T4 CVA Set	Pr.
9755	CVA Axle, Rear B44, B4, T4, SC10	Pr.
9789	SC10 / B4 FT Ti Front Axles, Set, requires # 9581, 4187 Not for hex	1
9795	Ti Nitride Ballstuds 4-40 x .20 - long	Pr.
9796	Ti Nitride Ballstuds 4-40 x .30 - long	Pr.
9797	Ti Nitride Ballstuds 4-40 x .40 - long	Pr.
9798	Ti Nitride Ballstuds 4-40 x .20 - short	Pr.
9799	Ti Nitride Ballstuds 4-40 x .30 - short	Pr.
9851	SC10 Battery Strap, Carbon	1
9864	FT Aluminum Hub, 0 deg (requires #7933, #7935, #6906)	Pr.
9865	FT Aluminum Hub, 0.5 deg (requires #7933, #7935, #6906)	Pr.
9866	FT Aluminum Hub, 1 deg (requires #7933, #7935, #6906)	Pr.
9867	FT Aluminum Hub, 1.5 deg (requires #7933, #7935, #6906)	Pr.
9872	FT Aluminum Hub Tower Set	1
9873	FT Aluminum Hub Tower C, carbon fiber	Pr.

:: Ball Diff Transmission Option

6573	Diff Thrust Washer & Bolt	2
6574	Precision Diff Thrust Balls, 5/64"	6
6575	Locking T-Nut, Diff Thrust Bolt, & Cover	1
6581	3/32" Carbide Diff Balls	12
6582	Diff Thrust Spring	1
6589	Ball Bearing, 5/32 x 5/16" unflanged	2
7664	Diff Gear 52T	1
7666	Diff Drive Rings, 2.60:1	2
7667	Diff Outdrive Hub, Right, 2.60:1	1
7668	Diff Outdrive Hub, Left, 2.60:1	1
7677	B4 / T4 / GT Diff Rebuild Kit	1
9574	B4 / T4 Transmission Case (left & right)	1
9852	SC10 Ball Diff Outdrives	1
9853	SC10 Complete Ball Differential	1

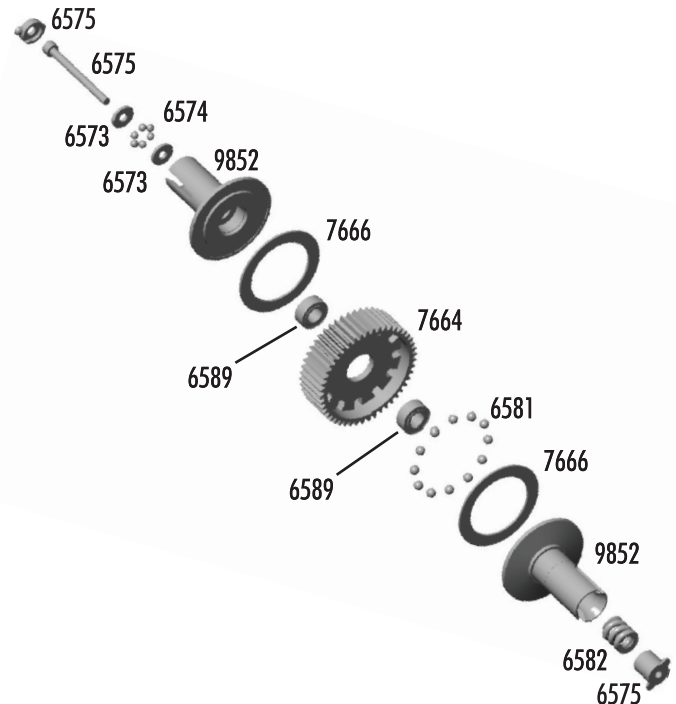

:: Reedy Batteries

302	AA Alkaline 1.5V (4)	1
303	AA 2700mAh NiMH 1.2V Rechargeable (4)	1
309	LiPo 65C 7000mAh 7.4V	1
602	LiPo 65C 4100mAh 7.4V Shorty	1
628	LiPo 60C 5500mAh 7.4V	1
681	Wolfpack 2400mAh 7.2V w/DEANS® connector	1
682	Wolfpack 3000mAh 7.2V w/DEANS® connector	1
683	Wolfpack 3600mAh 7.2V w/DEANS® connector	1
684	Wolfpack 4200mAh 7.2V w/DEANS® connector	1
730	Wolfpack LiPo 3000mAh 7.4V 25C w/DEANS®	1
731	Wolfpack LiPo 3300mAh 7.4V 35C w/DEANS®	1
732	Wolfpack LiPo 3400mAh 7.4V 35C w/DEANS®	1
734	Wolfpack LiPo 6500mAh 7.4V 25C w/DEANS®	1
736	Wolfpack LiPo 5000mAh 7.4V 25C	1
738	Wolfpack LiPo 3800mAh 7.4V 25C Shorty	1

:: Reedy Motors

231	Sonic 540 Mach 2 21.5 Competition Brushless Motor	1
232	Sonic 540 Mach 2 17.5 Competition Brushless Motor	1
233	Sonic 540 Mach 2 13.5 Competition Brushless Motor	1
234	Sonic 540 Mach 2 10.5 Competition Brushless Motor	1
235	Sonic 540 Mach 2 9.5 Competition Brushless Motor	1
236	Sonic 540 Mach 2 8.5 Competition Brushless Motor	1
237	Sonic 540 Mach 2 8.0 Competition Brushless Motor	1
238	Sonic 540 Mach 2 7.5 Competition Brushless Motor	1
239	Sonic 540 Mach 2 7.0 Competition Brushless Motor	1
240	Sonic 540 Mach 2 6.5 Competition Brushless Motor	1
241	Sonic 540 Mach 2 6.0 Competition Brushless Motor	1
242	Sonic 540 Mach 2 5.5 Competition Brushless Motor	1
243	Sonic 540 Mach 2 5.0 Competition Brushless Motor	1
244	Sonic 540 Mach 2 4.5 Competition Brushless Motor	1
245	Sonic 540 Mach 2 4.0 Competition Brushless Motor	1
246	Sonic 540 Mach 2 3.5 Competition Brushless Motor	1
908	Replacement Rotor 540-SL	1
920	540-SL Brushless Motor 3300kV	1
921	540-SL Brushless Motor 3900kV	1
922	540-SL Brushless Motor 4900kV	1
923	540-SL Brushless Motor 6100kV	1
954	Sonic 540 Stock Rotor 12.3 x 24.2 (7.25)	1
955	Sonic 540 Stock Rotor 12.3 x 25.0 (7.25)	1
956	Sonic 540 Stock Rotor 12.5 x 25.0 (7.25)	1
957	Sonic 540 Modified Rotor 12.2 x 25.0 (5.0)	1
958	Sonic 540 Modified Rotor 12.5 x 25.0 (5.0)	1
965	Reedy 540-SL 3300kV/XP SC700-BL ESC Combo	1
966	Reedy 540-SL 3900kV/XP SC700-BL ESC Combo	1
967	Reedy 540-SL 4900kV/XP SC700-BL ESC Combo	1
983	Reedy 540-SL 3300kV/XP SC1200-BL ESC Combo	1
984	Reedy 540-SL 3900kV/XP SC1200-BL ESC Combo	1
985	Reedy 540-SL 4900kV/XP SC1200-BL ESC Combo	1
986	Reedy 540-SL 6100kV/XP SC1200-BL ESC Combo	1
987	Sonic 540 Modified Rotor 13.0 x 25.0 (5.0)	1

:: Reedy Accessories

247	Sonic 540 Mach 2 Sensor w/bearing	1
248	Sonic 540 Mach 2 Steel Bearing Set	1
249	Sonic 540 Mach 2 Ceramic Bearing Set	1
250	Sonic 540 Mach 2 Insulator Set	1
604	526-S AC/DC 2S-6S LiPo/LiFe Charger	1
607	Charge Harness 2S Standard Pack 4mm	1
609	TAM to DEANS® charge adapter	1
610	447-S AC/DC NiMH Peak Charger	1
654	4.0mm plugs (2M, 2F)	1
655	4.0mm plugs (2M, 10F)	1
656	4.0mm plugs (10F)	1
657	4.0mm plugs (100F)	1
658	4.0mm plugs (10M)	1
659	4.0mm plugs (30M)	1
660	3.5mm plugs (3M, 3F)	1
661	3.5mm plugs (10F)	1
662	3.5mm plugs (100F)	1
663	3.5mm plugs (10M)	1
664	3.5mm plugs (30M)	1
716	Reedy 09 Decal Set	1
974	540-SL/550-SL Steel Bearing Set	1
975	540-SL/550-SL Ceramic Bearing Set	1
978	Flat Sensor Wire 70mm	1
979	Flat Sensor Wire 110mm	1
980	Flat Sensor Wire 150mm	1
981	Flat Sensor Wire 200mm	1
982	Flat Sensor Wire 270mm	1
992	Sonic 540 Rotor Spacers	1

:: XP Electronics

29107	S1903 Metal Gear Set	1
29125	S1903MG Servo	1
29126	S2008MG Servo	1
29127	XP DS2008/S2008 Metal Gear Set	1
29133	XP DS1903 Servo	1
29134	XP DS1903MG Servo	1
29135	XP DS2008MG Servo	1
29138	XP SC500 Brushless ESC	1
29139	XP SC900-BL Brushless ESC	1
29142	XP ESC Fan Option	1
29143	XP SC700-BL Brushless ESC	1
29144	XP SC1200 Brushless ESC	1
29145	XP SC1300 Brushless ESC	1
29166	XP DS1313 Digital Servo	1
29167	XP DS1015 Digital Servo	1
29168	XP DS1510MG Digital Servo	1
29209	Gear Set, DS1313	1
29210	Gear Set, DS1015	1
29211	Servo Case, DS1313 / DS1015	1
29212	Accessory Pack, DS1313 / DS1015	1
29214	TRS 403-SSi Receiver	1
29215	XP2G 2.4GHz Radio System	1
29216	XP3G 2.4GHz Radio System	1
29251	XP DS1505MG Digital Servo	1

:: Tools

1111	FT Turnbuckle Wrench	1
1449	Offroad Ride Height Gauge	1
1541	FT Hex Driver Set, (7 pcs)	1
1542	FT .050" Silver Hex Driver	1
1543	FT 1/16" Black Hex Driver	1
1544	FT 1.5mm Purple Hex Driver	1
1545	FT 5/64" Blue Hex Driver	1
1546	FT 3/32" Gold Hex Driver	1
1547	FT 2.5mm Green Hex Driver	1
1548	FT 3mm Red Hex Driver	1
1551	FT Screwdriver Set	1
1553	FT Phillips Silver Screwdriver	1
1554	FT Silver Spring Hook Tool	1
1561	FT Nut Driver Set, (6 pcs)	1
1562	FT 3/16" Black Nut Driver	1
1563	FT 1/4" Red Nut Driver	1
1564	FT 5.5mm Red Nut Driver	1
1565	FT 11/32" Green Nut Driver	1
1567	FT 8mm Gold Nut Driver	1
1589	FT 5/64" Blue Ball Hex Driver	1
1590	FT 3/32" Gold Ball Hex Driver	1
1592	FT Ball Hex Driver Set, (3 pcs)	1
1655	FT 8-Piece 1/4" Hex Drive Set	1
1656	FT 1/4" Hex Drive Handle, without tips	1
1657	FT 1/4" Hex Drive .050" Tip	1
1658	FT 1/4" Hex Drive 1/16" Tip	1
1659	FT 1/4" Hex Drive 5/64" - 2.0mm Tip	1
1660	FT 1/4" Hex Drive 3/32" Tip	1
1661	FT 1/4" Hex Drive 1.5mm Tip	1
1662	FT 1/4" Hex Drive 2.5mm Tip	1
1663	FT 1/4" Hex Drive 3/16" Nut Driver Tip	1
1664	FT 1/4" Hex Drive 1/4" Nut Driver Tip	1
1665	FT 1/4" Hex Drive 11/32" Nut Driver Tip	1
1666	FT 1/4" Hex Drive 5.5mm Nut Driver Tip	1
1667	FT 1/4" Hex Drive 7.0mm Nut Driver Tip	1
1668	FT 1/4" Hex Drive 8.0mm Nut Driver Tip	1
1669	FT 1/4" Hex Drive 5/64" - 2.0mm Ball End Tip	1
1670	FT 1/4" Hex Drive 3/32" Ball End Tip	1
1671	FT 1/4" Hex Drive Standard Screwdriver Tip	1
1672	FT 1/4" Hex Drive Phillips Screwdriver Tip	1
1673	FT 1/4" Hex Drive 2.5mm Ball End Tip	1
1674	FT 1/4" 5 Piece Power Tool Tips Set (5/64-2.0mm, 1.5mm, 2.5mm, 5/64" - 2.0mm ball, 2.5mm ball)	1
1719	FT Camber + Track Width Tool	1
1737	FT Body Scissors	1
3718	12 Inch Nylon Wire Ties	12
3719	6 Inch Nylon Wire Ties	12
3720	8 Inch Nylon Wire Ties	12
3987	FT Droop Gauge	1
6429	Shock Building Tool	1
6956	Molded Tools, Set	1
7494	V2 Stamped Multi Tool	1
7709	4 Inch Nylon Wire Ties	12

:: Qualifier Series Vehicles

7052	Pro Lite 4x4 RTR, 1/10 Scale (ready-to-run)	1
20111	Rival Mini Monster Truck 1/18 Scale (ready-to-run)	1
20119	APEX Mini Touring RTR, 1/18 Scale (ready-to-run)	1
20510	RIVAL Electric Monster Truck RTR, 1/8 Scale (ready-to-run)	1
30112	APEX Touring V-Type, 1/10 Scale (ready-to-run)	1

:: 1/18 Kits and RTR's

20103	RC18B2 - RC18T2 Team Kit	1
20121	SC18 RTR Brushless (ready-to-run)	1

:: 1/12, 1/10 Kits and RTR's

2042	Nitro TC3 RTR Plus (ready-to-run)	1
4020	FT 12R5.2 Kit	1
6001	RC10 Classic Kit	1
7025	FT RC10T4.2 Kit	1
7029	SC10 Associated/RC10.com Truck RTR (ready-to-run)	1
7030	SC10 KMC Wheels Race Truck RTR (ready-to-run)	1
7038	FT SC10.2 Kit	1
7039	RC10T4.2 RS RTR 2.4GHz Brushless (ready-to-run)	1
7046	SC10 RS RTR, Lucas Oil (ready-to-run)	1
7048	SC10 RS RTR, Pro Comp (ready-to-run)	1
7049	SC10 RS RTR, Rockstar/Makita (ready-to-run)	1
7050	SC10 RS RTR, Hart and Huntington (ready-to-run)	1
7051	SC10 RS RTR, Slick Mist (ready-to-run)	1
7093	SC10GT RTR (ready-to-run)	1
8020	FT RC10R5 Kit	1
8022	FT RC10R5.1 Kit	1
9040	FT RC10B4.1 Worlds Kit	1
9041	FT RC10B4.2 Kit	1
9042	RC10B4.2 RS RTR 2.4GHz Brushless (ready-to-run)	1
9050	SC10B RS RTR (ready-to-run)	1
9062	FT B44.2 4WD Buggy Kit	1
30101	TC4 Club Racer 4WD Touring Car Race Roller	1
30108	FT TC6.1 WC 4WD Touring Car Kit	1
90005	SC10 4x4 Lucas Oil RTR (ready-to-run)	1
90006	SC10 4x4 Pro Comp RTR (ready-to-run)	1
90010	SC10 4x4 FT Kit	1

:: 1/8 Kits and RTR's

20501	MGT 4.60 SE RTR (ready-to-run)	1
20502	MGT 8.0 Nitro RTR (ready-to-run)	1
20503	Limited Edition MGT 4.60 Nitro RTR, w/flag body (ready-to-run)	1
20504	Limited Edition MGT 8.0 Nitro RTR, w/flag body (ready-to-run)	1
80906	RC8.2 Nitro Buggy FT Kit	1
80907	RC8.2e Electric Buggy FT Kit	1
80908	RC8.2e Electric Buggy RTR (ready-to-run)	1
80909	RC8.2RS Nitro Buggy RTR (ready-to-run)	1
80912	RC8T Championship Edition	1
80933	SC8.2e Short Course Race Truck, Rockstar/Makita Electric RTR (ready-to-run)	1
80934	SC8.2e Short Course Race Truck, Slick Mist Electric RTR (ready-to-run)	1

:: Bodies and Decals

9836	SC10 Clear Body	1
9837	SC10 '09 Clear Body	1
9838	SC10 KMC Body, pre-painted & detailed	1
9843	SC10 KMC Decal Sheet	1
9844	SC10 Lucas Oil Decal Shee	1
9846	SC10 Pro Comp Decal Sheet	1
9847	SC10 AE Decal Sheet	1
9848	SC10 Ready Lift Body, pre-painted & detailed	1
9849	SC10 Ready Lift Decal Sheet	1
9856	SC10 '09 Lucas Oil Body, pre-painted & detailed	1
9857	SC10 '09 Lucas Oil Decal Sheet	1
9858	SC10 '09 Pro Comp Body, pre-painted & detailed	1
9859	SC10 '09 Pro Comp Decal Sheet	1
9860	SC10 '09 Speed Tech Body, pre-painted & detailed	1
9861	SC10 '09 Speed Tech Decal Sheet	1
9862	SC10 '09 Rockstar / Makita Body, pre-painted & detailed	1
9863	SC10 '09 Rockstar / Makita Decal Sheet	1
9876	SC10 Contender Body, clear	1
9886	SC10' 09 Slick Mist Body, pre-painted & detailed	1
9887	SC10' 09 Slick Mist Decal Sheet	1

:: Lubes and Adhesives

1105	Green Slime Shock Lube	4cc
1596	FT Locking Compound	10ml
1597	FT Tire Adhesive	.70oz
6588	Black Grease	4cc
6591	Diff Lube	4cc
6636	Silicone Lube	4cc
6727	Servo Tape Strips	2

1596

**:: Apparel**

SP36**	Reedy 09' Black T-Shirt (M, XL, 2XL)	1
SP37**	Reedy 2012 T-shirt - Black (S, M, L, XL, 2XL, 3XL)	1
SP38	Reedy Trucker Hat	1
SP39	Reedy Patch	1
SP66**	Stencil Blue T-Shirt (S, M, L, XL, 2-6XL)	1
SP67**	AE Stencil Gray Sweatshirt (S, M, L, XL, 2XL, 3XL)	1
SP68**	AE Stencil Blue T-Shirt (M, L, XL)	1
SP69**	AE 26 Time World Championship T-Shirt, Black (S, M, L, XL, 2XL, 3XL)	1
SP70**	Associated Windbreaker (XL)	1
SP71**	Associated Winter Jacket (M, L, XL)	1
SP73**	AE Long Sleeve T-Shirt (S, M, L, XL, 2XL)	1
SP74**	AE White T-Shirt (S, M, L, XL, 2XL, 3XL, 4XL)	1
SP75**	AE Blue T-Shirt (S, M, L, XL, 2XL, 4XL, 6XL)	1
SP76**	AE Black T-Shirt (S, M, L, XL, 2XL, 3XL)	1
SP77**	AE 2012 T-Shirt, Blue (S, M, L, XL, 2XL, 3XL)	1
SP78**	AE 2012 T-Shirt, White (S, M, L, XL, 2XL, 3XL)	1
SP79**	AE 2012 T-Shirt, Black (S, M, L, XL, 2XL, 3XL)	1
SP84**	Reedy 3D T-Shirt, Black (S, M, L, XL, 2XL, 3XL)	1
SP85**	Reedy Zip Hoodie, Black (S, M, L, XL, 2XL, 3XL)	1
SP86**	Reedy Girl's 3D T-Shirt, Black (S, M, L, XL)	1
SP87**	AE 2013 Zip Hoodie (S, M, L, XL, 2XL, 3XL)	1
SP411S	AE Hat 11' Flat Bill Black S/M	1
SP411L	AE Hat 11' Flat Bill Black L/XL	1
SP413S	26 Time World Championship Hat S/M	1
SP413L	26 Time World Championship Hat L/XL	1
SP416	Associated Car Carrier Bag, Medium	1
SP417	1/10 FT Motor Bag	1
SP418	Factory Team 1/10 Car Carrier Bag	1
SP420**	AE Pit Gloves (L, XL)	Pr.
SP421S	AE 2012 Hat, Black, Flat Bill, S/M	1
SP421L	AE 2012 Hat, Black, Flat Bill, L/XL	1
SP422S	AE 2012 Hat, Black, Curved Bill, S/M	1
SP422L	AE 2012 Hat, Black, Curved Bill, L/XL	1
SP423S	AE 2012 Hat, White, Flat Bill, S/M	1
SP423L	AE 2012 Hat, White, Flat Bill, L/XL	1
SP424S	AE 2012 Hat, White, Curved Bill, S/M	1
SP424L	AE 2012 Hat, White, Curved Bill, L/XL	1
715	Reedy 2009 Track Banner	1
110684	Team Associated Track Banner	1

:: Adjustments / Tips

Motor Gearing:

Proper motor gearing will result in maximum performance and run time while reducing the chance of overheating and premature motor failure. The gear ratio chart lists recommended starting gear ratios for the most widely used motor types. Gear ratios will vary depending upon track conditions, driving style, and personal preference. Generally, you should not increase the pinion gear size more than one tooth greater than the starting size.

SC10 Gear Ratio Chart

MOTOR	Pinion	Spur	FDR
27T Stock Motor	19	87	11.91:1
19T Super Stock Motor	19	87	11.91:1
17T Modified Motor	24	87	9.43:1
15T Modified Motor	22	87	10.28:1
14T Modified Motor	21	87	10.77:1
17.5 Brushless Motor	28	75	6.96:1
13.5 Brushless Motor	26	75	7.50:1
10.5 Brushless Motor	24	87	9.42:1
3300kV Brushless Motor	18	87	12.57:1

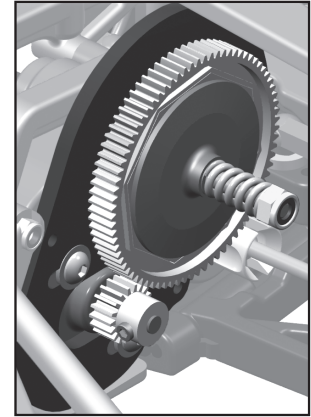

Set The Gear Mesh

You should be able to rock the teeth of the spur gear and the teeth of the pinion gear, slightly back and forth in the teeth of the pinion gear without making the pinion gear move. If the gear mesh is tight, then loosen the #31531 motor screws and move the motor back a little. Tighten the motor screws, then check gear mesh again. Gear mesh that is too tight or too loose can reduce power and damage or overheat the motor, or damage the teeth of the gears.

MAINTENANCE

Check For Fit

Periodically check all moving suspension parts. Suspension components must be kept clean and move freely without binding to prevent poor and / or inconsistent handling.

Motor Maintenance

Brushed motors require frequent maintenance to keep performance levels at their maximum. Between runs and after letting the motor cool completely, inspect the brushes to ensure that they are moving freely in their holders. Remove the springs and slide the brushes in and out of their holders checking for any resistance or rough spots. If found, remove the brush and carefully wipe it clean. Removing buildup will allow the brush to slide freely and create maximum contact with the commutator resulting in maximum power output.

After every 3-5 runs, remove the brushes from their holders and inspect the tips for wear or burning. If there is noticeable wear (less than 75% of the brush remaining), replace the brush with a new pair. If the tips become a burned blue color, the lubricant in the brush has been burned away and new brushes should be installed.

Occasionally, the motor should be cleaned with a soft brush to prevent dirt build up around the brush hood area and ball bearings. At this time, it is a good idea to add one drop of bushing / bearing oil to each bushing or ball bearing.

If using a brushless motor, please refer to the motor manufacturer's guidelines for proper maintenance.

Slipper Clutch

The assembly instructions give you a base setting for your clutch. Turn the nut on the shaft so that the end of the top shaft is even with the outside of the nut. Tighten the nut 3 more turns. At the track, tighten or loosen the nut in 1/8 turn increments until you hear a faint slipping sound for 1-2 feet on takeoffs.

Another popular way to set the clutch is to hold both rear tires firmly in place and apply short bursts of throttle. If the clutch is properly set, the front tires should lift slightly up off the surface.

:: Adjustments / Tips

Front Camber Links

Changing the length of the camber link is considered a bigger step than adjusting the ball end height on the tower. Shortening the camber link (or lowering the ball end) will give the front end less roll and quicken steering response. Lengthening the camber link (or raising the ball end) will give the front more roll and slower steering response.

Longer camber links are typically used on high grip tracks and shorter links tend to work better on medium-grip loose tracks.



* Raise or lower the ball end by adding or subtracting washers here

Caster

Caster describes the angle of the kingpin as it leans toward the rear of the vehicle. Positive caster means the kingpin leans rearward at the top. The supplied 30° caster blocks (#7922) are recommended in most cases. For less corner entry steering and more exit steering, try the optional 25° blocks (#7919).

Front Camber

Camber describes the angle at which the tire and wheel rides when looked at from the front. Negative camber means that the tire leans inward at the top.

A good starting camber setting is -1°. Use the included #1719 camber gauge to set your camber. Positive camber, where the top of the tire is leaning out, is not recommended.

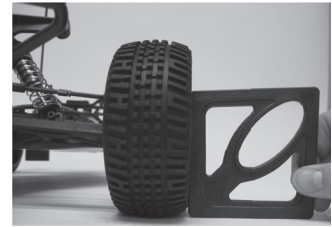

* Testing camber with camber gauge

Rear Camber Link

Changing the length of the camber link is considered a bigger step than adjusting the ball end height on the rear chassis brace. Shortening the camber link (or lowering the ball end) will give the rear end less roll and the car will tend to accelerate or "square up" better. Lengthening the camber link (or raising the ball end) will give the rear more roll and more cornering grip. Longer camber links are typically used on high grip tracks, while shorter links tend to work better on med-grip loose tracks. The kit setting is the best compromise of cornering grip and acceleration.



* Raise or lower the ball end by adding or subtracting washers here

Rear Camber

Camber describes the angle at which the tire and wheel rides when looked at from the back. Negative camber means that the tire leans inward at the top. A good starting camber setting is -1°. Use the included #1719 camber gauge to set your camber. Adding a small amount of positive camber, where the top of the tire is leaning out, will tend to improve straight-line acceleration on loose tracks.

Ride Height

Ride height is the distance from the ground to the bottom of the chassis. The standard front ride height setting is with the front arms level (referred to as "arms level"). Check the ride height by lifting up the entire car about 8-12 inches off the bench and drop it. After the suspension "settles" into place, add or remove pre-load clips so that the left & right arms appear to be level.

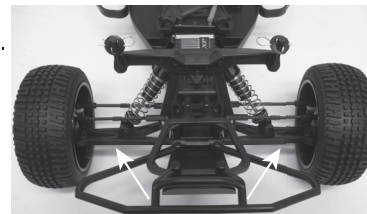

* Front arms should be in a straight line when ride height is set at "arms level"

The rear ride height setting you should use most often is with the outdrive, driveshaft, and axles all on the same imaginary horizontal line (referred to as "bones level"). Check the ride height by lifting up the entire car about 8-12 inches off the bench and drop it. After the suspension "settles" into place, add or remove pre-load clips so that the left & right driveshafts appear to be level.

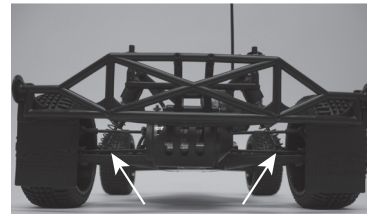

* Dogbones should be in a straight line when ride height is set at "dogbones level"

Wheelbase Adjustment

You have three options for rear hub spacing, Forward, Middle, & Back. The kit setting provides the most rear traction, and will be used most often. A short wheelbase will make the rear end more responsive.

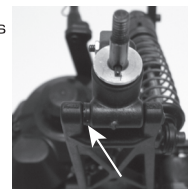

* Spacers to the rear will place hubs forward, shortening the wheelbase

Anti-Roll bar

The optional #9635 rear anti-roll bar kit (also called the "swaybar") allows you to add roll resistance to the rear end with minimal effect on handling over bumps and jumps. It is an especially helpful tuning item on high-grip tracks (try the gold bar). The silver and black anti-roll bars are typically used on medium-grip loose tracks.

:: Contact Information:

**Associated Electrics, Inc.
26021 Commercentre Drive
Lake Forest, CA 92630-8853 USA
<http://www.TeamAssociated.com>
<http://www.RC10.com>
[http://twitter/Team Associated](http://twitter/TeamAssociated)
<http://bit.ly/AEonFacebook>**

call: (949) 544-7500

fax: (949) 544-7501

Check out the following web sites for all of our electric kits, current products, new releases, setup help, tips, and racing info!

www.TeamAssociated.com. - www.RC10.com

:: Notes:

A large, empty rectangular area for taking notes, bounded by a thin black line.

Front Suspension

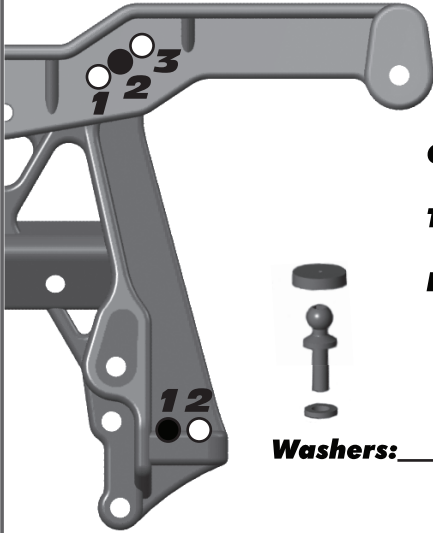

Camber: -1°

Toe: 0°

Ride Height: arms level

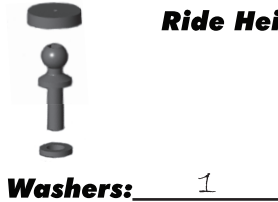

Washers: 1

Bump Steer Spacers: 2

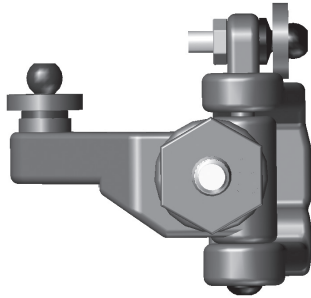

Caster:

- 20°
- 25°
- 30°

ABC

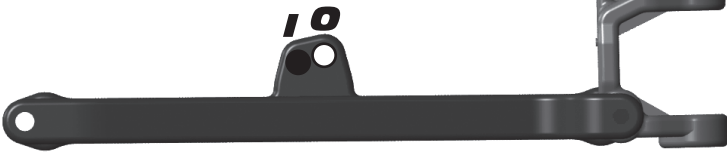

Rear Suspension

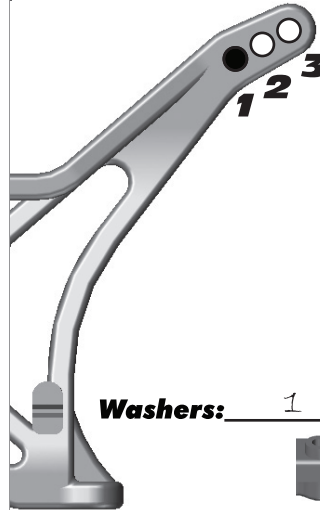

Camber: 0°

Ride Height: bones level

Anti-Squat: 2°

Toe: 3°

Washers: 1

Anti Roll Bar:

- None
- Black (soft)
- Silver (med)
- Gold (hard)

Rear Hub Carriers:

- Std 0°
- 0.5°
- 1°
- 1.5°

Drivetrain:

- Dog Bones
- CVD
- CVA

Wheelbase:

- Long
- Medium
- Short

Rear Hub Tower: std

ABC



Front Shocks

Spring: gold Piston: #3
 Shock Fluid: 30wt Limiter: 5thin
 Rebound: _____ Bladder Emulsion

Rear Shocks

Spring: green Piston: #1
 Shock Fluid: 30wt Limiter: 2thin
 Rebound: _____ Bladder Emulsion

Electronics

Motor & Wind: Reedy 540R 3300kv BL
 Pinion: 18
 Spur Gear: 87
 Batteries: not included
 Battery Placement: Front Middle Back
 Other

Radio: XP 2.4 GHz
 Throttle / Brake e.p.a: _____
 Throttle / Brake expo: _____
 Servo: SHV1903 MG Steering Expo: _____
 ESC: XP SC700
 ESC Profile: _____

Differentials

Gear Diff: black grease
 Ball Diff:

Other

Body Type: SC10 09' Championship Body
 Body Notes: _____

Front Tires

Tire: standard Compound: standard
 Insert: standard Wheel: KMC Hex - black
 Notes: _____

Rear Tires

Tire: JC Subcultures Compound: green
 Insert: standard Wheel: KMC Hex - black
 Notes: _____

Race and Vehicle Comments

Qualify: _____ Main: _____ Finish: _____ TQ: _____
 Comments: _____

Track Info

- Smooth: Bumpy: Blue Groove:
- Traction: High: Medium: Low:
- Soft Dirt: Grass: Clay: Wet:
- Dusty: Other: _____

:: Hardware - 1:1

socket head (shcs)

	4-40 x 1/4 (6285)
	4-40 x 3/8 (6924)
	4-40 x 1/2 (6925)
	4-40 x 5/8 (6926)
	4-40 x 3/4 (6927)
	4-40 x 7/8 (7738)
	4-40 x 1 (6928)
	4-40 x 1 1/4 (6913)
	4-40 x 1 3/4 (9833)
	5-40 x 7/16 (9643)
	5-40 x 9/16 (9644)
	5-40 x 3/4 (9835)

setscrews

	4-40 x 1/2 (9170)
	5-40 x 1/8 (3862)

ball bearings

	3/16 x 3/8 (3977)
	10 x 16mm (9832)

flat head (fhcs)

	2.5x6mm (4675)
	4-40 x 3/8 (6292)
	4-40 x 1/2 (6922)
	4-40 x 5/8 (6915)
	5-40 x 1/2 (9269)

shims & washers

	ballstud washer (9630)
	.03 nylon washer (4187)
	gold washer (7337)
	3/16 axle shim (7368)
#4 aluminum washer"/>	#4 aluminum washer (6936)
	5 x 9.5mm shim (9830) gear diff outdrives
	servo saver shim (9610) servo saver hardware (lower)
	servo saver shim (9610) servo saver hardware (upper)
	5 x 14mm shim (9829) diff rebuild

button head (bhcs)

	2-56 x 1/8 (9645)
	2-56 x 5/16 (4334)
	4-40 x 5/16 (6919)
	4-40 x 3/8 (6917)
	4-40 x 7/16 (2221)
	3x6mm (31531)

ballstuds

	black .200" (3981)
	black .300" (3983)
	silver .200" (6276)
	silver .300" (6277)

nuts (lock/plain)

	4-40 small plain nut (7260)
	3/16 aluminum locking nut (4449)
	shock mount nut (6472)
	4-40 nut (6295)
	5-40 lock nut (6629)
	8-32 aluminum lock nut (9834)

Servo Chart

1 FIND YOUR SERVO TYPE

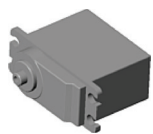

1 STEERING SERVO TYPE

(Steering servo is sold separately)
NOT ALL SERVOS ARE LISTED



2 #7336 SPACER



3 #9180 SERVO ARM



Associated Electrics / XP
AE SHV1504MG, AE SHV 1903 MG, DS1015, DS1313

Airtronics
94102

Airtronics
94738, 94157, 94158, 94257, 94258, 94357,
94358, 94452, 94453, 94751, 94755

thin spacer

no spacer

thick spacer

F

A

A

2 FIND YOUR SPACER(S)



Hitec
HS-5625MG, HS-5645MG, HS-625MG, HS-645MG

Hitec
HS-303, HS-300BB, HS-945MG, HS-925MG, HS-5945MG,
HS-5925MG, HS-525MG, HS-525BB, HS-425BB, HS-422

JR
Z4725, Z4750, Z2750, Z8450, Z8550, NES-4750

JR
Z250, Z550

no spacer

thin spacer

no spacer

thin spacer

H

H

J

J

3 SELECT YOUR SERVO HORN



Futaba
S9204, S9250, S9450, S148

Futaba
S3003, S9202, S9101

Futaba
S9404

KO
PS-401, PS-2001, PS-2004, PS-2015, PS-2173, PS-2174,
PS-2123, PS-2143, PS-2144

no spacer

thin spacer

thick spacer

thin spacer

F

F

F

J

Front Suspension

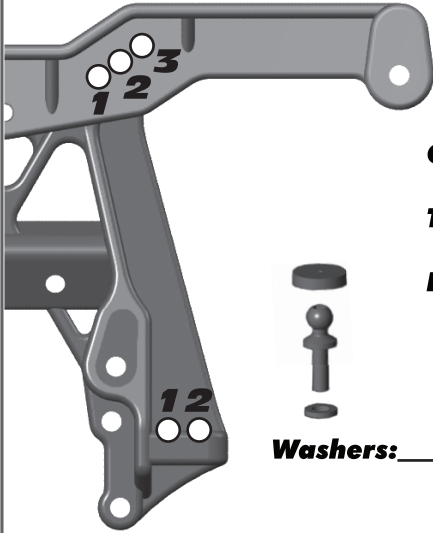

Camber: _____

Toe: _____

Ride Height: _____

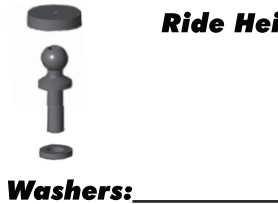

Bump Steer Spacers: _____

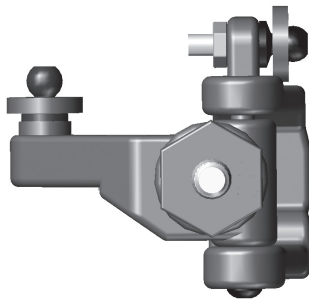

Caster:

- 20°
- 25°
- 30°

ABC



Rear Suspension

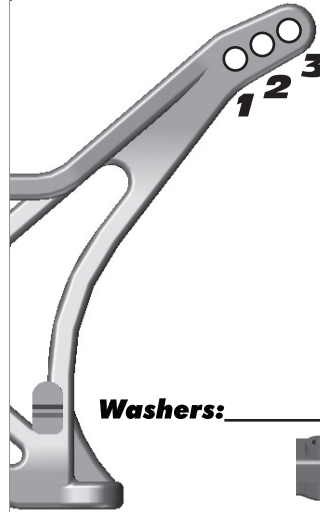

Camber: _____

Ride Height: _____

Anti-Squat: _____

Toe: _____

Washers: _____

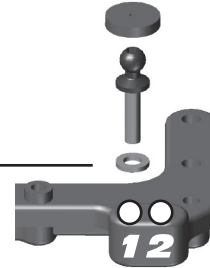

Anti Roll Bar:

- None
- Black (soft)
- Silver (med)
- Gold (hard)

Rear Hub Carriers:

- Std 0°
- 0.5°
- 1°
- 1.5°

Drivetrain:

- Dog Bones
- CVD
- CVA

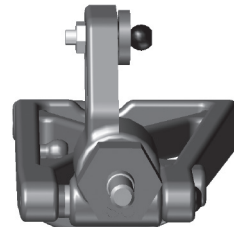

Wheelbase:

- Long
- Medium
- Short

Rear Hub Tower: _____

ABC

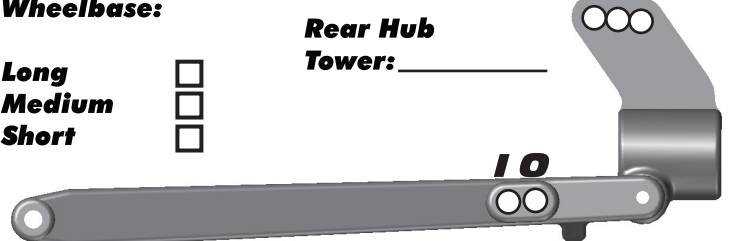

Front Shocks

Spring: _____ Piston: _____
 Shock Fluid: _____ Limiter: _____
 Rebound: _____ Bladder Emulsion

Rear Shocks

Spring: _____ Piston: _____
 Shock Fluid: _____ Limiter: _____
 Rebound: _____ Bladder Emulsion

Electronics

Motor & Wind: _____
 Pinion: _____
 Spur Gear: _____
 Batteries: _____
 Battery Placement: Front Middle Back
 Other

Radio: _____
 Throttle / Brake e.p.a: _____
 Throttle / Brake expo: _____
 Servo: _____ Steering Expo: _____
 ESC: _____
 ESC Profile: _____

Differentials

Gear Diff:
 Ball Diff:

Other

Body Type: _____
 Body Notes: _____

Front Tires

Tire: _____ Compound: _____
 Insert: _____ Wheel: _____
 Notes: _____

Rear Tires

Tire: _____ Compound: _____
 Insert: _____ Wheel: _____
 Notes: _____

Race and Vehicle Comments

Qualify: _____ Main: _____ Finish: _____ TQ: _____
 Comments: _____

Track Info

- Smooth: Bumpy: Blue Groove:
- Traction: High: Medium: Low:
- Soft Dirt: Grass: Clay: Wet:
- Dusty: Other: _____



**Associated Electrics, Inc.
26021 Commercentre Dr.
Lake Forest, CA 92630 USA**

<http://www.TeamAssociated.com>

<http://www.RC10.com>

https://twitter/Team_Associated

<https://bit.ly/AEonFacebook>

call: (949) 544-7500 - fax: (949) 544-7501

**Check out the following web sites for all of our kits,
current products, new releases, setup help, tips, and racing info!
www.TeamAssociated.com - www.RC10.com**