

# #6440 SHOCK REBUILD KIT

## Step 1

### DISMANTLING THE SHOCKS WHEN IT'S REBUILD TIME

Put the shock assembly tool into the bottom of the shock until it rests against the small washer, as shown, then push.

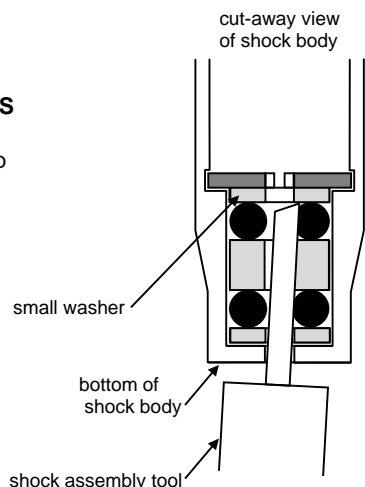

## Step 2

### TRIM SHOCK WASHERS & SPACERS

For best shock performance, trim each part from the parts tree so no part of the two molding runners remain. It is safer to remove a tiny amount of the part than to risk the chance of a burr remaining. Short blade scissors or a hobby knife will work fine, as shown at right. Run your finger over the edges to feel for burrs you cannot see. Remove the ones you find. Burrs can keep the parts from snapping in correctly, and can cause the shock to leak or the shaft to jam.



## Step 3

### SHOCK SEAL PARTS

Install the #5407 and #6440 parts shown onto the #6429 tool tip.

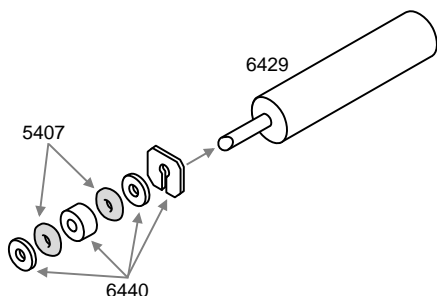

## Step 4

Add 3-4 drops of #5428 oil to the inside of the shock body, and to the shock seal parts.

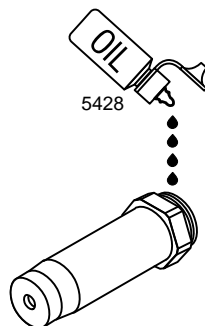

## Step 5

Insert the tool tip into the shock body all the way. Push **easily** until the parts snap into place.

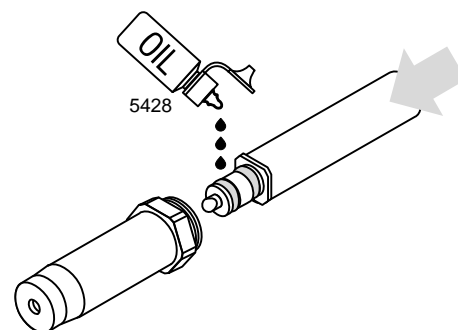

## Step 6

Check the tool height in photo. The right shock shows just before snapping parts in place, the left shows after.

If your shocks do not snap together easily, check the parts for burrs again as in Step 2.

Assemble the other shock bodies the same way.

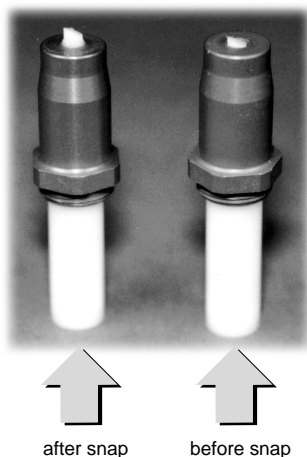

## Oils

Check out Team Associated's latest Silicone Shock Oils. All bottles are 2 ounces each, \$3.50.

- #5420 10 wt
- #5427 15 wt
- #5421 20 wt
- #5428 25 wt
- #5422 30 wt
- #5429 35 wt
- #5423 40 wt
- #5435 50 wt
- #5436 60 wt
- #5437 70 wt
- #5425 80 wt

TEAM ASSOCIATED  
3585 Cadillac Ave.  
Costa Mesa, CA 92626



phone: (714) 850-9342  
fax: (714) 850-1744  
web site: <http://www.teamassociated.com>