

#8205 RC10L REAR CHASSIS CROSS BRACE

Conversion kit to add RC10LSS cross brace to 10L chassis

Remove existing 10L dampener assembly washers, springs, collars, tube and dampener plate.

STEP 1 Assemble as shown in drawing. Start by mounting rear chassis standoffs (#8311) to the rear mounting hole of existing nurf wings with a 4-40 x 3/8" flat head socket screw (#6292).

STEP 2 Now mount lower dampener standoff (#8328) on top of the rear T-bar pivot ball assembly. Place rear chassis cross brace (#8310) on top of lower dampener standoff (#8328) and rear chassis standoff (#8311). Fasten with 4-40 x 1/4" flat head socket screw (#6285) using the two outer counter-sunk holes.

STEP 3 Now take the 4-40 x 1/2" stud (#8329B) and, using a .050 Allen wrench, drive the stud through the forward-facing hole of the rear chassis brace (#8310) into the lower dampener standoff (#8328). Half of the 4-40 x 1/2" stud (#8329B) should be sticking out of the rear chassis cross brace (#8310).

STEP 4 Mount upper dampener post (#8329A) onto the exposed threads of the 4-40 x 1/2" stud (#8329B).

To complete, reassemble dampener washer, collars, springs and dampener plate (#8201) according to your RC10L instruction book.

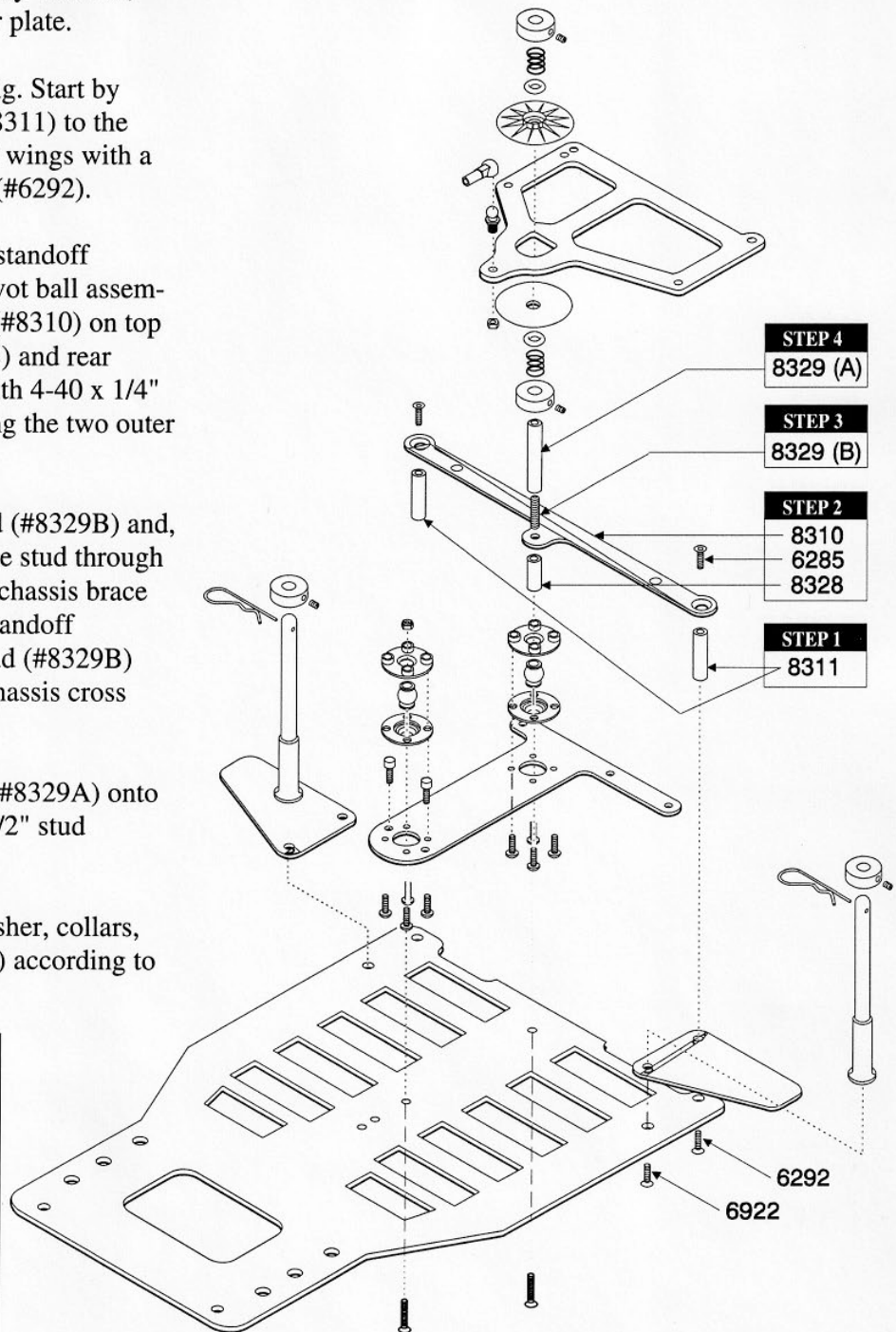

REPLACEMENT PARTS

Description	Part #
Rear chassis cross brace	8310
Rear chassis standoff	8311
Lower dampener standoff	8328
Upper dampener poset (8329A)	8329
4-40 x 1/2 stud (8329B)	8329
4-40 x 1/4 steel SHCScrews	6285
4-40 x 3/8" flat head socket screw	6292