

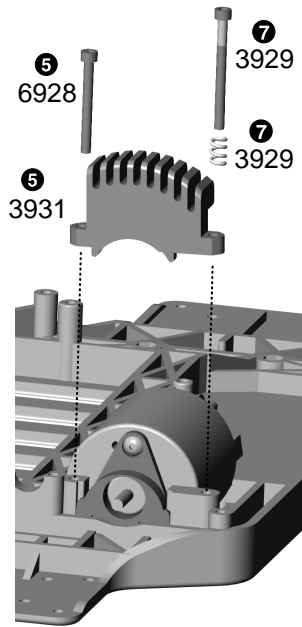



# SUPPLEMENTARY SHEET FOR THE TC3

On page 16, step 3, #5 of the TC3 assembly manual it is noted that you should lightly tighten the two #6928 screws that secure the motor clamp. We modified this step to include a spring. Please follow the steps below with the clamp and inner screw in place, but with the outer screw still removed.

## Step 3 (continued)

- 5 Screw down the #6928 inner screw first until the #3931 motor clamp just touches the chassis bulkhead.
- 6 Set your gear mesh.
- 7 Slide the #3929 spring onto the #3929 screw and thread in only until there is no free play between the screw head and spring. Now tighten the screw 2 to 3 turns. **No more.** It is normal to have a small gap remaining between the clamp and the bulkhead, as shown.



INSIDE SCREW	OUTSIDE SCREW	
		
6928	3929	3929
4-40 x 1" SHCS	4-40 x 1.25" SHCS	spring

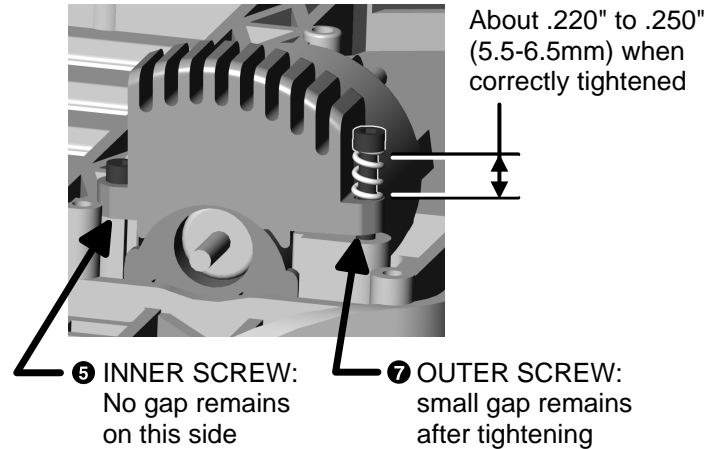

3929 MOTOR CLAMP OUTER SCREW AND SPRING | \$2.00