

## step 3

- 1 Install the #6469 O-ring over the threads of the #8458 shock body.
- 2 Install a #6299 E-clip on either side of a #6465 (#1) piston.
- 3 Slide one #6466 1/32" spacer onto the shock shaft.
- 4 Next install the assembled VC foam/bobbin over the shaft followed by two #5407 red O-rings. Place a couple of drops of oil on the O-ring. Insert the assembly into the shock body and pull the shaft through firmly to seat the VC bobbin at the base of the shock bore.
- 5 Push the #7217 pivot ball and eyelet together, then screw the eyelet onto the end of the shock shaft.

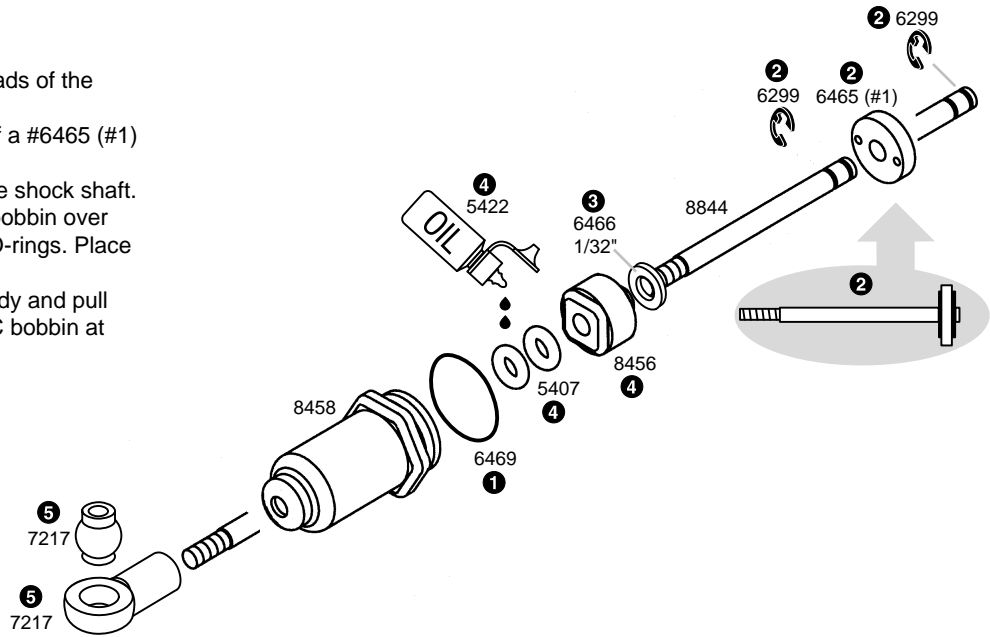

## step 4

- 1 Holding the shock upright, fill with oil to the top of the body.

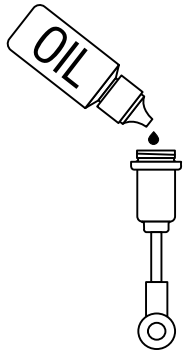

- 2 Slowly move the shaft up and down several times to allow air bubbles to escape to the top.

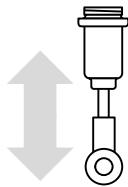

- 3 Refill with oil to the top of the body.

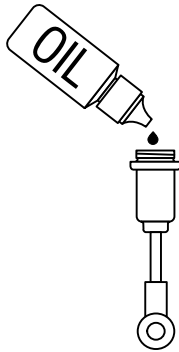

- 4 Push the shaft up until the piston is level with the top of the body. The oil will bulge up above the shock body.

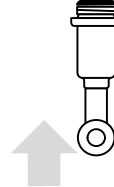

- 5 Fill The #6428 shock cap about halfway with oil and install onto the body. Try to retain as much oil as possible during assembly. The shaft will extend out as you tighten the cap down.

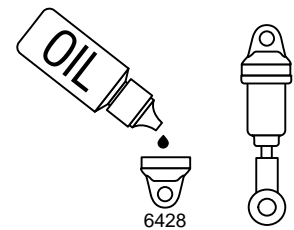

## DISASSEMBLY

- 1 To take out the VC foam/bobbin, unscrew the ball cup and shock cap, and push the shock shaft out.
- 2 Push your Allen wrench tip into the shock bottom and push the bobbin out, as shown. The O-rings should just fall out by themselves.

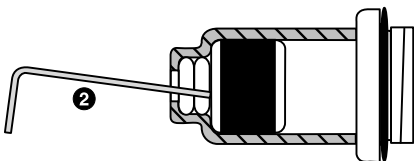

## TEAM ASSOCIATED ONLINE!

<http://www.teamassociated.com>

Get online help, tips, and new products for your kit through Associated online!

**Tech Help**, where answers to racers' questions are posted for all to learn from.

**Racer Spotlight**, where other racers proudly show off their favorite kit.

**Setup Sheets**, where racers go to find blank and standard setups to download for their kit.

**New Products**, where you learn of new kits and parts before they are announced anywhere else!

**Team Associated Insiders Newsletter.** Sign up for it on the Home Page if you want news delivered right to your e-mail box!

**Question of the Week.** Join in and give your opinion of the topic of the week, and learn from other racers.

**R/C Kits and Parts.** Online catalogs updated with new parts as soon as they come out.

**Help Form.** Our expert staff answers your toughest questions about Associated, Reedy, and LRP products.

**Free Stuff.** Get your Associated kit

# NDS Qualifier SUPPLEMENTARY SHEET, part 1

On Page 9, step 7, we have replaced the #6571 drive gear shaft with the new #6561 drive gear shaft.  
Please mark the number change in your manual.

## SUPPLEMENTARY SHEET, part 2

The following step replaces step 8 entirely on page 10.

### step 8

#### INSTALLING THE ADAPTER AND DISC BRAKE

- 1 Install the #7554 disc brake adapter onto the #6652 spur gear adapter so the slots line up. Place the #7553 brake disc over the #7554 disc brake adapter. Push the assembly onto the #6561 drive gear shaft so it fits neatly over the roll pin. Secure the new spur gear adapter with one #6936 #4 aluminum flat washer and one #6629 5-40 locknut (gold colored) as shown.

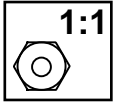
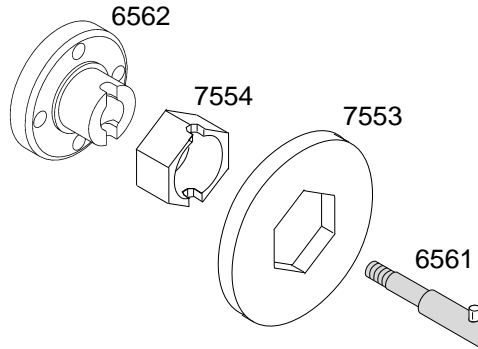

6629, qty 1  
5-40 locknut

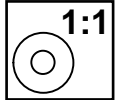

6936, qty 1  
#4 flat washer,  
alum.

## SUPPLEMENTARY SHEET, part 3

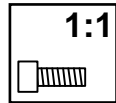

6285, qty 2  
4-40 x 1/4  
steel

On page 10, step 9, follow the text from 1-6 except for the following: In step 6 we have replaced the #6568 4-40 x 3/16" Button Head screws with the #6285 4-40 x 1/4" Socket Head Cap screws. Line up the gear with the spur gear adapter. Secure it with two #6285 screws.

## SUPPLEMENTARY SHEET, part 4

The following steps replace steps 1-4 on pages 17-18.

### BAG G

REMOVE THESE PARTS FOR:

8077, 8078:  
steps 1-4

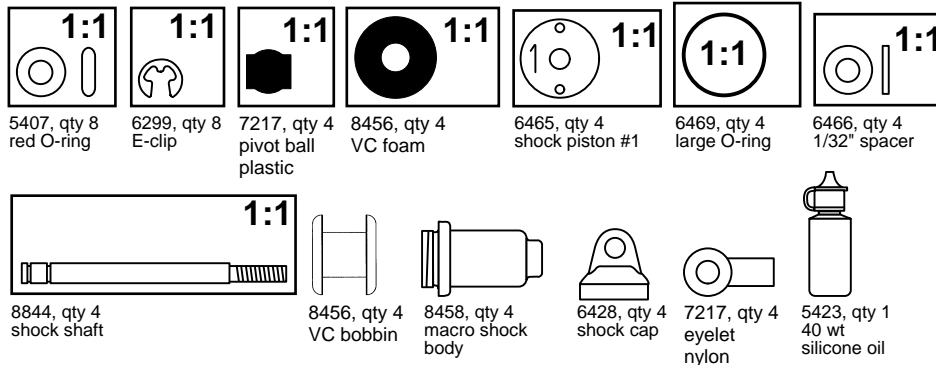

### TOOLS USED

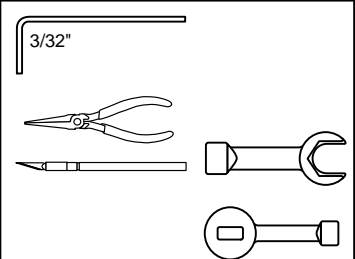

### step 1

#### TRIM SHOCK PISTON

- 1 Burrs interfere with smooth shock action within the shock body. To remove from tree without creating burrs, twist up, not down. Remove one #1 shock piston.
- 2 Remove remaining burrs carefully with hobby knife.

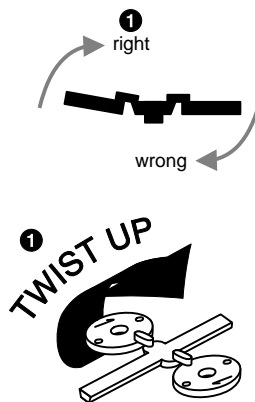
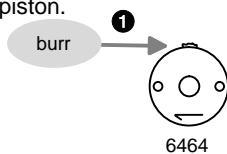

### step 2

**VC FOAM AND PISTON**  
Soak the #8456 VC foam with #5422 shock oil and install it onto the #8456 VC bobbin.

