

# SUPPLEMENTARY SHEET

These instructions replace the instructions for assembling universal axles and rear hub carriers in the **RC10T2 manual, figs. 100 to 102**, and the **RC10GT manual, fig. 136**. Do not follow the instructions in the manual referring to those figures; use the following.

## STEP 1

- 1 Spread some Associated #6588 black grease inside the axle hole where shown, then on the coupling, and insert the coupling into the axle.
- 2 Slide the axle into the bone, aligning the cross holes.
- 3 Insert the cross pin, making sure it is evenly spaced on both sides of the bone.
- 4 Add the MIP thread lock to the set screw. Angle and turn the MIP CVD™ (Constant Velocity Drive™) so the set screw can be screwed in with the supplied Allen wrench.
- 5 Assemble the other axle.

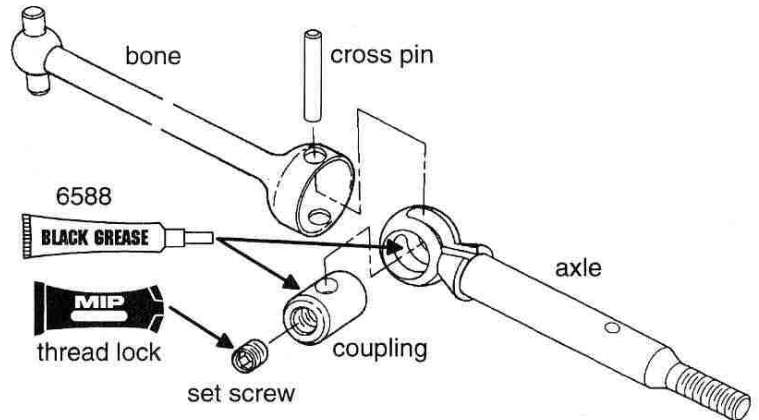

## STEP 2

- 1 Slide two #7368 shims onto the axle.
- 2 Slide one #6906 unflanged bearing onto the axle.
- 3 Slide the #7377 spacer into the #7365 hub carrier.
- 4 Slide the #7365 hub carrier onto the axle and bearing.

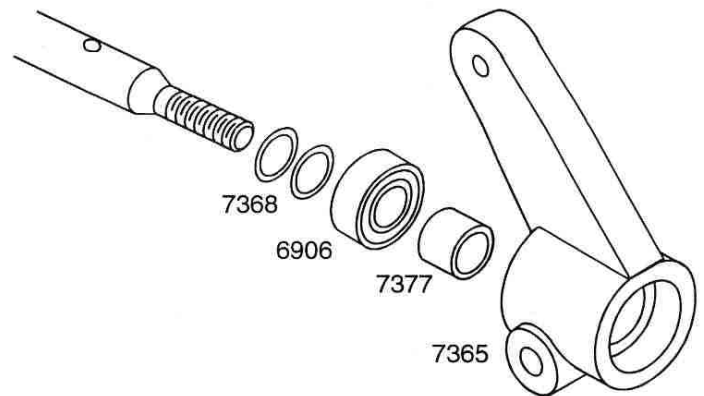
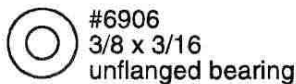

## STEP 3

- 1 Slide one #6906 unflanged bearing onto the axle.
- 2 Slide three #7368 shims onto the axle.
- 3 Install the #7369 spring pin with your needlenose pliers, which will hold all the shims against the bearing.
- 4 Follow the next steps as outlined in your manual.

